

**DAMMON**  
ENGINEERING, INC.

CHIEF ENGINEER  
EMMETT  
DAMMON, P.E.

CHIEF ARCHITECT  
ROBERT  
WILTSE

1095 FLORIDA AVENUE  
SLIDELL, LA. 70458  
OFFICE: 985-649-5832  
FAX: 985-641-5950

WEBSITE:  
WWW.DAMMONENGINEERING.COM

EMAIL:  
DAMMONENG@BELLSOUTH.NET

- ARCHITECTURE
- ENGINEERING
- STUDIES
- PLANNING
- INVESTIGATION
- EXPERT WITNESS

GREEN-STATEFARM  
RETAIL COMPLEX  
381-391 GAUSE  
BLVD., WEST  
SLIDELL, LA

FLOOR PLAN

REV:

SCALE: AS NOTED

JOB#: 2057

DATE: 06-23-10

SHEET 8

**A-1**

OF 19

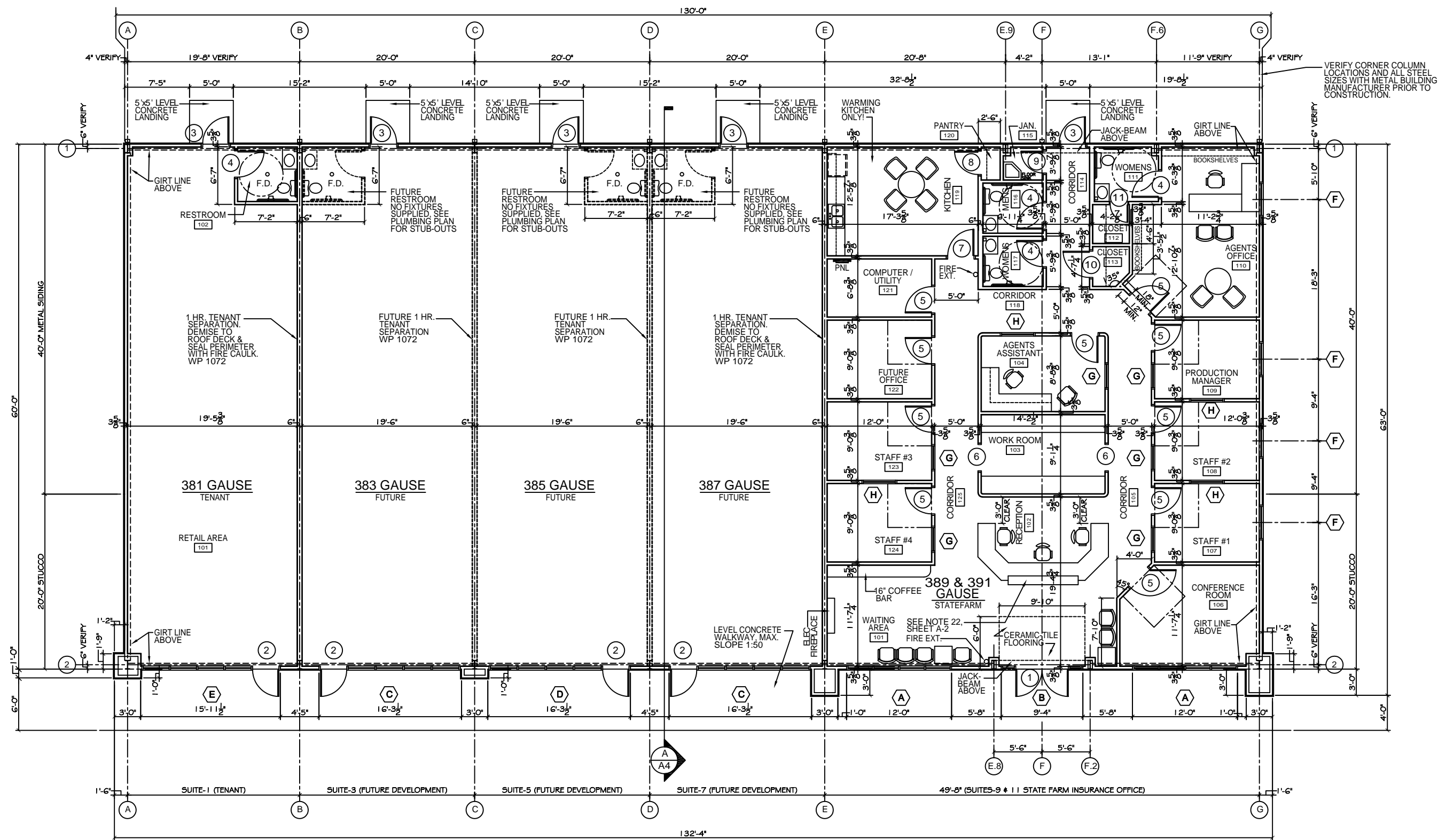

**GA FILE NO. WP 1072 GENERIC**

ONE LAYER 5/8" TYPE X GYPSUM WALLBOARD OR GYPSUM VENEER  
BASE APPLIED PARALLEL OR AT RIGHT ANGLES TO EACH SIDE OF  
3-5/8" STEEL STUDS 24" O.C. WITH 1" TYPE S DRYWALL SCREWS  
8" O.C. AT VERTICAL JOINTS AND 12" O.C. AT FLOOR AND CEILING  
RUNNERS AND INTERMEDIATE STUDS.

JOINTS STAGGERED 24" ON EACH SIDE AND ON OPPOSITE SIDES.  
SOUND TESTED WITH 3-12" GLASS FIBER FRICTION FIT IN STUD  
SPACE. (NON-LOAD BEARING)

1 HOUR FIRE 45 TO 49 STC SOUND



THICKNESS:  
APPROX. WEIGHT: 6 PSF  
FIRE TEST:

SOUND TEST:

4-7/8"  
SEE WP 1200 (FM WP-45, 6-19-68);  
OSU T-1770, 8-61; ULC 79T484, 79T500,  
79T497, 8-12-81, ULC DESIGN W415)  
NRCC 816-NV, 2-3-81

**1 HR SEPARATION DETAIL**

NTS

**FLOOR PLAN**

SCALE: 3/16"=1'



NOTE: ALL DIMENSIONS ARE TO FACE  
OF STUD, EXCEPT COLUMN GRID LINES,  
UNLESS OTHERWISE NOTED.