

DAMMON ENGINEERING, INC.

CHIEF ENGINEER
EMMETT
DAMMON, P.E.

CHIEF ARCHITECT
ROBERT
WILTSE

1095 FLORIDA AVENUE
SLIDELL, LA. 70458
OFFICE: 985-649-5832
FAX: 985-641-5950

WEBSITE:
WWW.DAMMONENGINEERING.COM

EMAIL:
DAMMONENG@BELL5OUTH.NET

ARCHITECTURE

ENGINEERING

STUDIES

PLANNING

INVESTIGATION

EXPERT WITNESS

RAIN FOREST CARWASH

3017
PONTCHARTRAIN
DRIVE
SLIDELL, LA
70458

MASONRY DETAILS

Robert Wiltse

REV:

SCALE: AS NOTED

JOB#: 2085

DATE: 01-17-11

SHEET 15

S-4

OF 25

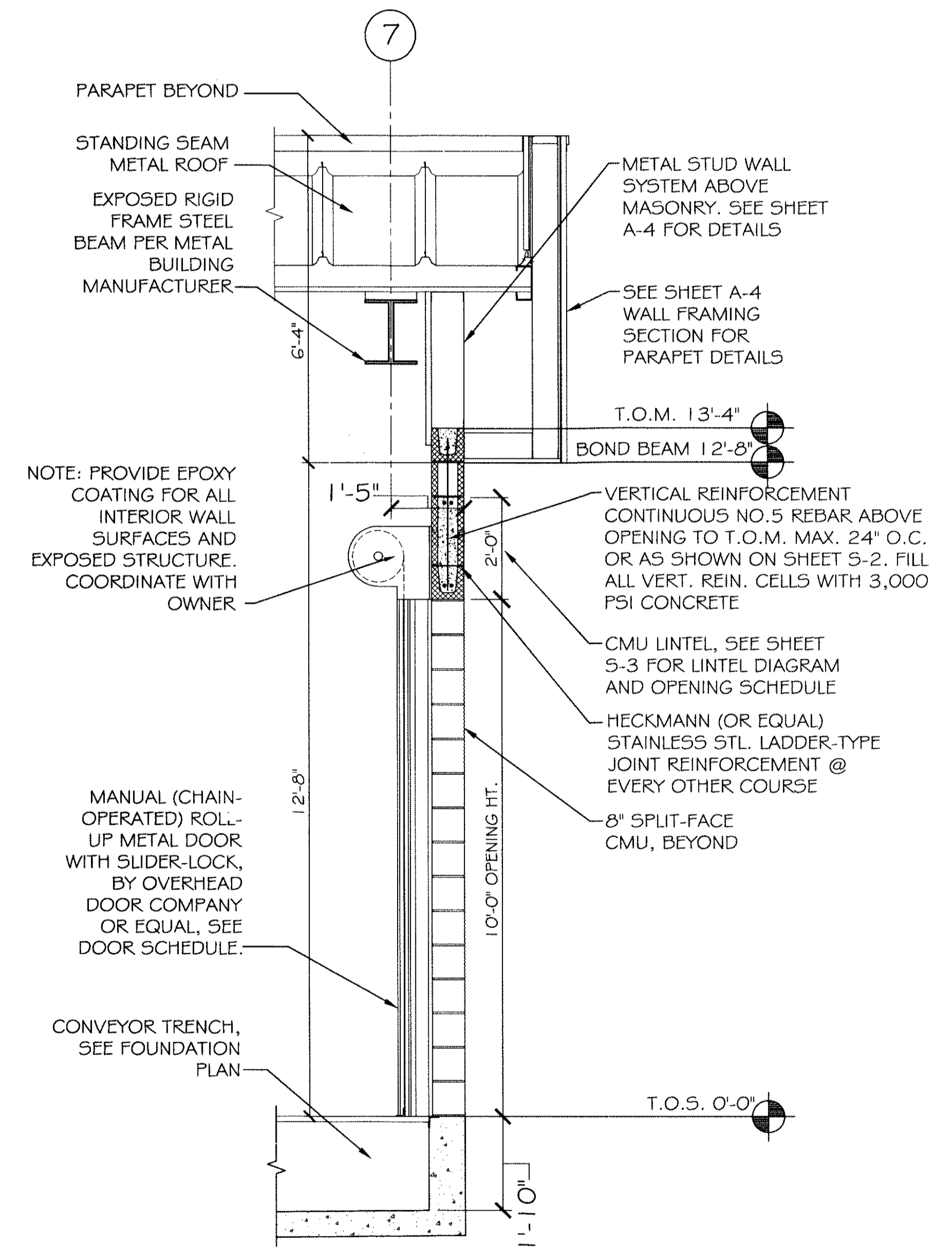
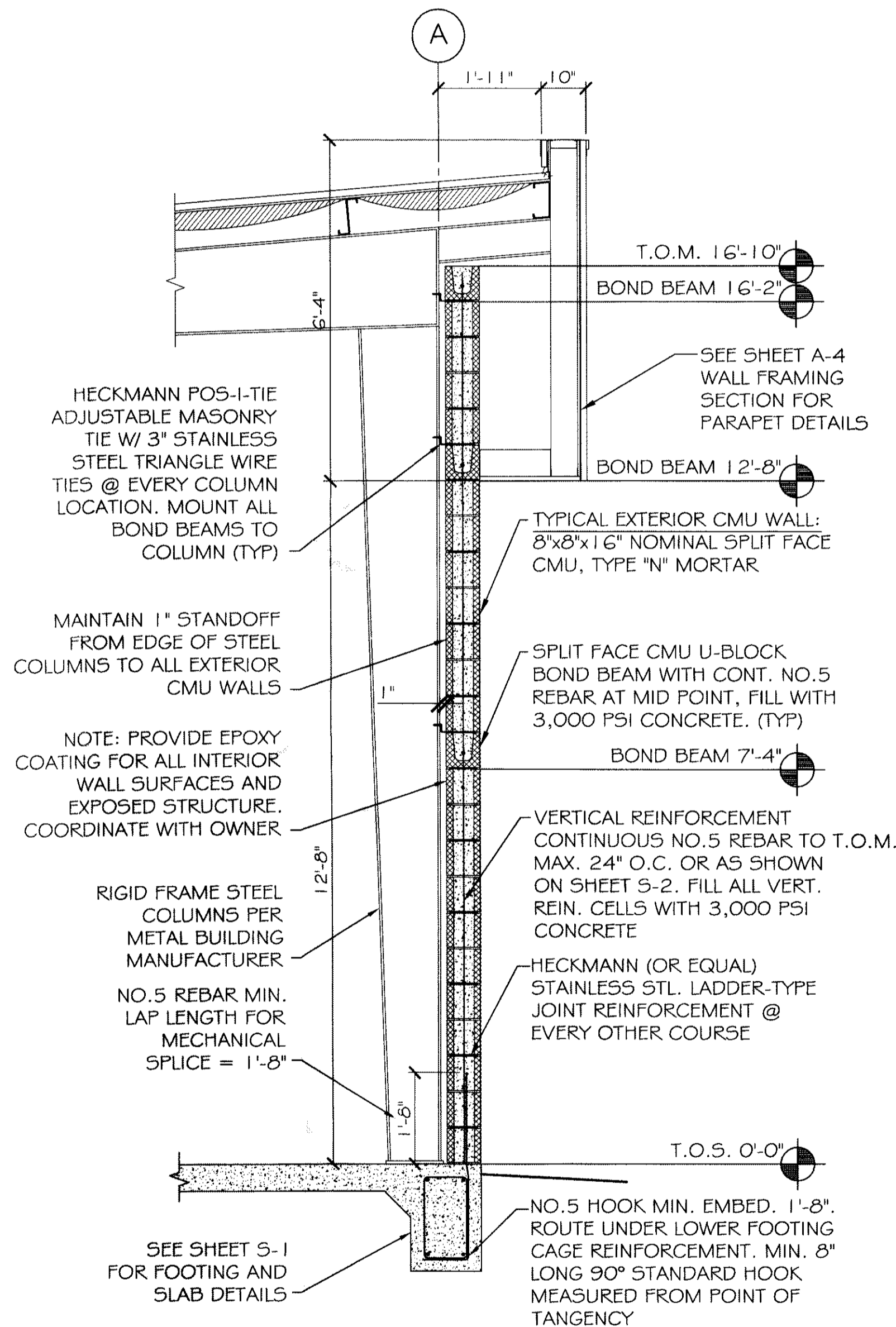
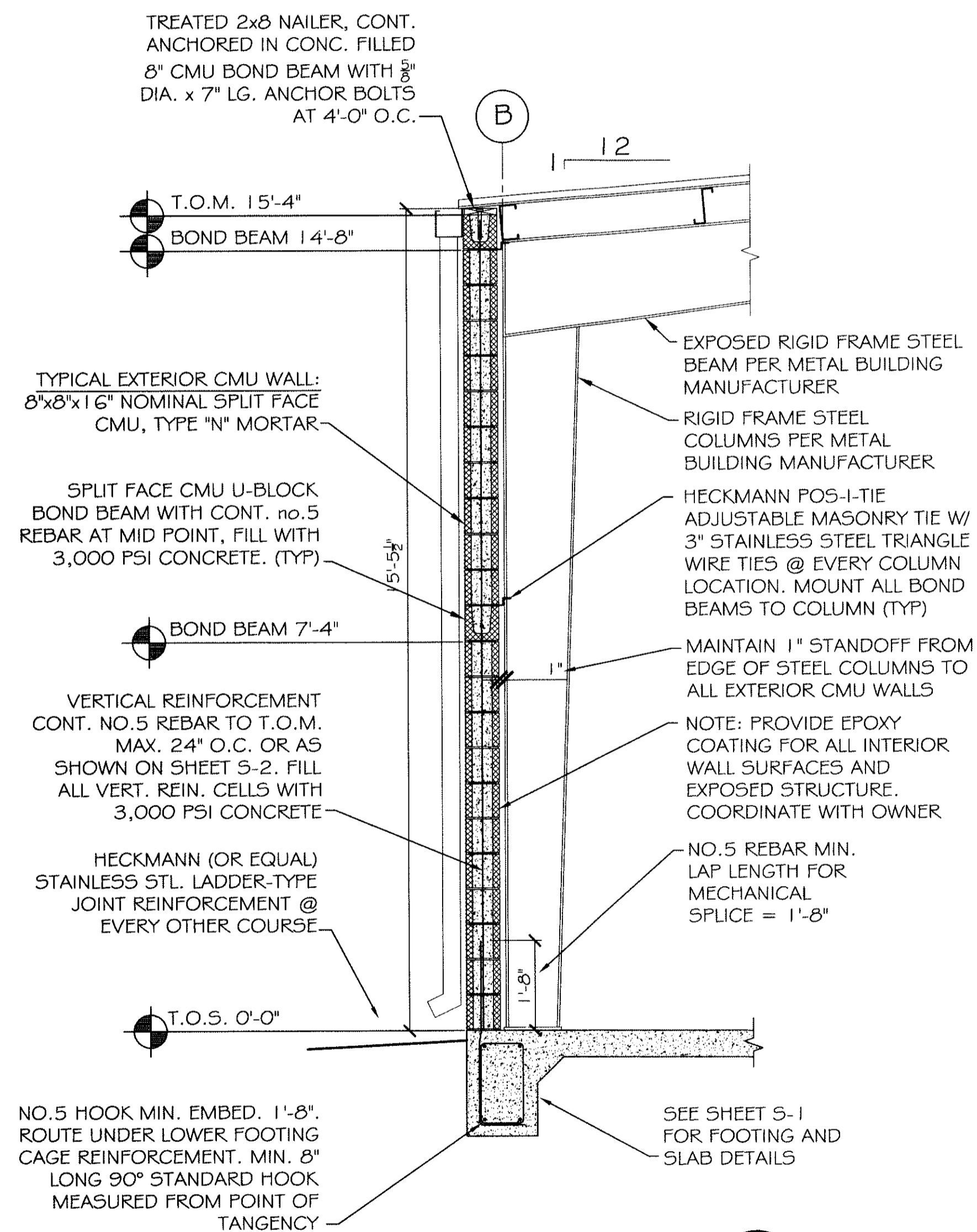

392868
 REVIEWED FOR
 STATE FIRE MARSHAL
 AS PER REVIEW LETTER
 BY: WILLIAM D. JONES, ARCHITECT, CGO
William D. Jones