

BASIC-1 TUNNEL WASH & GATE CONFIGURATION by G.C.

09.01.06

Notes:

- 1- Curb should be 6" in height.
- 2- Curb should have bollards (Ø6" X36" A.F.F.) at both ends to protect hardware.
- 3- Lanes between curbs should be 8'-6" ±6"
- 4- Loops provided by GC. Installation by G.C.

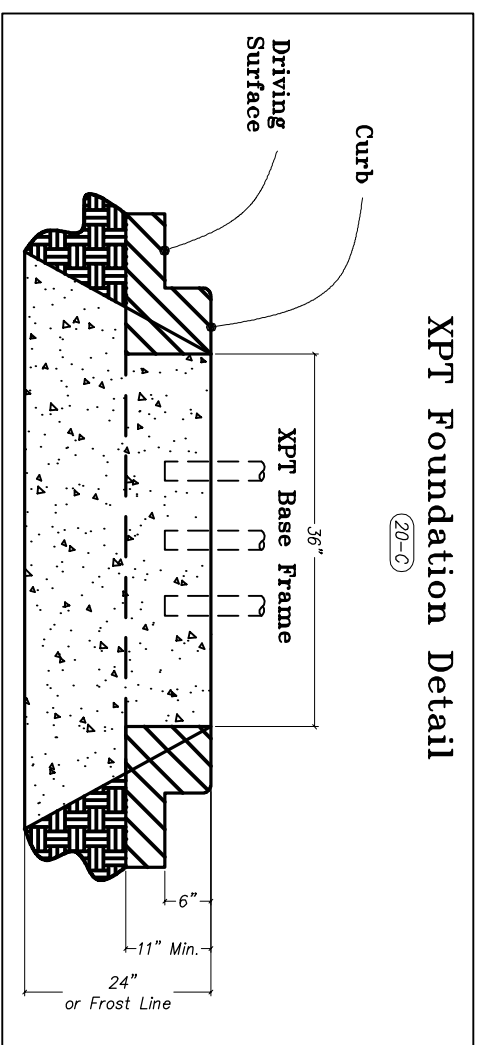

XPR Conduit Routing

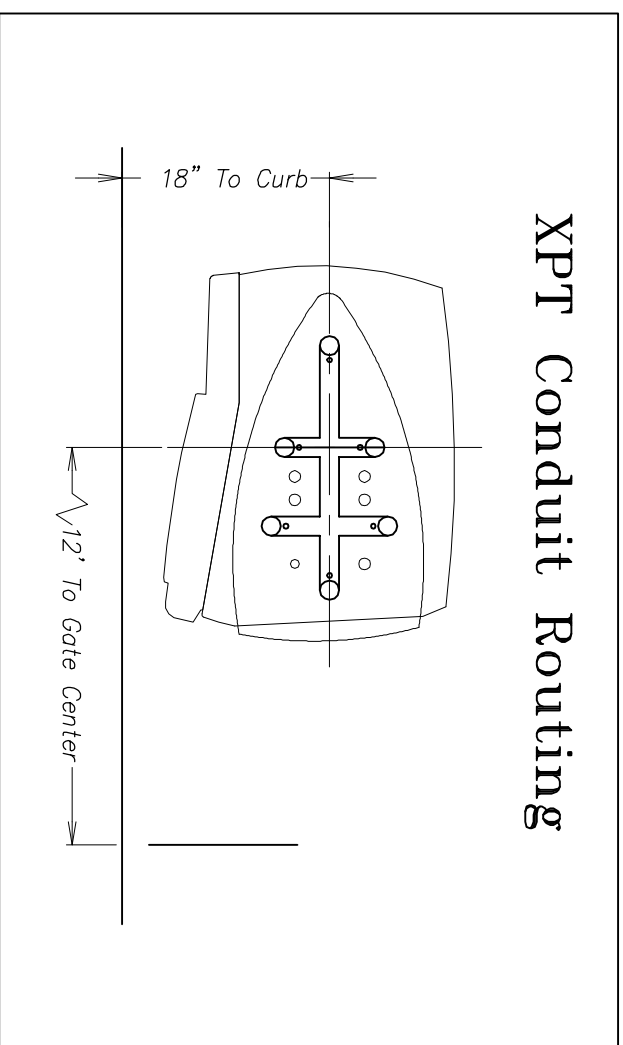

Template

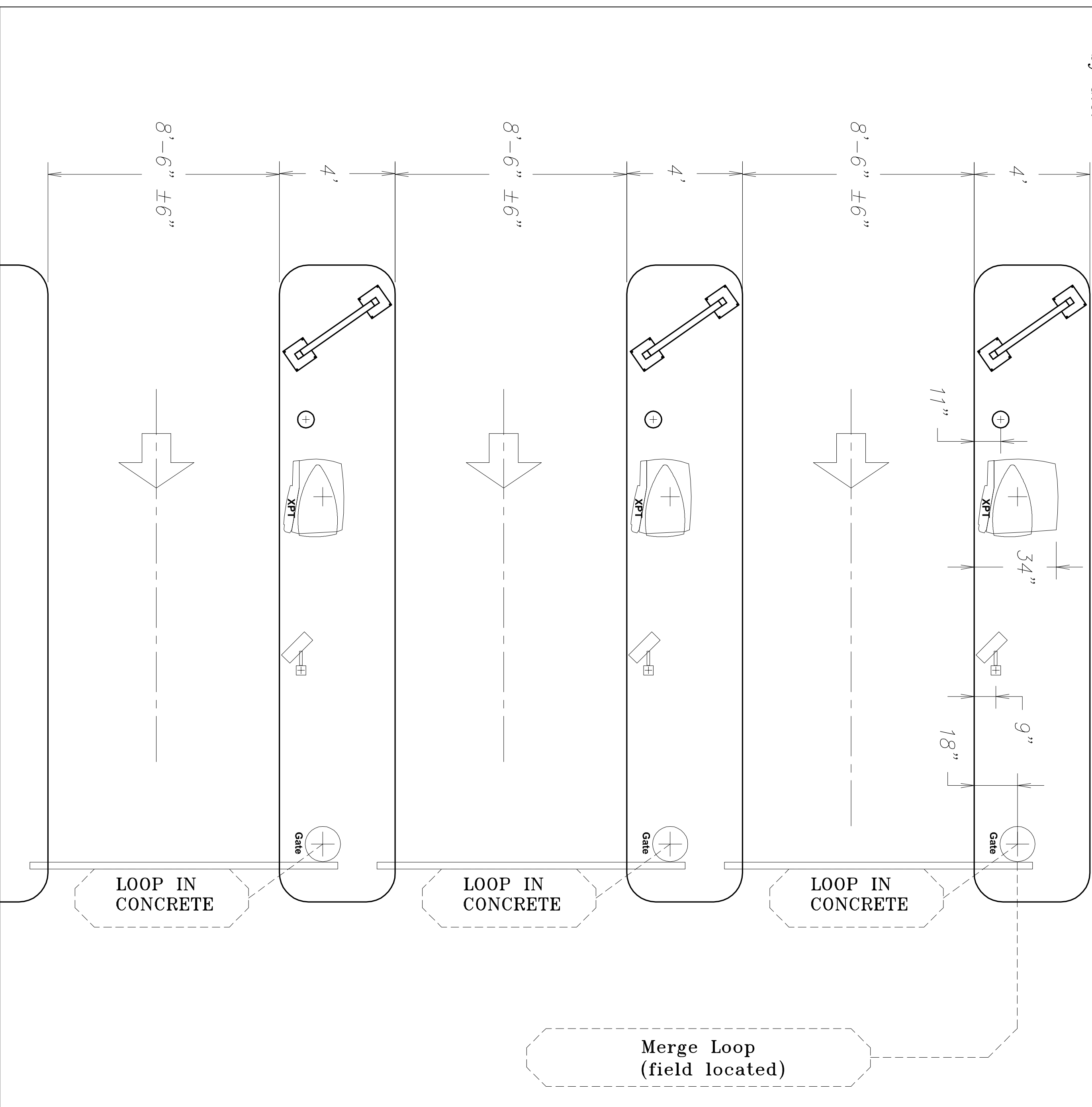
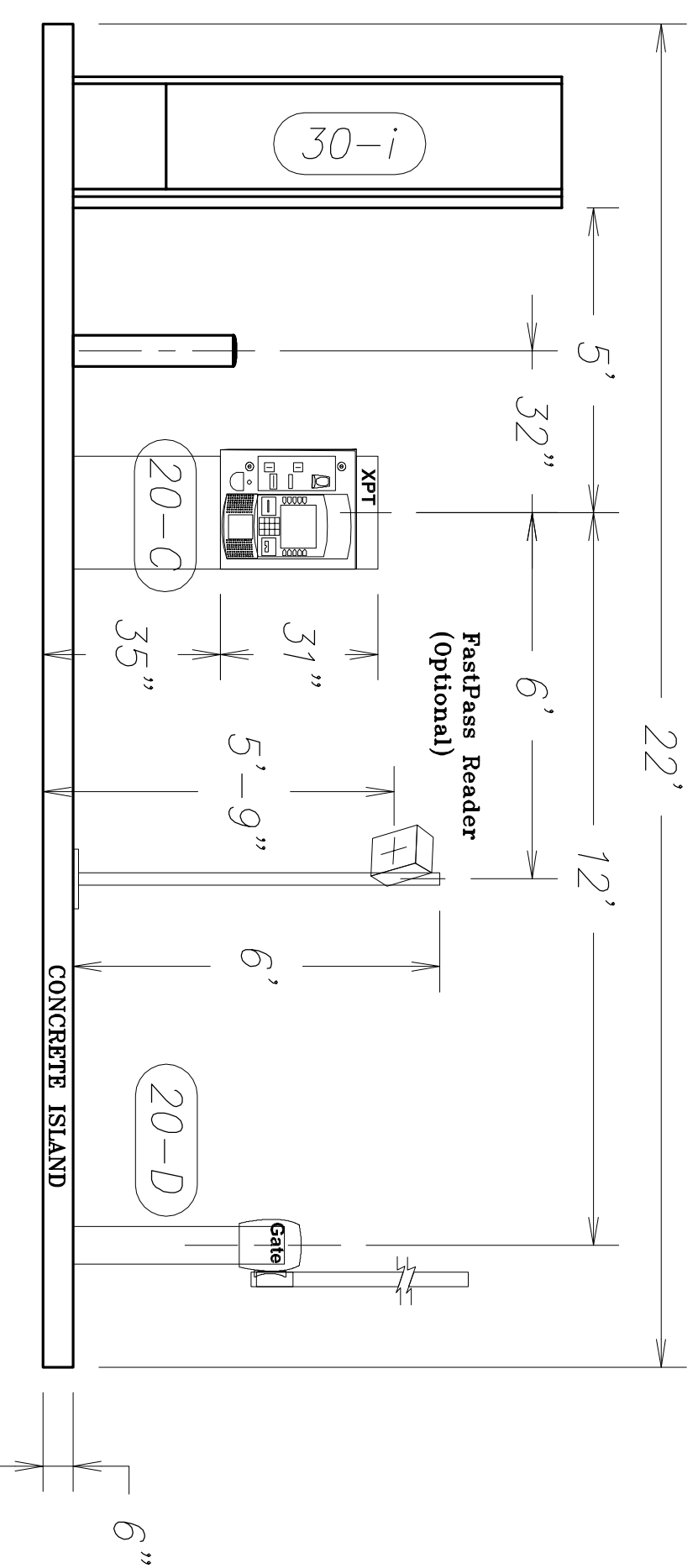
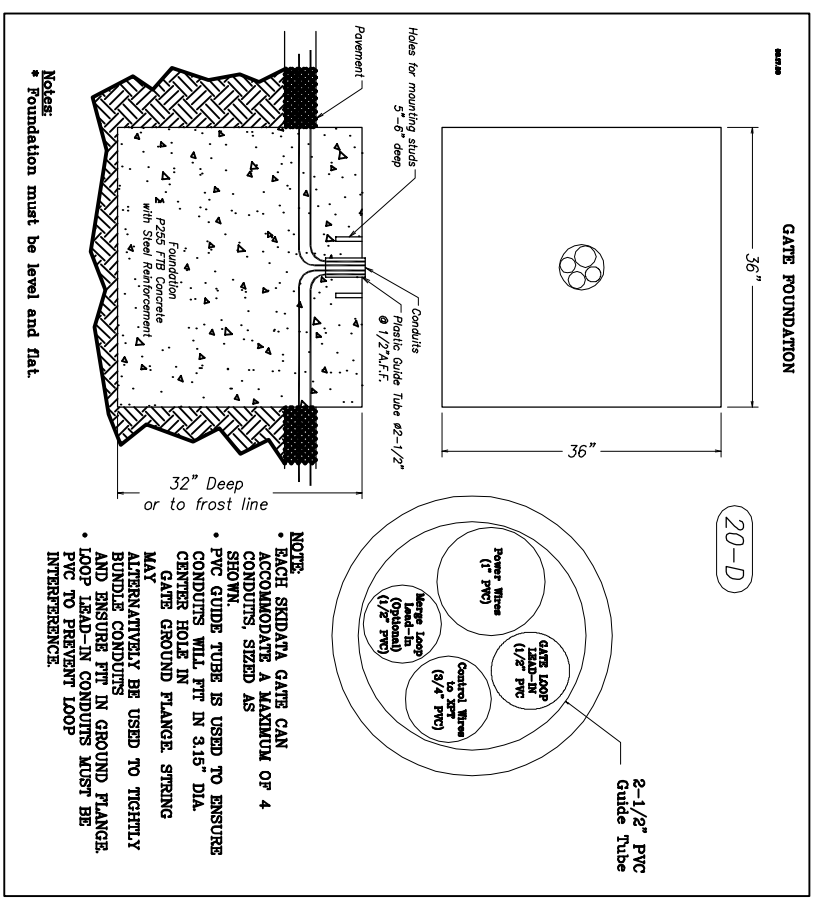
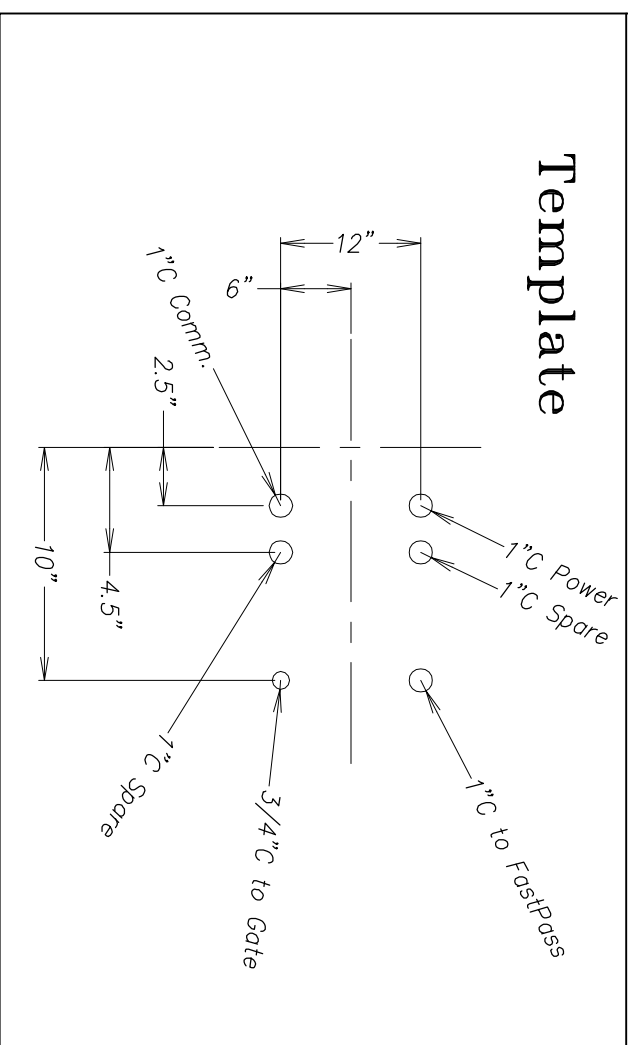

NOT FOR CONSTRUCTION UNTIL APPROVED BELOW.

APPROVED BY: _____ DATE _____

DISCLAIMER
ALTHOUGH BUILDING CODES HAVE BEEN CONSIDERED IN DEVELOPING THIS DRAWING, VERIFICATION OF SITE SPECIFIC CONDITIONS AND COMPLIANCE WITH FEDERAL, STATE AND LOCAL BUILDING CODES IS THE EXCLUSIVE RESPONSIBILITY OF THE CUSTOMER AND/OR ARCHITECT AND ENGINEER. THESE DRAWINGS REFLECT REQUIREMENTS FOR SONNNY'S FURNISHED EQUIPMENT ONLY UNLESS OTHERWISE NOTED. PLEASE REFER TO OTHER MANUFACTURERS, IF ANY, FOR THEIR EQUIPMENT REQUIREMENTS.

CONFIDENTIAL WARNING:
THIS SHEET CONTAINS AND CONSTITUTES CONFIDENTIAL INFORMATION, IMAGES AND TRADE SECRETS OF SONNNY'S ENTERPRISES INC. ANY UNAUTHORIZED USE OR DISCLOSURE OF ANY OR PORTION THEREOF, IS STRICTLY PROHIBITED. THIS WORK IS THE EXCLUSIVE PROPERTY OF SONNNY'S ENTERPRISES INC. ALL RIGHTS RESERVED.

CWP-06370-B11-RAINFOREST-HATT.
SCALE: N.T.S. LOCATION: LA

Sheet Rev. G.1 - 1