

SITE CONDITION NOTE:

DESIGN FOR RENOVATION WAS GAINED FROM INFORMATION PROVIDED BY OWNER. ACTUAL ON-SITE CONDITIONS MAY VARY. CONTRACTOR AND ALL SUBCONTRACTORS TO INSPECT ACTUAL CONDITIONS ON-SITE FOR VARIATIONS FROM DRAWINGS. HIGHLY OWNER AND ARCHITECT OF MAJOR VARIATIONS FROM DRAWINGS PRIOR TO CONSTRUCTION.

WALL LEGEND

- EXISTING TO REMAIN
- NEW

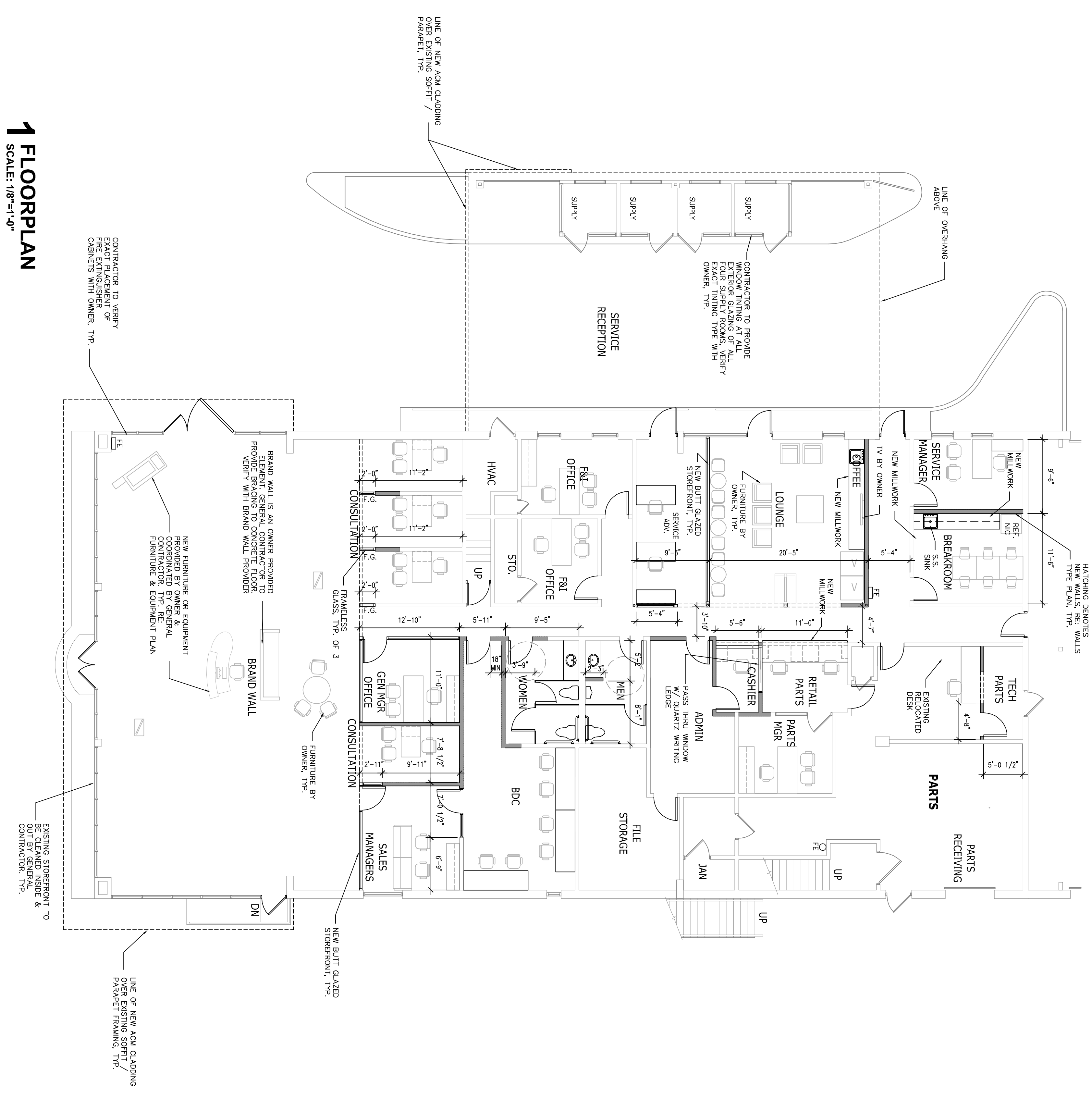

FLOORPLAN
SCALE: 1/8"=1'-0"

REVIEW SET

Sheet No. **A210**
Of

A Dealership Renovation For:
Lakeshore Kia
330 E Howze Beach Rd.
Slidell, Louisiana 70461

Job No:
Date: 5-11-16
Drawn: msl

REVISIONS

CRESS & LOPRESTO ARCHITECTS L.L.C.
A PROFESSIONAL ARCHITECTURAL COMPANY

10606 COURSEY BLVD., STE. A
BATON ROUGE, LOUISIANA 70816
(225) 930-6040 FAX (225) 930-6045

