

DOOR SCHEDULE

MK	WIDTH	HEIGHT	THK	DOOR MAT	FRAME MAT	FR	REMARKS
DO1	(2)3'-0"	7'-0"	1-3/4"	GLASS	STEEL	NR	EXISTING DOUBLE DOOR WITH CLOSURE
DO2	3'-0"	6'-8"	1-3/4"	STEEL	STEEL	NR	EXISTING BACK DOOR
DO3	2'-8"	6'-8"	1-3/4"	WOOD	STEEL	NR	EXISTING RESTROOM DOOR WITH CLOSURE
DO4	2'-8"	6'-8"	1-3/4"	WOOD	STEEL	NR	NEW RESTROOM DOOR WITH CLOSURE
DO5	3'-0"	6'-8"	1-3/4"	WOOD	STEEL	20 MIN	NEW DOORS WITH CLOSURE
DO6	3'-0"	6'-8"	-	-	STEEL	NR	EXISTING CASSED OPENING

NOTE: DOORS IN A REQUIRED MEANS OF EGRESS SERVING ANY ASSEMBLY AREA HAVING AN OCCUPANT LOAD OF 50 OR MORE PERSONS SHALL NOT BE EQUIPPED WITH A LATCH OR LOCK OTHER THAN PANIC HARDWARE OR FIRE EXIT HARDWARE.

GENERAL PLAN NOTES

- INSULATION AND INSULATION ASSEMBLIES SHALL MEET THE REQUIREMENTS OF IBC 2015 SECTION 120.
 - CONCEALED INSULATION SHALL HAVE A FLAME SPREAD OF 0-25 AND SMOKE DEVELOPED INDEX OF 0-450, EXCEPT THAT IN COMBUSTIBLE (WOOD FRAME) CONSTRUCTION.
 - FACING SHALL COMPLY WITH IBC 2015.
- ALL MATERIALS SHALL BE NEW AND UL LISTED.
- NO WORK SHALL BE CONCEALED UNTIL APPROVED BY LOCAL INSPECTORS.
- CONSTRUCTION SHALL COMPLY WITH ALL PARISH, STATE, AND LOCAL CODES.
- CONTRACTOR TO GUARANTEE WORK FOR ONE YEAR FROM DATE OF SUBSTANTIAL COMPLETION.
- CONTRACTOR SHALL FURNISH WATER AND POWER FROM EXISTING SOURCES.
- EXTERIOR CAULKING SHALL BE THICKAL CAULK.
- PAINT SHALL BE SHERWIN WILLIAMS OR EQUIVALENT AND APPROPRIATE FOR THE SUBSTRATE TO WHICH IT IS APPLIED AS RECOMMENDED BY PAINT MANUFACTURER. ALL WORK TO RECEIVE THREE COATS (ONE PRIMER COAT, TWO FINISH COATS) UNLESS OTHERWISE RECOMMENDED BY PAINT MANUFACTURER. COLORS TO BE SELECTED BY OWNER.
- PROVIDE CLEANUP ON A REGULAR BASIS. NO TRASH SHALL BE STORED INSIDE BUILDING PREMISES.
- ALL BATT INSULATION SHALL HAVE A CLASS "A" (0-25) FLAME SPREAD IN COMPLIANCE WITH IBC 2015.
- USE 2x6 WOOD STUDS, OR TWO 2x4 WOOD STAGGERED STUDS WITH 2x6 SILL PLATE AT ALL WALLS WHERE 4" PIPE IS INDICATED. SEE PLUMBING RISER DIAGRAM FOR PIPE SIZE.
- PROVIDE GALVANIZED METAL PAN WITH DRAIN AT ALL WATER HEATERS.
- ALL FLOORING SHALL MEET OR EXCEED ADA GUIDELINES REQUIREMENTS FOR SLIP RESISTANCE.
- INTERIOR LOCKS ON DOORS IN MEANS OF EGRESS SHALL NOT REQUIRE THE USE OF A KEY, SPECIAL KNOWLEDGE, OR SPECIAL DEVICE TO OPEN IN THE DIRECTION OF EGRESS. ALL DOORS SHALL HAVE LEVER TYPE HANDLES.
- INTERIOR WALLS AND CEILING SHALL HAVE A FLAME SPREAD OF 0-200 AND A SMOKE DEVELOPMENT RATINGS OF 0-450.
- ALL NEW WORK SHALL COMPLY WITH THE LATEST EDITION OF ALL LOCAL, STATE, AND NATIONAL CODES COVERING THE TYPE OF WORK BEING PERFORMED.
- PROVIDE PORTABLE FIRE EXTINGUISHERS IN ACCORDANCE WITH NFPA 101, SEE APPENDIX 'E' OF NFPA 101 FOR DISTRIBUTION OF EXTINGUISHERS.
- ALL FIRE WALLS SHALL EXTEND TIGHT TO ROOF DECK AND BE SEALED WITH AN APPROVED FIRE CAULK.
- ALL ELECTRICAL, MECHANICAL, AND PLUMBING MATERIALS PENETRATING FIRE WALLS SHALL BE FIRE CAULKED. (PENETRATIONS THROUGH RATED CONSTRUCTION SHALL BE SEALED WITH A MATERIAL CAPABLE OF PREVENTING THE PASSAGE OF FLAMES AND HOT GASES WHEN TESTED IN ACCORDANCE WITH ASTM-E814.)
- SERVICE COUNTERS SHALL HAVE AN ACCESSIBLE WRITING SURFACE IN COMPLIANCE WITH ADAAG ACCESSIBILITY GUIDELINES 2010, SECTION 902.3.

LIGHTING LEGEND

- EXISTING CEILING MOUNTED EXIT LIGHT
- NEW CEILING MOUNTED EXIT LIGHT
- EXISTING EMERGENCY LIGHT
- NEW EMERGENCY LIGHT
- EXISTING 2X4 LIGHT FIXTURE
- NEW 2X4 LIGHT FIXTURE
- NEW 6" RECESSED LIGHT FIXTURE
- EXISTING 6" FLUORESCENT LIGHT FIXTURE

NOTE: REUSE EXISTING LIGHTS. REPLACE MISSING OR DAMAGED LIGHTS

MECHANICAL LEGEND

- EXISTING SUPPLY AIR GRILLE
- NEW SUPPLY AIR GRILLE
- EXISTING RETURN AIR GRILLE
- NEW RETURN AIR GRILLE
- NEW EXHAUST FAN

NOTE: REUSE EXISTING DUCTS. REPLACE MISSING OR DAMAGED EQUIPMENT

CEILING LEGEND

- EXISTING 2X4 SUSPENDED CEILING GRID
- NEW SHEET ROCK

NOTE: REUSE EXISTING CEILING GRID. REPLACE MISSING OR DAMAGED TILES

WALLS AND INTERIOR PARTITIONS, WOOD FRAMED

GA FILE NO. WP 3241	PROPRIETARY*	1 HOUR FIRE	50 to 54 STC SOUND
GYPSUM WALLBOARD, RESILIENT CHANNELS, MINERAL FIBER INSULATION, WOOD STUDS			
Resilient channels 24" o.c. attached at right angles to ONE SIDE of 2 x 4 wood studs 16" or 24" o.c. with 1 1/4" Type S drywall screws. One layer 1/2" proprietary type X gypsum wallboard or gypsum veneer base applied parallel to channels with 1" Type S drywall screws 12" o.c. End joints backblocked with resilient channels. 3" mineral fiber insulation, 2.0 or 2.3 pcf, in stud space.			
OPPOSITE SIDE: One layer 1/2" proprietary type X gypsum wallboard or gypsum veneer base applied at right angles to studs with 1 1/4" Type W drywall screws 12" o.c. Vertical joints staggered 48" on opposite sides. Sound tested with studs 16" o.c. and open face of mineral fiber insulation blankets toward resilient channel-side of stud space. (LOAD-BEARING)			
PROPRIETARY GYPSUM BOARD			
American Gypsum Company LLC	-	1/2" FireBloc® Type C	
CertainTeed Gypsum Inc.	-	1/2" ProRock® Type C Gypsum Panels	
CertainTeed Gypsum Canada Inc.	-	1/2" ProRock® Type C Gypsum Panels	
Georgia-Pacific Gypsum LLC	-	1/2" ToughRock® Fireguard C™	
Lafarge North America Inc.	-	1/2" Firecheck® Type C	
National Gypsum Company	-	1/2" Gold Bond® Brand FIRE-SHIELD C™	
		Gypsum Board	
PABCO Gypsum	-	1/2" FLAME CURB® Super C™	
Temple-Inland	-	1/2" TG-C	

BXUV.U906
Fire Resistance Ratings - ANSI/UL 263
Fire Resistance Ratings - ANSI/UL 263
Design No. U906
March 17, 2004

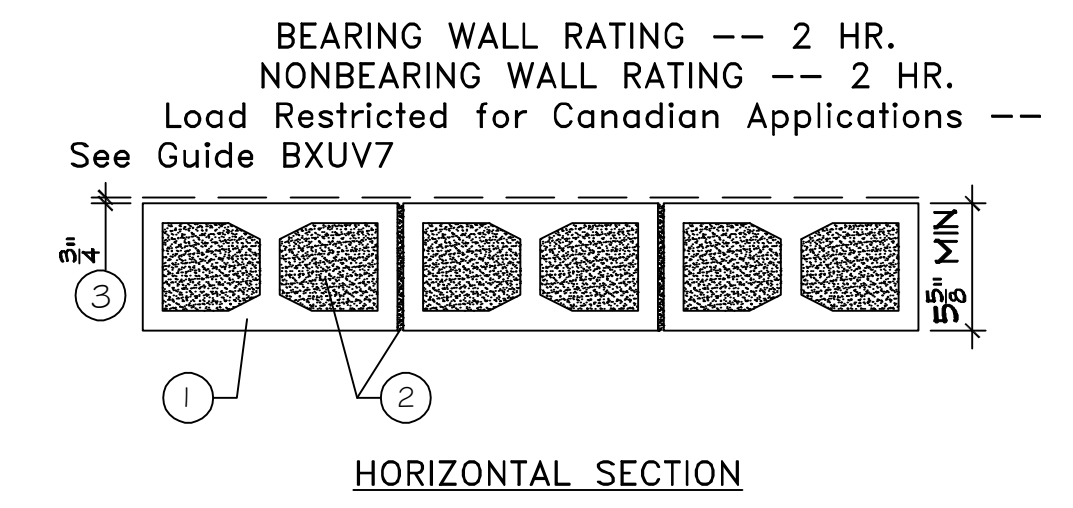

- Concrete Blocks* -- Nominal 6 by 8 by 16 in, hollow or solid. Classification D-2 (2 hr). ANCHOR CONCRETE PRODUCTS INC GAGNE & SON CONCRETE BLOCK INC
Allowable compressive stress of 57% of max allowable compressive stress in accordance with the empirical design method.
- Mortar -- Blocks laid in full bed of mortar, nom. 3/8 in. thick, of not less than 2-1/4 and not more than 3-1/2 parts of clean sharp sand to 1 part Portland cement (proportioned by volume) and not more than 50 percent hydrated lime (by cement volume). Vertical joints staggered.
- Portland Cement Stucco or Gypsum Plaster -- Add 1/2 hr to Classification if used. Attached to concrete blocks (Item 1).
- Foamed Plastic* -- (Optional-Not Shown) -- 1-1/2 in. thick max, 4 ft wide sheathing attached to concrete blocks (Item 1). THE DOW CHEMICAL CO -- Type Thermax

*Bearing the UL Classification Mark
Last Updated on 2004-03-17

DAMMON ENGINEERING, INC.
LOUISIANA & MISSISSIPPI
www.dammonengineering.com
info@dammonengineering.com
554 Old Spanish Trail
Slidell, LA 70458
Chief Engineer: Brian Metch, PE
Civil Engineer: Brian Metch, PE
554 Old Spanish Trail
Slidell, LA 70458
PH: 985.649.5832 F: 985.641.5950

REVISIONS	DATE	DESCRIPTION

LESIA CRISTIANA
SINCE DE CRISTO
1000 CARIBOU BLVD.
BUILDING 1 UNIT 169
SLIDELL, LA 70461
JOB NO: 2454 DATE: 12/07/2021
DRAWN BY: JAS
CHECKED BY: JAS

SHEET TITLE:
FLOOR AND REFLECTED
CEILING PLAN PLAN
DRAWING NUMBER:
A101
SHEET No: 3 of 5