

□ - DENOTES: FLAT WASHERS

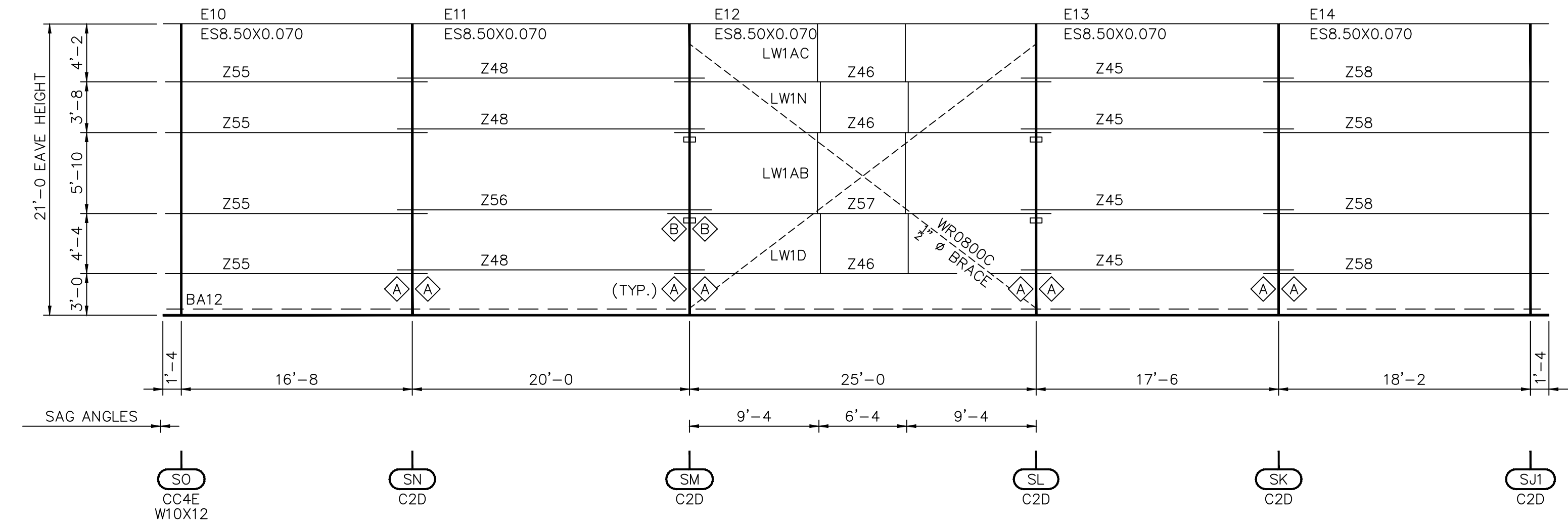

ALL Z'S ARE Z8.50X0.059
UNLESS NOTED OTHERWISE

ELEVATION "D"
BUILDING "B"
(PHASES "1" AND "Z")

FIELD MITER PERIMETER
TRIM CORNERS AND PEAK
BOXES, MAKE WATER TIGHT

(5) NG49-1
(34) NG70-2
(34) NG73-1

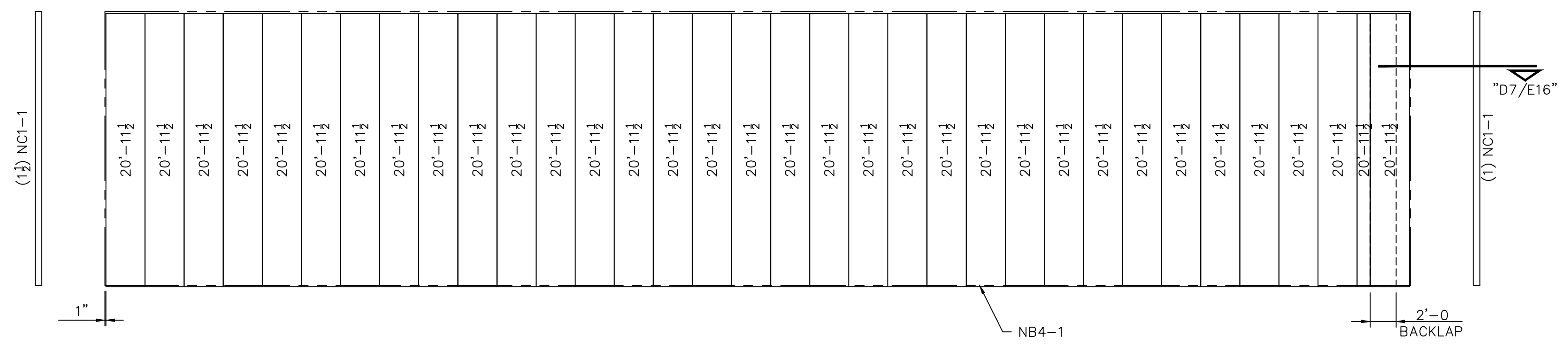

WALL SHEETING ELEVATION "D"
BLDG B
(PHASES "2")

| SYMBOL | LAP | SYMBOL | LAP | SYMBOL | LAP |
|--------|-----------|--------|---------------|--------|-----------|
| ⬠ | 1'-1" LAP | ⬡ | 3'-2 1/4" LAP | ⬢ | 4'-7" LAP |
| ⬤ | 1'-7" LAP | ⬣ | 3'-7" LAP | ⬥ | 5'-1" LAP |
| ⬦ | 2'-1" LAP | ⬧ | 4'-1" LAP | ⬨ | 5'-7" LAP |
| ⬩ | 2'-7" LAP | ⬪ | 2 1/2" LAP | | |

| Revision | Date | Description |
|----------|----------|---|
| F1 | 08/09/11 | FINAL DRAWINGS COMPLETE FOR PHASE 1 AND Z |
| F2 | 08/31/11 | FINAL DRAWINGS COMPLETE ALL PHASES |

STAR BUILDING SYSTEMS
An NCI Company
P.O. BOX 94910
OKLAHOMA CITY, OK 73143
(405) 656-2010

Project Name & Location:
PINNACLE CASINO -
MANHATTAN CONSTRUCTION
BATON ROUGE, LA

Customer:
CASEY CIVIL LLC
COMMERCIAL
MANDEVILLE, LA

Drawing Status:
 Preliminary
 For Approval
 For Construction Permit
 For Erector Installation

Scale: NOT TO SCALE
 Drawn by: LSI
 Checked by: LSA
 Project Engineer: AK
 Job Number: 12-B-63841
 Sheet Number: E7 of 16

The engineer whose seal appears hereon is an employee for the manufacturer for the materials described herein. Said seal or certification is limited to the products designed and manufactured by manufacturer only. The undersigned engineer is not the overall engineer of record for this project.

BRIAN A. CARMICHAEL, P.E.
Louisiana P.E. 33110

