

BEARING FRAME ENDWALL	
COLUMN TOP CONNECTION	SHEET #
TYPE I AT SLOPE W/PC64	18.04
TYPE I AT SLOPE W/PC65	18.05
TYPE I AT SLOPE W/PC71	18.06
TYPE I AT PEAK W/PC64	18.09
TYPE II AT SLOPE W/PC71	18.14
TYPE II AT SLOPE W/PC73	18.15
TYPE II AT PEAK W/PC71	18.14

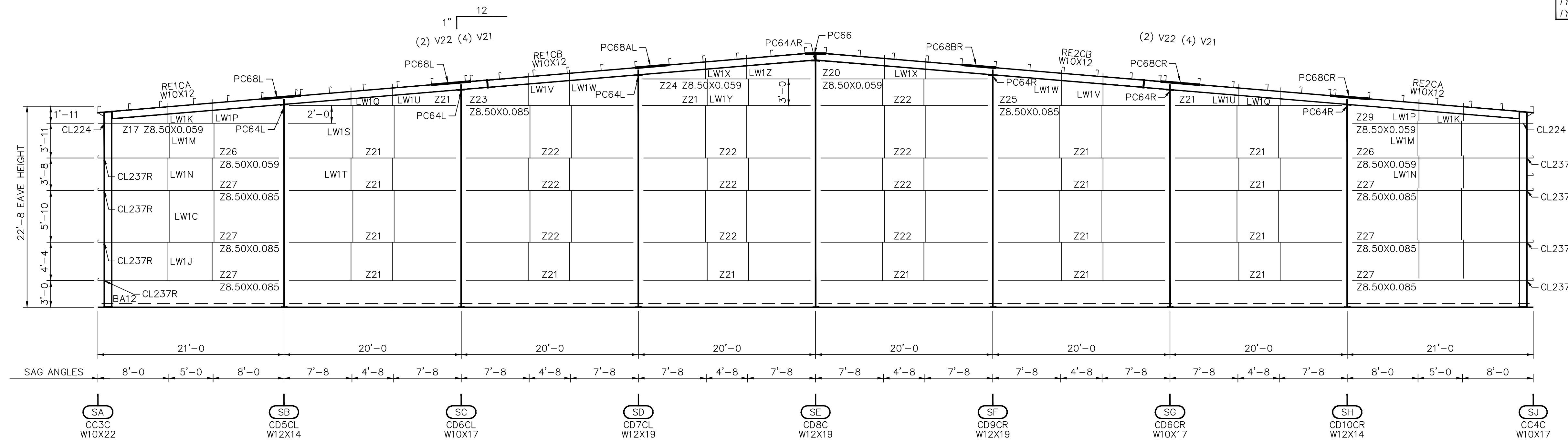

ALL Z'S ARE Z8.50X0.070 UNLESS NOTED OTHERWISE

\* DENOTES: PLATE AT FLANGE BRACE  
CL180 AT 8" PURLINS/GIRTS  
CL181 AT 10" PURLINS/GIRTS  
CL182 AT 12" PURLINS/GIRTS

- ONE \* FB4A @ 7'-4" LEFT
- ONE \* FB4A @ 13'-2" LEFT
- ONE \* FB4A @ 16'-10" LEFT
- ONE \* FB4A @ 22'-9" LEFT

ELEVATION "B"  
BUILDING "A"  
(PHASES "1" AND "2")

FIELD MITER PERIMETER TRIM CORNERS AND PEAK BOXES, MAKE WATER TIGHT

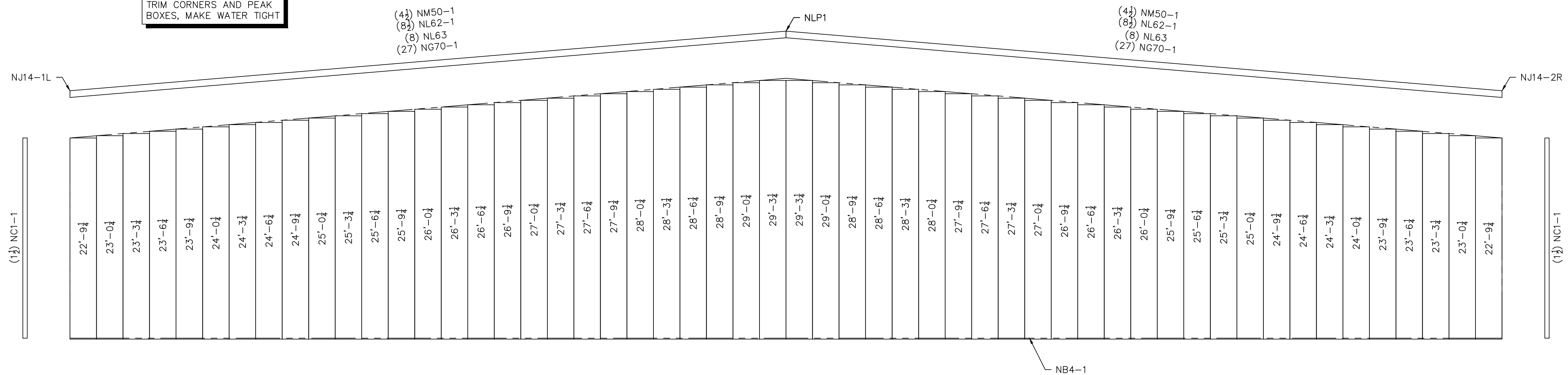

WALL SHEETING ELEVATION "B"  
BLDG A  
(PHASES "2")

Revision	Date	Description
F1	08/09/11	FINAL DRAWINGS COMPLETE FOR PHASE 1 AND Z LSI
F2	08/31/11	FINAL DRAWINGS COMPLETE ALL PHASES

**STAR BUILDING SYSTEMS**  
An NCI Company

P.O. BOX 94910  
OKLAHOMA CITY, OK 73143  
(405) 656-2010

**Project Name & Location:**  
PINNACLE CASINO -  
MANHATTAN CONSTRUCTION  
BATON ROUGE, LA

**Customer:**  
CASEY CIVIL LLC  
COMMERCIAL  
MANDEVILLE, LA

**Drawing Status:**  
 Preliminary  
 For Approval  
 For Construction Permit  
 For Erector Installation

Scale: NOT TO SCALE  
 Drawn by: LSI  
 Checked by: LSA  
 Project Engineer: AK  
 Job Number: 12-B-63841  
 Sheet Number: EB of 16

The engineer whose seal appears hereon is an employee for the manufacturer for the materials described herein. Said seal or certification is limited to the products designed and manufactured by manufacturer only. The undersigned engineer is not the overall engineer of record for this project.

BRIAN A. CARMICHAEL, P.E.  
Louisiana P.E. 33110

