

A SEWER SURVEY OF BRIDGE CITY CENTER FOR YOUTH
 PORTION OF FAIRFIELD PLANTATION T 13 S, R 23 E,
 SECTIONS 2 AND 3; WITHIN JEFFERSON PARISH, LA.

1. THE LOCATIONS OF UNDERGROUND AND OTHER NONVISIBLE UTILITIES SHOWN HEREON HAVE BEEN DETERMINED FROM DATA EITHER FURNISHED BY THE AGENCIES CONTROLLING SUCH DATA AND/OR EXTRACTED FROM RECORDS MADE AVAILABLE TO US BY THE AGENCIES CONTROLLING SUCH RECORDS. WHERE FOUND, THE SURFACE FEATURES OF LOCATIONS ARE SHOWN. THE ACTUAL NONVISIBLE LOCATIONS MAY VARY FROM THOSE SHOWN HEREON. EACH AGENCY SHOULD BE CONTACTED RELATIVE TO THE PRECISE LOCATION OF ITS UNDERGROUND INSTALLATION PRIOR TO ANY RELIANCE UPON THE ACCURACY OF SUCH LOCATIONS SHOWN HEREON, INCLUDING PRIOR TO EXCAVATION AND DIGGING.
2. ALL ELEVATIONS SHOWN REFER TO NAVD 88 DATUM, 2009 GEIOD.
3. NOTE: THE UNDERSIGNED DOES NOT CERTIFY TO THE LOCATION OF THE ANY IMPROVEMENTS SHOWN OTHER THAN THE LOCATION OF THE ABOVE GROUND SEWER AS SHOWN.

BFM Corporation
 Professional Land Surveying

1011 NORTH CAUSEWAY BLVD., SUITE 16
 WEBSITE: BFM-CORPORATION.COM
 OFFICE (985)-778-0751
 FAX NO. (985)-778-0752
 CITY OF MANDEVILLE
 ST. TAMMANY PARISH, LOUISIANA, 70471

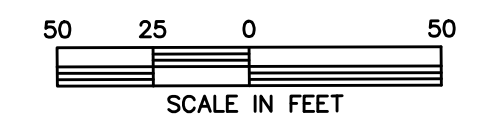
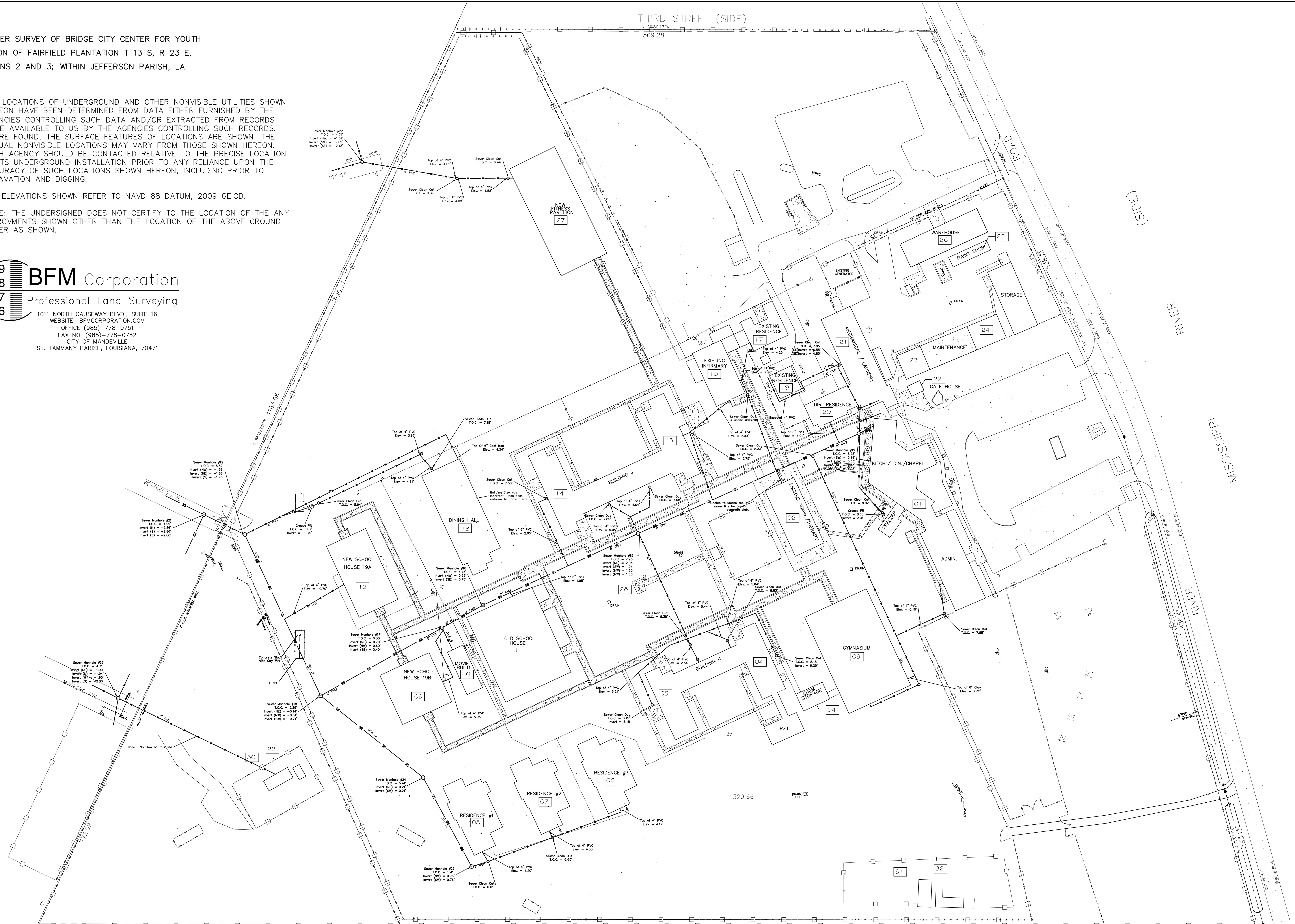

SEWER SURVEY
 SCALE: 1" = 50'

DAMMON ENGINEERING, INC.
Architects & Engineers

CHIEF ENGINEER: BRIAN WISTICH, P.E.
 CHIEF ARCHITECT: KEVIN KIRCHEN
 554 OLD SPANISH TRAIL
 SUDELL, LA 70456

**SEWER SYSTEM RENOVATION
 BRIDGE CITY CENTER FOR YOUTH**
 PROJ. NO. 05-403-11-01 PART 1
 322 RIVER ROAD
 BRIDGE CITY, LA 70094

JOB No: 2156 DATE: 6/10/2014 CHECKED BY: BM
 DRAWN BY: DPD

#	DESCRIPTION	REVISIONS	DATE

STATE OF LOUISIANA
 BRIAN A. WISTICH
 License No. 39187
 6/10/2014

SEWER SURVEY

SHEET No: 02 OF 08

C-1