

1ST STREET

X 6.41

150.00'

60.00'

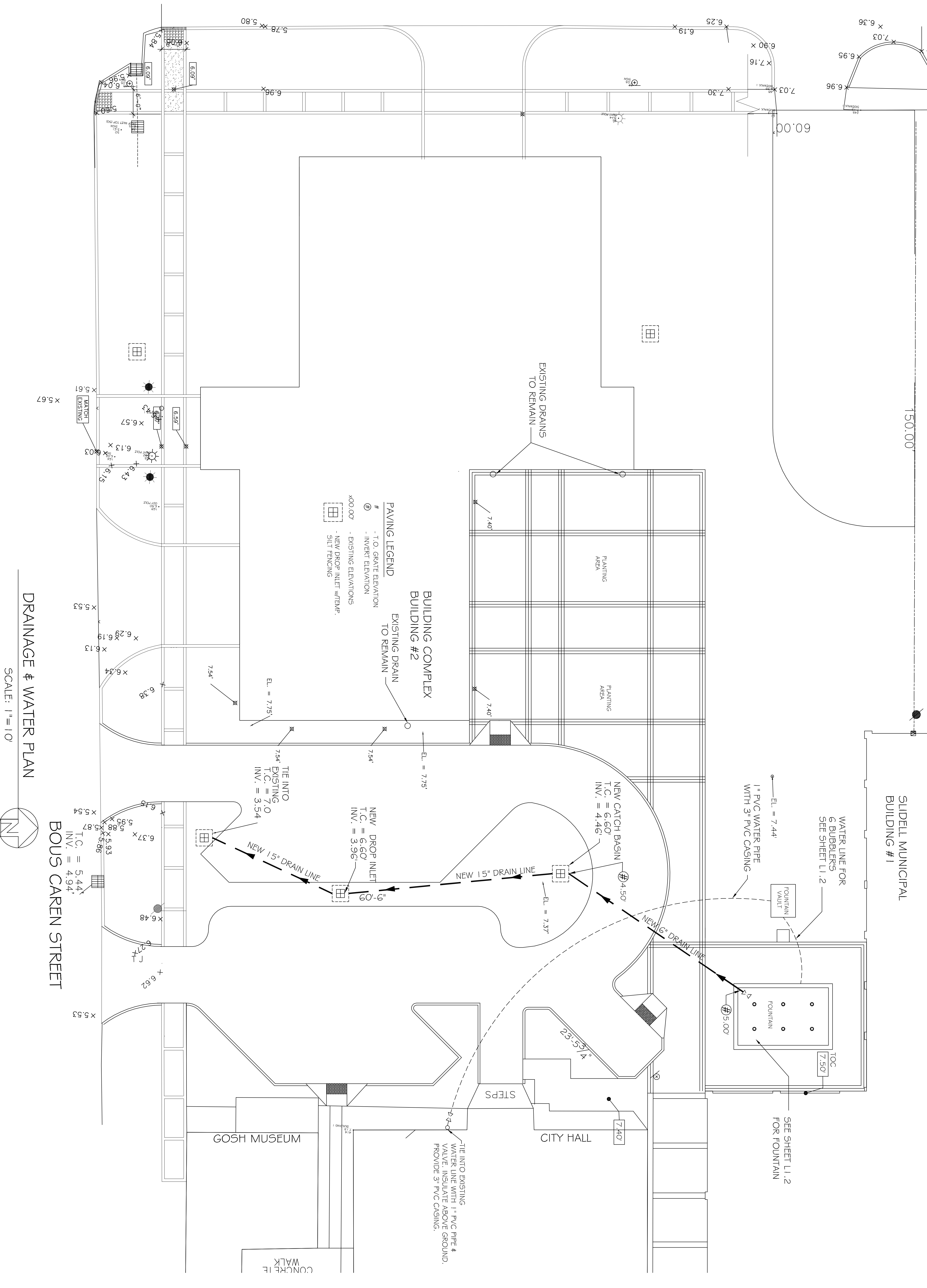

PAVING LEGEND
 # - T.O. GRATE ELEVATION
 ⊕ - INVERT ELEVATION
 000.00' - EXISTING ELEVATIONS
 □ - NEW DROP INLET w/EMP.
 □ - SILT FENCING

BUILDING COMPLEX BUILDING #2
 EXISTING DRAIN TO REMAIN

EXISTING DRAINS TO REMAIN

PLANTING AREA

PLANTING AREA

SUIDELL MUNICIPAL BUILDING #1

WATER LINE FOR 6 BUBBLERS SEE SHEET L1.2

1" PVC WATER PIPE WITH 3" PVC CASING

FOUNTAIN VAULT

FOUNTAIN

SEE SHEET L1.2 FOR FOUNTAIN

TOC

CITY HALL

GOSH MUSEUM

BOUIS CAREN STREET

DRAINAGE & WATER PLAN

SCALE: 1" = 10'

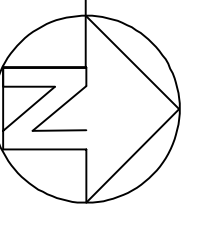

REVISIONS	
#	DESCRIPTION

CITY HALL PARKING LOT & COURTYARD

BOUIS CAREN STREET
 SUIDELL, LA

JOB No:	2172	DATE:	04-15-13
DRAWN BY:	CKD	CHECKED BY:	CKD



DAMMON ENGINEERING, INC.
 Architects & Engineers

CHIEF ENGINEER: ENMETT DAMMON, P.E.
 CHIEF ARCHITECT: KEVIN KINCHEN
 554 OLD SPANISH TRAIL
 SUIDELL, LA 70458
 dammonengineering.com
 dammoneng@bellsouth.net
 PHONE: 985-649-5832
 FAX: 985-641-5950

SHEET No: 3 OF 8
C2

DRAINAGE & WATER PLAN