

LEGEND

- EXISTING RIGHT OF WAY
- OLVERT
- DROP INLET DRAIN LINE
- DROP INLET DRAIN LINE
- GAS MANHOLE, GAS LINE
- SEWER MANHOLE, SEWER LINE
- TELEPHONE MANHOLE, TELE LINE
- TRAFFIC MANHOLE, TRAFFIC LINE
- WATER MANHOLE, WATER LINE
- UTILITY POLE / OVERHEAD LINES
 ELECTRIC, TELEPHONE, CABLE, TV
- FENCE
- SEWER CLEANOUT
- WATER METER
- UTILITY PEDESTAL
- UTILITY VALVE
- UTILITY VALVE VAULT
- FIRE HYDRANT
- LIGHT STANDARD
- SIGN
- TREE
- RESIDENTIAL MAILBOX
- PP DEWMAN
- CONCRETE HATCH/DRIVEWAY
- GRAVEL HATCH/DRIVEWAY
- SPOT ELEVATION

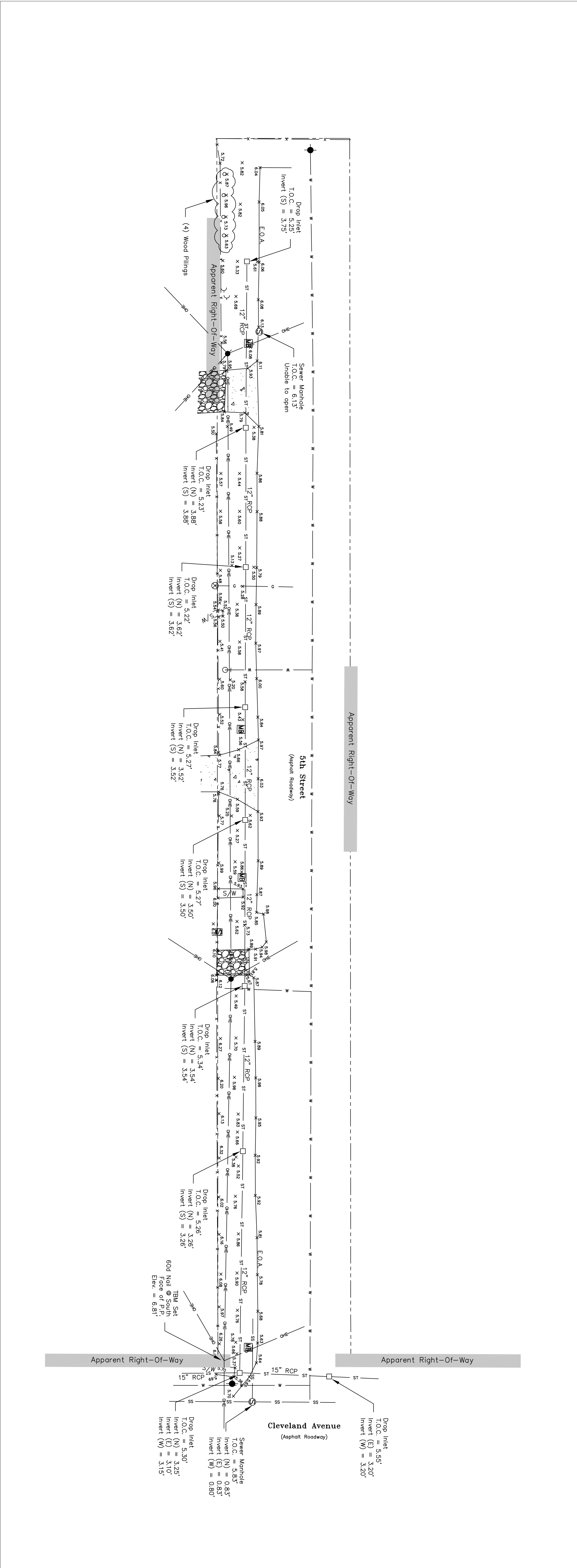

GENERAL NOTES

The servitudes and restrictions shown on this survey are limited to those set forth in the description furnished us and there are no other servitudes or restrictions shown hereon. The surveyor has made no title search or public record search in compiling the data for this survey.

I have consulted the Federal Insurance Maps and found this property is in a Special Flood Hazard Area.

FRM 309E-AE
 BRSE FLOOD ELEV. = 9'

COMMUNITY PANEL NO. 220204 0010 C
 MAP DATED/REVISED: APRIL 21, 1999

THE LOCATIONS OF UNDERGROUND AND OTHER NONVISIBLE UTILITIES SHOWN HEREON HAVE BEEN DETERMINED FROM DATA EITHER FURNISHED BY THE AGENCIES OR INCLUDING SPOT DATA AND/OR EXTRACTED FROM RECORDS MADE BY AGENCIES OR FROM FIELD SURVEYS. THE SURFACE FEATURES OF LOCATIONS ARE SHOWN. THE ACTUAL NONVISIBLE LOCATIONS MAY VARY FROM THOSE SHOWN HEREON. EACH AGENCY UNDERGROUND INSTALLATION PRIOR TO ANY RELIANCE UPON THE ACCURACY OF SUCH LOCATIONS SHOWN HEREON, INCLUDING PRIOR TO EXCAVATION AND DIGGING.

ALL ELEVATIONS SHOWN REFER TO NAD 83 DATUM, 2009 GEIOD.

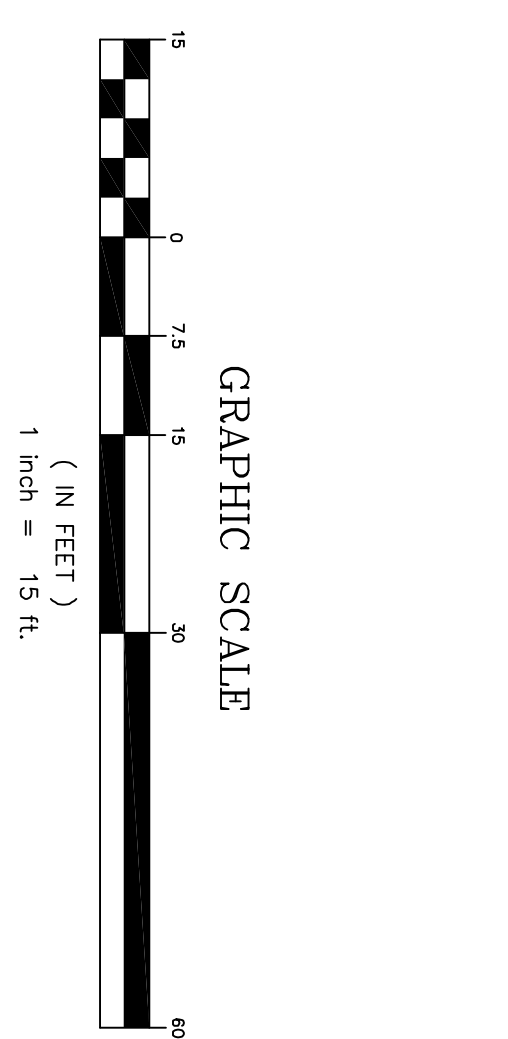

A TOPOGRAPHIC SURVEY OF WASHINGTON AVENUE FROM ELEANOR STREET TO THE END OF WASHINGTON AVENUE JUST PAST TUPELO STREET, LOCATED WITHIN LINCOLN PARK ADDITION TO THE TOWN OF SLIDELL, SECTION 15, T-9-S, R-14-E, ST. TAMMANY PARISH, LOUISIANA.

I certify that this plot represents an actual ground survey made by me or under my direction, and it does not conform to the requirements for the Minimum Standards for Property Boundary Surveys as found in Louisiana Administrative Code TITLE 48: LXI, Chapter 29 for a Class C survey.

CITY OF SLIDELL

BAM
 CORPORATION, L.L.C.
 Professional Land Surveyors
 534 WILLIAMS BOULEVARD
 E-mail: bfmcorp@bfmcorporation.com
 (504) 467-0000
 Fax No. (504) 467-0065
 JOHN S. KENNEDY
 CITY OF KENNESAW
 LISTED
 JEFFERSON PARISH, LOUISIANA, 70062

REGISTERED PROFESSIONAL LAND SURVEYOR
 JOHN S. TEEGARDEN
 REGISTRATION NO. 46355

MARK	DESCRIPTION	DATE	BY	CHK'D

SCALE: 1" = 15'

DATE: 2012

DRAWN BY: J.B.M.

CHECKED BY: J.B.M.

PROJECT NO. 7731 DRAWING NO. 7731

SHEET 5 OF 6