

NOTE: FILLET WELD ALL AROUND FOR ALL STRUCTURAL CONNECTIONS

**PARTITION SUPPORT DETAIL**

SCALE: 3/8"=1'-0"

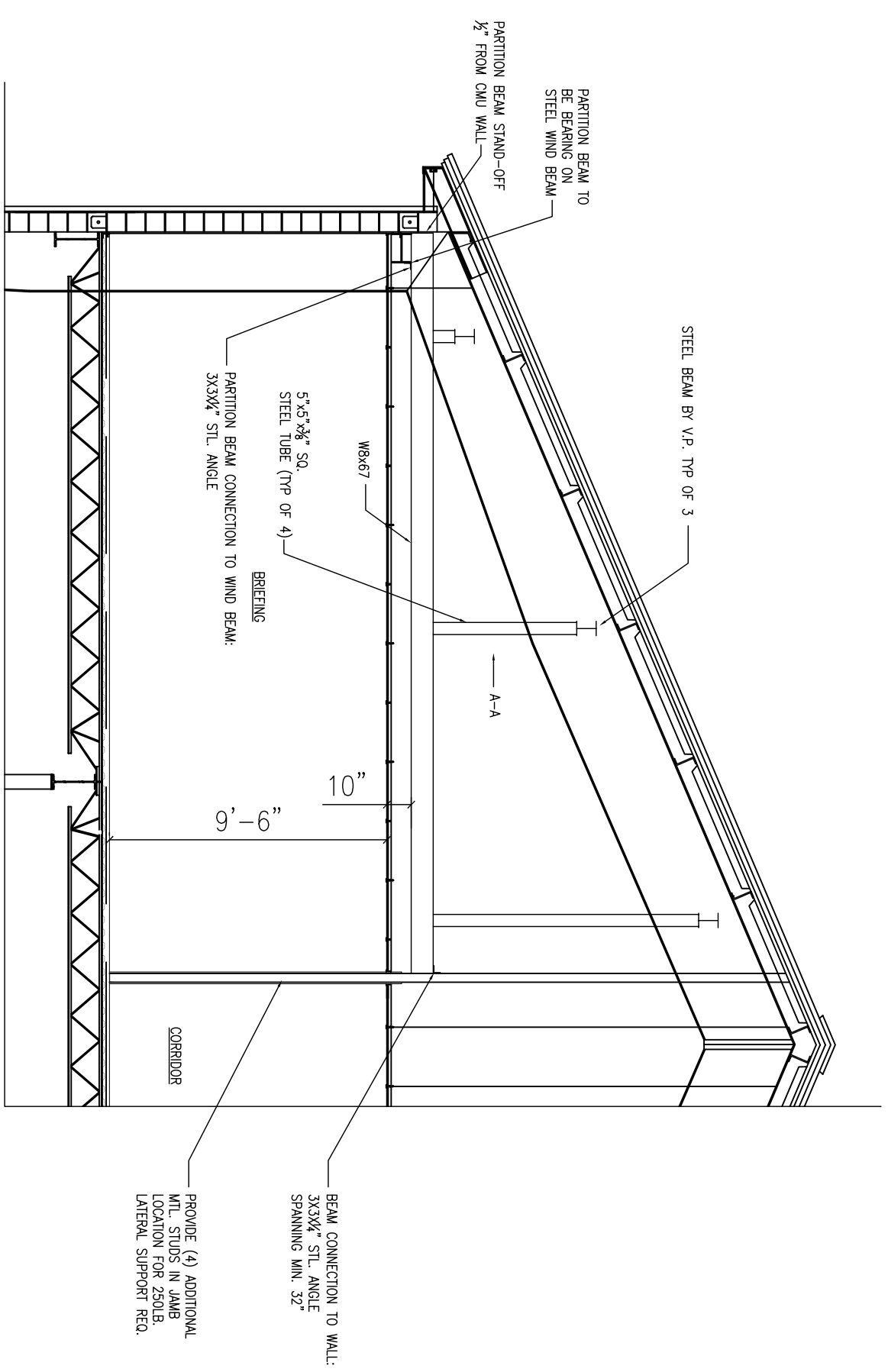

BEAM CONNECTION TO WALL:  
3X3X3/4" STL. ANGLE  
SPANNING MIN. 32"

PROVIDE (4) ADDITIONAL  
MTL. STUDS IN JAMB  
LOCATION FOR 250LB.  
LATERAL SUPPORT REQ.

**PARTITION SUPPORT ELEVATION**

SCALE: 3/8"=1'-0"

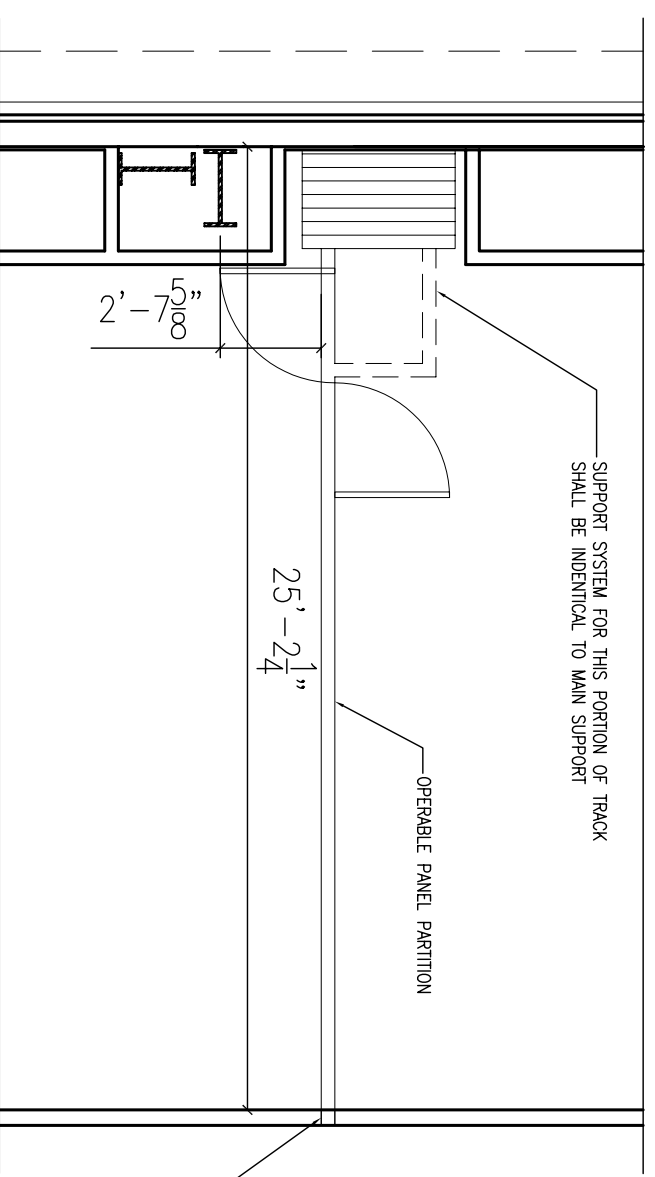

PROVIDE (4) ADDITIONAL MTL. STUDS IN JAMB LOCATION FOR 250LB. LATERAL SUPPORT REQ.

**PARTIAL FLOOR PLAN**

SCALE: 3/8"=1'-0"