

**DAMMON
ENGINEERING, INC.**

CHIEF ENGINEER
EMMETT
DAMMON, P.E.

CHIEF ARCHITECT
ROBERT
WILTSE

1095 FLORIDA AVENUE
SLIDELL, LA. 70458
OFFICE: 985-649-5832
FAX: 985-641-5950

WEBSITE:
WWW.DAMMONENGINEERING.COM

EMAIL:
DAMMONENI@BELLSOUTH.NET

ARCHITECTURE

ENGINEERING

STUDIES

PLANNING

INVESTIGATION

EXPERT WITNESS

OFFICE &
WAREHOUSE
EXPANSION &
RENOVATION

PATTERSON
DENTAL SUPPLY
107 MALLARD ST.
SAINT ROSE, LA
70087

NEW
ELECTRICAL
LIGHTING
PLAN

REV:

SCALE: AS NOTED

JOB#: 2076

DATE: 11-05-10

SHEET 9

E-2

OF 11

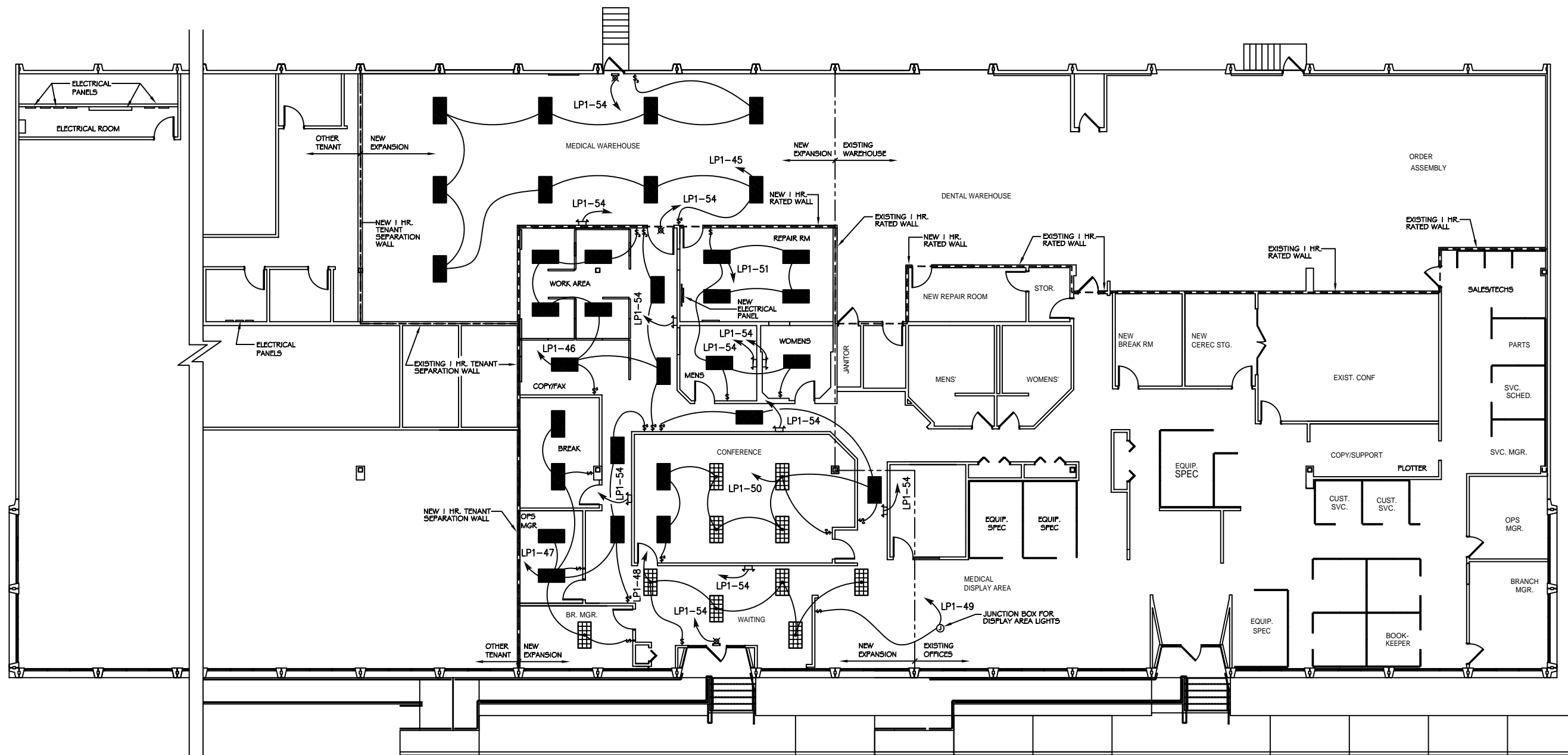

NEW ELECTRICAL LIGHTING PLAN

SCALE: 1/8" = 1'-0"

LEGEND

- - NEW 2x4' DOUBLE-BALLASTED 4-BULB FLUORESCENT LIGHT FIXTURE (216w)
- - NEW OR RELOCATED 2x4' 3-BULB PARABOLIC LIGHT FIXTURE (100w)
- ⊗ - NEW OR RELOCATED HVAC SUPPLY AIR GRILLE
- ⊠ - NEW OR RELOCATED HVAC RETURN AIR GRILLE
- ▤ - EXISTING 2x4' 3-BULB PARABOLIC LIGHT FIXTURE TO REMAIN (100w)
- ⏏ - EMERGENCY LIGHT W/ 90 MIN. BATTERY BACKUP (12w)
- ⊗ - LOW LEVEL MOUNTED EXIT LIGHT/SIGN W/90 MIN. BATTERY BACK-UP (.92w)
- ⊗ - LOW LEVEL MOUNTED EXIT/EMERGENCY LIGHT/SIGN COMBO W/90 MIN. BATTERY BACKUP (2.3w)
- ⚡ - SWITCH
- ⚡ - 3-WAY SWITCH
- ⚡ - POWER PANEL

PRELIMINARY (NOT FOR CONSTRUCTION)