

U.S. Interstate 59

Exit 1 Ramp

LEGEND FOR PROPOSED IMPROVEMENTS

- PROPERTY LINE / R.O.W.
- ▭ PROPOSED BUILDING
- PROPOSED CURB AND GUTTER
- ⊙ PROPOSED PARKING SPACES
- PROPOSED FENCING
- SYSL/4" - SINGLE YELLOW SOLID LINE / 4 INCH THICK
- DYSL/5" - DOUBLE YELLOW SOLID LINE / 5 INCH THICK EACH
- SWSL/24" - SINGLE WHITE SOLID LINE / 24 INCH THICK
- SWSL/36" - SINGLE WHITE SOLID LINE / 36 INCH THICK
- SWSL/4" - SINGLE WHITE SOLID LINE / 4 INCH THICK
- SWDL/4" - SINGLE WHITE DASHED LINE / 4 INCH THICK

EXISTING LEGEND

- SUBJECT PROPERTY BOUNDARY LINE
- ADJACENT BOUNDARY LINES
- OLD WIRE FENCE
- "40" LINES
- LIMITS OF EASEMENT
- BURIED FIBER OPTIC LINE
- OVERHEAD UTILITY LINES
- MAJOR CONTOUR
- MINOR CONTOUR
- DRAINAGE PIPE
- SIGNIFICANT DRAINAGE FLOWLINE
- APPROXIMATE FLOOD ZONE LOCATION
- NO HIGHWAY ACCESS
- PAINT STRIPE
- 1/2" IRON REBAR SET
- IRON PIN FOUND
- FENCE CORNER FOUND
- UTILITY POLE
- APS AS PER SURVEY
- APR AS PER RECORD
- ROW RIGHT-OF-WAY
- CONTOUR ELEVATION
- RCP REINFORCED CONCRETE PIPE
- CMP CORRUGATED METAL PIPE
- ROAD SIGN POST

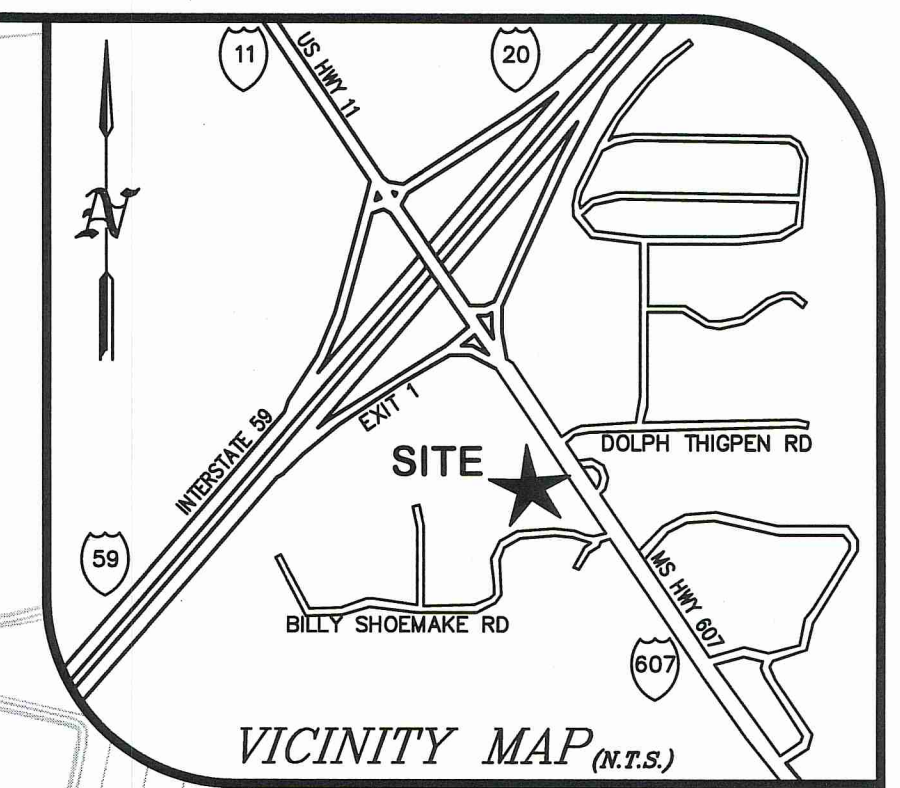

RC 200325
 File: 200325v7
 Drawn: DMT
 Date: 03-01-2023

RESOURCECONSULTING
 CIVIL ENGINEERING
 6700 Jefferson Highway - Resource Suite 4A
 Baton Rouge, Louisiana 70806
 ResourceConsulting@hotmail.com
 Tel: (225) 761-9909, Fax (225) 766-6672

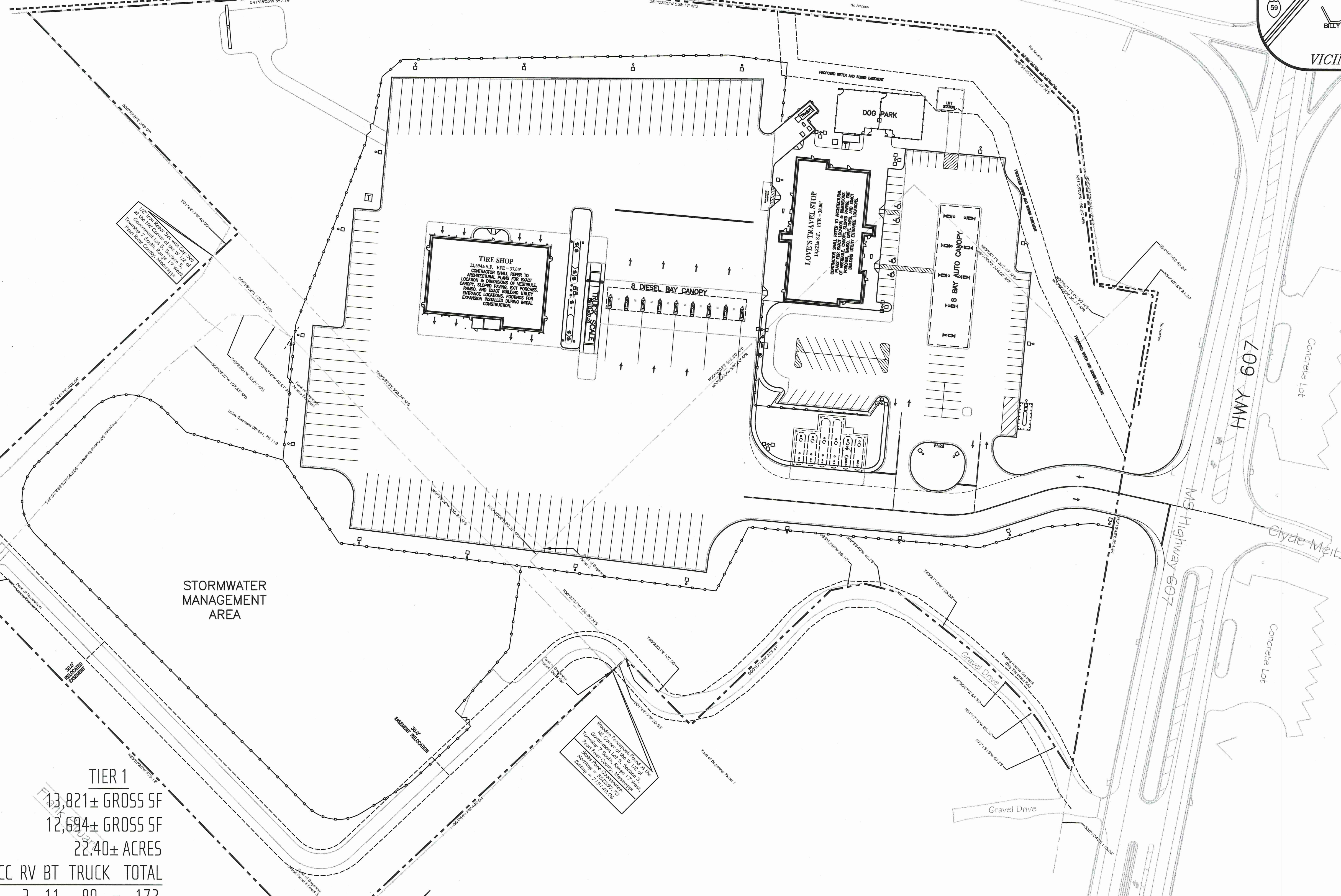

SITE ANALYSIS

LOVE'S TRAVEL STOP	13,821± GROSS SF
LOVE'S TIRE SHOP	12,694± GROSS SF
TOTAL SITE AREA	22.40± ACRES

TIER 1

PARKING SUMMARY	AUTO	ACC	RV	BT	TRUCK	TOTAL
SPACES PROVIDED	74	4	3	11	80	= 172

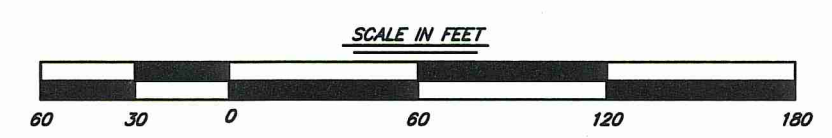

THIS DRAWING IS NOT VALID WITHOUT AN ORIGINAL BLUE INK SIGNATURE AND ORIGINAL HANDWRITTEN DATE OF A LICENSED PROFESSIONAL ENGINEER.

OVERALL SITE PLAN

LOVE'S TRAVEL STOP
 INTERSTATE 59 EXIT 1 @ MS HIGHWAY 607
 PEARL RIVER COUNTY, MISSISSIPPI

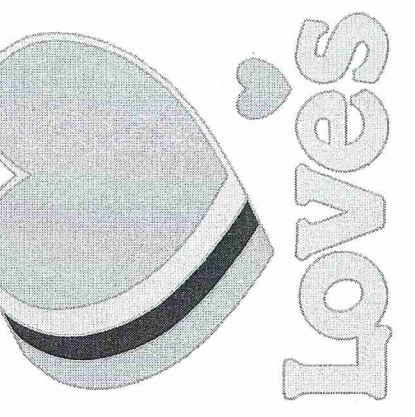

C3.0

K:\200325 - Pearl River County, MS Love's 1-59 @ MS Hwy 607 SEQ\Design\200325v7 design.dwg, C:\0 OVERALL SITE PLAN, 3/1/2023, 4:35:05 PM, Jessie, Resource Consulting, LLC copyright