

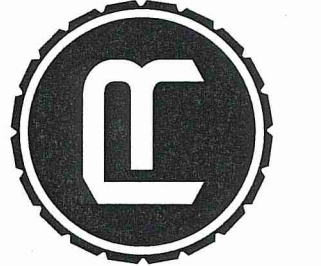

**RESOURCE CONSULTING**  
 CIVIL ENGINEERING  
 6700 Jefferson Highway - Resource Suite 4A  
 Baton Rouge, Louisiana 70806  
 ResourceConsulting@hotmail.com  
 Tel: (225) 761-9909, Fax (225) 765-6672



**LOVE'S TRAVEL STOP**  
 INTERSTATE 59 EXIT 1 @ MS HIGHWAY 607  
 PEARL RIVER COUNTY, MISSISSIPPI



**C7.4**

200325v6a  
 Prepared by Resource Consulting  
 HydroCAD® 10.20-2g s/n 08580 © 2022 HydroCAD Software Solutions LLC Page 1

200325v6a - Pearl River County, MS  
 Printed 12/21/2022

**Summary for Pond 3P: Proposed SW Management Pond**

Volume #1	Invert	Avail. Storage	Storage Description
	18.00'	8.446 af	Custom Stage Data (Prismatic) Listed below (Recalc)
Elevation (feet)	Surf. Area (acres)	Inc. Store (acre-feet)	Cum. Store (acre-feet)
18.00	0.484	0.000	0.000
19.00	0.935	0.740	0.740
20.00	1.425	1.210	1.950
21.00	1.523	1.474	3.424
22.00	1.622	1.572	4.997
23.00	1.724	1.673	6.670
24.00	1.828	1.776	8.446

Device	Routing	Invert	Outlet Devices	Notes
#1	Primary	18.00'	36.0" Vert. Orifice/Grate	C=0.600 Limited to weir flow at low heads
#2	Device 1	18.00'	6.0" Vert. Orifice/Grate	C=0.600 Limited to weir flow at low heads
#3	Device 1	19.50'	36.0" Vert. Orifice/Grate	C=0.600 Limited to weir flow at low heads
#4	Device 1	23.00'	4.0' long Sharp-Crested Rectangular Weir	2 End Contractions(s)
#5	Device 1	23.00'	4.0' long Sharp-Crested Rectangular Weir	2 End Contractions(s)

**Primary Outflow**  
 1=Orifice/Grate  
 2=Orifice/Grate  
 3=Orifice/Grate  
 4=Sharp-Crested Rectangular Weir  
 5=Sharp-Crested Rectangular Weir

Event	Inflow (cfs)	Outflow (cfs)	Elevation (ft)	Storage (ac-ft)
2-Year	25.10	7.34	20.44	2.590
5-Year	37.71	16.21	21.00	3.426
10-Year	45.23	21.51	21.28	3.858
25-year	52.71	26.67	21.54	4.266
50-year	59.54	31.17	21.77	4.623
100-year	66.97	35.80	22.00	5.004

	Pre	Post	
Area (acres)	15.01	15.01	
Tc (min)	22.27	7.30	
C	76.00	88.00	
<b>Storm Event</b>	<b>Q<sub>pre</sub> (cfs)</b>	<b>Q<sub>post</sub> (cfs)</b>	<b>Q<sub>post</sub> &lt; Q<sub>pre</sub></b>
2-Year	13.73	7.34	OK
5-Year	23.65	16.21	OK
10-Year	29.84	21.51	OK
25-year	36.10	26.67	OK
50-year	41.88	31.17	OK
100-year	48.21	35.80	OK

**LEGEND FOR PROPOSED IMPROVEMENTS**

- PROPERTY LINE / R.O.W.
- PROPOSED BUILDING
- PROPOSED CURB AND GUTTER
- PROPOSED INLET
- PROPOSED CURB INLET
- PROPOSED STORM SEWER
- \*12.10 PROPOSED ELEVATION

**EXISTING LEGEND**

- SUBJECT PROPERTY BOUNDARY LINE
- ADJACENT BOUNDARY LINES
- OLD WIRE FENCE
- "40' LINES
- LIMITS OF EASEMENT
- BURIED FIBER OPTIC LINE
- OVERHEAD UTILITY LINES
- MAJOR CONTOUR
- MINOR CONTOUR
- DRAINAGE PIPE
- SIGNIFICANT DRAINAGE FLOWLINE
- APPROXIMATE FLOOD ZONE LOCATION
- NO HIGHWAY ACCESS
- PAINT STRIPE
- 

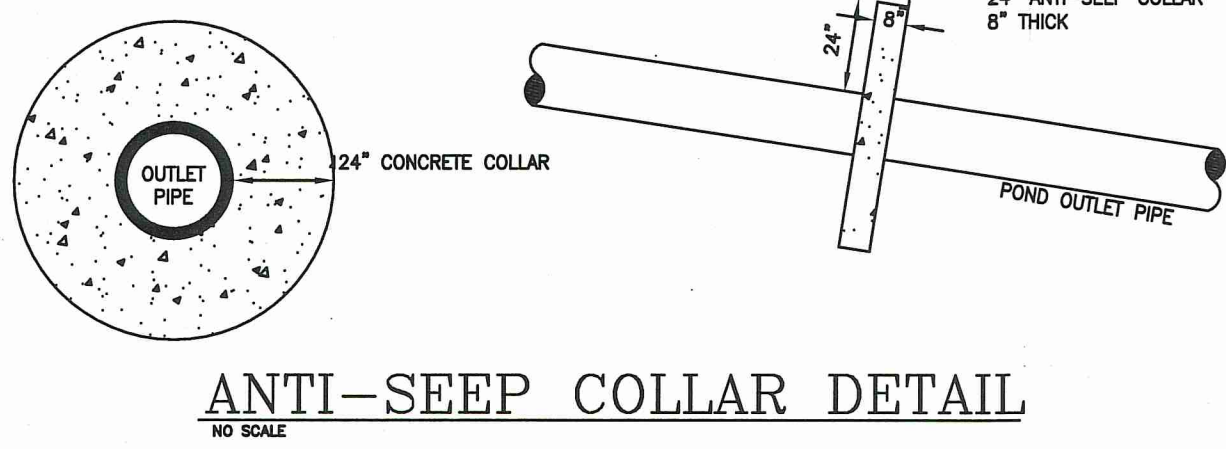
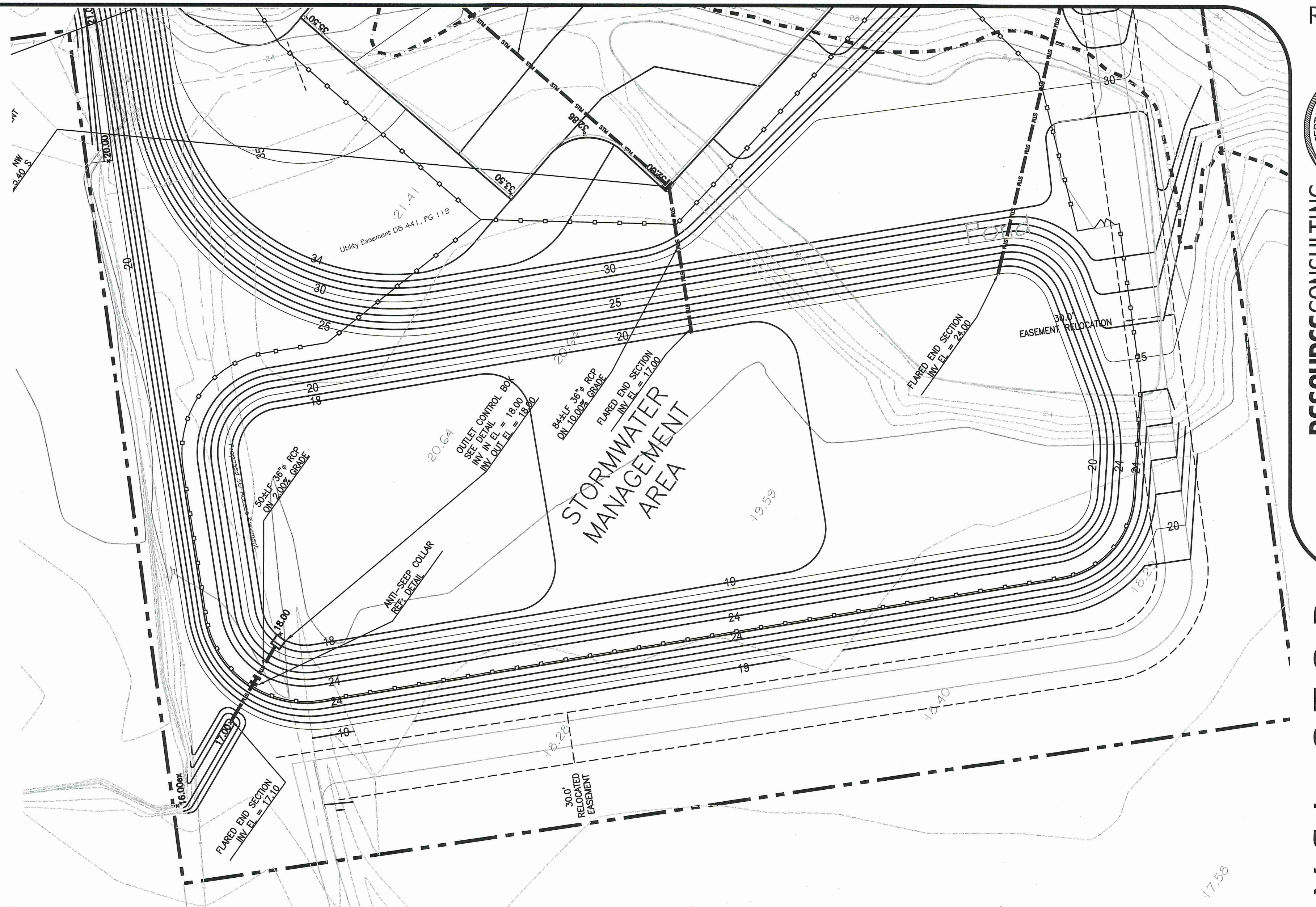

ANTI-SEEP COLLAR DETAIL

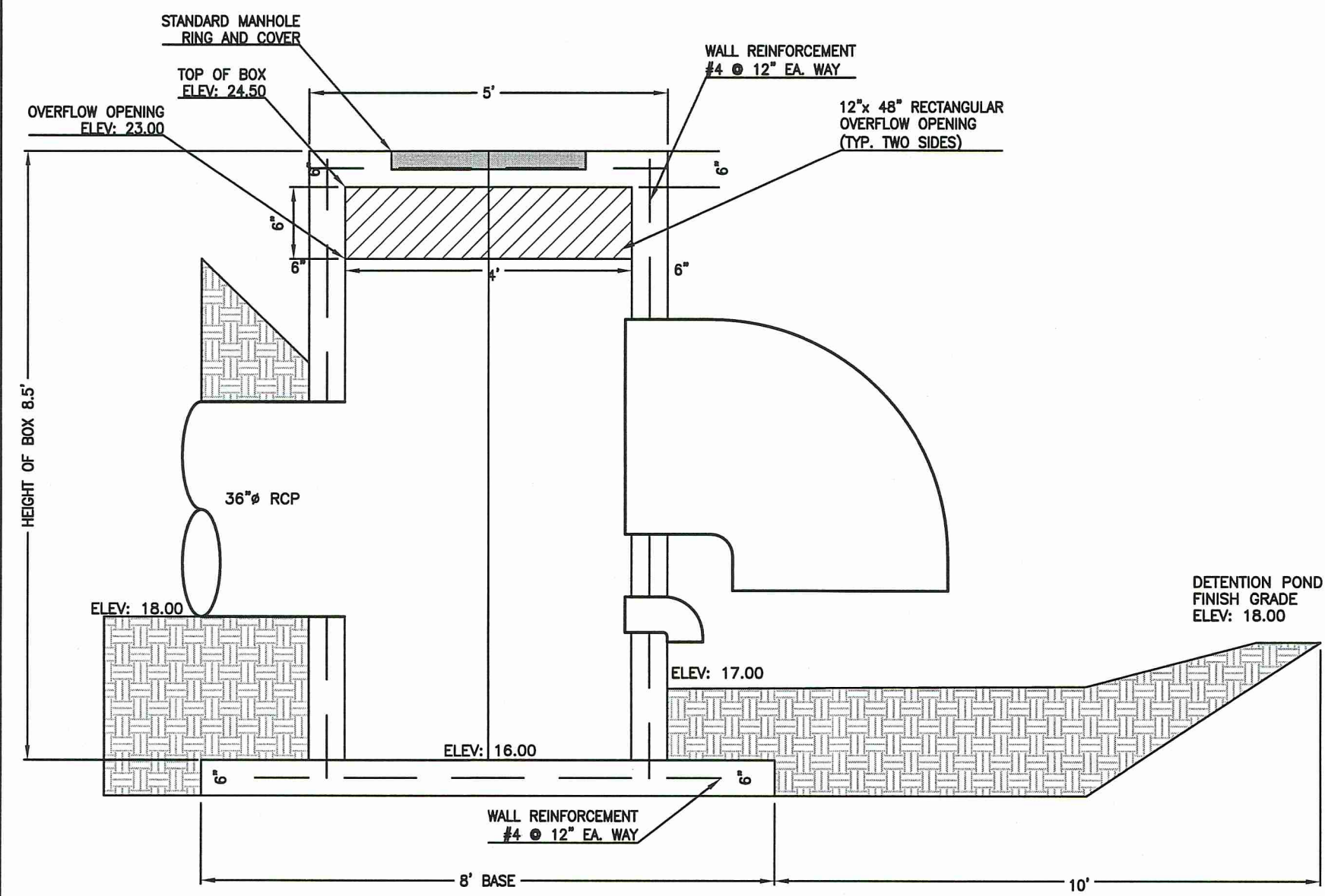

SIDE VIEW  
 NTS

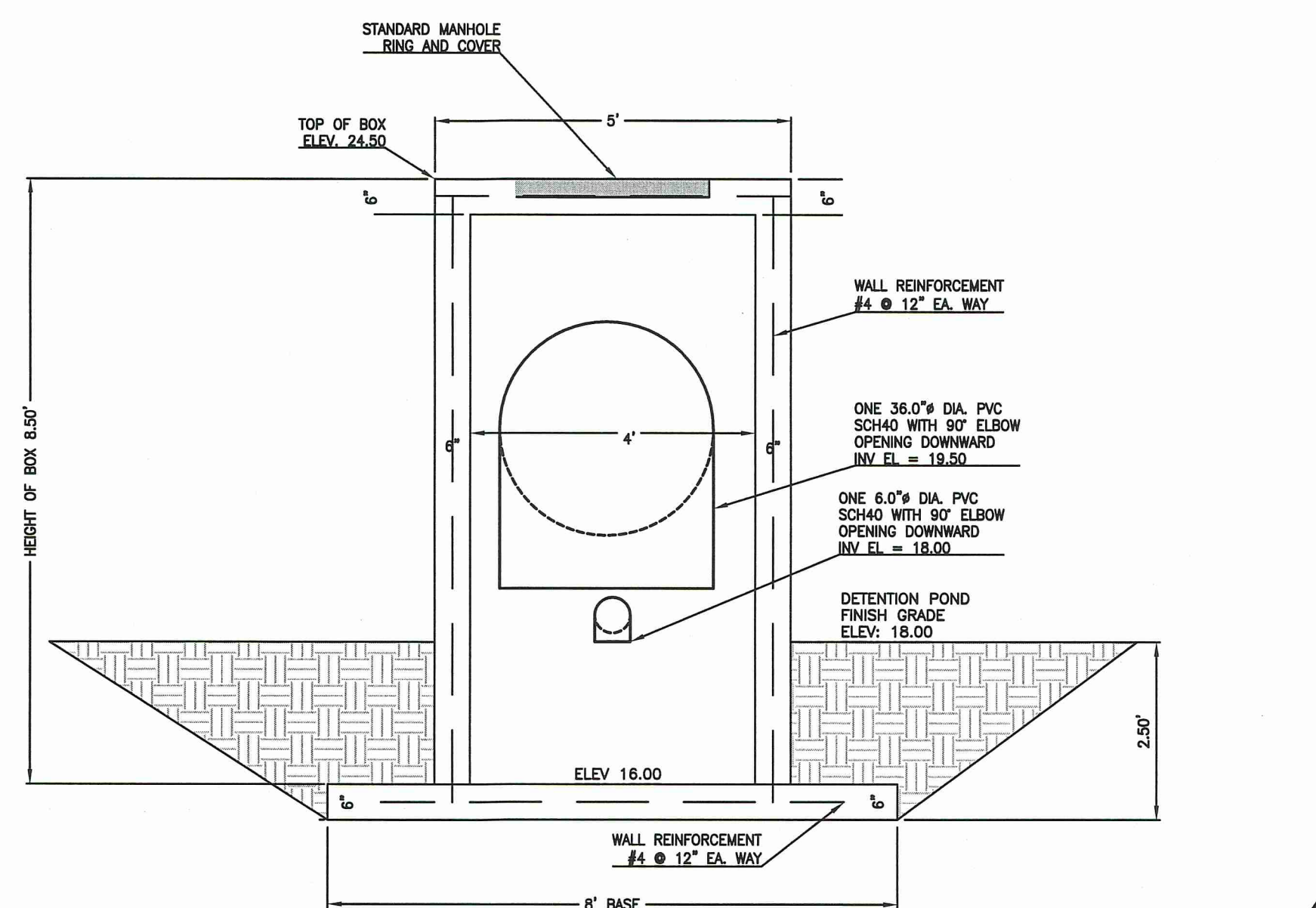

FRONT VIEW  
 NTS

**OUTLET CONTROL STRUCTURE**

**DRAINAGE BASIN AND POND NOTES:**

- REFERENCE HYDROLOGIC SUMMARY VERSION 6A PROVIDED BY RESOURCE CONSULTING, LLC FOR SUPPORTING HYDRAULIC INFORMATION.
- REFERENCE GEOTECHNICAL INVESTIGATION AND REPORT PERFORMED BY TERRACON CONSULTANTS INC., TEL: 228-283-7050, FOR ALL EARTHWORK SPECIFICATIONS.
- REFERENCE SHEETS C4.1, C4.2, AND C4.3 FOR ALL DETAIL ON PROPER INSTALLATION AND MAINTENANCE OF BEST MANAGEMENT PRACTICES FOR SEDIMENT AND EROSION CONTROL.
- REFERENCE SITework SPECIFICATIONS



THIS DRAWING IS NOT VALID WITHOUT AN ORIGINAL BLUE INK SIGNATURE AND ORIGINAL HANDWRITTEN DATE OF A LICENSED PROFESSIONAL ENGINEER.  
**STORM WATER MANAGEMENT SYSTEM DETAIL**



Know what's below.  
 Call before you dig.