

This document, together with the concepts and designs presented herein, as an instrument of service, is intended only for the specific purpose and client for which it was prepared. Reuse of and improper reliance on this document without written authorization and adaptation by Kimley-Horn and Associates, Inc. shall be without liability to Kimley-Horn and Associates, Inc.

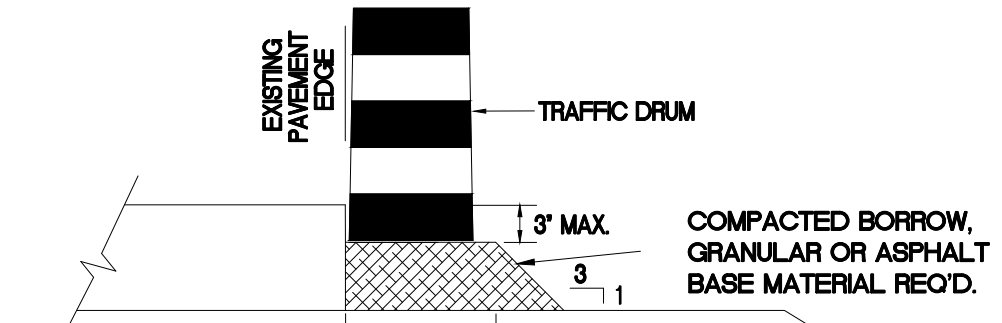

CONTRACTOR SHALL PLACE PLASTIC DRUMS ADJACENT TO ROADWAY IN AREAS WHERE THE WIDENING HAS NOT BEEN CONSTRUCTED TO WITHIN TWO INCHES OF EXISTING PAVEMENT ELEVATIONS. DRUMS REQUIRED WHERE WORK ZONE INCLUDES UNDERCUT SHOULDER AND REMOVAL OF CURB + GUTTER. DRUMS TO BE PLACED AS SHOWN IN DETAILS, LEFT FOR NIGHT OPERATION OR SUSPENSIONS OF WORK. COST TO BE ABSORBED (UNDER PAY ITEM 618-A).

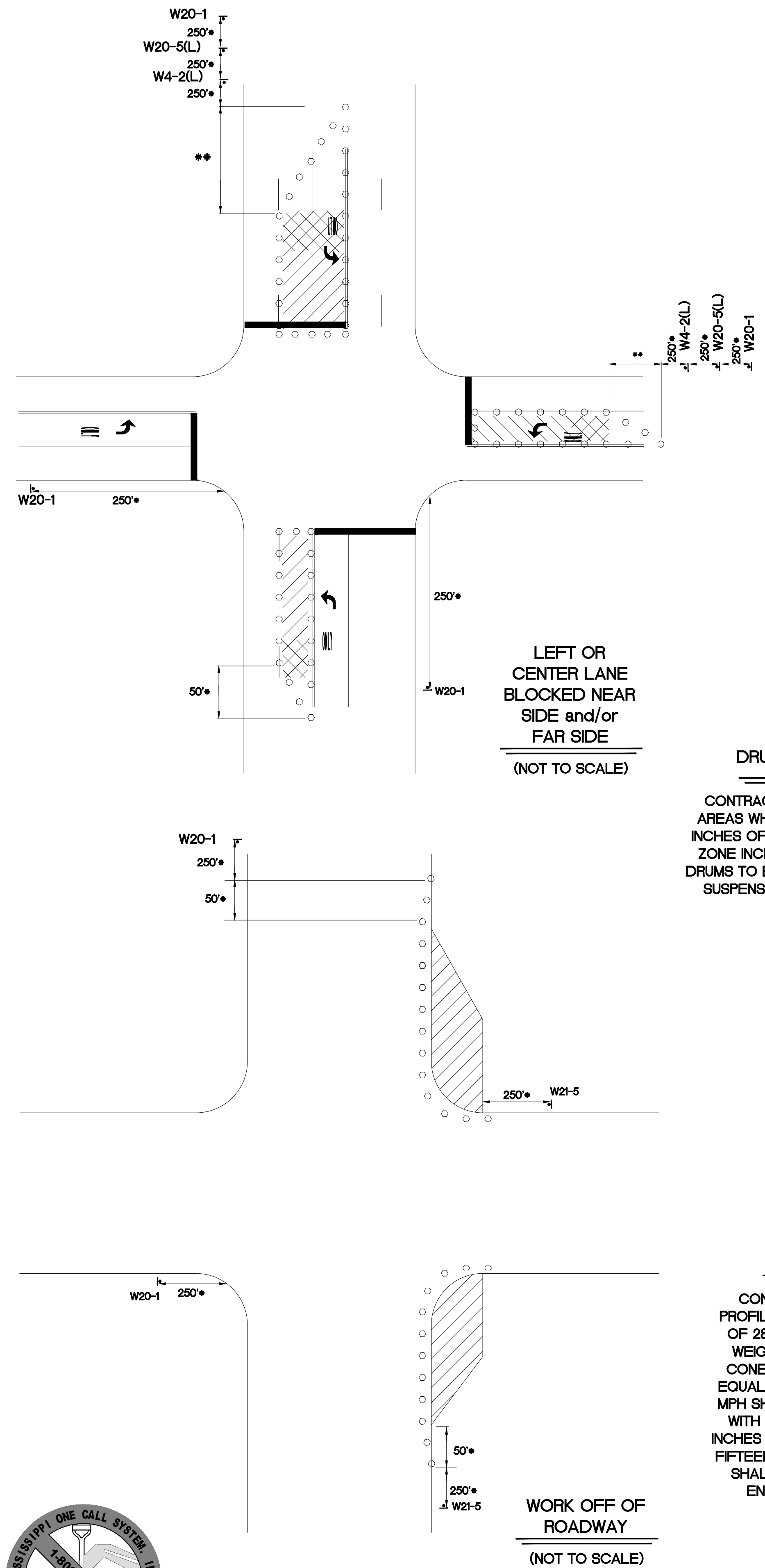
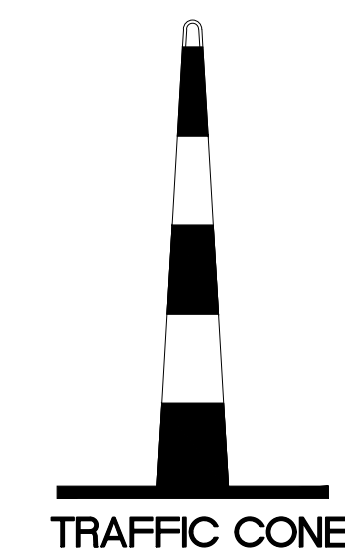

CONES SHALL BE NARROW PROFILE WITH A MINIMUM HEIGHT OF 28 INCHES AND A MINIMUM WEIGHT OF TEN (10) POUNDS. CONES USED IN SPEED ZONES EQUAL TO OR GREATER THAN 45 MPH SHALL BE NARROW PROFILE WITH A MINIMUM HEIGHT OF 28 INCHES AND A MINIMUM WEIGHT OF FIFTEEN (15) POUNDS. ALL CONES SHALL BE APPROVED BY THE ENGINEER PRIOR TO USE.

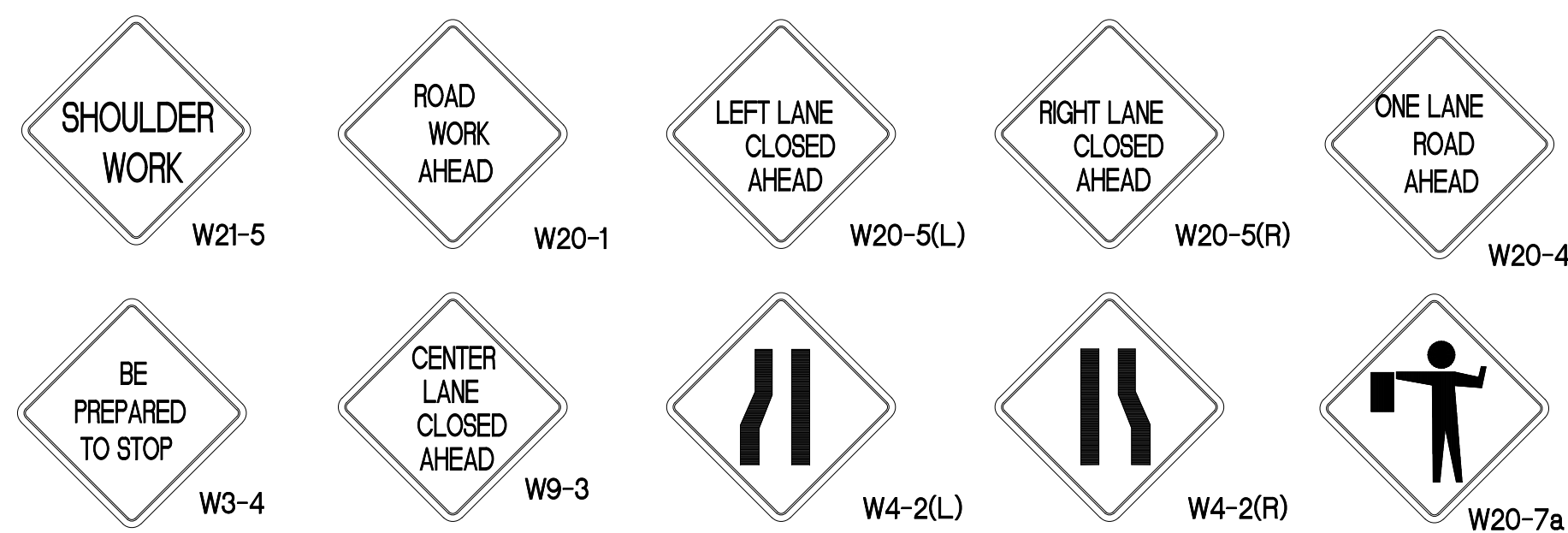
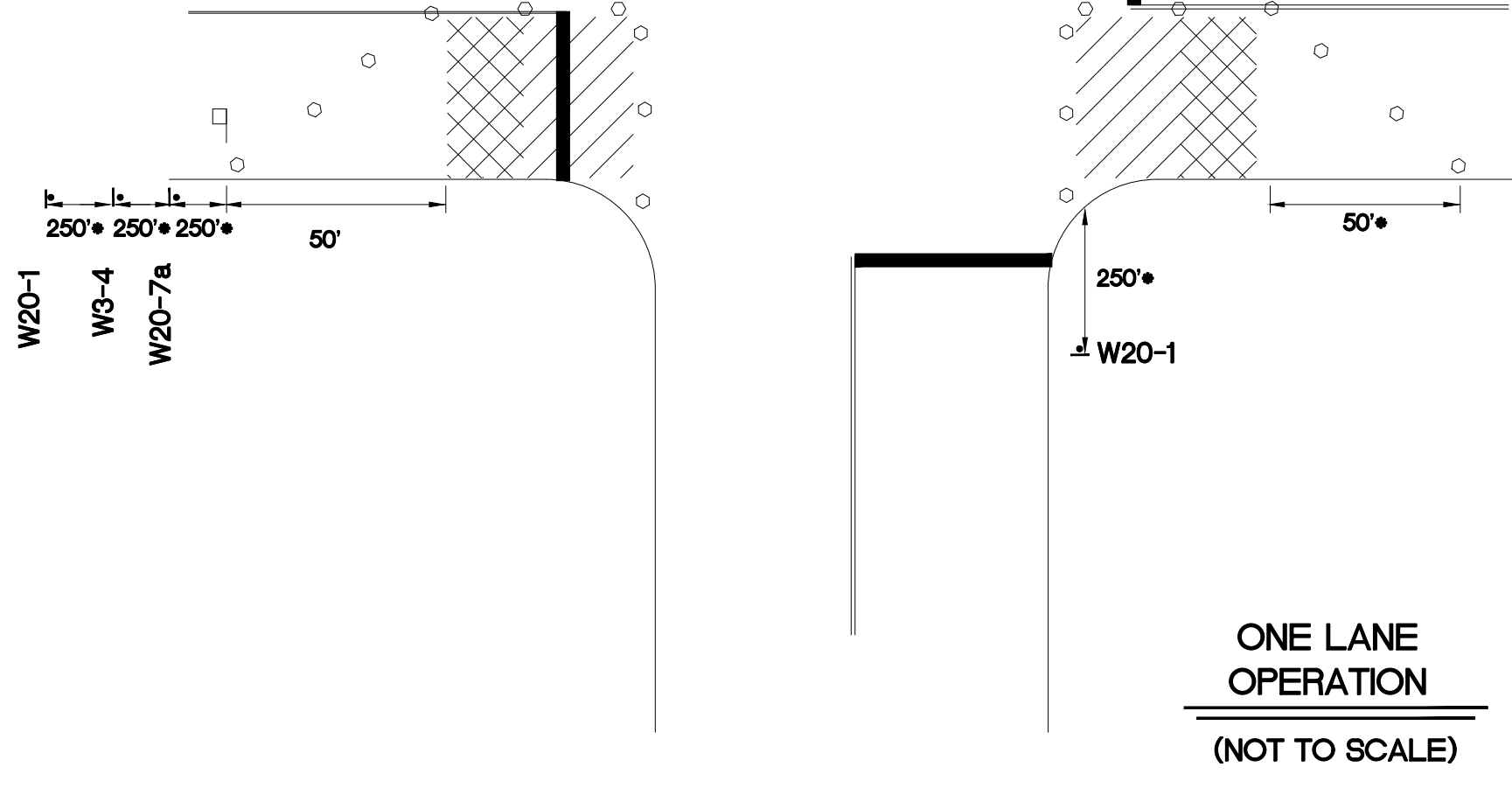

- GENERAL NOTES:**
- ADDITIONAL ADVANCE WARNING SIGNS MAY BE NECESSARY. ANY ADDITIONAL SIGNS SHOULD BE INCLUDED UNDER PAY ITEM 618-A, MAINTENANCE OF TRAFFIC.
 - POST MOUNTED SIGNS SHALL HAVE A 7' MINIMUM MOUNTING HEIGHT.
 - PAYMENT FOR ALL SIGNS, CONES, DRUMS, CONCRETE BARRIERS, STEEL PLATES AND OTHER MATERIALS, BARRICADES, LABOR AND INCIDENTALS REQUIRED TO IMPLEMENT THE TRAFFIC CONTROL PLAN SHALL BE INCLUDED UNDER PAY ITEM 618-A, MAINTENANCE OF TRAFFIC.
 - APPROACH SIDE TRAFFIC CONTROL TO BE USED WHEN WORK OCCURS ON EITHER THE APPROACH SIDE OR THE FAR SIDE OF THE INTERSECTION. FAR SIDE TRAFFIC CONTROL IS NOT NEEDED WHEN WORK IS CONFINED TO THE APPROACH SIDE ONLY.
 - FOR A DIVIDED HIGHWAY SITUATION, A SECOND SET OF ADVANCE WARNING SIGNS SHALL BE ERECTED IN MEDIAN AREA (8' MIN. MEDIAN WIDTH REQUIRED).

LEGEND

- DRUMS (30' MAXIMUM SPACING) - CONES SHALL BE NARROW PROFILE WITH A MINIMUM HEIGHT OF 28 INCHES AND A MINIMUM WEIGHT OF TEN (10) POUNDS. CONES USED IN SPEED ZONES EQUAL TO OR GREATER THAN 45 MPH SHALL BE NARROW PROFILE WITH A MINIMUM HEIGHT OF 28 INCHES AND A MINIMUM WEIGHT OF FIFTEEN (15) POUNDS. ALL CONES SHALL BE APPROVED BY THE ENGINEER PRIOR TO USE.
- SIGNS - SEE SIGN LEGEND MIN. SIZE 48" x 48", BLACK ON ORANGE BACKGROUND
- FLAGGER WITH PADDLE - 18" STOP/SLOW PADDLES ACCEPTED AS PROPER TRAFFIC CONTROL DEVICES SHALL BE USED. HAND HELD FLAGS SHALL NOT BE FOR FLAGGING OPERATION.



CONSIDERED MINIMUM DISTANCE - ENGINEER TO DETERMINE APPROPRIATE SPACING IN THE FIELD

** SPEED LIMIT	BUFFER FEET	TAPER LENGTH (Feet) (Per 12' Lane Shift)
20	115	80
25	155	125
30	200	180
35	250	245
40	305	320
45	360	540
50	425	600
55	495	660
60	570	720
65	645	780
70	730	840

NO.	REVISIONS	DATE	BY

Kimley-Horn
 420 N 20TH ST, SHIPT TOWER STE 2200, BIRMINGHAM, AL 35203
 PHONE: 205-558-5831
 WWW.KIMLEY-HORN.COM



KHA PROJECT	142362033
DATE	2/2022
SCALE	AS SHOWN
DESIGNED BY	BST
DRAWN BY	BST
CHECKED BY	CBB

TRAFFIC CONTROL PLAN DETAILS

LOVE'S TRAVEL STOP
 TRAFFIC SIGNAL DESIGN
 PREPARED FOR
MDOT

PICAYUNE MS