

**DAMMON
ENGINEERING, INC.**

CHIEF ENGINEER
EMMETT
DAMMON, P.E.

CHIEF ARCHITECT
ROBERT
WILTSE

554 OLD SPANISH TRAIL
SLIDELL, LA. 70458
OFFICE: 985-649-5832
FAX: 985-641-5950

WEBSITE:
WWW.DAMMONENGINEERING.COM

EMAIL:
DAMMONENG@BELLSOUTH.NET

- ARCHITECTURE
- ENGINEERING
- STUDIES
- PLANNING
- INVESTIGATION
- EXPERT WITNESS

NEW
OFFICE
WAREHOUSE

BINGO
9000 SQ.FT.
OFFICE / WAREHOUSE
SLIDELL, LA

ELECTRICAL
LIGHTING PLAN

REV:

SCALE: AS NOTED

JOB#: 2113

DATE: 06-01-11

SHEET

E-2

OF

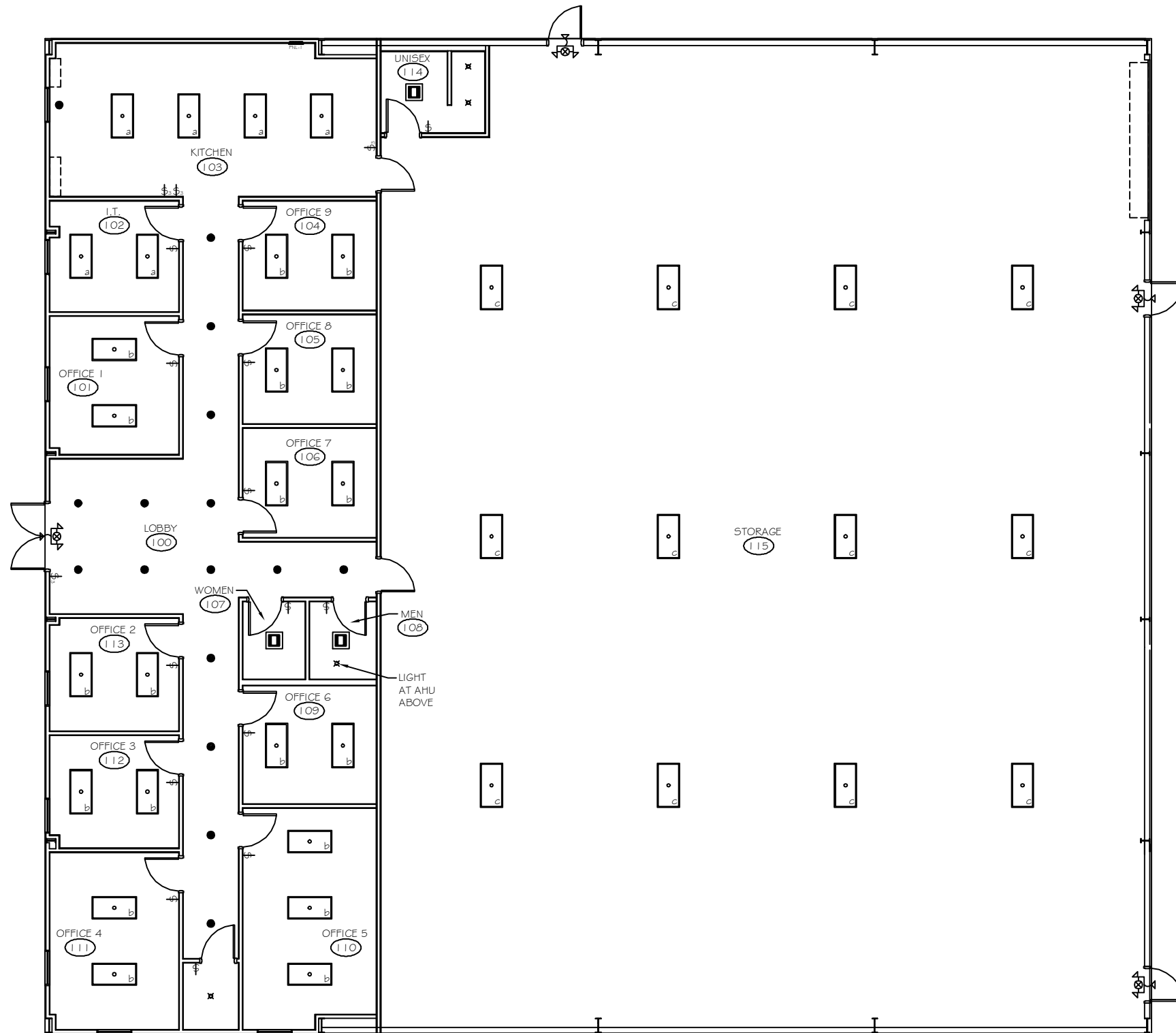

- LEGEND**
- 2x4 FLOURESCENT LAY-IN TYPE FIXTURE
3-T8 25W LAMPS, 120V
PRISMATIC LENS
 - 2x4 FLOURESCENT LOW-BAY FIXTURE
6-T8 32W LAMPS, 120V
WHITE REFLECTOR
 - INCANDESCENT CLG. MTD. FIXTURE
1-GOW LAMP, 120V
 - INCANDESCENT CLG. MTD. FIXTURE AT AHU DECK ABOVE,
1-GOW LAMP, 120V
 - INCANDESCENT RECESSED CAN FIXTURE, ADJUSTABLE
1-GOW LAMP, 120V
 - VENT / LIGHT COMBO FIXTURE
 - EMERGENCY / EXIT LIGHT COMBO
W/ 90 MIN. BATTERY BACKUP AND
REMOTE TO EXTERIOR (12W)

LIGHTING PLAN

SCALE: 3/16" = 1'-0"

