  
**REFLECTED CEILING PLAN**  
 SCALE: 1/8" = 1'-0"

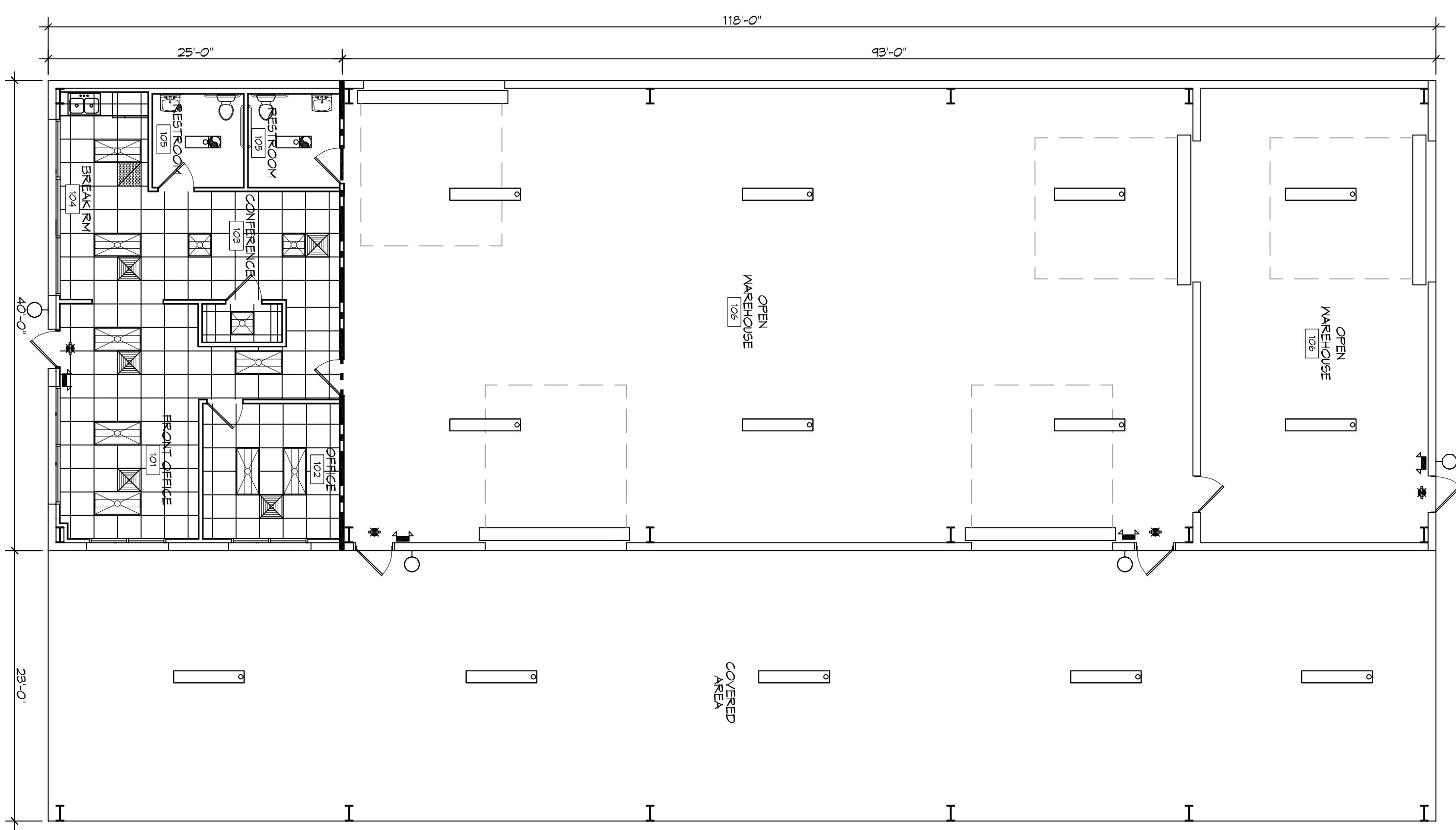

**OFFICE WAREHOUSE RENOVATION**  
**SURGI INVESTMENTS**  
 38255  
 COAST BLVD.  
 SLIDELL, LA  
 JOB No: ???? DATE: 07-17-2019  
 DRAWN BY: CKD CHECKED BY: JMS

The above drawings are specifications, through and through, representing the work to be done. It is the responsibility of the contractor to verify the accuracy of the information shown on these drawings and to check the work for compliance with the specifications. The contractor shall be responsible for checking the work for compliance with the specifications. The contractor shall be responsible for checking the work for compliance with the specifications.

| REVISIONS |             |
|-----------|-------------|
| #         | DESCRIPTION |
|           |             |
|           |             |
|           |             |
|           |             |
|           |             |
|           |             |
|           |             |
|           |             |
|           |             |
|           |             |

# DAMMON

## ENGINEERING, INC.

**LOUISIANA & MISSISSIPPI**

Chief Engineer: Brian Mstich, PE  
 554 Old Spanish Trail  
 Slidell, LA 70458  
 www.dammonengineering.com  
 info@dammonengineering.com  
 PH: 985.649.5832

SHEET NO. **A103** 9 OF 1  
 DRAWING NUMBER: