

**13 REFLECTED CEILING PLAN**  
 SCALE: 1/8" = 1'-0"

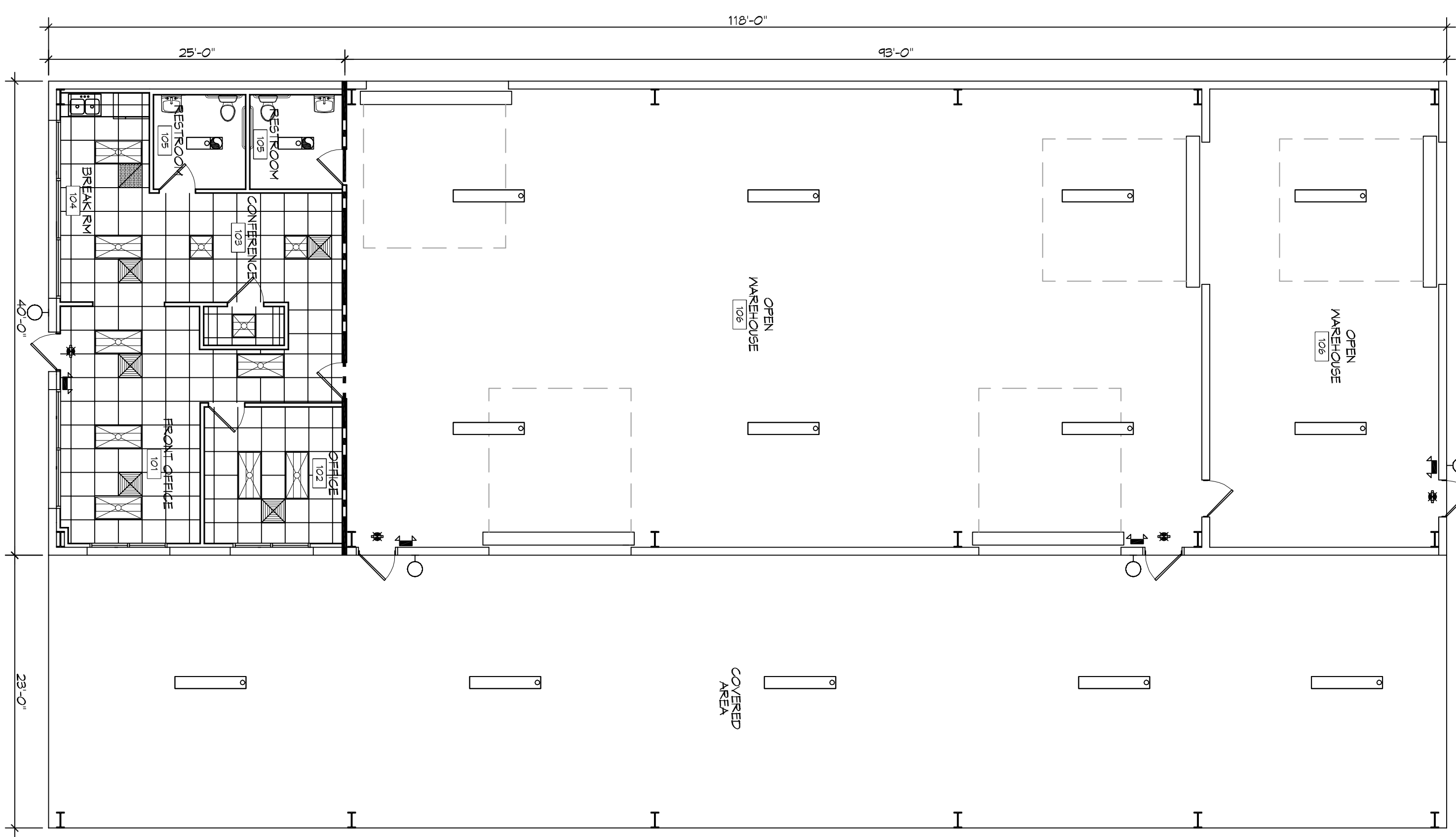

**OFFICE WAREHOUSE RENOVATION**  
**SURGI INVESTMENTS**  
 38255  
 COAST BLVD.  
 SLIDELL, LA  
 JOB No: 2395 DATE: 08-14-2019  
 DRAWN BY: CKD CHECKED BY: JMS

We warrant coverage and specifications, through and through representation hereby and shall remain the property of Dammon Engineering, Inc. No part thereof shall be copied, reproduced, or used in connection with any work or project other than the specific project for which the same have been prepared and provided without the consent of Dammon Engineering. Please contact with other drawings or specifications that constitute part of this project.

REVISIONS		
#	DESCRIPTION	DATE

# DAMMON

## ENGINEERING, INC.

**LOUISIANA & MISSISSIPPI**

Chief Engineer: Brian Mstich, PE  
 554 Old Spanish Trail  
 Slidell, LA 70458  
 www.dammonengineering.com  
 info@dammonengineering.com  
 PH: 985.649.5832

SHEET NO: **A103**  
 6 of 6