

### GE® 7.4 cu. ft. Capacity Smart aluminized alloy drum Electric Dryer with Sanitize Cycle and Sensor Dry

Model #: GTD84ECPNDG ★★★★★ 4.5 (911)

## \$1,049.00

- Steam
  - Vent Sensor
  - Built-in WiFi
  - Dimensions: 48 H x 27 W x 30 1/2 D
- [Learn More >](#)

Color: Gray



[FIND STORES](#)



- [About This Product](#)   [Related Products](#)   [Specs & Details](#)   [Reviews](#)   [Q&A](#)   [Owner Support](#)

## ABOUT THIS PRODUCT



**Steam**  
Dewrinkle and refresh your laundry right in the dryer thanks to innovative built-in steam technology

[Play Video](#)

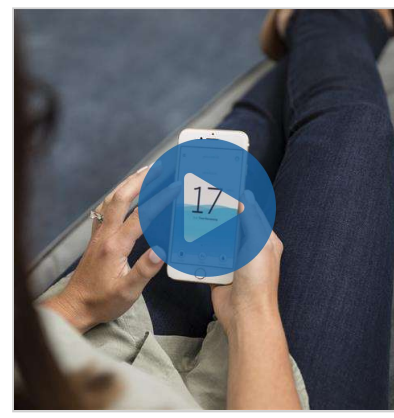

**Built-in WiFi**  
Enjoy the ultimate in convenience and the latest in technology with the ability to monitor and control your laundry from anywhere and receive real-time notifications and updates

[Play Video](#)



**Sensor Dry**  
Prevent over-drying and get more wear out of your clothing thanks to innovative dual thermistor technology, that continually monitors temperature and moisture in the dryer

[Play Video](#)



**Wrinkle Care**  
Spend less time ironing thanks to an innovative wrinkle care system that allows you to tumble clothes without heat to reduce creasing



**Damp Alert**  
Be notified when clothes are the ideal dampness to remove from the dryer for wrinkle-free results



**Temperature Options**  
Four different temperatures for full control over the drying process

**Quick Dry**  
Dry a full load in less time thanks to innovative quick dry technology

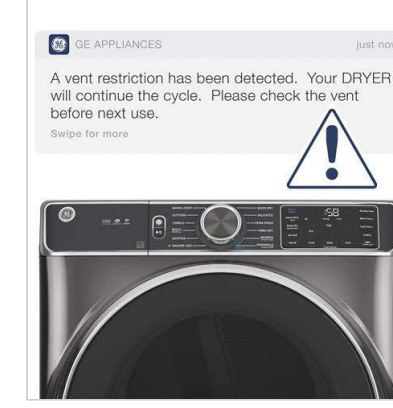

**Vent Sensor**  
Maintain optimal drying performance with this notification that alerts you when a restriction is detected in your dryer vent



**Sanitize Cycle**  
Reduce certain types of bacteria by 99.8% with this cycle



**Up to 120 ft. venting**  
Maximize your dryer's performance with innovative venting, designed to provide optimal airflow, enhanced drying ability, and flexible installation



**Digital Touch Controls**  
Quickly and easily adjust your settings to do laundry your way using these sleek controls



**Dry Level Options**  
Four different drying levels to dry the way you want

## CLAIMS & CERTIFICATIONS

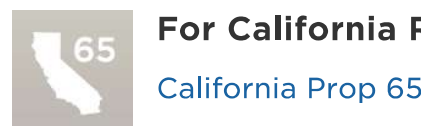

**For California Residents:**  
California Prop 65



ENERGY STAR® Qualified

## BUILT-IN WIFI, POWERED BY SmartHQ™



Connect to WiFi for real-time feedback, optimized performance, alerts and more.



Works With



# IFTTT SONOS

## COMPLETE THE LOOK



**GE® 5.2 cu. ft. Capacity Smart Washer with...**  
Model #: GTW840CPNDG



**GE® 5.0 cu. ft. Capacity Smart Washer with...**  
Model #: GTW845CPNDG



1,049.00



1,049.00

## SPECS & DETAILS

### APPEARANCE

<b>Color Appearance</b>	Diamond Gray
-------------------------	--------------

### CAPACITY

<b>Total Capacity (cubic feet)</b>	7.4 cu ft
------------------------------------	-----------

### FEATURES

<b>Heat Selections</b>	5
<b>Number of Cycles</b>	13 w/ Warm Up
<b>Dryer Cycles</b>	Active Wear Bulky / Comforter Cottons Delicates Jeans Mixed Loads Quick Dry Sanitize Steam Dewrinkle Steam Refresh Timed Dry Towels/ Sheets Warm Up
<b>Long Vent Capability</b>	Up to 120 feet
<b>Temperature Options</b>	High/Medium/Low/No Heat
<b>Control Type</b>	Electronic
<b>Moisture Sensor</b>	Sensor Dry
<b>Style</b>	Top Load Matching
<b>Dual Thermistors</b>	Yes
<b>Additional Cycles</b>	Delay Dry EcoDry My Cycle Warm Up Wrinkle Care
<b>Dryness Levels</b>	4
<b>Timed Dry</b>	90 Minutes Warm Up
<b>Steam Dewrinkle</b>	Yes
<b>Steam Refresh</b>	Yes
<b>WiFi Connect</b>	Built-In
<b>Connected Capabilities</b>	Amazon Alexa IFTTT Sonos The Google Assistant
<b>Energy Saving Option</b>	Yes - eDry
<b>Steam</b>	Yes
<b>Drum Type</b>	Aluminized Alloy
<b>Exhaust Options</b>	4-Way (Rear; Right; Left & Bottom)
<b>Fuel Type</b>	Electric
<b>Reverse-a-Door</b>	Yes
<b>Additional Dryer Features</b>	Front Serviceable Glass Door Lint Filter with Reminder Removable Up-Front Lint Filter Y-connector, short and long steam hoses included
<b>Additional Optional Cycles</b>	Extended Tumble Wrinkle Care
<b>Dryer Control Features</b>	Damp Dry Signal Delay Dry - Up to 24 hours End-of-Cycle Signal LED Cycle Countdown LED Cycle Status Indicator Lights
<b>Product Type</b>	Top Load Matching

### POWER / RATINGS

<b>Volts/Watts/Amps</b>	240V,5600W,24A,60Hz or 208V,4400W,22A,60Hz
-------------------------	--

### WARRANTY

<b>Labor Warranty</b>	Limited 1-year entire appliance
<b>Parts Warranty</b>	Limited 1-year entire appliance
<b>Warranty Notes</b>	See written warranty for full details

### WEIGHTS & DIMENSIONS

<b>Depth with Door Open 90°</b>	51.75 in
<b>Height to Top of Case</b>	40.5 in
<b>Net Weight</b>	111.0 lb
<b>Overall Depth</b>	30.5 in
<b>Overall Height</b>	48.0 in
<b>Overall Width</b>	27.0 in