

DOOR & HARDWARE SCHEDULE						
MARK	SIZE	DOOR TYPE	FRAME	HWDR. NO.	STC	REMARKS
EXTERIOR DOORS						
①	3/0x7/0	STORE FRONT	TO MATCH DOOR	I	NA	STORE FRONT UNIT
②	12 X 14	ROLL-UP MTL. DR.	GALV. PTD. HOL. MET.	NA	NA	GALVANIZING TO BE G90
③	3/0x7/0	FLUSH GALV. HOL. MET. STEEL INSUL.	GALV. PTD. HOL. MET.	I	NA	GALVANIZING TO BE G90
④	8/0x7/0	CASED OPENING	GALV. PTD. HOL. MET.	NA	NA	
⑤	3/0x7/0	FLUSH GALV. HOL. MET. STEEL INSUL.	GALV. PTD. HOL. MET.	5	NA	GALVANIZING TO BE G60

DOOR HARDWARE SCHEDULE:
 1. AUTO CLOSER, PANIC BAR, AIR RESISTANT METAL THRESHOLD, WEATHERSTRIP, DOOR STOP, EXTERIOR CYLINDER LOCK (OFFICE/ENTRANCE), BALL BEARING U532D HINGES.
 2. AUTO CLOSER, DOOR STOP, CYLINDER LOCK (OFFICE/ENTRANCE), BALL BEARING U532D HINGES.
 3. PASSAGE LOCK, DOOR STOP, U526D HINGES.
 4. KEYED HANDLE (OFFICE/ENTRANCE), DOOR STOP, U526D HINGES.
 5. AUTO CLOSER, DOOR STOP, PRIVACY LOCK, BALL BEARING U526D HINGES.

- GENERAL NOTES
- INSULATION AND INSULATION ASSEMBLIES SHALL MEET THE REQUIREMENTS OF SECTION 719.
 - CONCEALED INSULATION SHALL HAVE A FLAME SPREAD OF 0-25 AND SMOKE DEVELOPED INDEX OF 0-450. EXCEPT THAT IN COMBUSTIBLE (WOOD FRAME) CONSTRUCTION.
 - FACING SHALL COMPLY WITH IBC 2009.
 - PROVIDE 5x5' LANDINGS, LEVEL WITH FINISHED FLOOR, OUTSIDE EXTERIOR DOORS ON WEST SIDE OF BUILDING. THRESHOLDS SHALL BE NOT MORE THAN 1/2" IN HEIGHT AND SHALL BE BEVELED IF MORE THAN 1/4".
 - CONTRACTOR TO VERIFY ALL SITE CONDITIONS, BUILDING LOCATIONS, AND DIMENSIONS PRIOR TO CONSTRUCTION.
 - MATERIALS SHALL BE NEW AND U.L. LISTED.
 - NO WORK SHALL BE CONCEALED UNTIL APPROVED BY LOCAL INSPECTORS.
 - CONSTRUCTION SHALL COMPLY WITH ALL PARISH, STATE, AND LOCAL CODES.
 - CONTRACTOR TO GUARANTEE WORK FOR ONE YEAR.
 - CONTRACTOR SHALL FURNISH WATER AND POWER FROM EXISTING SOURCES.
 - EXTERIOR CAULKING SHALL BE THIOKAL CAULK.
 - PAINT GRADE TO SHALL BE SHERWIN WILLIAMS OR EQUIVALENT. ALL WORK TO RECEIVE 3 COATS. COLOR SELECTION BY OWNER.
 - PROVIDE CLEANUP ON A REGULAR BASIS. NO TRASH STORED IN BUILDING.
 - ALL BATT INSULATION SHALL HAVE A CLASS "A" (0-25) FLAME SPREAD IN COMPLIANCE WITH APPLICABLE CODE.
 - USE 6" STUDS, OR 4" STAGGERED STUDS AT ALL PLUMBING WALLS.
 - PROVIDE GALVANIZED METAL PAN WITH DRAIN AT WATER HEATER LOCATION.
 - ALL CORNERS SHALL BE PROPERLY BRACED FOR WIND LOADS. A 48" SHEATHING SHALL BE PROVIDED EVERY 20 FEET OF WALL LENGTH.
 - INTERIOR LOCKS ON DOORS IN MEANS OF EGRESS SHALL NOT REQUIRE THE USE OF A KEY, SPECIAL KNOWLEDGE, OR SPECIAL DEVICE TO OPEN IN THE DIRECTION OF EGRESS. ALL DOORS SHALL HAVE LEVER TYPE HANDLES.
 - INTERIOR WALLS AND CEILINGS SHALL HAVE A FLAME SPREAD OF 0-200 AND A SMOKE DEVELOPMENT RATING OF 0-450.
 - ALL WORK SHALL COMPLY WITH THE LATEST EDITION OF ALL LOCAL, STATE, AND NATIONAL CODES COVERING THE TYPE OF WORK BEING PERFORMED.
 - PROVIDE PORTABLE FIRE EXTINGUISHERS IN ACCORDANCE WITH NFPA 101. SEE APPENDIX "E" OF NFPA 101 FOR DISTRIBUTION OF EXTINGUISHERS.
 - ALL FIRE WALLS SHALL EXTEND TIGHT TO ROOF DECK AND BE SEALED WITH AN APPROVED FIRE CAULK.
 - ALL ELECTRICAL, MECHANICAL, AND PLUMBING MATERIALS PENETRATING FIRE WALLS SHALL BE FIRE CALKED. (PENETRATIONS THROUGH RATED CONSTRUCTION SHALL BE SEALED WITH A MATERIAL CAPABLE OF PREVENTING THE PASSAGE OF FLAMES AND HOT GASES WHEN TESTED IN ACCORDANCE WITH ASTM-E814.)
 - SERVICE COUNTER SHALL HAVE A HCP ACCESSIBLE WRITING SURFACE, MAX. 36" FROM F.F. (ADAAG MANUAL 1998, PG 135)

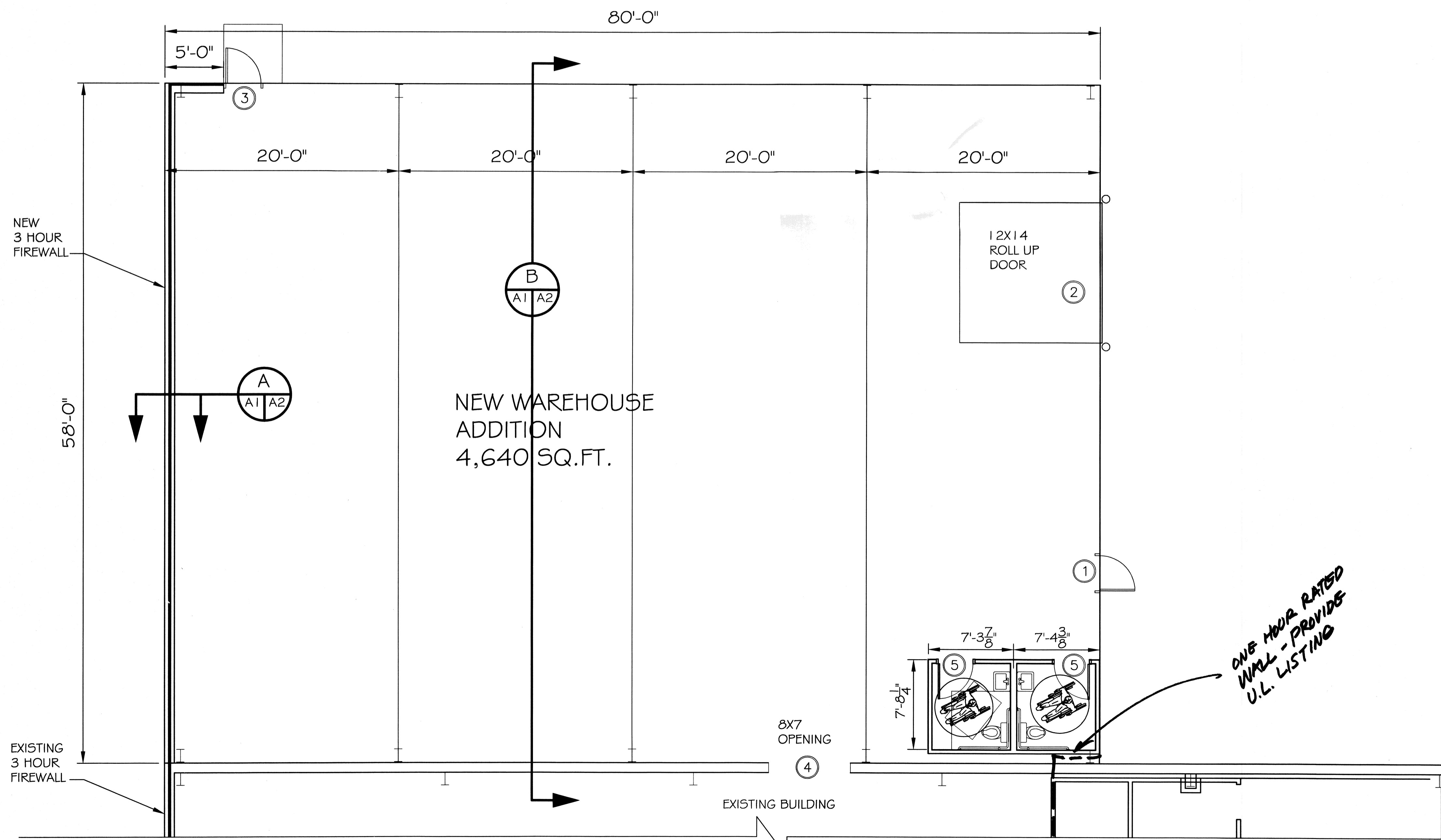

FLOOR PLAN
 SCALE: 1/8" = 1'-0"
 5/16

4 14757
 REVIEWED FOR
 STATE FIRE MARSHAL
 AS PER REVIEW LETTER
 BY: WILLIAM D. JONES, ARCHITECT, CBO
William D. Jones

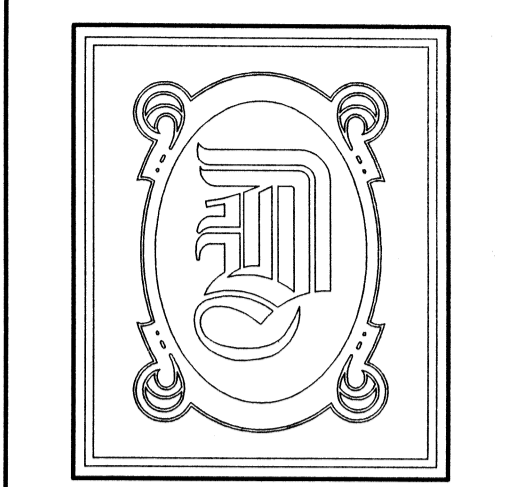

DAMMON ENGINEERING, INC.

CHIEF ENGINEER
 EMMETT DAMMON, P.E.

CHIEF ARCHITECT
 ROBERT WILTSE

554 OLD SPANISH TRAIL
 SLIDELL, LA. 70458
 OFFICE: 985-649-5832
 FAX: 985-641-5950

WEBSITE:
 WWW.DAMMONENGINEERING.COM

EMAIL:
 DAMMONENG@BELLSOUTH.NET

- ARCHITECTURE
- ENGINEERING
- STUDIES
- PLANNING
- INVESTIGATION
- EXPERT WITNESS

NEW ADDITION

FEAST CATERING
 109 TAOS
 SLIDELL
 LA

FLOOR PLAN

REV: *Robert Wiltse*

SCALE: AS NOTED

JOB#: 2140

DATE: 04-20-12

SHEET

A-1

OF