

DATE: 09/11/2023 11:53 AM PROJECT: 2475 - NEW OFFICE BUILDING - TRUWEALTH LLC - 554 OIG SPANISH TRAIL - SULLY, LA 70458

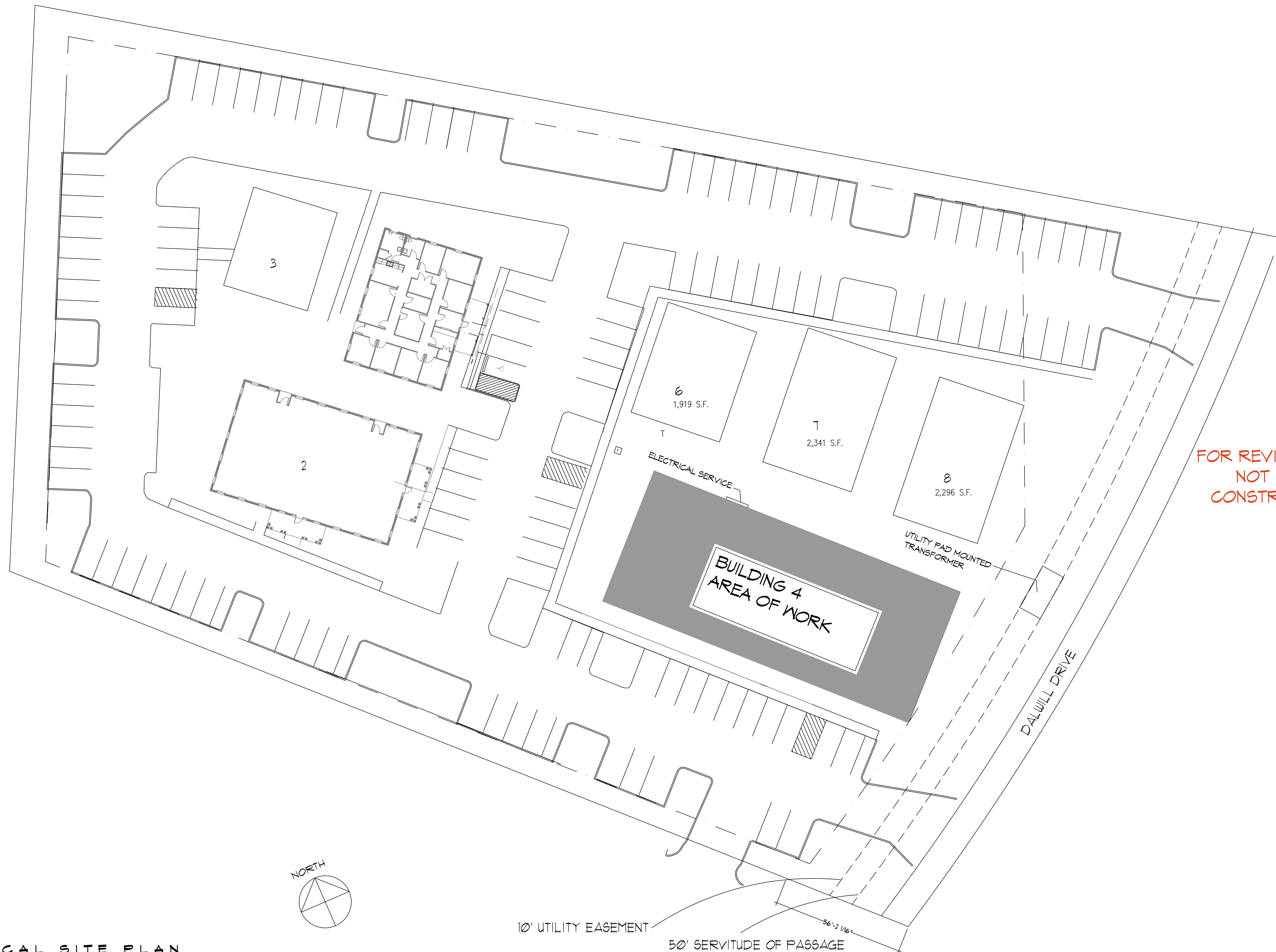

FOR REVIEW ONLY  
NOT FOR  
CONSTRUCTION

# 1 ELECTRICAL SITE PLAN

SCALE: 1" = 20'-0"

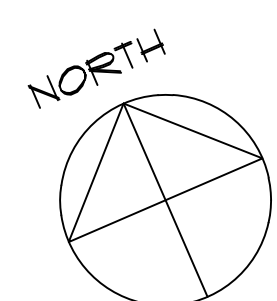

10' UTILITY EASEMENT  
50' SERVITUDE OF PASSAGE  
56'-2 1/16"

**DAMMON**  
ENGINEERING, INC.  
LOUISIANA & MISSISSIPPI

Chief Engineer: Brian Mistich, PE  
554 Old Spanish Trail  
Sulley, LA 70458  
www.dammonengineering.com  
info@dammonengineering.com  
PH: 985.649.5832

#	DESCRIPTION	REVISIONS	DATE

SEAL:

NEW OFFICE BUILDING  
TRUWEALTH LLC  
ADVISORS LLC

Dalwill Drive  
Merden, LA

JOB No: 2475 DATE: 9-11-2023  
DRAWN BY: TT CHECKED BY: PFP

SHEET TITLE:  
ELECTRICAL SITE PLAN

DRAWING NUMBER:  
**E101**  
SHEET No: