

Pool KEY:

1. Return inlets 12" below water line in accordance with LAC 51:XXIV.509 B
2. (2) Dark colored easily visible main drains
3. All materials and equipment comply with NSF Standard 50 as per LAC 51:XXIV.501 D
4. All suction grates/cover have flow rates greater than maximum system flow as per ANSI/APSP-7 2006 Section 4.6.1 and conform to ASME/ANSI A112.19.8
5. Maximum flow rate of 83 GPM producing turnover of pool every 1.75 hours.
6. Depth markers on walls and deck in accordance with LAC51:XXIV.701
7. Pool will have 12 Pole with Shepherds Hook, Ring Buoy with 40' Rope, Telephone with Phone Numbers for Police, Fire and 911 Listed in accordance with LAC51:XXIV.703
8. Pool Light of 500 watts plus exterior lights in accordance with LAC51:XXIV.715
9. Pool floor and walls to be white plaster as per LAC51:XXIV.301
- 10 ADA Chair Lift to be provided by General Contractor
- 11 SVRS Automatic Safety Vacuum Release Lock at Equipment

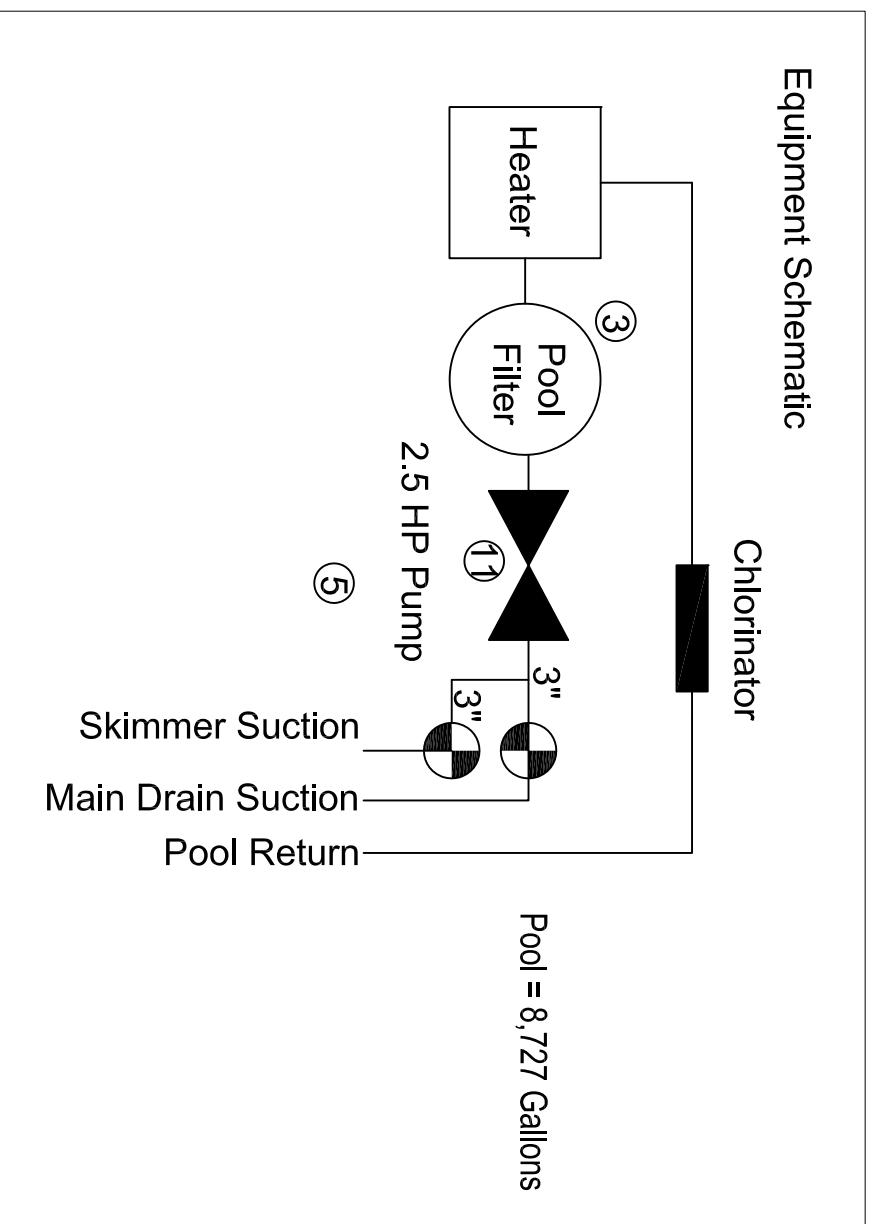

- Equipment:**
1. Pump - Jandy Stealth Pump 1.5 HP
 2. Filter - Jandy CL 340 Series Cartridge Filter
 3. Lights - Jandy 500 Watts White Light
 4. Heater - Jandy LXZ (Natural Gas) 400,000 BTU
 5. Chlorinator - Rainbow 320 In Line
 6. Controls - Mechanical Timers - Intermatic
 7. Valves - Jandy 2"

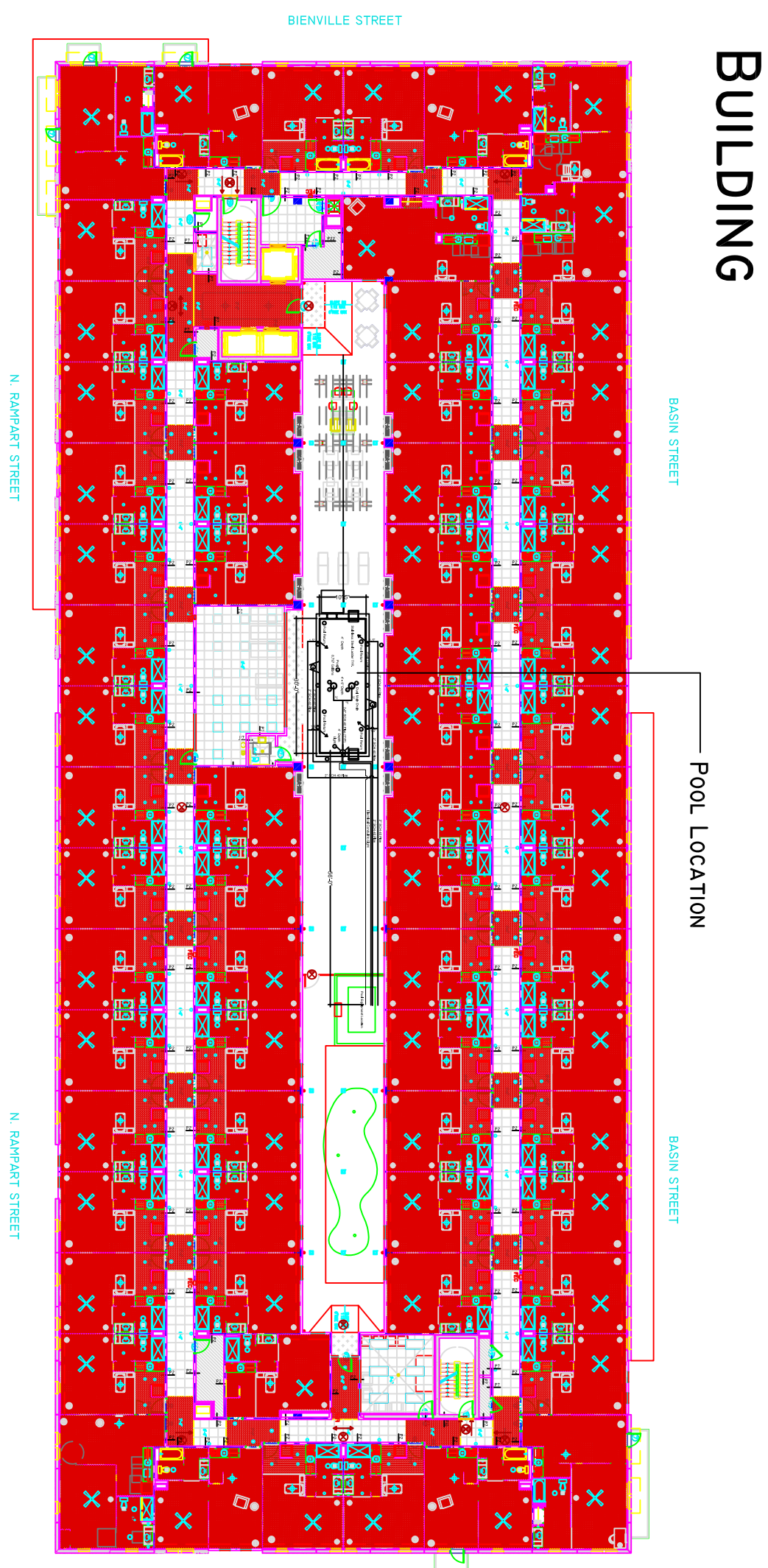
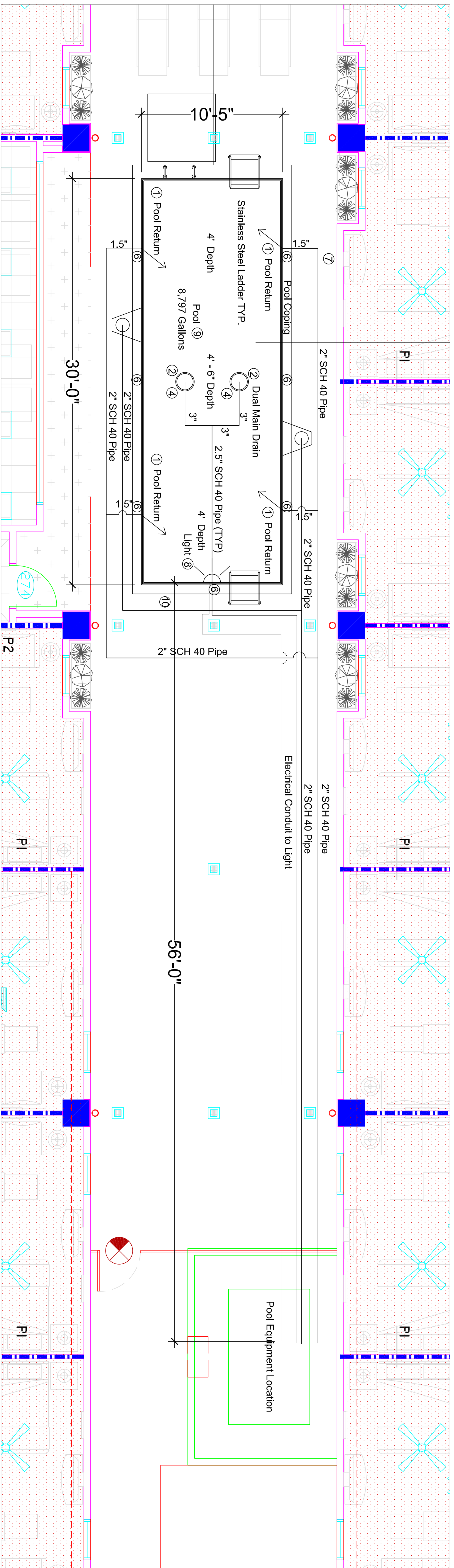

POOL Plumbing Plan
Scale 1/4" = 1'-0"

Date: 11/10/15
Drawn by: MD
Checked by:
Revision:

project no:
This drawing is the property of Specialty Pools and is not to be reproduced or copied in whole or in part without the written consent of Specialty Pools. Scale as stated herein are valid on the original drawing only.

Specialty Pools
Licensed Landscape Architects, Pool Contractors, Landscape Contractors & Horticulturist
1701 Belle Chasse Hwy. Gretna, Louisiana 70056 (504) 456 - 8534
Rampart Homewood
317 North Rampart, New Orleans - Louisiana