

FILE NAME: P:\1-RESIDENTIAL\04-2024\04-2024-01-01\04-2024-01-01.dwg
 PLOT DATE: 04/19/2024
 PLOT TIME: 10:58:10 AM
 PLOT USER: BMM

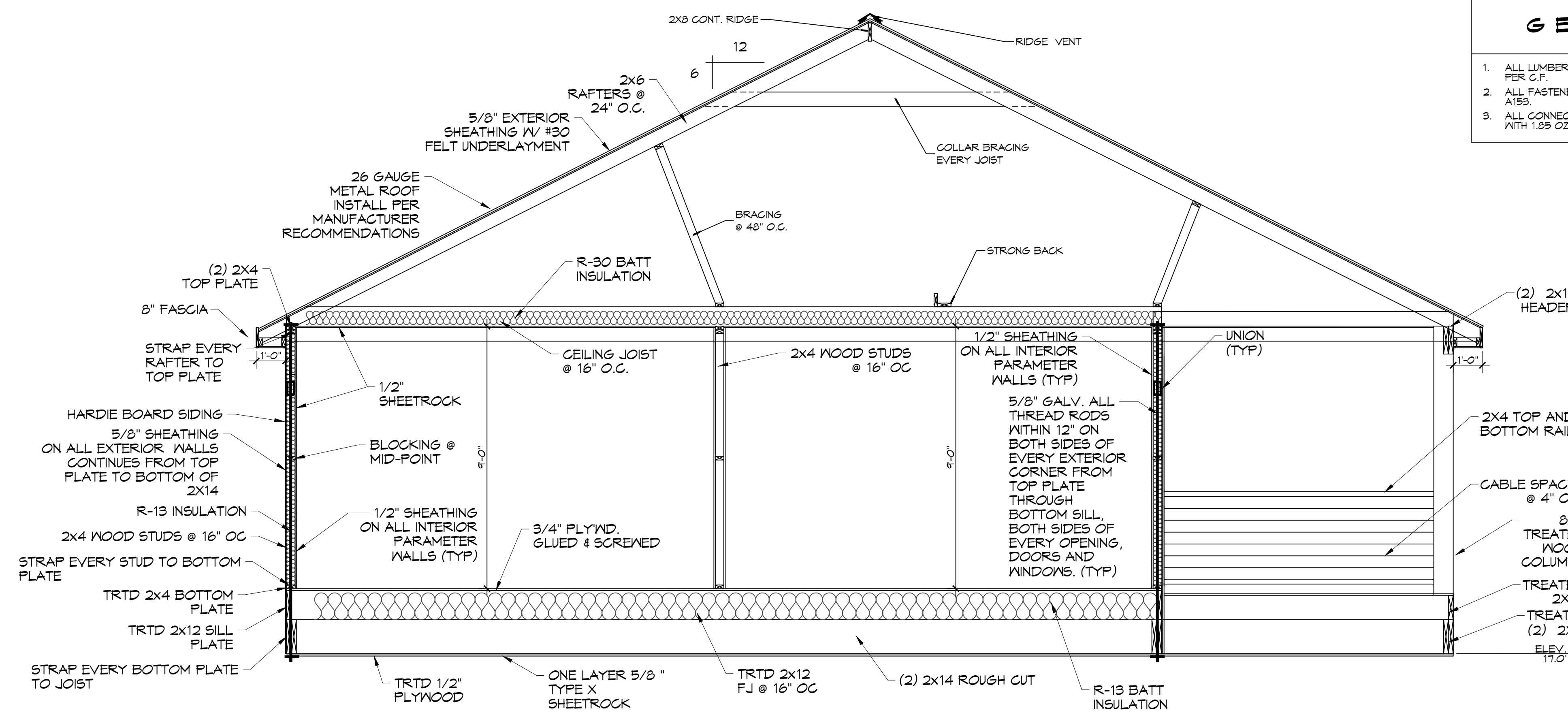

- ### GENERAL NOTES
1. ALL LUMBER SHALL BE PRESSURE TREATED WITH A RETENTION OF .4 PER C.F.
 2. ALL FASTENERS SHALL BE HOT DIPPED GALVANIZED (HDS) PER ASTM A193.
 3. ALL CONNECTORS SHALL BE HDG PER ASTM A653, CLASS G185 SHEET WITH 1.05 OZ/SF ZINC COATING.

- ### ROOF TIE-DOWNS
1. SEC. 18-10. - ROOF TIE-DOWN STRAPS.
 2. FOR ALL NEW CONSTRUCTION, ROOF TIE-DOWN STRAPS WILL BE REQUIRED TO AID IN THE STRUCTURAL INTEGRITY OF A STRUCTURE TO WITHSTAND A 150 MPH WIND EVENT.
 3. ONLY GALVANIZED STEEL STRAPPING SHALL BE UTILIZED. STRAPPING SHALL HAVE A MINIMUM SECTION OF ONE AND ONE-FOURTH INCH BY ONE-EIGHTH INCH AND HAVE A MINIMUM BREAKING STRENGTH OF 4,750 POUNDS. NO SPLICES WILL BE ALLOWED.
 4. ROOF TIES SHALL BE INSTALLED AT EACH EXTERIOR PILING AND ALONG THE STRUCTURE'S SILL. THE MAXIMUM SPACING FOR ROOF TIE-DOWN STRAPS SHALL BE TEN FEET.
 5. ROOF TIE-DOWN STRAPS SHALL BE ATTACHED TO THE STRUCTURE'S SILL OR PILING, RUN ALONG THE SIDE WALL, OVER THE ROOF STRUCTURE FRAMING AND DECKING, AND ATTACHED TO THE SILL ON THE OPPOSING SIDE OF THE STRUCTURE.
 6. COMMERCIALY AVAILABLE ADAPTERS SHALL BE UTILIZED TO PREVENT SHARP BENDS IN THE TIES AND TO KEEP THEM FROM CUTTING INTO THE STRUCTURAL FRAMING WHEN TENSION IS APPLIED.

HOUSE SECTION
SCALE: 3/8" = 1'-0"

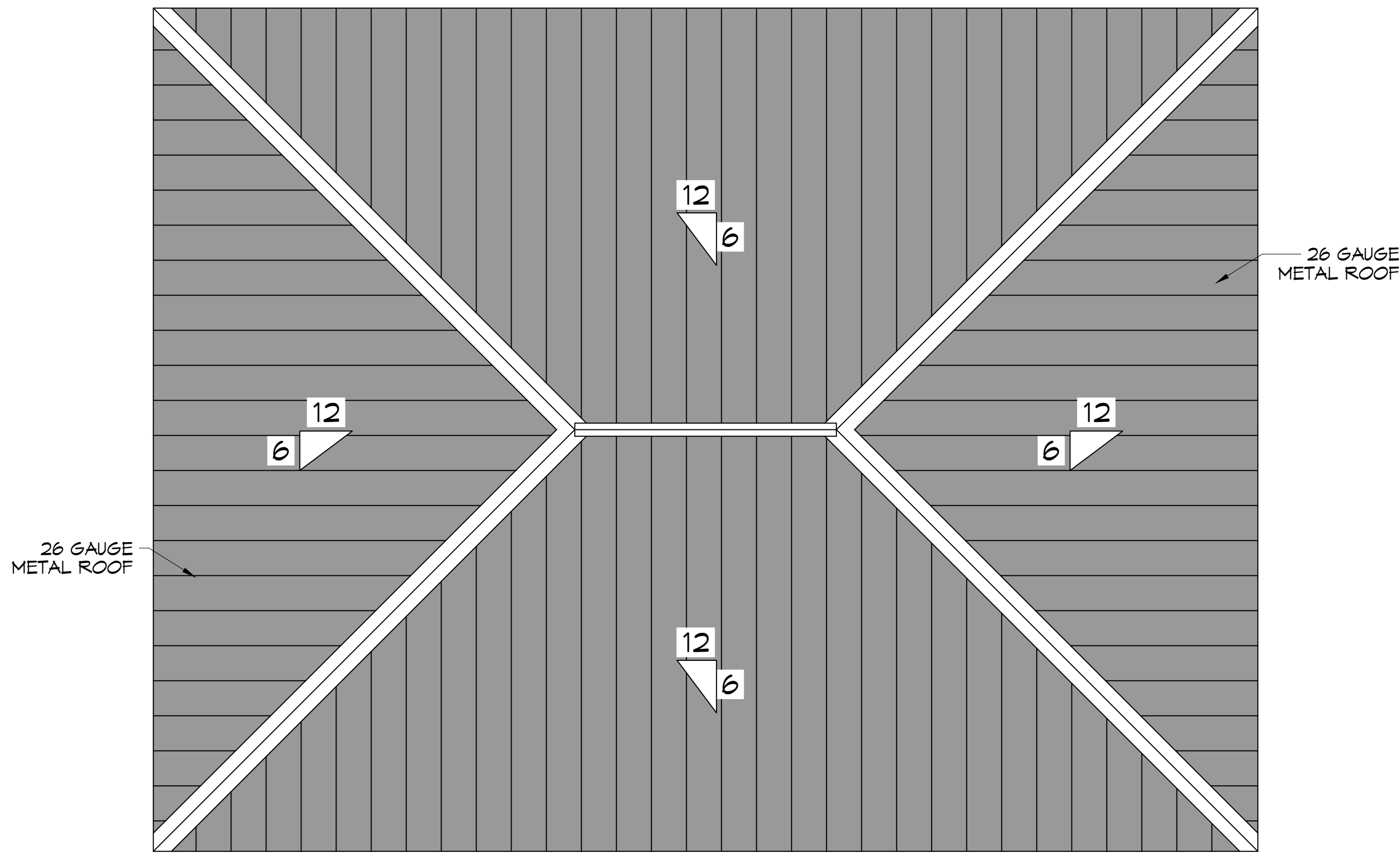

ROOF PLAN
SCALE: 1/4" = 1'-0"

DAMMON ENGINEERING, INC.

LOUISIANA & MISSISSIPPI
 Chief Engineer: Brian Mistich, PE
 554 Old Spanish Trail
 Slidell, LA 70458
 www.dammonengineering.com
 info@dammonengineering.com
 PH: 985.649.8832

REVISIONS	DATE
#	DESCRIPTION



BOAT HOUSE PLAN

ALBERT CUITTO

LOT 16
 21781 CHEF MENTEUR HWY
 NEW ORLEANS, LOUISIANA 70128
 JOB No: 2024 | DATE: 04-19-2024
 DRAWN BY: CKD | CHECKED BY: BMM

SHEET TITLE:
HOUSE SECTION AND ROOF PLAN

DRAWING NUMBER:

S106