

ONE-LINE DIAGRAM
SCALE: NTS

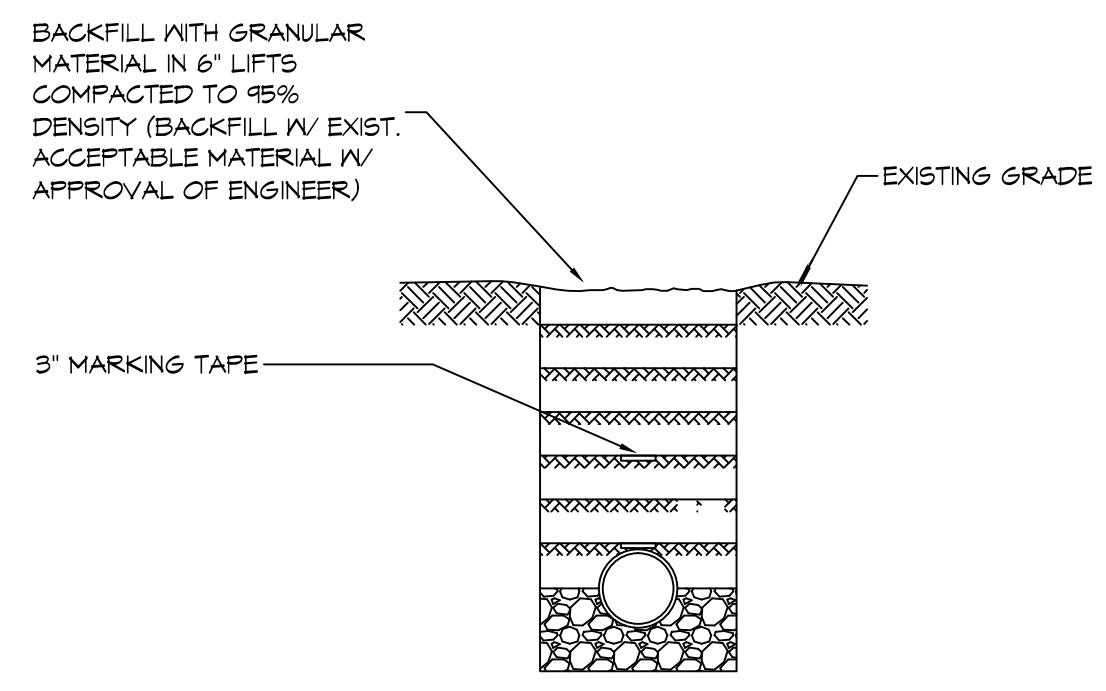

4 DETAIL
SCALE: NTS ELECTRICAL SERVICE CONDUIT

DATA, VOICE AND COAX

1. CONTRACTOR SHALL INSTALL CAT 6 CABLING, BELDEN OR EQUAL, FOR ALL DATA AND VOICE CONNECTIONS. TERMINATE ALL CAT 6 CABLES IN UTILITY ROOM USING A 110-8 PORT RJ-45 PATH PANEL, FANOUT OR EQUAL.

A. CAT 6 CABLING SHALL BE TERMINATED USING STANDARD SPECIFIED BY MANUFACTURER AND TESTED USING A CERTIFIED CABLE ANALYZER. PROVIDE ENGINEER TEST RESULTS FOR EACH CABLE DROP.

B. CAT 6 TERMINATIONS INSIDE THE RESIDENCE, SHALL USE A FLUSH MOUNTED CAT 6 RJ-45 CONNECTOR PORT WITH PLASTIC COVER PLATE, LEVITON OR EQUAL, COLOR BY ARCHITECT.

2. ALL CATV CABLE SHALL BE RG-6 COPPER SHIELDED, COAXIAL CABLE WITH SOLID COPPER CONDUCTOR, BELDEN OR EQUAL. ALL COAXIAL CABLE SHALL BE 75 OHMS. CONTRACTOR TO CERTIFY ALL DROPS USING A D-SAM 3600, OR EQUAL, NETWORK ANALYZER. TEST SHALL INCLUDE BUT NOT LIMITED TO NOISE MITIGATION.

A. CATV CABLE TERMINATION:

1). ALL 'F' CONNECTORS TO BE ENVIRONMENTALLY SEALED, COMPRESSION TYP FITTINGS.

2). ALL RF SIGNAL DISTRIBUTIONS COAXIAL CABLE AT THE 'USER END' SHALL BE TERMINATED WITH FEMALE 'F' CONNECTOR WITH A PLASTIC COVER PLATE, LEVITON OR EQUAL, COLOR BY ARCHITECT.

B. WHERE DATA AND CATV ARE INSTALLED IN THE SAME LOCATION A SINGLE COVER PLATE SHALL BE USED, COLOR BY ARCHITECT.

GENERAL ELECTRIC AL NOTES

- DRAWINGS ARE DIAGRAMMATIC ONLY. FURNISH ALL CONDUIT, WIRING, PANELS, BREAKERS, DISCONNECTS, ACCESSORIES, ETC. FOR COMPLETE INSTALLATION RATHER OR NOT EVERY ITEM IS SHOWN OR SPECIFIED.
- THESE DRAWINGS ARE INTENDED AS GENERAL GUIDELINES FOR PURPOSES OF ESTABLISHING CERTAIN MIN. CRITERIA, AND DO NOT NECESSARILY REPRESENT THE FINAL LAYOUT, ARRANGEMENT, SIZE, BRAND NAME, CAPACITY OR OTHER CHARACTERISTICS OF THE ENGINEERED SYSTEM. SYSTEM SHALL BE DESIGNED IN ACCORDANCE WITH ALL APPLICABLE CODES, STANDARDS AND REQUIREMENTS OF LOCAL UTILITY OFFICIALS.
- INSTALL GFCI OUTLETS AS REQUIRED BY APPLICABLE CODES. INSTALL GROUND FAULT RECEPTACLES AT RECEPTACLE LOCATIONS WITHIN 5' OF SINKS OR LAVATORIES, AND AT EXTERIOR LOCATIONS. EXTERIOR RECEPTACLES SHALL ALSO BE WEATHERPROOF.
- INSTALL HARDWIRED SMOKE DETECTORS WITH BATTERY BACKUP AS REQUIRED. INTER-CONNECT DETECTORS SO THAT ALL WILL SOUND SHOULD ONE DETECTOR ACTIVATE.
- SOME EQUIPMENT SHOWN ON OTHER PLANS MAY REQUIRE ELECTRICAL SERVICE, SUCH AS WATER HEATER, CONDENSING UNITS, AIR-HANDLING UNITS, CONDENSATE PUMPS, ETC.. ELECTRICAL CONTRACTOR SHALL INCLUDE ELECTRICAL SERVICE TO ALL SUCH EQUIPMENT. COORDINATE WITH OTHER TRADES CONCERNING ITEMS REQUIRING ELECTRICAL SERVICE. PROVIDE ONE DUPLEX OUTLET AND LIGHT IF UNIT IS IN NON-LIT AREA FOR EVERY CONDENSING UNIT AND EVERY AIR-HANDLING UNIT AS REQUIRED BY APPLICABLE CODES.
- OBTAIN NAME PLATE AND RATING OF ALL EQUIPMENT BEFORE ROUGHING IN AND PROVIDE WIRING OF PROPER SIZE, VOLTAGE, AND AMPACITY. PROVIDE FUSED OR NON-FUSED DISCONNECT SWITCH AS REQUIRED.
- PROVIDE PANEL BOARDS OF PROPER VOLTAGE AND AMPACITY FOR ALL ELECTRICAL CIRCUITS.
- VERIFY SERVICE REQUIREMENTS WITH LOCAL POWER COMPANY INCLUDING TRANSFORMER LOCATIONS AND TYPES, DISCONNECTS AT EXTERIOR OF BLDG., VOLTS AND AMPACITIES AND OTHER DETAILS OF ELECTRICAL CONSTRUCTION. SIZE ALL FEEDERS ACCORDING TO NEC REQUIREMENTS.
- RUN ALL CABLE CONCEALED IN WALLS, CEILING OR FLOORS UNLESS NOTED OTHERWISE.
- SUPPORT ALL FIXTURES AND OTHER ITEMS RIGIDLY FROM STRUCTURE.
- INSULATE AND SEAL SOLIDLY BEHIND RECEPTACLES IN EXTERIOR WALLS.
- WHERE MORE THAN ONE SWITCH OCCURS IN THE SAME LOCATION, THEY SHALL BE INSTALLED IN A GANG TYPE BOX UNDER ONE COVER PLATE.
- ALL OUTLETS SHALL BE INSTALLED 18" AFF UNLESS NOTED OTHERWISE.
- ALL CEILING PENETRATIONS SHALL BE SEALED TO PREVENT THE MOVEMENT OF AIR AND MOISTURE.
- ALL 120V 15A AND 20A OUTLETS SHALL BE ARC-FAULT CIRCUIT INTERRUPTER COMPLIANT.

GENERAL UTILITY NOTES

- USE SCH. 80 PVC CONDUIT WHERE PIPE IS EXPOSED ABOVE GRADE. TRANSITION TO SCH. 40 PVC BELOW GRADE. ALL 90° ELBOWS TO BE LONG SWEEP TYPE.
- 120/240V 10 200A SERVICE FROM UTIL. CO., FEEDER BY UTIL. CO TO METER BOX. FIELD LOCATE TRANSFORMER ON POLE AND COORDINATE WITH ELEC. COMPANY REGARDING NEW ELECTRICAL SERVICE CONNECTION.
- CONTACT LOUISIANA ONE CALL BEFORE DIGGING.

ELECTRICAL POWER LEGEND

⊕	DUPLEX OUTLET	⊗	120V CARBON MONOXIDE DETECTOR
⊕	COUNTER-HT DUPLEX OUTLET	⊗	120V SMOKE DETECTOR W/ 9VDC BATTERY BACKUP
⊕	QUAD OUTLET	⊕	COAXIAL OUTLET
⊕	DUPLEX OUTLET W/ USB CHARGER	⊕	THERMOSTAT
⊕	FLOOR QUAD OUTLET	⊕	DISCONNECT DOOR BELL
⊕	FLOOR TELEPHONE BOX	⊕	JUNCTION BOX
▷	DATA OUTLET (WALL)	⊕	DOOR BELL JUNCTION BOX
▷	TELEPHONE OUTLET (WALL)	⊕	DOOR BELL
⊕	GROUND FAULT INTERRUPTER (GFCI)	---	WIRING CONCEALED IN CEILING OR WALL
⊕	GFCI OUTLET W/ WEATHER PROOF COVER	---	WIRING CONCEALED IN FLOOR
⊕	METER	---	EXPOSED WIRING
T	LINE VOLTAGE THERMOSTAT	→	HOME RUN TO PANEL BOARD

ELECTRICAL LIGHTING LEGEND

⊗	FAN/LIGHT COMBINATION	⊕	WALL MOUNTED LIGHT FIXTURE
⊕	RECESSED LIGHT FIXTURE (6\"/>		

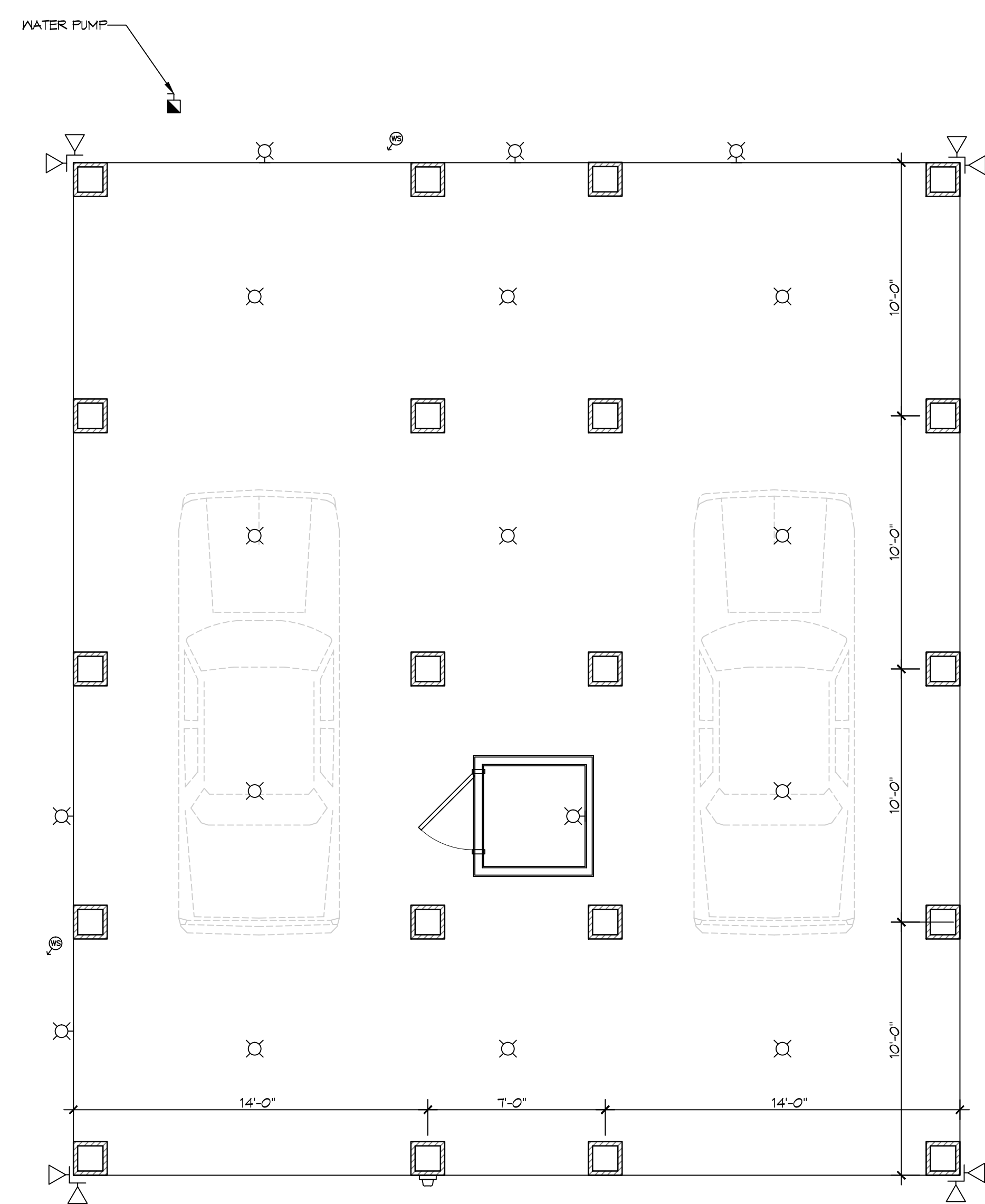

1 ELECTRICAL PLAN
SCALE: 1/4" = 1'-0"

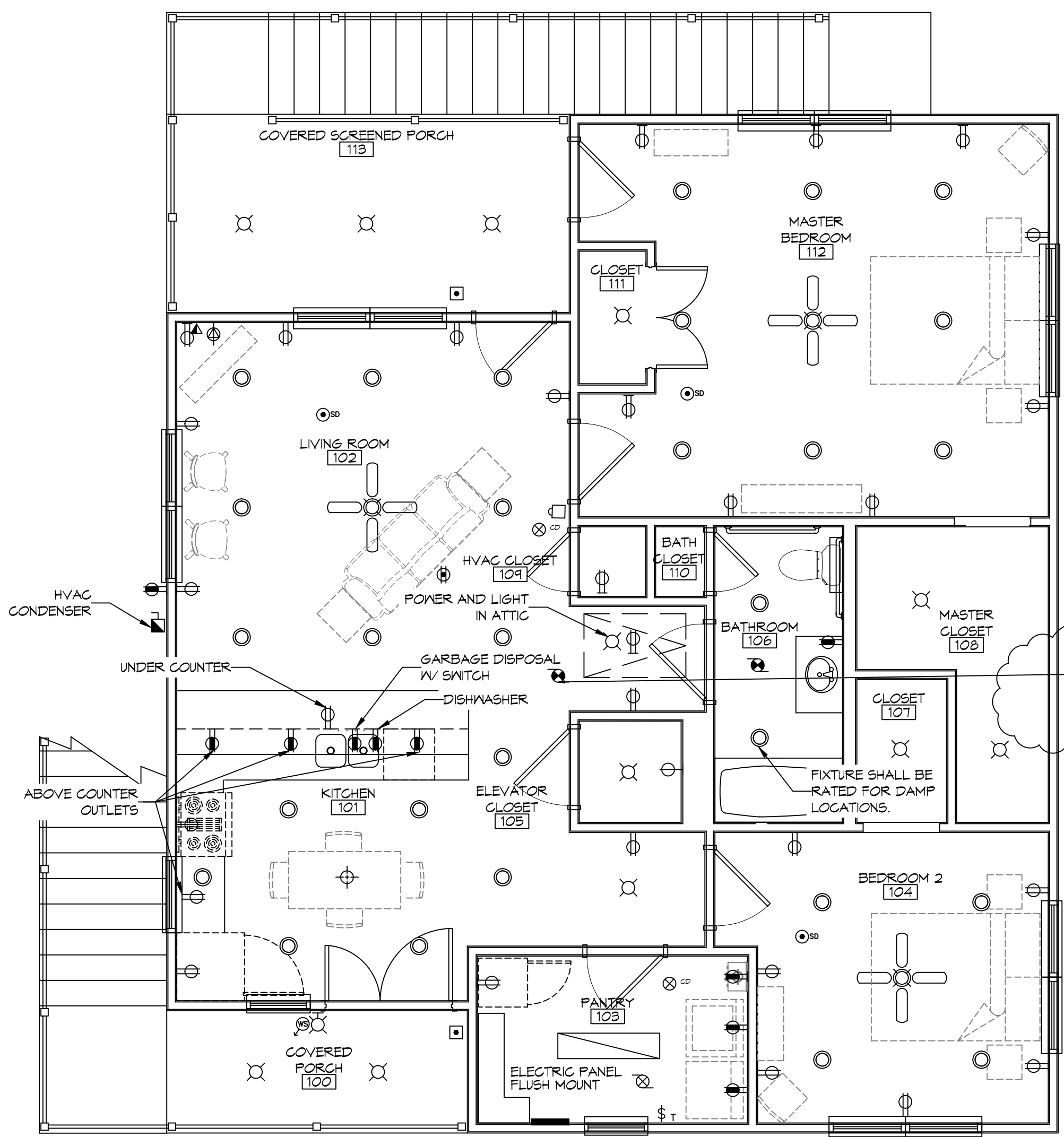

2 ELECTRICAL PLAN
SCALE: 1/4" = 1'-0"

REVISIONS	DATE
# DESCRIPTION	
1 ADDED CB ON METER AND ADD ATTIC FAN	9/17/2018

SEAL:

DATE: 8-3-2018
DRAWN BY: DPD
CHECKED BY: DPD
JOB NO: 101
VICKY MAGAS
261 CARR DR.
SLIDELL, LA 70458