

FILE NAME: J:\1 - EXISTING\144 - Healthy School Food Collaborative\144\144-0100 - SITE PLAN.dwg PLOT DATE & TIME: Tuesday, October 26, 2021 10:53:25 AM

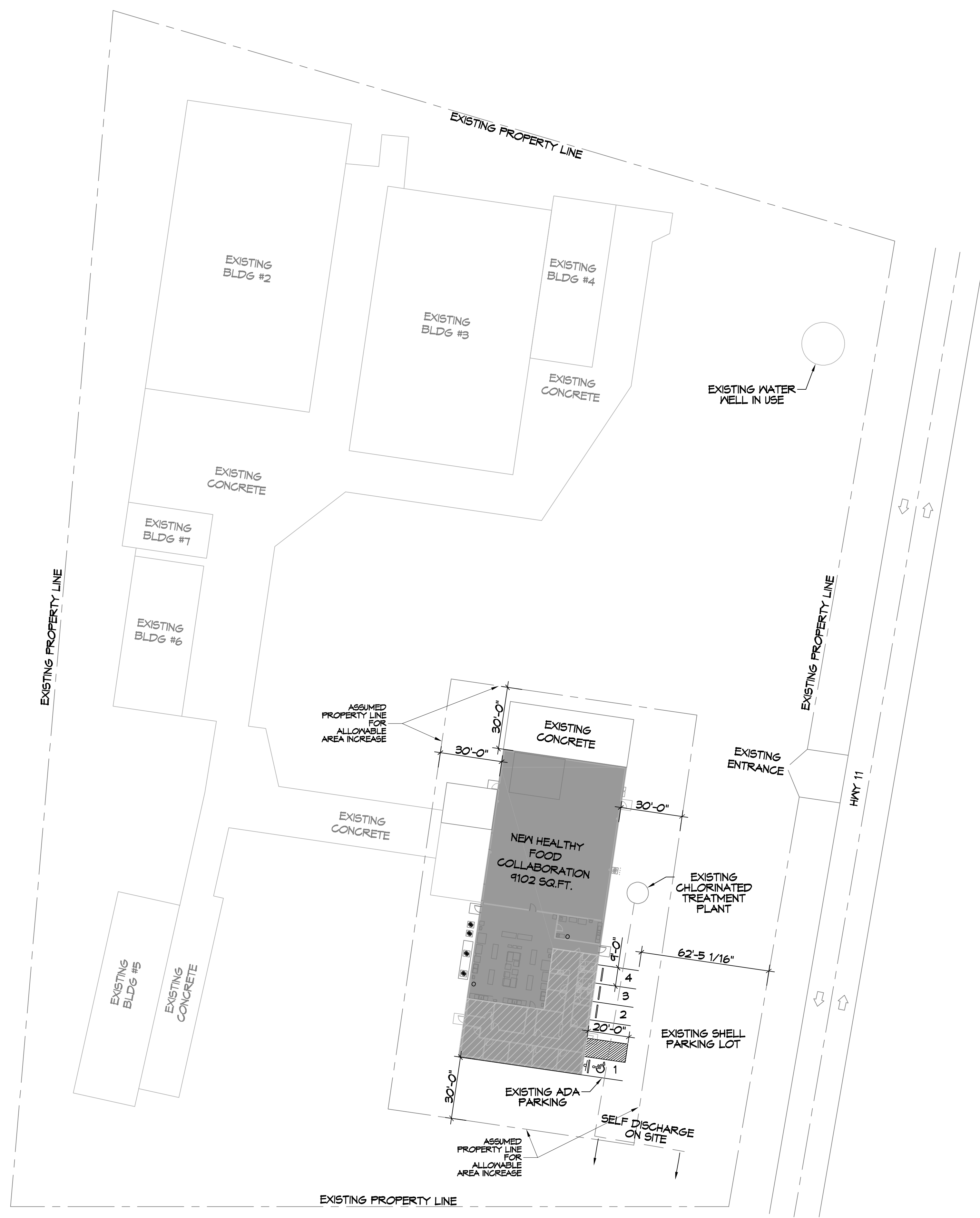

2 SITE PLAN
SCALE: 1" = 30'

PLANING
ZONED H-1 HIGHWAY COMMERCIAL
FLOOD ZONE
ZONE "X"
BUILDING ELEVATION
BASE FLOOD ELEVATION = X'
SITE LIGHTING
EXTERIOR LIGHTING SHALL BE SHADED OR INWARDLY DIRECTED IN SUCH A MANNER SO THAT NO DIRECT LIGHTING OR GLARE BE CAST BEYOND THE PROPERTY LINE. THE INTENSITY OF SUCH LIGHTING SHALL NOT EXCEED ONE FOOT CANDLE AS MEASURED AT THE ADJUTING PROPERTY LINE.

DAMMON ENGINEERING, INC.
LOUISIANA & MISSISSIPPI

www.dammonengineering.com
info@dammonengineering.com
Chief Engineer: Brian Misch, PE
554 Old Spanish Trail
Slidell, LA 70458
PH: 985.649.5332

#	DESCRIPTION	REVISIONS	DATE

SEAL:

**NEW FOOD DISTRIBUTION
HEALTHY SCHOOL
FOOD COLLABORATIVE**

62271 HWY 11
PEARL RIVER, LOUISIANA 70452
JOB No: 2444 | DATE: 10-25-2021
DRAWN BY: CKD | CHECKED BY: KJK

SHEET TITLE:
SITE PLAN

DRAWING NUMBER:
C100