

1st STRUCTURAL ROOF PLAN
SCALE: 3/32"=1'-0"

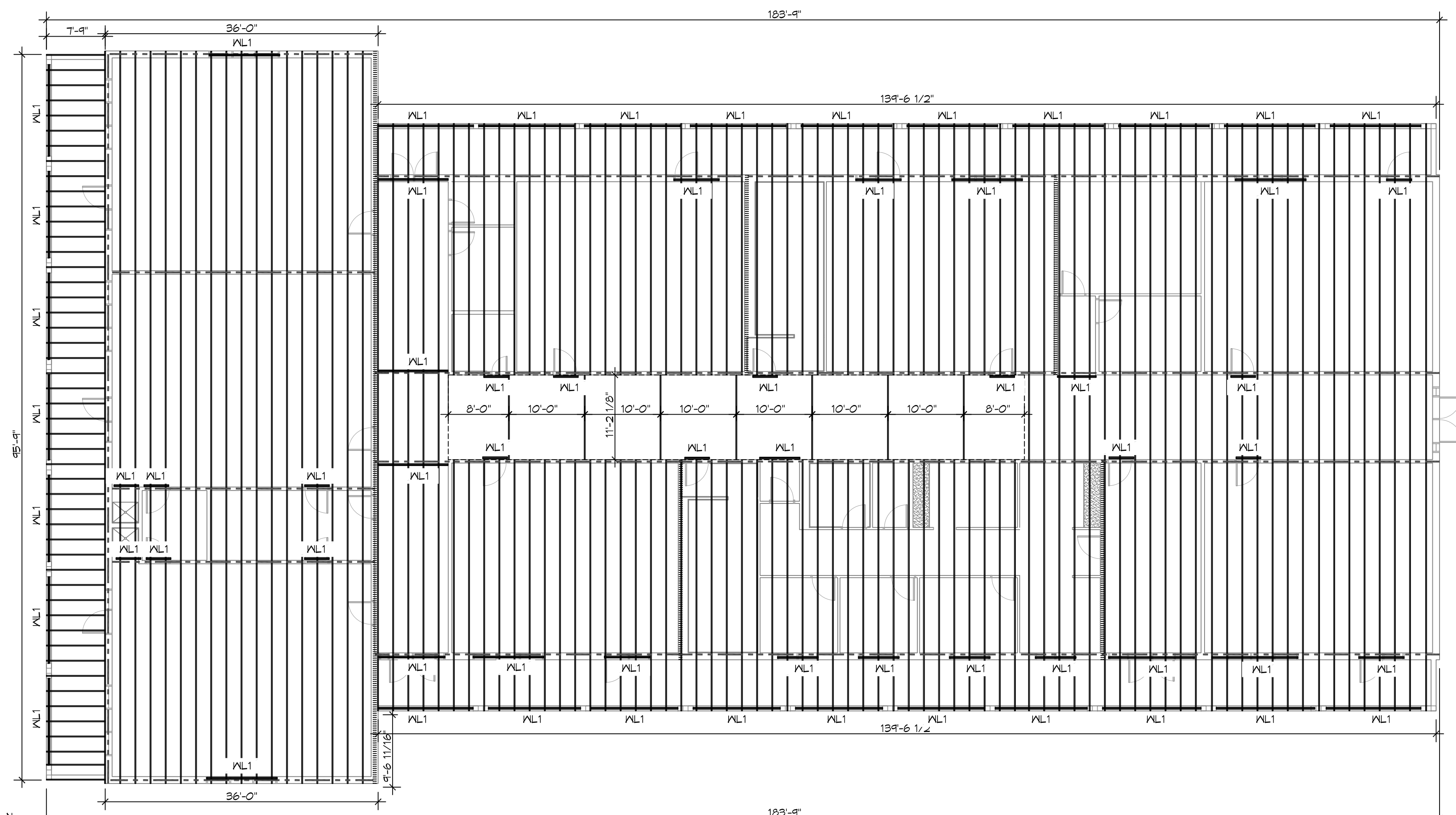

1st STRUCTURAL FRAMING PLAN
SCALE: 3/32"=1'-0"

STUD SCHEDULE		
LOCATION	SPACING	STRUCTURAL STUD SECTION
EXTERIOR WALLS	16" O.C.	2X6
CORRIDOR WALLS	16" O.C.	2X6
INTERIOR 3.5" LOAD BEARING	16" O.C.	2X4
INTERIOR 3.5" NON-LOAD BEARING	16" O.C.	2X4
INTERIOR 6" NON-LOAD BEARING	16" O.C.	2X6

NOTE:
ALL DIMENSIONAL LUMBER SHALL BE A MINIMUM GRADE OF SOUTHERN PINE #2

LOAD LEGEND	
	LOAD BEARING WALL
	DENOTES WALL TO ACT AS SHEAR WALL; STRAP BOTH WALLS WITH 2" I-B-GAGE SHEAR WALL BRACING STRAP ATTACHING TO EACH STUD IN A CROSS CONFIGURATION.

LINTEL SCHEDULE	
MARK	SIZE
XL1	THREE 2X12

WIND SPEED DESIGN REQUIREMENTS	
THIS BUILDING SHALL BE DESIGNED WITH IBC SEC 1609 AS A FULLY ENCLOSED BLDG USING THE FOLLOWING INFORMATION:	
WIND DESIGN DATA:	
DETERMINATION OF WIND LOADS SHALL BE IN ACCORDANCE WITH IBC SEC 1604.3 (A), (B), OR (C) DEPENDING ON THE RISK CATEGORY	
BASIC WIND SPEED (3 SECOND GUST) =	130 MPH (IBC FIG 1604C)
RISK FACTOR: CATEGORY I BLDG	SURFACE ROUGHNESS = C
TOPOGRAPHIC FACTOR = 1	EXPOSURE = C
DESIGN WIND PRESSURE (ASCE 7-10 TABLE 26.6-1):	34.7 PSF
INTERNAL PRESSURE COEFFICIENT (ASCE 7-10 TABLE 26.11-1):	± 0.18
LIVE LOADS (IBC SEC 1607)	
SCHOOLS, CLASSROOMS	40 PSF
SCHOOLS, 1ST-FLOOR CORRIDORS	100 PSF
OFFICES LOBBIES & 1ST FL CORRIDORS	100 PSF
OFFICES	50 PSF
STORAGE, LIGHT (IBC TABLE 1607.1):	125 PSF
ROOF LIVE LOADS (IBC TABLE 1607.1):	20 PSF UNIFORM, 300 LB CONCENTRATED
SNOW LOADS (IBC TABLE 1608):	
GROUND SNOW LOAD (IBC FIG 1608.2):	5 PSF

95 % COMPLETE

DAMMON ENGINEERING, INC.
LOUISIANA & MISSISSIPPI
www.dammonengineering.com
info@dammon.com
PH: 905.499.8832

Chief Engineer: Brian Misch, PE
554 Old Spanish Trail
Stidell, LA 70468

REVISIONS	DATE
# DESCRIPTION	

SEAL:

SHELL-ONLY PACKAGE
CHRIST EPISCOPAL CLASSROOM
80 CHRISTWOOD BOULEVARD
COVINGTON, LA 70435
JOB No: 05-1T-2016 DATE: 2/13/16
DRAWN BY: JAG/MH CHECKED BY: CND

SHEET TITLE:
STRUCTURAL PLAN

DRAWING NUMBER:

S101