

SYLVAN LEARNING CENTER

RENOVATION = 2750 SQ.FT.

TYLER SQUARE

SUITE #3 & #4

58465 TYLER STREET

SLIDELL, LA 70458

INTERNATIONAL BUILDING CODE 2009 SUMMARY

OCCUPANCY CLASSIFICATION:
 BUSINESS GROUP: B (SEC 304.1)

OCCUPANT LOAD: (TBL 1004.1.1)
 BUSINESS = 100 GROSS / OCCUPANT = 27.50/100 = 27.50 OCCUPANTS
 TOTAL LOAD = 28.00 OCCUPANTS

EXIT ACCESS REQUIREMENTS: (SEC 101.4)
 EXIT REQUIRED FOR < 50 OCCUPANTS (TBL 1015.1)
 EXIT PROVIDED
 MAXIMUM COMMON PATH OF EGRESS TRAVEL = 200' (BUSINESS WITHOUT SPRINKLER, TBL 1016.1)
 LONGEST EGRESS PATH IN AREA OF WORK = 44'

CONSTRUCTION CLASSIFICATION: (SEC 602.2)
 TYPE IIB

ALLOWABLE HEIGHT AND BLDG. AREA: (TBL 503)
 THREE STORY AND 23,000 SQ.FT. (BUSINESS)
 THIS BLDG 11,000 SQ.FT. / 1 STORY

FIRE RESISTANCE RATING REQUIREMENTS FOR BLDG. ELEMENTS: (TBL 601)
 STRUCTURAL FRAME = 0 HRS.
 BEARING WALLS (INTERIOR AND EXTERIOR) = 0 HRS.
 NON-BEARING WALLS = 0 HRS.
 FLOOR CONSTRUCTION = 0 HRS.
 ROOF CONSTRUCTION = 0 HRS.

FIRE RESISTANCE REQUIREMENTS FOR EXTERIOR WALLS: (TBL 602)
 EXTERIOR WALLS WITH >= 30' FIRE SEPARATION DISTANCE = 0 HRS.
 EXTERIOR WALLS WITH < 5' FIRE SEPARATION DISTANCE = 1HR.

MAX. AREA OF EXTERIOR WALL OPENINGS: (TBL 705.6)
 BLDGS WITH >= 50' FIRE SEPARATION DISTANCE ALLOWED UNLIMITED PROTECTED AND UNPROTECTED OPENINGS

AUTOMATIC SPRINKLER SYSTEM REQUIREMENTS: (SEC 903)
 THIS BLDG: DOES REQUIRE NOT AN AUTOMATIC SPRINKLER SYSTEM.

FIRE PROTECTION SYSTEM REQUIREMENTS: (SEC 907)
 THIS BLDG: SHALL BE NOT REQUIRED TO HAVE AN APPROVED FIRE PROTECTION SYSTEM IN ACCORDANCE WITH SEC 907.2.2.

CONSTRUCTION DOCUMENTS: (SEC 1603)
 THIS BLDG. SHALL BE DESIGNED IN ACCORDANCE WITH IBC SECTION 1609 AS A FULLY ENCLOSED BLDG. USING THE FOLLOWING INFORMATION:
 WIND DESIGN DATA:
 DETERMINATION OF WIND LOADS SHALL BE IN ACCORDANCE WITH IBC SEC 1609.4
 BASIC WIND SPEED (3 SECOND GUSTS) = 130 MPH (FIG 1609)
 IMPORTANCE FACTOR: CATEGORY II BLDG., IE = 1.00, IS = 1.0, IW = 1.00 (TBL 1604.5)
 EXPOSURE B
 DESIGN WIND PRESSURE (ASCE 7-05 FIG. 6-2): 33.6 PSF
 INTERNAL PRESSURE COEFFICIENT (ASCE 7-05 FIG. 6-5): ± 0.18
 LIVE LOADS: (SEC 1607)
 OFFICE (TBL 1607.1): 50 PSF
 ROOF LIVE LOAD (TBL 1607.1) = 20 PSF UNIFORM, 300 LB. CONCENTRATED
 GROUND SNOW LOAD (FIG. 1608.2) = 5 PSF

NATIONAL FIRE PROTECTION ASSOCIATION 2009 SUMMARY

BUILDING AREA:
 TOTAL BUILDING AREA = 11,000 SQ.FT.
 AREA TO BE RENOVATED = 2750 SQ.FT.

OCCUPANCY CLASSIFICATION:
 EXISTING GROUP B (BUSINESS)

OCCUPANT LOAD: (TBL 7.3.1.2)
 BUSINESS = 100 GROSS SQ.FT. / OCCUPANT = 2.750 / 100 = 28.00 OCCUPANTS

SPRINKLER SYSTEM: (SEC 39.2.5)
 THIS BUILDING SHALL NOT BE REQUIRED TO HAVE AN AUTOMATIC SPRINKLER SYSTEM AT THIS TIME.

FIRE ALARM SYSTEM: (SEC 39.3.4.1)
 A FIRE ALARM SYSTEM IS NOT REQUIRED.

EXIT ACCESS:
 EXITS REQUIRED (SEC 39.2.4.1)
 EXITS PROVIDED
 ALLOWABLE EXIT ACCESS TRAVEL DISTANCE = 200' (SEC 39.2.6.2)
 LONGEST EGRESS PATH IN AREA OF WORK = 44'

INDEX OF DRAWINGS

SHT#	DWG#	COVERSHEET	DRAWING NAME	REVISED
1				
2	A-1	FLOOR PLAN & REFLECTED CEILING PLAN		
3	M-1	MECHANICAL PLAN		
4	E-1	POWER AND LIGHTING PLAN		

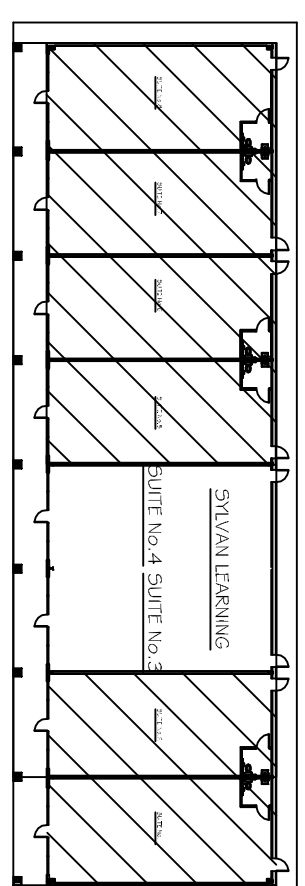

VICINITY MAP
 N.T.S.

KEY PLAN
 N.T.S.

CHIEF ENGINEER: EMMETT DAMMON, P.E.
 CHIEF ARCHITECT: ROBERT WILTSE
 554 OLD SPANISH TRAIL
 SLIDELL, LA 70458

www.dammonengineering.com
 dammonem@bellsouth.net
 PHONE: 985-649-5832
 FAX: 985-641-5950

DAMMON
 ENGINEERING, INC.
 Architects & Engineers



The above drawings and specifications, drawings and annotations incorporated thereby are and shall remain the property of Dammon Engineering, and no part thereof shall be copied, altered, or used in connection with any work or project other than the specific project for which they have been prepared and approved without written consent of Dammon Engineering. Your contract with these drawings or specifications shall constitute conclusive evidence of acceptance of these terms and conditions.

SYLVAN LEARNING CENTER

TYLER SQUARE
 58465 TYLER STREET SUITE #3 & #4
 SLIDELL, LA

JOB No: 2153 DATE: 10-11-12
 DRAWN BY: BSN CHECKED BY: BSN