

# SYLVAN LEARNING CENTER

RENOVATION = 2750 SQ.FT.

TYLER SQUARE

SUITE #3 & #4

58465 TYLER STREET

SLIDELL, LA 70458

## INTERNATIONAL BUILDING CODE 2009 SUMMARY

OCCUPANCY CLASSIFICATION:  
BUSINESS GROUP: B (SEC 304.1)

OCCUPANT LOAD: (TBL 1004.1.1)  
 BUSINESS = 700 GROSS / OCCUPANT = 27.50(100) = 27.50 OCCUPANTS  
 TOTAL LOAD = 28.00 OCCUPANTS

EXIT ACCESS REQUIREMENTS: (SEC 101.4)  
 ! EXIT REQUIRED FOR < 50 OCCUPANTS (TBL 1015.1)  
 ! EXIT PROVIDED  
 MAXIMUM COMMON PATH OF EGRESS TRAVEL = 200' (BUSINESS WITHOUT SPRINKLER, TBL 1016.1)  
 LONGEST EGRESS PATH IN AREA OF WORK = 44'

CONSTRUCTION CLASSIFICATION: (SEC 602.2)  
 TYPE IIB

ALLOWABLE HEIGHT AND BLDG. AREA: (TBL 503)  
 THREE STORY AND 23,000 SQ.FT. (BUSINESS)  
 THIS BLDG 11,000 SQ.FT. / 1 STORY

FIRE RESISTANCE RATING REQUIREMENTS FOR BLDG. ELEMENTS: (TBL 601)  
 STRUCTURAL FRAME = 0 HRS.  
 BEARING WALLS (INTERIOR AND EXTERIOR) = 0 HRS.  
 NON-BEARING WALLS = 0 HRS.  
 FLOOR CONSTRUCTION = 0 HRS.  
 ROOF CONSTRUCTION = 0 HRS.

FIRE RESISTANCE RATING REQUIREMENTS FOR EXTERIOR WALLS: (TBL 602)  
 EXTERIOR WALLS WITH  $\geq$  30' FIRE SEPARATION DISTANCE = 0 HRS.  
 EXTERIOR WALLS WITH < 5' FIRE SEPARATION DISTANCE = 1 HR.

MAX. AREA OF EXTERIOR WALL OPENINGS: (TBL 705.8)  
 BLDGS WITH  $\geq$  30' FIRE SEPARATION DISTANCE ALLOWED UNLIMITED PROTECTED AND UNPROTECTED OPENINGS

AUTOMATIC SPRINKLER SYSTEM REQUIREMENTS: (SEC 903)  
 THIS BLDG. DOES REQUIRE NOT AN AUTOMATIC SPRINKLER SYSTEM.

FIRE PROTECTION SYSTEM REQUIREMENTS: (SEC 907)  
 THIS BLDG. SHALL BE NOT REQUIRED TO HAVE AN APPROVED FIRE PROTECTION SYSTEM IN ACCORDANCE WITH SEC 907.2.2.

CONSTRUCTION DOCUMENTS: (SEC 1603)  
 THIS BLDG. SHALL BE DESIGNED IN ACCORDANCE WITH IBC SECTION 1609 AS A FULLY ENCLOSED BLDG. USING THE FOLLOWING INFORMATION:  
 WIND DESIGN DATA:  
 DETERMINATION OF WIND LOADS SHALL BE IN ACCORDANCE WITH IBC SEC 1609.4  
 BASIC WIND SPEED (3 SECOND GUSTS) = 130 MPH (FIG. 1609)  
 IMPORTANCE FACTOR: CATEGORY II BLDG., IE = 1.00, IS = 1.0, IW = 1.00 (TBL 1604.5)  
 EXPOSURE B  
 DESIGN WIND PRESSURE (ASCE 7-05 FIG. 6-2): 33.6 PSF  
 INTERNAL PRESSURE COEFFICIENT (ASCE 7-05 FIG. 6-5):  $\pm$  0.18  
 LIVE LOADS: (SEC 1607)  
 OFFICE (TBL 1607.1): 50 PSF  
 ROOF LIVE LOAD (TBL 1607.1) = 20 PSF UNIFORM, 300 LB. CONCENTRATED  
 GROUND SNOW LOAD (FIG. 1608.2) = 5 PSF

## NATIONAL FIRE PROTECTION ASSOCIATION 2009 SUMMARY

BUILDING AREA:  
 TOTAL BUILDING AREA = 11,000 SQ.FT.  
 AREA TO BE RENOVATED = 2750 SQ.FT.

OCCUPANCY CLASSIFICATION:  
EXISTING GROUP: B (BUSINESS)

OCCUPANT LOAD: (TBL 7.3.1.2)  
 BUSINESS = 700 GROSS SQ.FT. / OCCUPANT = 2,750 / 100 = 28.00 OCCUPANTS

SPRINKLER SYSTEM: (SEC 39.2.5)  
 THIS BUILDING SHALL NOT BE REQUIRED TO HAVE AN AUTOMATIC SPRINKLER SYSTEM AT THIS TIME.

FIRE ALARM SYSTEM: (SEC 39.3.4.1)  
 A FIRE ALARM SYSTEM IS NOT REQUIRED.

EXIT ACCESS:  
 ! EXITS REQUIRED (SEC 39.2.4.1)  
 ! EXITS PROVIDED  
 ALLOWABLE EXIT ACCESS TRAVEL DISTANCE = 200' (SEC 39.2.6.2)  
 LONGEST EGRESS PATH IN AREA OF WORK = 44'

### INDEX OF DRAWINGS

SHT#	DWG#	COVERSHEET	DRAWING NAME	REVISED
1		COVERSHEET		
2	A-1	FLOOR PLAN & REFLECTED CEILING PLAN		
3	M-1	MECHANICAL PLAN		
4	E-1	POWER AND LIGHTING PLAN		

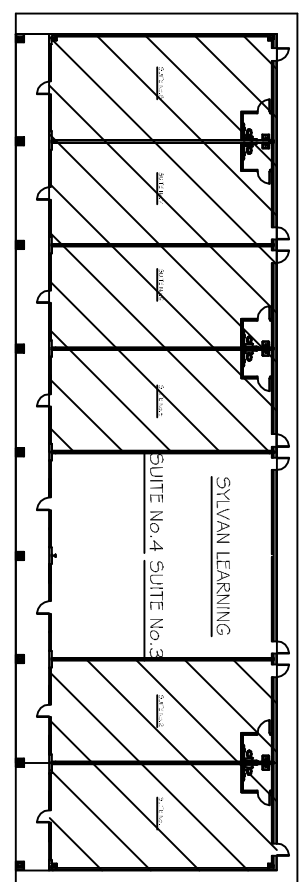
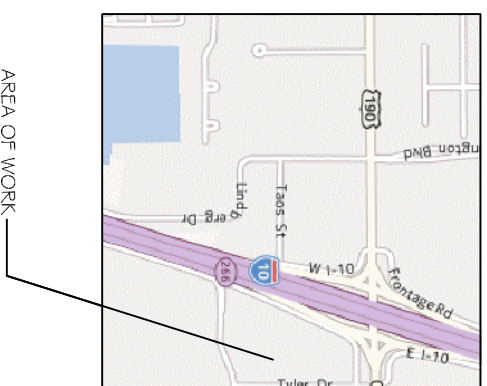

VICINITY MAP  
 N.T.S.

KEY PLAN  
 N.T.S.

CHIEF ENGINEER: EMMETT DAMMON, P.E.  
 CHIEF ARCHITECT: ROBERT WILTSE  
 554 OLD SPANISH TRAIL  
 SLIDELL, LA 70458

www.dammonengineering.com  
 dammoneng@bcsouth.net  
 PHONE: 985-649-5832  
 FAX: 985-641-5950

**DAMMON**  
 ENGINEERING, INC.  
 Architects & Engineers



The above drawings and specifications, designs and calculations, representations, drawings and all other items that are the property of Dammon Engineering, shall not be used for any other project, or allowed to be used, or used in connection with any other project, without the prior written consent of Dammon Engineering. Visual conflicts with other drawings or specifications shall constitute a conclusive evidence of acceptance of these requirements.

## SYLVAN LEARNING CENTER

TYLER SQUARE  
 58465 TYLER STREET SUITE #3 & #4  
 SLIDELL, LA

JOB No: 2153 DATE: 10-11-12  
 DRAWN BY: BSN CHECKED BY: BSN