

EXISTING FIRE HYDRANT

LEGEND

- PROPERTY LINE
- NEW BUILDING
- - - EXISTING
- - - SETBACK LINE

LANDSCAPE REQUIREMENTS:

- EXISTING BUILDING**
- 512 SQ. FT. PEDESTRIAN ACCESS PLANTING REQUIRED
 - 516 SQ. FT. PEDESTRIAN ACCESS PLANTING PROVIDED
- NEW BUILDING**
- 700 SQ. FT. PEDESTRIAN ACCESS PLANTING REQUIRED
 - 743 SQ. FT. PEDESTRIAN ACCESS PLANTING PROVIDED
- - GRAPE MYRTLE TOTAL OF 2
 - - 1" CALIPER, 6' HIGH
 - - CAMELLIA TOTAL OF 19
 - - 1" CALIPER, 6' HIGH
 - - HORN BEAM TOTAL OF 3
 - - 1/2" CALIPER, 4' HIGH
 - - SHUMARD OAK TOTAL OF 5
 - - 1/2" CALIPER, 4' HIGH
 - - LIVE OAK TOTAL OF 6
 - - 1" CALIPER, 6' HIGH
 - - SHRUB TOTAL OF 53

PARKING REQUIREMENTS

- TOTAL REQUIRED:**
- 1 SPACE FOR EVERY 150 SQ. FT. OF EXISTING RESTAURANT AND BAR AREA
 - TOTAL SQ. FT.=5,898
 - TOTAL SPACES REQUIRED=39
 - 1 SPACE FOR EVERY 300 SQ. FT. OF RETAIL AREA
 - TOTAL SQ. FT.=7,875
 - TOTAL SPACES REQUIRED=26
 - TOTAL REQUIRED = 65 SPACES

- TOTAL PROVIDED:**
- 3 HANDICAP SPACES
 - + 62 PARKING SPACES
 - 65 TOTAL SPACES PROVIDED

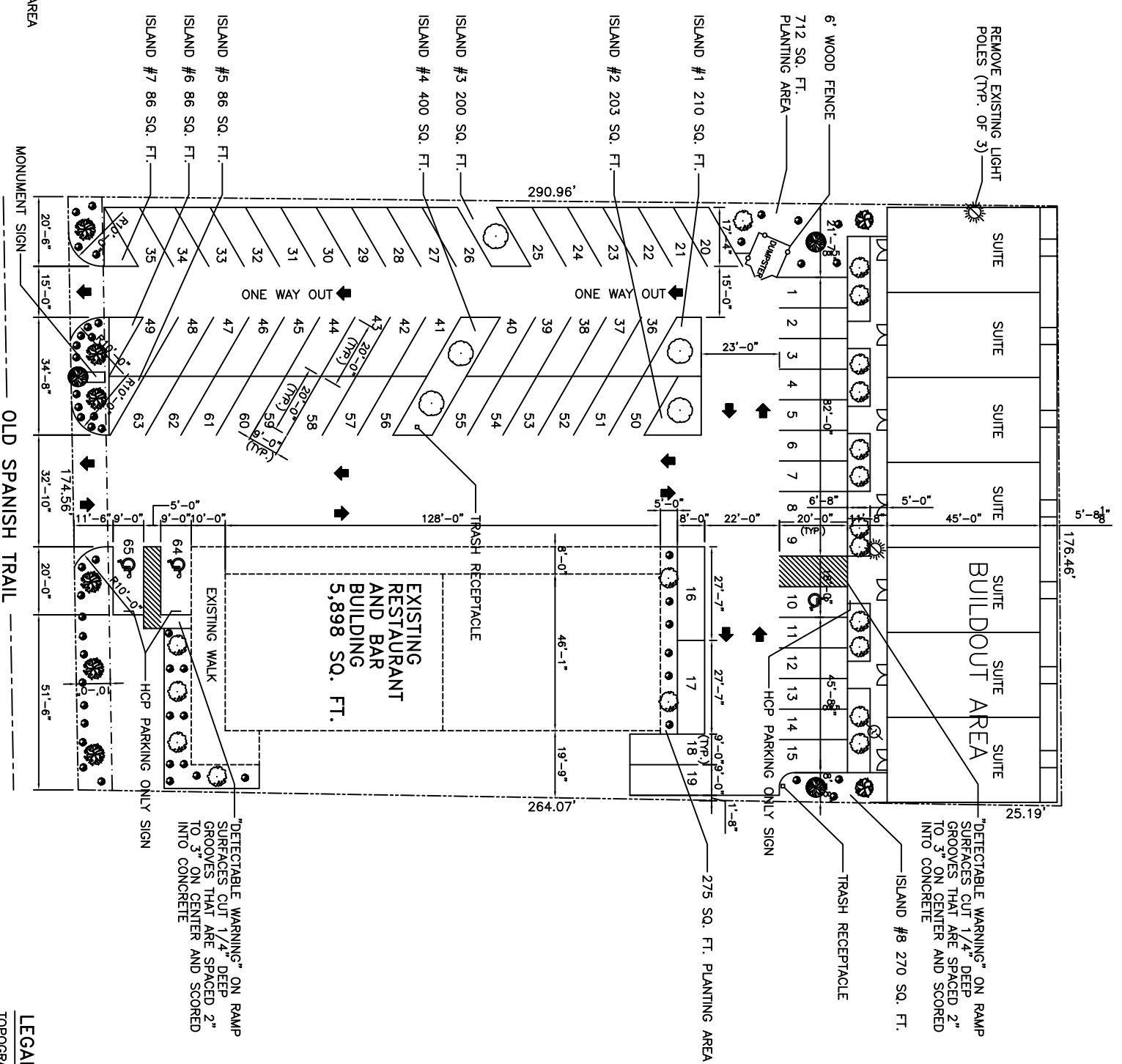

SITE PLAN
SCALE: 1"=20'-0"

NOTE:
EXTERIOR LIGHTING SHALL BE SHADED OR INWARDLY DIRECTED IN SUCH A MANNER SO THAT NO DIRECT LIGHTING OR GLARE IS CAST BEYOND THE PROPERTY LINE. THE INTENSITY OF SUCH LIGHTING SHALL NOT EXCEED ONE FOOT CANDLE AS MEASURED AT THE ABUTTING PROPERTY LINE.

LEGAL DESCRIPTION:

TOPOGRAPHIC AND BOUNDARY SURVEY OF LOT 1-A KASTNER PLACE SUBDIVISION CITY OF SLIDELL ST. TAMMANY PARISH, LOUISIANA

SITE PLAN
KOSTMAYER CONSTRUCTION
OLD SPANISH TRAIL
SLIDELL, LOUISIANA

HIRAM INVESTMENTS LLC
DAMMON ENGINEERING, INC.
ARCHITECTS - ENGINEERS
2000 OLD SPANISH TRAIL, STE 100 985-649-5832 SLIDELL, LA. 70458
DAMMONENGINEERING.COM

SCALE: AS NOTED
FILE: _____
JOB NO. 1550
DATE: 2-25-04
SHEET
C-2
OF