

OFFICE CROSS SECTION K
SCALE: 1/4"=1'-0"

GA FILE NO. WP 3910 GENERIC 2 HOUR FIRE
50 to 54 STC SOUND
Thickness: 8"
Approx. Weight: 13 psf
Fire Test: UL R4024, OONK26545, 4-27-01, UL Design L556
(FM WP 360, 9-27-74)
Sound Test: NCC 2377, 5-19-70
Gypsum Wallboard, Wood Studs
Base layer 5/8" type X gypsum wallboard or gypsum veneer base applied at right angles to each side of 2 x 4 wood studs 16" o.c., staggered 8" o.c. on 2 x 6 wood plates, with 8d coated nails, 17/8" long, 0.085" shank, 1/4" heads, 24" o.c. Face layer 5/8" type X gypsum wallboard or gypsum veneer base applied at right angles to each side with 8d coated nails, 23/8" long, 0.113" shank, 9/32" heads, 8" o.c.
Joints staggered 16" each layer and side. Sound tested with nails for base layer spaced 6" o.c. Horizontal bracing required at mid-height. (LOAD-BEARING)

2 HOUR WALL
SCALE: N.T.S.

GA FILE NO. FC 5751 GENERIC 2 HOUR FIRE
Approx. Ceiling Weight: 12 psf
Fire Test: UL R4024, OONK26545, 4-27-01, UL Design L556
WOOD FLOOR, WOOD TRUSSES, GYPSUM WALLBOARD, RIGID FLOORING CHANNELS
Base layer 5/8" type X gypsum wallboard applied at right angles to 18" deep parallel chord wood 24" o.c. with 11/4" Type W drywall screws 12" o.c. Second layer 5/8" type X gypsum wallboard applied at right angles to trusses with 2" Type W drywall screws 12" o.c. Second layer joints offset 24" from base layer joints. Third layer 5/8" type X gypsum wallboard applied at right angles to trusses with 21/2" Type W drywall screws 12" o.c. Third layer joints offset 12" from second layer joints. Hat-shaped rigid furring channels 24" o.c. applied at right angles to trusses over third layer with two 21/2" long Type W drywall screws at each truss. Face layer 5/8" type X gypsum wallboard applied at right angles to trusses supporting 3/4" T & G edge plywood floor applied at right angles to trusses with 8d nails 6" o.c. at joints and 12" at intermediate trusses. Ceiling provides two-hour fire-resistance protection for wood framing.

2 HOUR FLOOR/CEILING
SCALE: N.T.S.

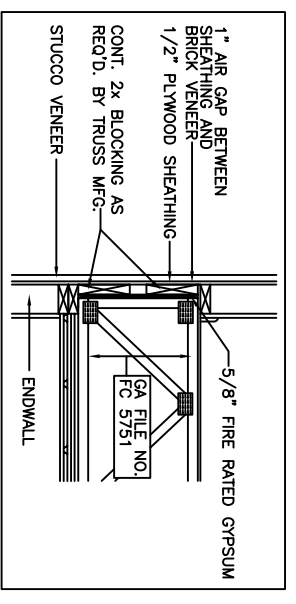

TRUSS SUPPORT AT ENDWALL
SCALE: N.T.S.

GENERAL NOTES

- INSULATION AND INSULATION ASSEMBLIES SHALL MEET THE REQUIREMENTS OF SECTION 719.
 - CONCEALED INSULATION SHALL HAVE A FLAME SPREAD OF 0-25 AND SMOKE DEVELOPED INDEX OF 0-450, EXCEPT THAT IN COMBUSTIBLE (WOOD FRAME) CONSTRUCTION.
 - FACING SHALL COMPLY WITH IBC 2003.
 - PROVIDE 5'x5' LANDINGS, LEVEL WITH FINISHED FLOOR, OUTSIDE EXTERIOR DOORS. THRESHOLDS SHALL BE NOT MORE THAN 1/2" IN HEIGHT AND SHALL BE BEVELED IF MORE THAN 1/4".
 - DIMENSIONS ARE TO CENTER-LINE, FACE OF STUDS, CENTER OF COLUMNS, OR FACE OF VENEER.
 - CONTRACTOR TO VERIFY ALL SITE CONDITIONS, BUILDING LOCATIONS, AND DIMENSIONS PRIOR TO CONSTRUCTION.
 - MATERIALS SHALL BE NEW AND U.L. LISTED.
 - NO WORK SHALL BE CONCEALED UNTIL APPROVED BY LOCAL INSPECTORS.
 - CONSTRUCTION SHALL COMPLY WITH ALL PARISH, STATE, AND LOCAL CODES.
 - CONTRACTOR TO GUARANTEE WORK FOR ONE YEAR.
 - CONTRACTOR SHALL FURNISH WATER AND POWER FROM EXISTING SOURCES.
 - EXTERIOR CAULKING SHALL BE THICK CAULK.
 - PAINT GRADE TO SHALL BE SHERWIN WILLIAMS OR EQUIVALENT. ALL WORK TO RECEIVE 3 COATS. COLOR SELECTION BY OWNER.
 - PROVIDE CLEAN-UP ON A REGULAR BASIS. NO TRASH STORED IN BUILDING.
 - ALL BATT INSULATION SHALL HAVE A CLASS "A" (0-25) FLAME SPREAD IN COMPLIANCE WITH APPLICABLE CODE.
 - USE 6" STUDS, OR 4" STAGGERED STUDS AT ALL PLUMBING WALLS.
 - PROVIDE GALVANIZED METAL PAN WITH DRAIN AT WATER HEATER LOCATION.
 - ALL CORNERS SHALL BE PROPERLY BRACED FOR WIND LOADS. A 48" SHEATHING SHALL BE PROVIDED EVERY 20 FEET OF WALL LENGTH.
 - FLOORING SHALL BE NON-SLIP.
 - INTERIOR LOCKS ON DOORS IN MEANS OF EGRESS SHALL NOT REQUIRE THE USE OF A KEY. SPECIAL KNOWLEDGE, OR SPECIAL DEVICE TO OPEN IN THE DIRECTION OF EGRESS. ALL DOORS SHALL HAVE LEVER TYPE HANDLES.
 - INTERIOR WALLS AND CEILINGS SHALL HAVE A FLAME SPREAD OF 0-200 AND A SMOKE DEVELOPMENT RATING OF 0-450.
 - ALL WORK SHALL COMPLY WITH THE LATEST EDITION OF ALL LOCAL, STATE, AND NATIONAL CODES COVERING THE TYPE OF WORK BEING PERFORMED.
 - PROVIDE PORTABLE FIRE EXTINGUISHERS IN ACCORDANCE WITH NFPA 101. SEE APPENDIX "E" OF NFPA 101 FOR DISTRIBUTION OF EXTINGUISHERS.
 - ALL FIRE WALLS SHALL EXTEND TIGHT TO ROOF SHEATHING, AND BE SEALED WITH AN APPROVED FIRE CAULK.
 - ALL ELECTRICAL, MECHANICAL, AND PLUMBING MATERIALS PENETRATING FIRE WALLS SHALL BE FIRE CALKED. (PENETRATIONS THROUGH RATED CONSTRUCTION SHALL BE SEALED WITH A MATERIAL CAPABLE OF PREVENTING THE PASSAGE OF FLAMES AND HOT GASES WHEN TESTED IN ACCORDANCE WITH ASTM-E814.)

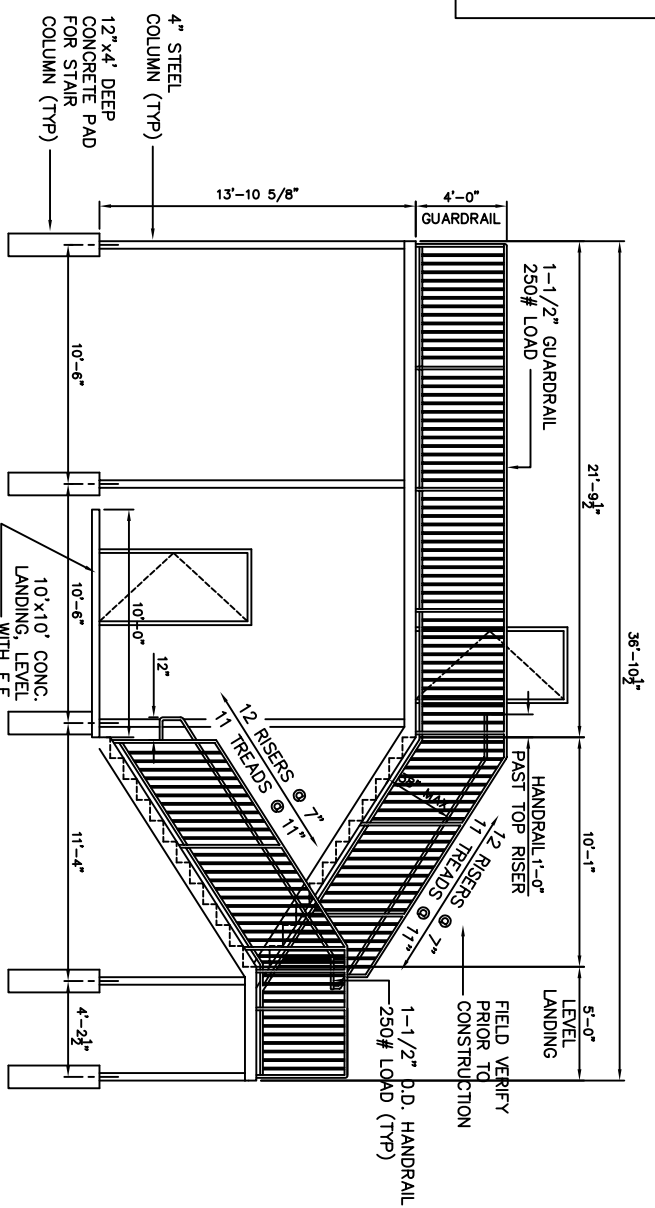

APARTMENT EXTERIOR STAIRS DETAIL L
SCALE: 1/4"=1'-0"

OFFICE CROSS SECTION
JEFF BRELAND
64287 HWY. 41
PEARL RIVER, LOUISIANA

PLANET STORAGE
DAMMON ENGINEERING, INC.
1095 FLORIDA AVENUE 985-649-5832 SLIDELL, LA. 70458
DAMMONENGINEERING.COM

SCALE: AS NOTED
FILE:
JOB NO. 1757
DATE: 6-19-06
SHEET 11
A-2
OF 27