

PLAN OF THE LOFT

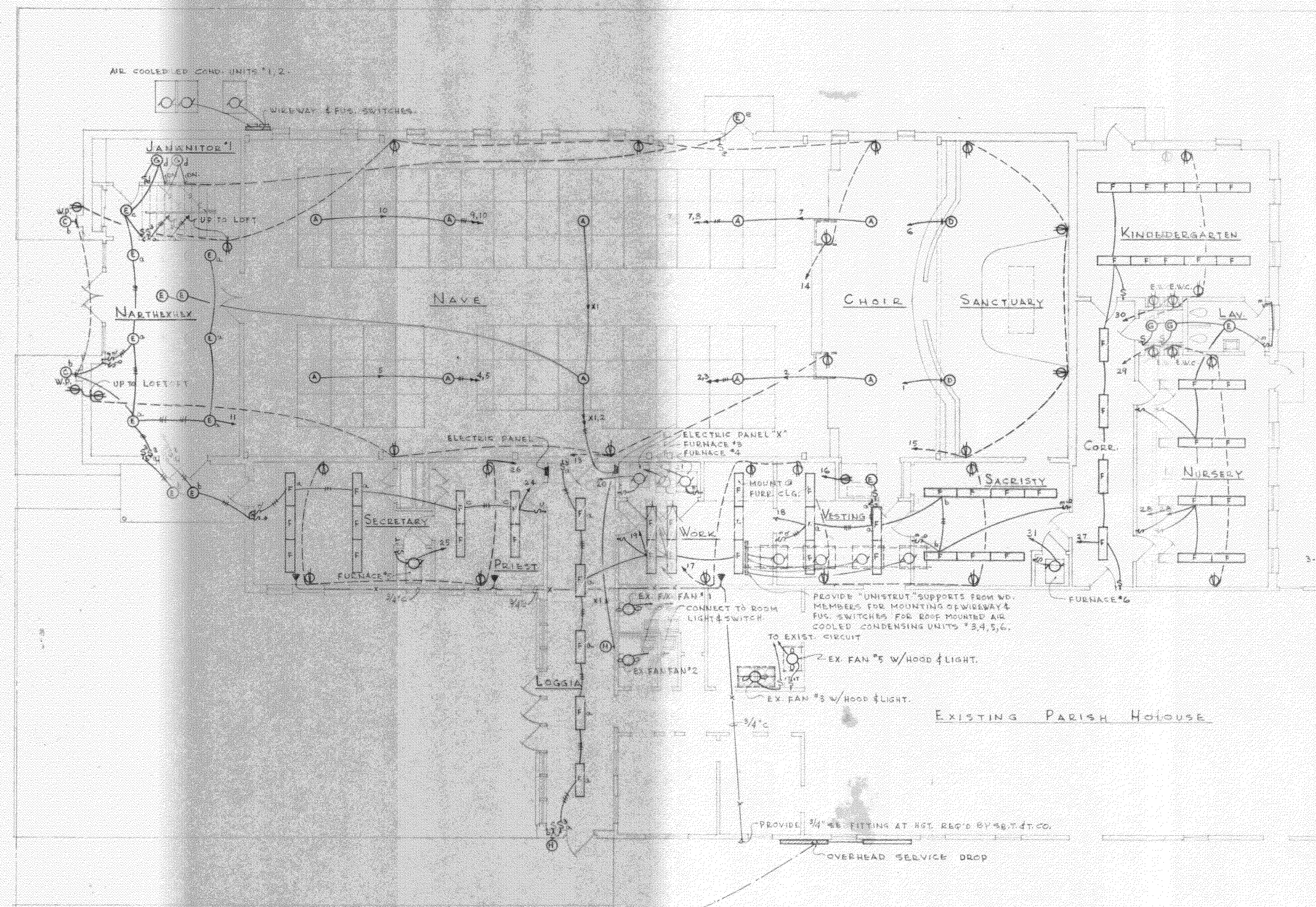

FLOOR PLAN - ELECTRICAL  
SCALE: 1/8" = 1'-0"

SYMBOLS

- ⊙ CEILING MOUNTED FIXTURE, CAPITAL LETTER INDICATES FIXTURE TYPE - SEE SPECIFICATIONS, SOURCE OF CEILING INDICATED - SWITCH CONTROLLING FIXTURE
- ⊙ WALL MOUNTED FIXTURE
- ▭ FLUORESCENT FIXTURE
- ⊕ CONVENIENCE RECEPTACLE
- ⊕ CONVENIENCE RECEPTACLE - WEATHERPROOF TYPE
- ⊕ TELEPHONE OUTLET
- ⊕ SINGLE POLE TOSSEL SWITCH
- ⊕ THREE WAY SWITCH
- ⊕ THERMAL TRIP SWITCH
- WIRING RUN CONCEALED IN WALLS AND/OR CEILING
- WIRING RUN CONCEALED IN FLOOR SLAB
- TELEPHONE CONDUITS

ELECTRIC PANEL - FLUSH MOUNTED, 200 AMP MAINS, MAIN LUGS ONLY, NEUTRAL BAR, ARRANGED FOR 100 AMP INST. SINGLE PHASE, THREE WIRE SERVICE. BRANCHES AS FOLLOWS:  
 20 - 20A 1/2 P 15 - CIRCUITS 1 THRU 22 TRAY  
 31 & 32 SPARE  
 1 - 20A 1/2 P 15 - CIRCUIT 21

PANEL Y - 2-20A 1/2 P 15

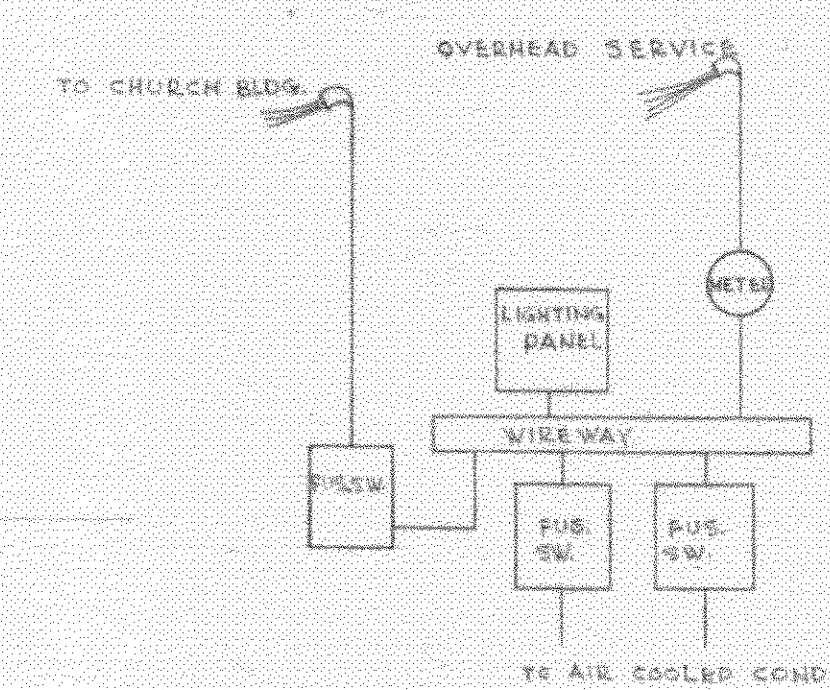

EXISTING SERVICE WIRING

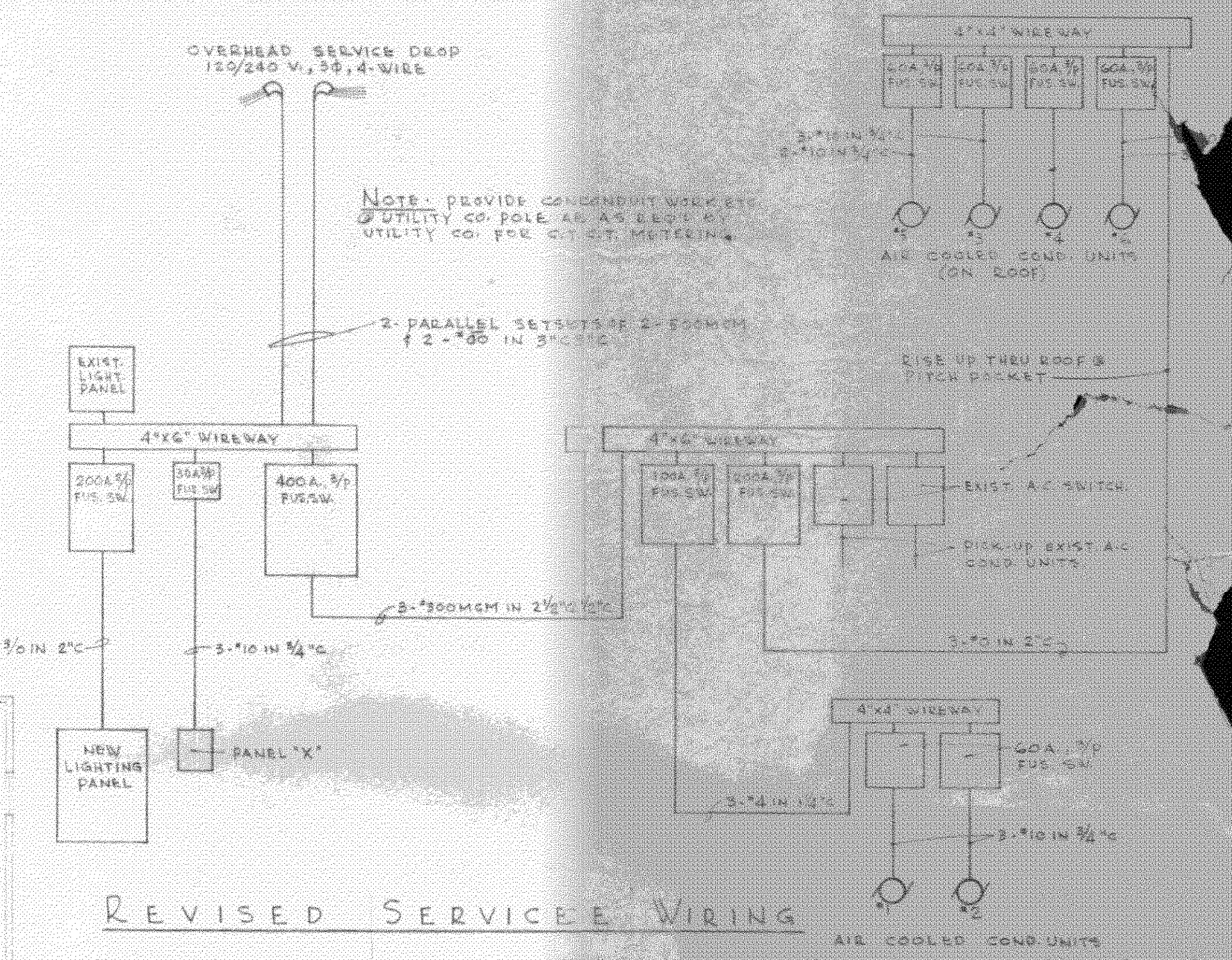

REVISED SERVICE WIRING

CHURCH BUILDING FOR <b>CHRIST EPISCOPAL CHURCH</b> SLIDELL, LOUISIANA		COMM. NO. 885
FRERET AND WOLFF ARCHITECTS 910 CHARLES ST. NEW ORLEANS, LA.		DATE: 12 APRIL, 1950
		REVISED: 10 APRIL, 1950
		SHEET NO.: E-109