



**DAMON**  
ENGINEERING, INC.  
**EMMETT**  
**DAMON**

**ARCHITECT**  
**ROBERT**  
**SOLBERGER**

1095 FLORIDA AVENUE  
SLIDELL, LA. 70458  
985-649-5832

WEBSITE:  
WWW.DAMONENGINEERING.CO

EMAIL:  
DAMONENGN@BELL.SOUTH.NET

ARCHITECTURE  
ENGINEERING  
STUDIES  
PLANNING  
INVESTIGATION  
EXPERT WITNESS

TEXTRON  
OFFICE PLAN

TEXTRON  
MARINE AND  
LAND

2585 FRONT ST  
SLIDELL, LA

FIRST AND  
SECOND  
FLOOR PLAN

REV:

SCALE: AS NOTED

JOB#: 1880

DATE: 8-8-07

SHEET

A-2

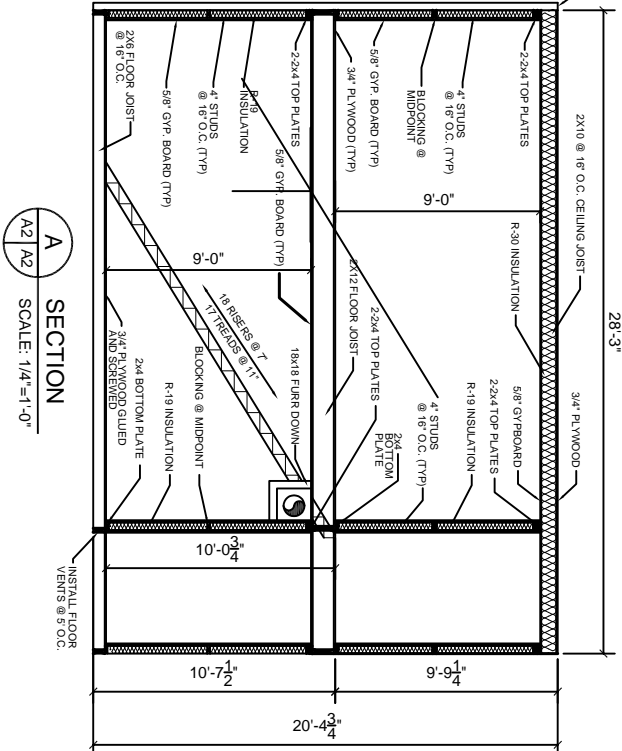

SECTION  
A A2  
SCALE: 1/4"=1'-0"

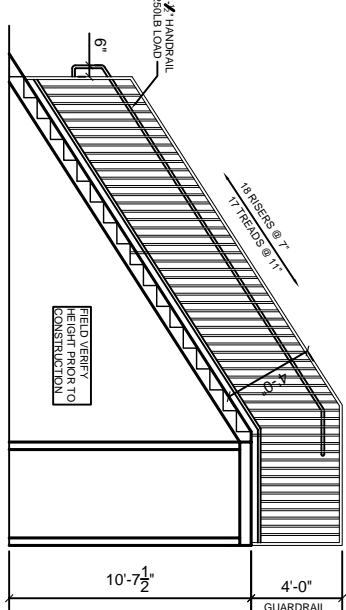

STAIR DETAILS  
NTS

FIRST & SECOND FLOOR DOOR AND HARDWARE SCHEDULE (X)			
#	TYPE	FRAME	FINISH
ACCESSORIES			
REMARKS			
#	SIZE	WOOD	FINISH
1	30x60x1-3/4"	WOOD	WOOD
2	30x60x1-3/4"	WOOD	WOOD
3	30x60x1-3/4"	WOOD	WOOD
4	24x60x1-3/4"	WOOD	WOOD
5	30x60x1-3/4"	WOOD	WOOD
6	30x60x1-3/4"	WOOD	WOOD
7	30x60x1-3/4"	WOOD	WOOD
8	30x60x1-3/4"	WOOD	WOOD
9	30x60x1-3/4"	WOOD	WOOD
10	30x60x1-3/4"	WOOD	WOOD
11	30x60x1-3/4"	WOOD	WOOD
12	30x60x1-3/4"	WOOD	WOOD
13	30x60x1-3/4"	WOOD	WOOD
14	30x60x1-3/4"	WOOD	WOOD
15	30x60x1-3/4"	WOOD	WOOD
16	30x60x1-3/4"	WOOD	WOOD
17	30x60x1-3/4"	WOOD	WOOD
18	30x60x1-3/4"	WOOD	WOOD
19	30x60x1-3/4"	WOOD	WOOD
20	30x60x1-3/4"	WOOD	WOOD
21	30x60x1-3/4"	WOOD	WOOD
22	30x60x1-3/4"	WOOD	WOOD
23	30x60x1-3/4"	WOOD	WOOD
24	30x60x1-3/4"	WOOD	WOOD
25	30x60x1-3/4"	WOOD	WOOD
26	30x60x1-3/4"	WOOD	WOOD
27	30x60x1-3/4"	WOOD	WOOD
28	30x60x1-3/4"	WOOD	WOOD
29	30x60x1-3/4"	WOOD	WOOD
30	30x60x1-3/4"	WOOD	WOOD
31	30x60x1-3/4"	WOOD	WOOD
32	30x60x1-3/4"	WOOD	WOOD
33	30x60x1-3/4"	WOOD	WOOD
34	30x60x1-3/4"	WOOD	WOOD
35	30x60x1-3/4"	WOOD	WOOD
36	30x60x1-3/4"	WOOD	WOOD
37	30x60x1-3/4"	WOOD	WOOD
38	30x60x1-3/4"	WOOD	WOOD
39	30x60x1-3/4"	WOOD	WOOD
40	30x60x1-3/4"	WOOD	WOOD
41	30x60x1-3/4"	WOOD	WOOD
42	30x60x1-3/4"	WOOD	WOOD
43	30x60x1-3/4"	WOOD	WOOD
44	30x60x1-3/4"	WOOD	WOOD
45	30x60x1-3/4"	WOOD	WOOD
46	30x60x1-3/4"	WOOD	WOOD
47	30x60x1-3/4"	WOOD	WOOD
48	30x60x1-3/4"	WOOD	WOOD
49	30x60x1-3/4"	WOOD	WOOD
50	30x60x1-3/4"	WOOD	WOOD
51	30x60x1-3/4"	WOOD	WOOD
52	30x60x1-3/4"	WOOD	WOOD
53	30x60x1-3/4"	WOOD	WOOD
54	30x60x1-3/4"	WOOD	WOOD
55	30x60x1-3/4"	WOOD	WOOD
56	30x60x1-3/4"	WOOD	WOOD
57	30x60x1-3/4"	WOOD	WOOD
58	30x60x1-3/4"	WOOD	WOOD
59	30x60x1-3/4"	WOOD	WOOD
60	30x60x1-3/4"	WOOD	WOOD
61	30x60x1-3/4"	WOOD	WOOD
62	30x60x1-3/4"	WOOD	WOOD
63	30x60x1-3/4"	WOOD	WOOD
64	30x60x1-3/4"	WOOD	WOOD
65	30x60x1-3/4"	WOOD	WOOD
66	30x60x1-3/4"	WOOD	WOOD
67	30x60x1-3/4"	WOOD	WOOD
68	30x60x1-3/4"	WOOD	WOOD
69	30x60x1-3/4"	WOOD	WOOD
70	30x60x1-3/4"	WOOD	WOOD
71	30x60x1-3/4"	WOOD	WOOD
72	30x60x1-3/4"	WOOD	WOOD
73	30x60x1-3/4"	WOOD	WOOD
74	30x60x1-3/4"	WOOD	WOOD
75	30x60x1-3/4"	WOOD	WOOD
76	30x60x1-3/4"	WOOD	WOOD
77	30x60x1-3/4"	WOOD	WOOD
78	30x60x1-3/4"	WOOD	WOOD
79	30x60x1-3/4"	WOOD	WOOD
80	30x60x1-3/4"	WOOD	WOOD
81	30x60x1-3/4"	WOOD	WOOD
82	30x60x1-3/4"	WOOD	WOOD
83	30x60x1-3/4"	WOOD	WOOD
84	30x60x1-3/4"	WOOD	WOOD
85	30x60x1-3/4"	WOOD	WOOD
86	30x60x1-3/4"	WOOD	WOOD
87	30x60x1-3/4"	WOOD	WOOD
88	30x60x1-3/4"	WOOD	WOOD
89	30x60x1-3/4"	WOOD	WOOD
90	30x60x1-3/4"	WOOD	WOOD
91	30x60x1-3/4"	WOOD	WOOD
92	30x60x1-3/4"	WOOD	WOOD
93	30x60x1-3/4"	WOOD	WOOD
94	30x60x1-3/4"	WOOD	WOOD
95	30x60x1-3/4"	WOOD	WOOD
96	30x60x1-3/4"	WOOD	WOOD
97	30x60x1-3/4"	WOOD	WOOD
98	30x60x1-3/4"	WOOD	WOOD
99	30x60x1-3/4"	WOOD	WOOD
100	30x60x1-3/4"	WOOD	WOOD

1. DOORS IN PART OF EGRESS SHALL BE REMOVED FROM THE EGRESS SIDE WITHOUT THE USE OF A KEY  
2. A READY VISIBLE SIGN SHALL BE POSTED ON THE EGRESS SIDE ON OR ADJACENT TO THE DOOR STATION.  
THIS DOOR SHALL BE REMAIN UNLOCKED WHEN BUILDING IS OCCUPYED.  
3. ALL HEADERS SHALL HAVE SOLID BLOCKING. (IBC 2003 - 1008.1.8.3, 2.2)

GA FILE NO. WP 3514	GENERIC	1 HOUR FIRE	35 TO 39 STC SOUND
WOOD JOISTS, GYPSUM WALLBOARD			
ONE LAYER 5/8" TYPE X GYPSUM WALLBOARD OR GYPSUM VENER BASE APPLIED PARALLEL OR AT RIGHT ANGLES TO EACH SIDE OF 2x4 WOOD STUDS 16" O.C. WITH 1-1/4" TYPE W DRYWALL SCREWS 12" O.C.			
JOINTS STAGGERED 16" ON OPPOSITE SIDES. (LOAD BEARING)			
THICKNESS: 4-3/4"			
APPROX. WEIGHT: 7 PSF			
FIRE TEST: SWR 01-45T1-619, 8-19-02			
SOUND TEST: SEE WP 3520			
(G&H NG-246T1, 7-2-65)			

GA FILE NO. RC 2601	GENERIC	1 HOUR FIRE	40 TO 44 STC SOUND
WOOD JOISTS, GYPSUM WALLBOARD			
BASE LAYER 5/8" TYPE X GYPSUM WALLBOARD APPLIED AT RIGHT ANGLES TO 2 X 10 WOOD JOISTS 24" O.C. FACE LAYER 5/8" TYPE X GYPSUM WALLBOARD OR GYPSUM VENER BASE APPLIED AT RIGHT ANGLES TO JOISTS WITH 1 7/8" TYPE S DRYWALL SCREWS 12" O.C. AT JOINTS AND INTERMEDIATE JOISTS AND 1 1/2" TYPE G DRYWALL SCREWS 12" O.C. PLACED 2" FROM BASE LAYER JOINTS. WOOD JOISTS SUPPORTING 1/2" PLYWOOD WITH EXTERIOR GLUE APPLIED AT RIGHT ANGLES TO JOISTS WITH 8D NAILS. CEILING PROVIDES ONE HOUR FIRE RESISTANCE PROTECTION FOR WOOD FRAMING, INCLUDING TRUSSES.			
APPROX. CEILING WEIGHT: 5 PSF			
FIRE TEST: FC 172, 2-25-72			
NTS, 8-6-98			

FIRST & SECOND FLOOR FINISH SCHEDULE			
NAME	FLOOR	BASE	WALLS
REMARKS			
1ST FLOOR OFFICES	CARPET	CONCRETE	WOOD BASE
2ND FLOOR OFFICES	CARPET	CONCRETE	WOOD BASE
OWNER TO SELECT STYLE, COLOR, AND BRAND			

WINDOW SCHEDULE (X)			
TYPE	FRAME	GLASS	UNITES
ACCESSORIES			
REMARKS			
WINDOW	FIXED	VERTICAL SLIDE	STEEL
		HORIZ SLIDE	ALUMINUM
			WOOD
			TINTED
			PLAIN
			TEMPERED
			WIREGLASS
			NONE
			22
			4/4
			6/6
			8/8
			ALARM
			SCREEN
			SHUTTER
			NONE

1. INSULATION AND INSULATION ASSEMBLIES SHALL MEET THE REQUIREMENTS OF SECTION 719.
- A. CONCEALED INSULATION SHALL HAVE A FLAME SPREAD OF 0-25 AND SMOKE DEVELOPED INDEX OF 0-450. EXCEPT THAT IN COMBUSTIBLE (WOOD FRAME) CONSTRUCTION.
- B. FACING SHALL COMPLY WITH IBC 2006.
2. PROVIDE 5x6 LANDING, LEVEL WITH FINISHED FLOOR, OUTSIDE EXTERIOR DOORS. THRESHOLDS SHALL BE NOT MORE THAN 1/2" IN HEIGHT AND SHALL BE BEVELED IF MORE THAN 1/4".
3. DIMENSIONS ARE TO CENTERLINE, FACE OF STUDS, CENTER OF COLUMNS, AND DIMENSIONS PRIOR TO CONSTRUCTION.
4. CONTRACTOR TO VERIFY ALL SITE CONDITIONS, BUILDING LOCATIONS, AND DIMENSIONS PRIOR TO CONSTRUCTION.
5. MATERIALS SHALL BE NEW AND U.L. LISTED.
6. NO WORK SHALL BE CONCEALED UNTIL APPROVED BY LOCAL INSPECTORS.
7. CONSTRUCTION SHALL COMPLY WITH ALL PARISH, STATE, AND LOCAL CODES.
8. CONTRACTOR TO GUARANTEE WORK FOR ONE YEAR.
9. CONTRACTOR SHALL FURNISH WATER AND POWER FROM EXISTING SOURCES.
10. EXTERIOR CAULKING SHALL BE THICK CAULK.
11. PAINT GRADE TO SHALL BE SHERWIN WILLIAMS OR EQUIVALENT. ALL WORK TO RECEIVE 3 COATS. COLOR SELECTION BY OWNER.
12. PROVIDE CLEANUP ON A REGULAR BASIS. NO TRASH STORED IN BUILDING.
13. ALL BATT INSULATION SHALL HAVE A CLASS "A" (0-25) FLAME SPREAD IN COMPLIANCE WITH APPLICABLE CODE.
14. USE 6" STUDS, OR 4" STAGGERED STUDS AT ALL PLUMBING WALLS.
15. PROVIDE GALVANIZED METAL PAN WITH DRAIN AT WATER HEATER LOCATION.
16. ALL CORNERS SHALL BE PROPERLY BRACED FOR WIND LOADS. A 48" SHEATHING SHALL BE PROVIDED EVERY 20 FEET OF WALL LENGTH.
17. FLOORING SHALL BE NON-SLIP.
18. INTERIOR LOCKS ON DOORS IN MEANS OF EGRESS SHALL NOT REQUIRE THE USE OF A KEY. SPECIAL KNOWLEDGE, OR SPECIAL DEVICE TO OPEN IN THE DIRECTION OF EGRESS. ALL DOORS SHALL HAVE LEVER TYPE HANDLES.
19. INTERIOR WALLS AND CEILINGS SHALL HAVE A FLAME SPREAD OF 0-200 AND A SMOKE DEVELOPMENT RATING OF 0-450.
20. ALL WORK SHALL COMPLY WITH THE LATEST EDITION OF ALL LOCAL, STATE, AND NATIONAL CODES COVERING THE TYPE OF WORK BEING PERFORMED.
21. PROVIDE PORTABLE FIRE EXTINGUISHERS IN ACCORDANCE WITH NFPA 101. SEE APPENDIX "E" OF NFPA 101 FOR DISTRIBUTION OF EXTINGUISHERS.
22. ALL FIRE WALLS SHALL EXTEND TIGHT TO ROOF SHEATHING, AND BE SEALED WITH AN APPROVED FIRE CAULK. (PENETRATIONS THROUGH RATED CONSTRUCTION SHALL BE SEALED WITH A MATERIAL CAPABLE OF PREVENTING THE PASSAGE OF FLAMES AND HOT GASES WHEN TESTED IN ACCORDANCE WITH ASTM-E814)
24. SERVICE COUNTER SHALL HAVE A HCP ACCESSIBLE WRITING SURFACE, MAX. 36" FROM F.F. (ADAAG MANUAL, 1998, PG 136)

### GENERAL CONSTRUCTION NOTES

