

REFLECTED CEILING PLAN  
SCALE: 1/4" = 1'-0"

FLOOR PLAN  
SCALE: 1/4" = 1'-0"

- GENERAL NOTES**
- INSULATION AND INSULATION ASSEMBLIES SHALL MEET THE REQUIREMENTS OF SECTION 719.
    - CONCEALED INSULATION SHALL HAVE A FLAME SPREAD OF 0-25 AND SMOKE DEVELOPED INDEX OF 0-450. EXCEPT THAT IN COMBUSTIBLE (WOOD FRAME) CONSTRUCTION.
    - FACING SHALL COMPLY WITH IBC 2009.
  - PROVIDE 5x5' LANDINGS, LEVEL WITH FINISHED FLOOR, OUTSIDE EXTERIOR DOORS ON WEST SIDE OF BUILDING. THRESHOLDS SHALL BE NOT MORE THAN 1/2" IN HEIGHT AND SHALL BE BEVELED IF MORE THAN 1/4".
  - CONTRACTOR TO VERIFY ALL SITE CONDITIONS, BUILDING LOCATIONS, AND DIMENSIONS PRIOR TO CONSTRUCTION.
  - MATERIALS SHALL BE NEW AND U.L. LISTED.
  - NO WORK SHALL BE CONCEALED UNTIL APPROVED BY LOCAL INSPECTORS.
  - CONSTRUCTION SHALL COMPLY WITH ALL PARISH, STATE, AND LOCAL CODES.
  - CONTRACTOR TO GUARANTEE WORK FOR ONE YEAR.
  - CONTRACTOR SHALL FURNISH WATER AND POWER FROM EXISTING SOURCES.
  - EXTERIOR CAULKING SHALL BE THIOKAL CAULK.
  - PAINT GRADE TO SHALL BE SHERWIN WILLIAMS OR EQUIVALENT. ALL WORK TO RECEIVE 3 COATS. COLOR SELECTION BY OWNER.
  - PROVIDE CLEANUP ON A REGULAR BASIS. NO TRASH STORED IN BUILDING.
  - ALL BATT INSULATION SHALL HAVE A CLASS "A" (0-25) FLAME SPREAD IN COMPLIANCE WITH APPLICABLE CODE.
  - USE 6" STUDS, OR 4" STAGGERED STUDS AT ALL PLUMBING WALLS.
  - PROVIDE GALVANIZED METAL PAN WITH DRAIN AT WATER HEATER LOCATION.
  - ALL CORNERS SHALL BE PROPERLY BRACED FOR WIND LOADS. A 48" SHEATHING SHALL BE PROVIDED EVERY 20 FEET OF WALL LENGTH.
  - INTERIOR LOCKS ON DOORS IN MEANS OF EGRESS SHALL NOT REQUIRE THE USE OF A KEY, SPECIAL KNOWLEDGE, OR SPECIAL DEVICE TO OPEN IN THE DIRECTION OF EGRESS. ALL DOORS SHALL HAVE LEVER TYPE HANDLES.
  - INTERIOR WALLS AND CEILINGS SHALL HAVE A FLAME SPREAD OF 0-200 AND A SMOKE DEVELOPMENT RATING OF 0-450.
  - ALL WORK SHALL COMPLY WITH THE LATEST EDITION OF ALL LOCAL, STATE, AND NATIONAL CODES COVERING THE TYPE OF WORK BEING PERFORMED.
  - PROVIDE PORTABLE FIRE EXTINGUISHERS IN ACCORDANCE WITH NFPA 101. SEE APPENDIX "E" OF NFPA 101 FOR DISTRIBUTION OF EXTINGUISHERS.
  - ALL FIRE WALLS SHALL EXTEND TIGHT TO ROOF DECK AND BE SEALED WITH AN APPROVED FIRE CAULK.
  - ALL ELECTRICAL, MECHANICAL, AND PLUMBING MATERIALS PENETRATING FIRE WALLS SHALL BE FIRE CAULKED. (PENETRATIONS THROUGH RATED CONSTRUCTION SHALL BE SEALED WITH A MATERIAL CAPABLE OF PREVENTING THE PASSAGE OF FLAMES AND HOT GASES WHEN TESTED IN ACCORDANCE WITH ASTM-E814.)
  - SERVICE COUNTER SHALL HAVE A HCP ACCESSIBLE WRITING SURFACE, MAX. 36" FROM F.F. (ADAAG MANUAL 1998, PG 135)

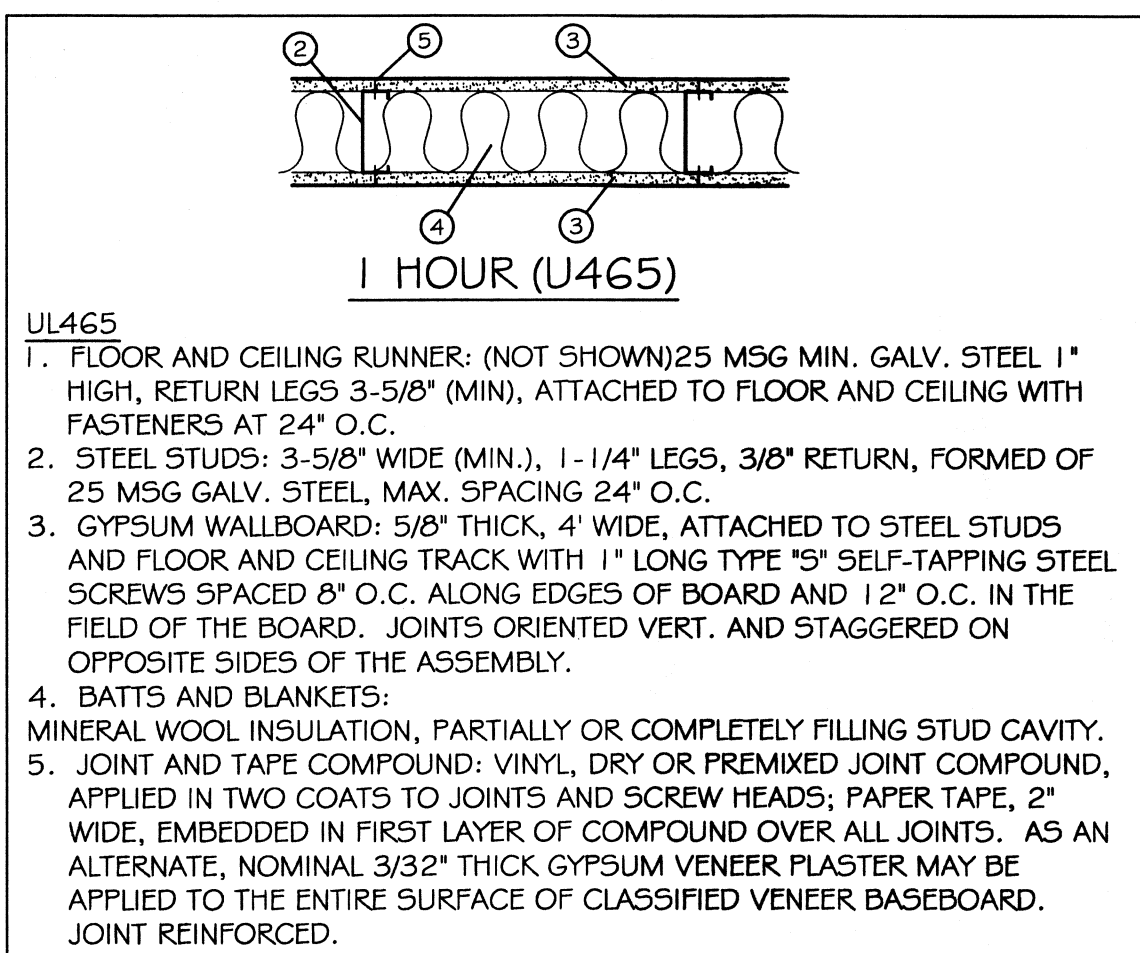

**DOOR & HARDWARE SCHEDULE**

| MARK | SIZE     | DOOR TYPE              | FRAME                | HDWR. NO. | STC | REMARKS        |
|------|----------|------------------------|----------------------|-----------|-----|----------------|
| ①    | EXISTING | NA                     | NA                   | NA        | NA  | EXISTING       |
| ②    | 3/0x3/0  | FLUSH HOLLOW CORE WOOD | GALV. PTD. HOL. MET. | 4         | NA  | COLOR BY OWNER |
| ③    | 3/0x3/0  | FLUSH HOLLOW CORE WOOD | GALV. PTD. HOL. MET. | 5         | NA  | COLOR BY OWNER |

**DOOR HARDWARE SCHEDULE:**

- AUTO CLOSER, PANIC BAR, AIR RESISTANT METAL THRESHOLD, WEATHERSTRIP, DOOR STOP, EXTERIOR CYLINDER LOCK (OFFICE ENTRANCE), BALL BEARING US322 HINGES.
- AUTO CLOSER, DOOR STOP, CYLINDER LOCK (OFFICE ENTRANCE), BALL BEARING US322 HINGES.
- PASSAGE LOCK, DOOR STOP, US262 HINGES.
- KEYED HANDLE (OFFICE ENTRANCE), DOOR STOP, US262 HINGES.
- AUTO CLOSER, DOOR STOP, PRIVACY LOCK, BALL BEARING US262 HINGES.

**LEGEND:**

GWB GYPSUM WALL BOARD  
CT CEILING TILE, 2x2'  
RB RUBBER BASE 4" HIGH  
VCT VINYL COMPOSITION TILE (NON-SKID)

**FINISH SCHEDULE**

| ROOM NAME          | WALLS        | FLOOR | WALL BASE | CLG     | CLG HGT | COMMENTS   |
|--------------------|--------------|-------|-----------|---------|---------|------------|
| TOILET             | 5/8" PTD GWB | VCT   | RB        | PTD GWB | 8'      | GREEN ROCK |
| OFFICES CLASSROOMS | 5/8" PTD GWB | VCT   | RB        | CT      | 10'     |            |
| WAITING ROOM       | 5/8" PTD GWB | VCT   | RB        | CT      | 10'     |            |

**FINISH SCHEDULE NOTES:**

1. ALL FINISH MATERIALS TO BE SELECTED BY OWNER. VERIFY MANUFACTURER, STYLE, AND COLOR, WITH OWNER.

4 2 3 1 5 9  
REVIEWED FOR  
STATE FIRE MARSHAL  
AS PER REVIEW LETTER  
BY WILLIAM D. JONES, ARCHITECT, CBO  
*William D. Jones*

**DAMMON ENGINEERING**  
Architects & Engineers

**SILVAN LEARNING**  
TYLER SQUARE  
58-465 TYLER STREET SUITE #3 & 4  
SLIDELL, LA

JOB No: 2153 DATE: 10-11-12 CHECKED BY: BSN  
DRAWN BY: BSN

REVISIONS

| # | DESCRIPTION | DATE |
|---|-------------|------|
|   |             |      |

*Robert White*

**FLOOR & REFLECTED PLAN**

SHEET No: 2 OF 4

**A-1**

CHIEF ENGINEER: RYAN W. DAMMON, P.E.  
CHIEF ARCHITECT: ROBERT WILISE  
554 OLD SPANISH TRAIL  
SLIDELL, LA 70456  
PHONE: 985-649-5832  
FAX: 985-641-5950