

## FLOOR-CEILING SYSTEMS, WOOD-FRAMED

GA FILE NO. FC 5406

GENERIC

1 HOUR  
FIRE

35 to 39 STC  
SOUND

### WOOD JOISTS, GYPSUM WALLBOARD

**Base** layer 5/8" type X gypsum wallboard applied at right angles to 2 x 10 wood joists 24" o.c. with 1 1/4" Type W or S drywall screws 24" o.c. **Face** layer 5/8" type X gypsum wallboard or gypsum veneer base applied at right angles to joists with 1 7/8" Type W or S drywall screws 12" o.c. at joints and intermediate joists and 1 1/2" Type G drywall screws 12" o.c. placed 2" back on either side of end joints. Joints offset 24" from base layer joints. Wood joists supporting 1/2" plywood with exterior glue applied at right angles to joists with 8d nails. **Ceiling provides one hour fire resistance protection for framing, including trusses.**

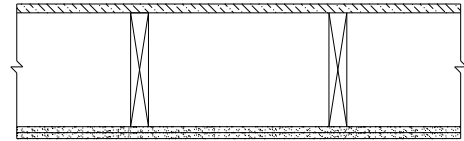

Approx. Ceiling  
Weight: 5 psf  
Fire Test: FM FC 172, 2-25-72;  
ITS, 8-6-98  
Sound Test: Estimated