

**PENETRATION ADDITION WITH PARAPRO 123 FLASHING**  
PARADIENE 20/30 FR - RIGID INSULATION

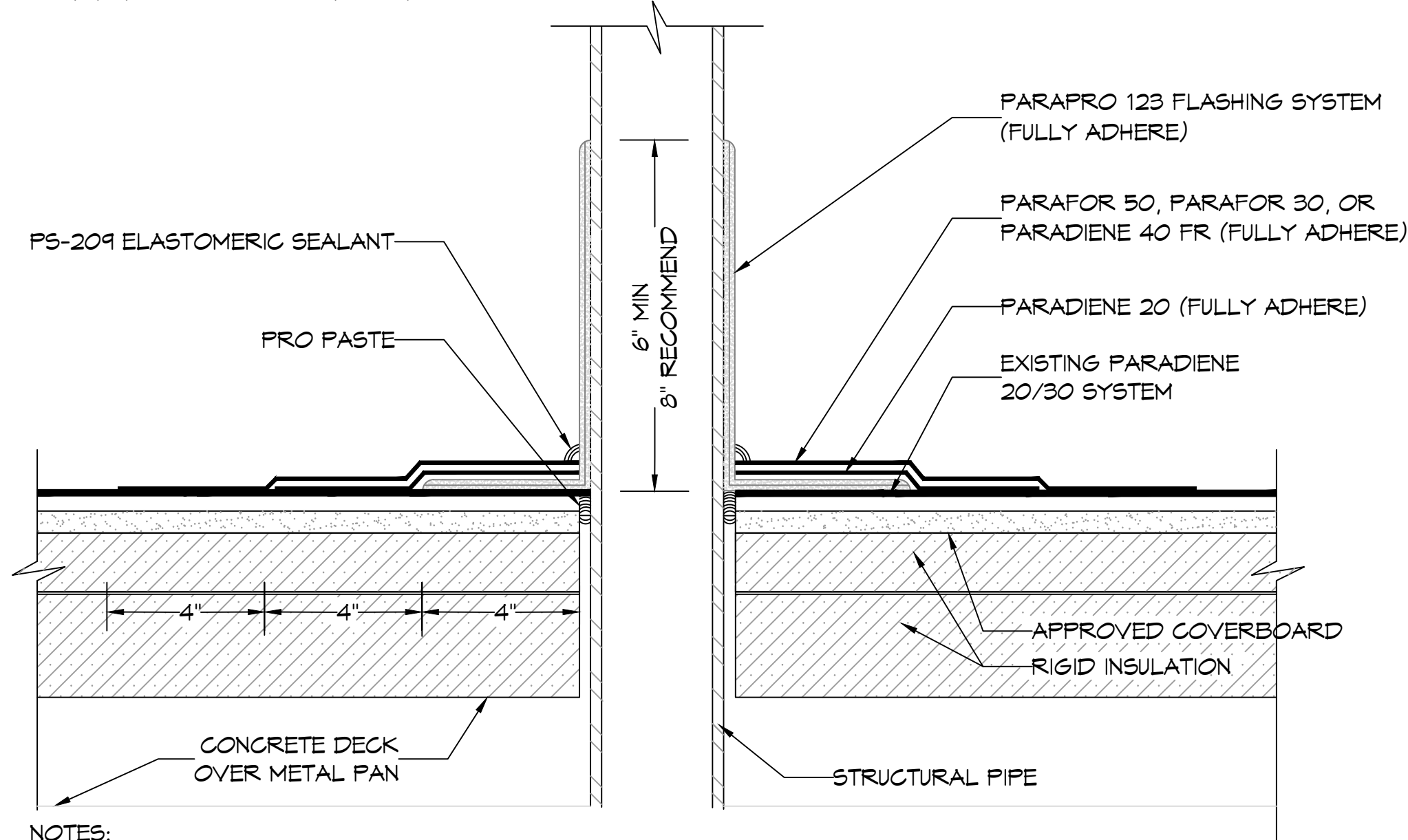

NOTES:

- BEFORE APPLICATION OF PARAPRO 123 FLASHING SYSTEM, PRO PASTE SHOULD BE USED TO FILL VOIDS WHERE ROOFING MEMBRANES TERMINATE AT PENETRATIONS.
- REFER TO SIPLAST PREPARATION GUIDELINES FOR PROPER SURFACE TREATMENT OF ALL MATERIALS PRIOR TO APPLICATION OF PARAPRO FLASHING.
- REFER TO SIPLAST FLEECE CUTTING RECOMMENDATIONS FOR CONFIGURATIONS, CUTTING, FOLDING AND LAPPING TECHNIQUES.
- REQUIREMENTS AND RECOMMENDATIONS DETAILED IN THE CURRENT SIPLAST SPECIFICATIONS AND THE PARAPRO 123 FLASHING SYSTEM INSTALLER'S GUIDE SHALL APPLY IN ADDITION TO THE ABOVE DRAWING.

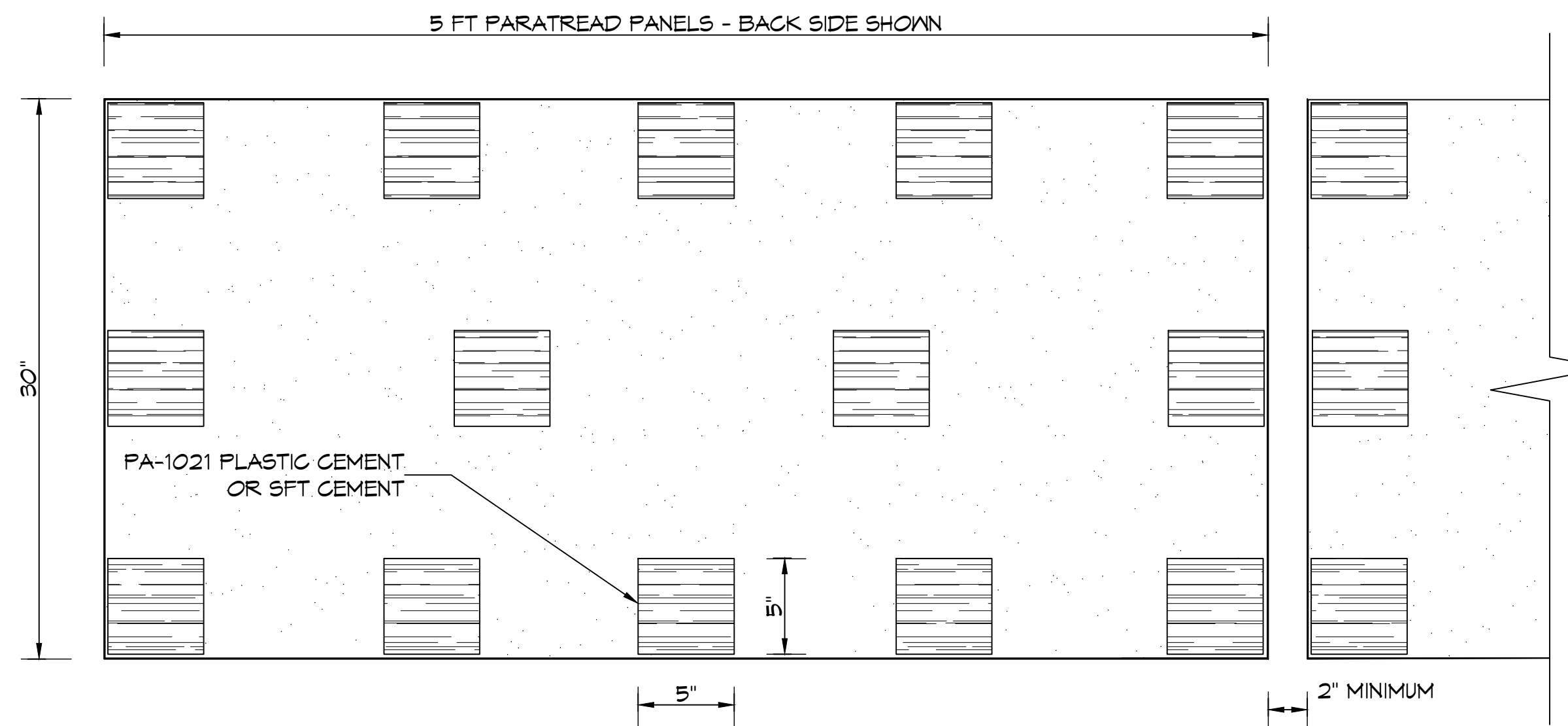

NOTES:

- PARATREAD IS APPLIED WITH PA-1021 PLASTIC CEMENT TO BOTH GRANULE SURFACED AND FOIL FINISHED MEMBRANES. THE PANELS MUST BE PRE-CUT FROM THE ROLL IN MAXIMUM 5 FOOT LENGTHS AND ALLOWED TO RELAX PRIOR TO APPLICATION. COLD WEATHER APPLICATION MAY REQUIRE PRE-WARMING PANELS TO ALLOW THE MATERIAL TO LAY FLAT. THE PA-1021 PLASTIC CEMENT IS APPLIED TO THE BACK SIDE OF THE PARATREAD IN APPROX. 5\"/>
- PARATREAD IS NOT APPROVED FOR USE ON SLOPES IN EXCESS OF 3\"/>
- REQUIREMENTS AND RECOMMENDATIONS DETAILED IN CURRENT SIPLAST SPECIFICATIONS SHALL APPLY IN ADDITION TO THE ABOVE DRAWING.

**ROOF NOTES**

- THIS ROOF HAS A 20-YR. ROOF MEMBRANE / SYSTEM GUARANTEE WITH SIPLAST PARAGUARD PERIMETER EDGE SYSTEM INCLUSION. THE GUARANTEE NO. 53583 HAS AN EXPIRATION DATE OF 10/05/2031.
- ALL ROOF REPAIRS, PENETRATIONS AND WALKING TREAD INSTALLATIONS SHALL BE PERFORMED BY A SIPLAST APPROVED CONTRACTOR TO MAINTAIN WARRANTY OF THE ROOF AND ANY IMPROVEMENTS.
- PARATREAD PANELS SHALL BE INSTALLED SO THAT NORMAL AIR FILTER MAINTENANCE OF THE ROOF TOP HVACS CAN BE DONE WITHOUT DAMAGING THE ROOF.

**ROOF PLAN**  
SCALE: 1/8" = 1'-0"

**WALKING SURFACE**  
SCALE: N.T.S.

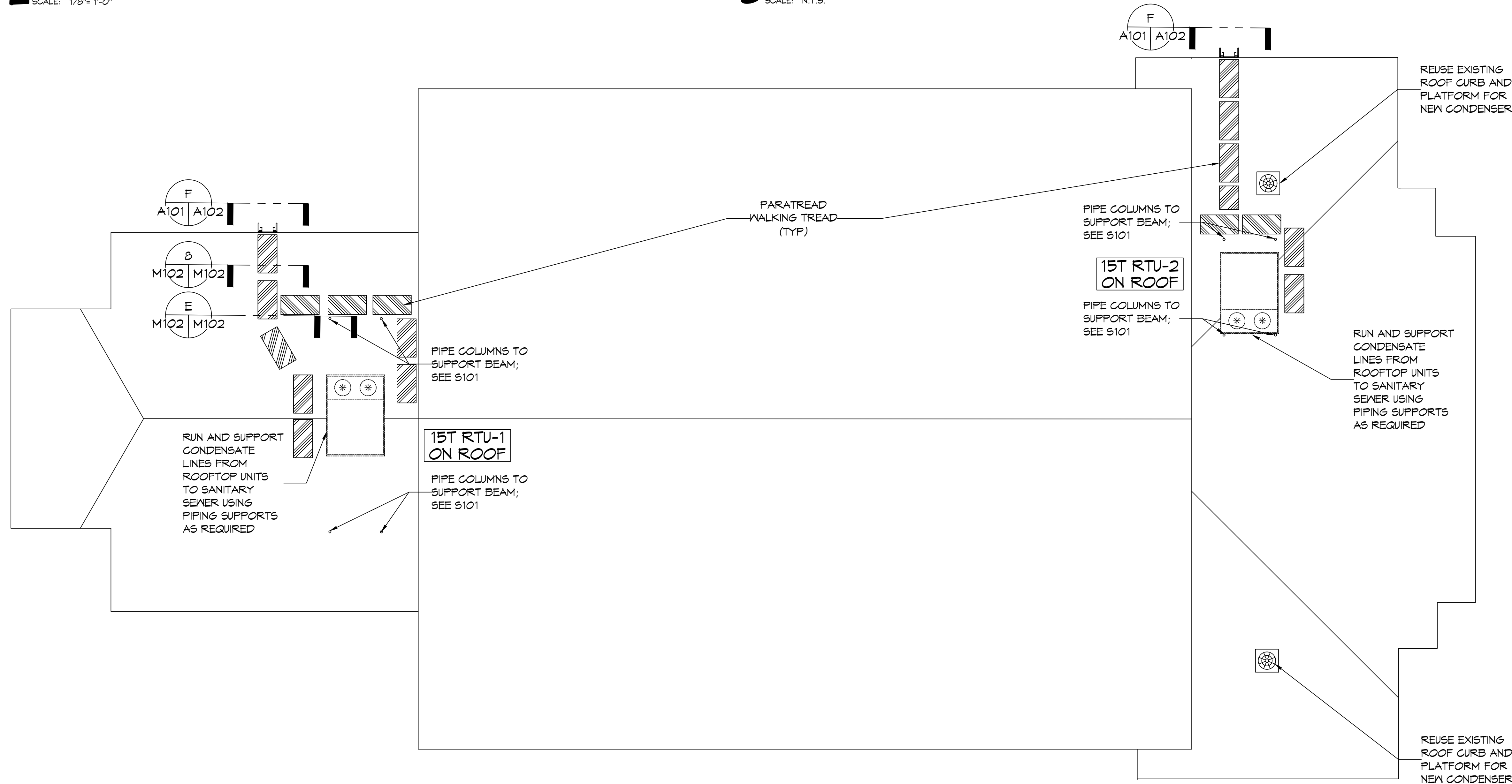

**ROOF PLAN**  
SCALE: 1/8" = 1'-0"

**DAMMON ENGINEERING, INC.**  
LOUISIANA & MISSISSIPPI  
Chief Engineer: Brian Mistich, PE  
554 Old Spanish Trail  
Slidell, LA 70458  
www.dammonengineering.com  
info@dammonengineering.com  
PH: 985.649.5832

#	DESCRIPTION	DATE

SEAL:

**MECHANICAL RENOVATIONS**  
**BOYETT JUNIOR HIGH SCHOOL**  
51295 Rebel Dr.  
Slidell, LA 70461  
JOB No: 2465  
DATE: 3-1-2023  
DRAWN BY: CKD  
CHECKED BY: BAK

SHEET TITLE:  
ROOF PLAN  
DRAWING NUMBER:  
**M102**  
SHEET No: 6 of 9