

PENETRATION ADDITION WITH PARAPRO 123 FLASHING
PARADIENE 20/30 FR - RIGID INSULATION

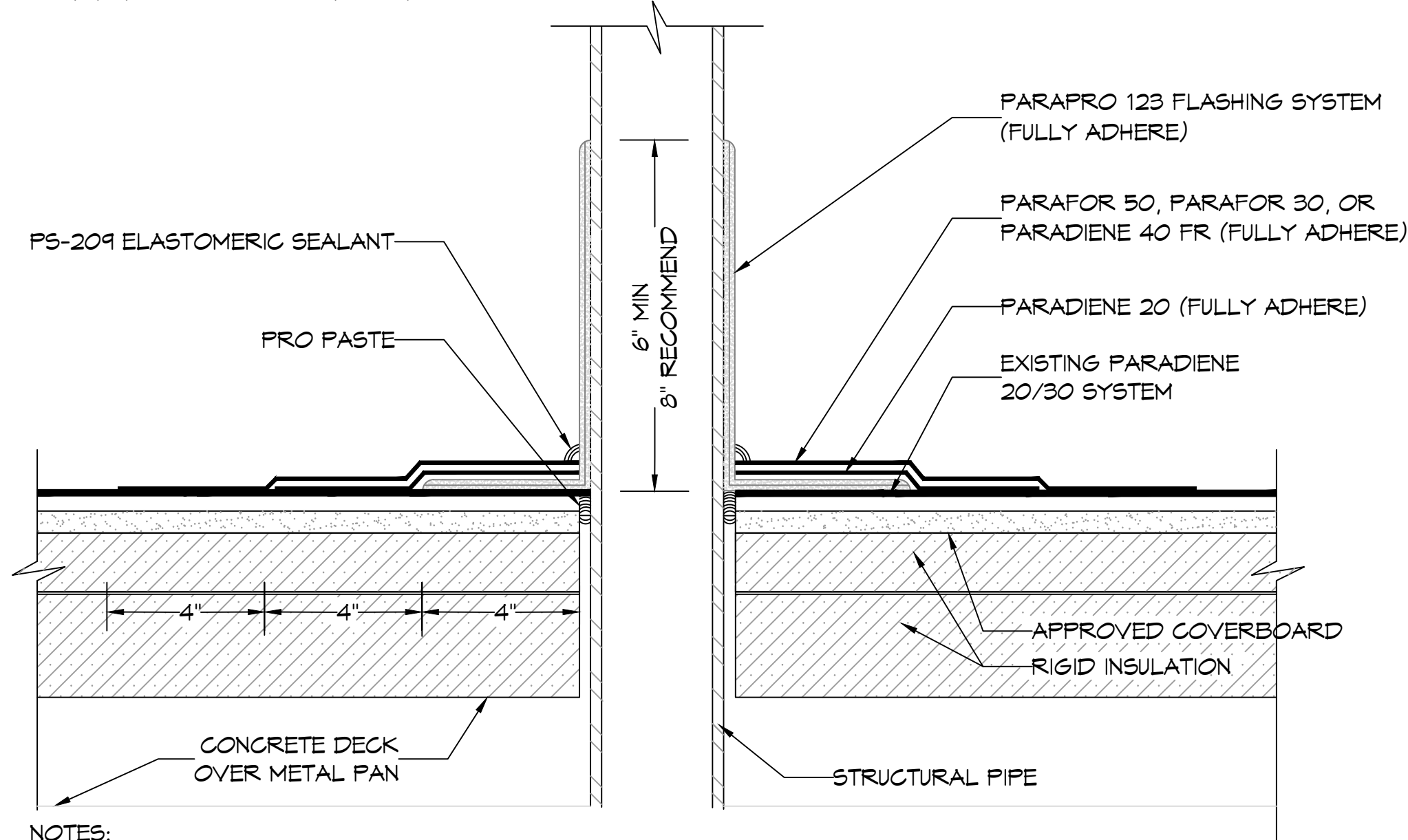

NOTES:

- BEFORE APPLICATION OF PARAPRO 123 FLASHING SYSTEM, PRO PASTE SHOULD BE USED TO FILL VOIDS WHERE ROOFING MEMBRANES TERMINATE AT PENETRATIONS.
- REFER TO SIPLAST PREPARATION GUIDELINES FOR PROPER SURFACE TREATMENT OF ALL MATERIALS PRIOR TO APPLICATION OF PARAPRO FLASHING.
- REFER TO SIPLAST FLEECE CUTTING RECOMMENDATIONS FOR CONFIGURATIONS, CUTTING, FOLDING AND LAPPING TECHNIQUES.
- REQUIREMENTS AND RECOMMENDATIONS DETAILED IN THE CURRENT SIPLAST SPECIFICATIONS AND THE PARAPRO 123 FLASHING SYSTEM INSTALLER'S GUIDE SHALL APPLY IN ADDITION TO THE ABOVE DRAWING.

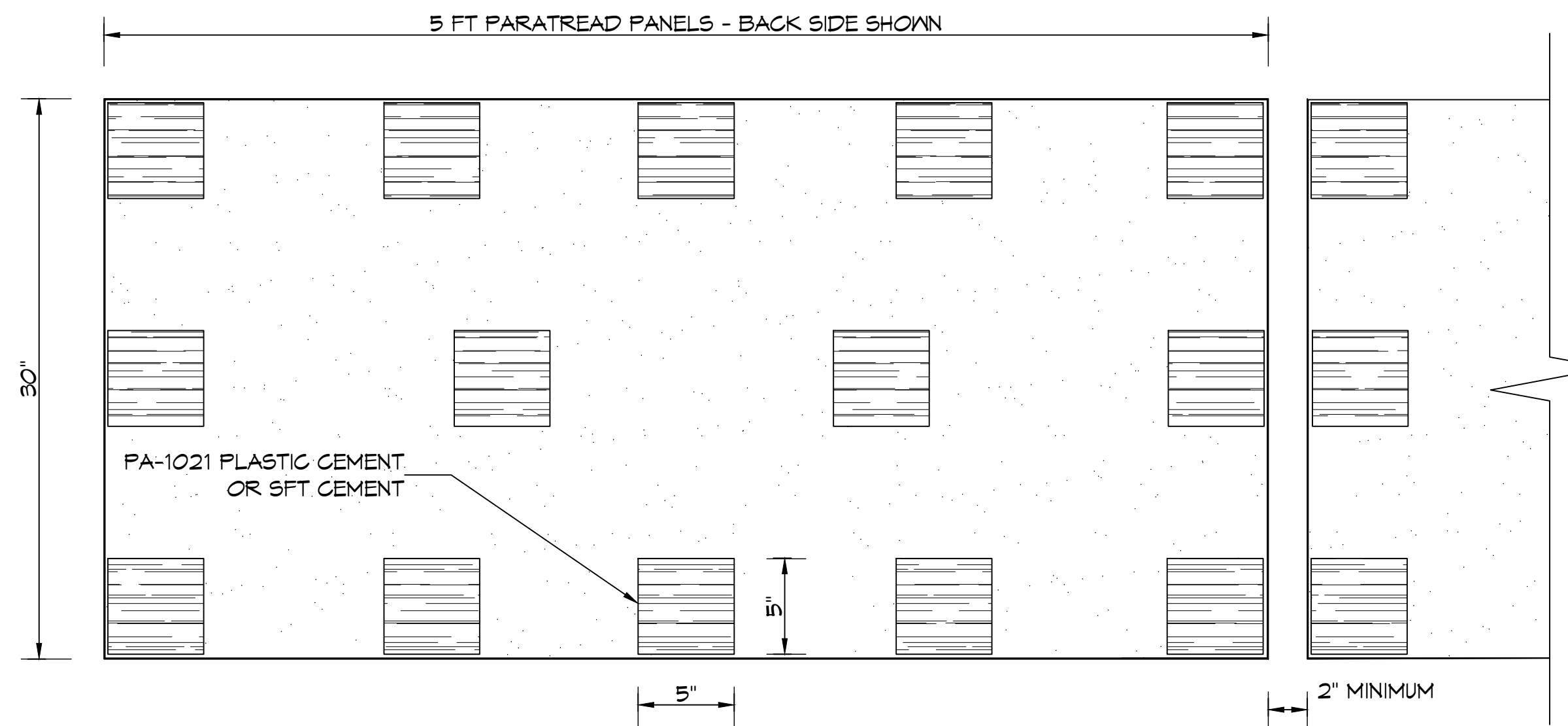

NOTES:

- PARATREAD IS APPLIED WITH PA-1021 PLASTIC CEMENT TO BOTH GRANULE SURFACED AND FOIL FINISHED MEMBRANES. THE PANELS MUST BE PRE-CUT FROM THE ROLL IN MAXIMUM 5 FOOT LENGTHS AND ALLOWED TO RELAX PRIOR TO APPLICATION. COLD WEATHER APPLICATION MAY REQUIRE PRE-WARMING PANELS TO ALLOW THE MATERIAL TO LAY FLAT. THE PA-1021 PLASTIC CEMENT IS APPLIED TO THE BACK SIDE OF THE PARATREAD IN APPROX. 5" SQUARES, SPACED APPROX. 11" O.C. AT THE OUTER EDGES AND 14" O.C. DOWN THE MIDDLE OF THE PANELS. THE PARATREAD PANEL IS SET OVER THE ROOF MEMBRANE SURFACE WITH THE GRANULE SURFACE SIDE UP. PRESSURE SHOULD BE EXERTED ON THE PANEL TO ENSURE POSITIVE CONTACT OF THE PLASTIC CEMENT TO THE ROOF SURFACE.
- PARATREAD IS NOT APPROVED FOR USE ON SLOPES IN EXCESS OF 3" IN 12".
- REQUIREMENTS AND RECOMMENDATIONS DETAILED IN CURRENT SIPLAST SPECIFICATIONS SHALL APPLY IN ADDITION TO THE ABOVE DRAWING.

ROOF NOTES

- THIS ROOF HAS A 20-YR. ROOF MEMBRANE / SYSTEM GUARANTEE WITH SIPLAST PARAGUARD PERIMETER EDGE SYSTEM INCLUSION. THE GUARANTEE NO. 53583 HAS AN EXPIRATION DATE OF 10/05/2031.
- ALL ROOF REPAIRS, PENETRATIONS AND WALKING TREAD INSTALLATIONS SHALL BE PERFORMED BY A SIPLAST APPROVED CONTRACTOR TO MAINTAIN WARRANTY OF THE ROOF AND ANY IMPROVEMENTS.
- PARATREAD PANELS SHALL BE INSTALLED SO THAT NORMAL AIR FILTER MAINTENANCE OF THE ROOF TOP HVACS CAN BE DONE WITHOUT DAMAGING THE ROOF.

ROOF PLAN
SCALE: 1/8" = 1'-0"

WALKING SURFACE
SCALE: N.T.S.

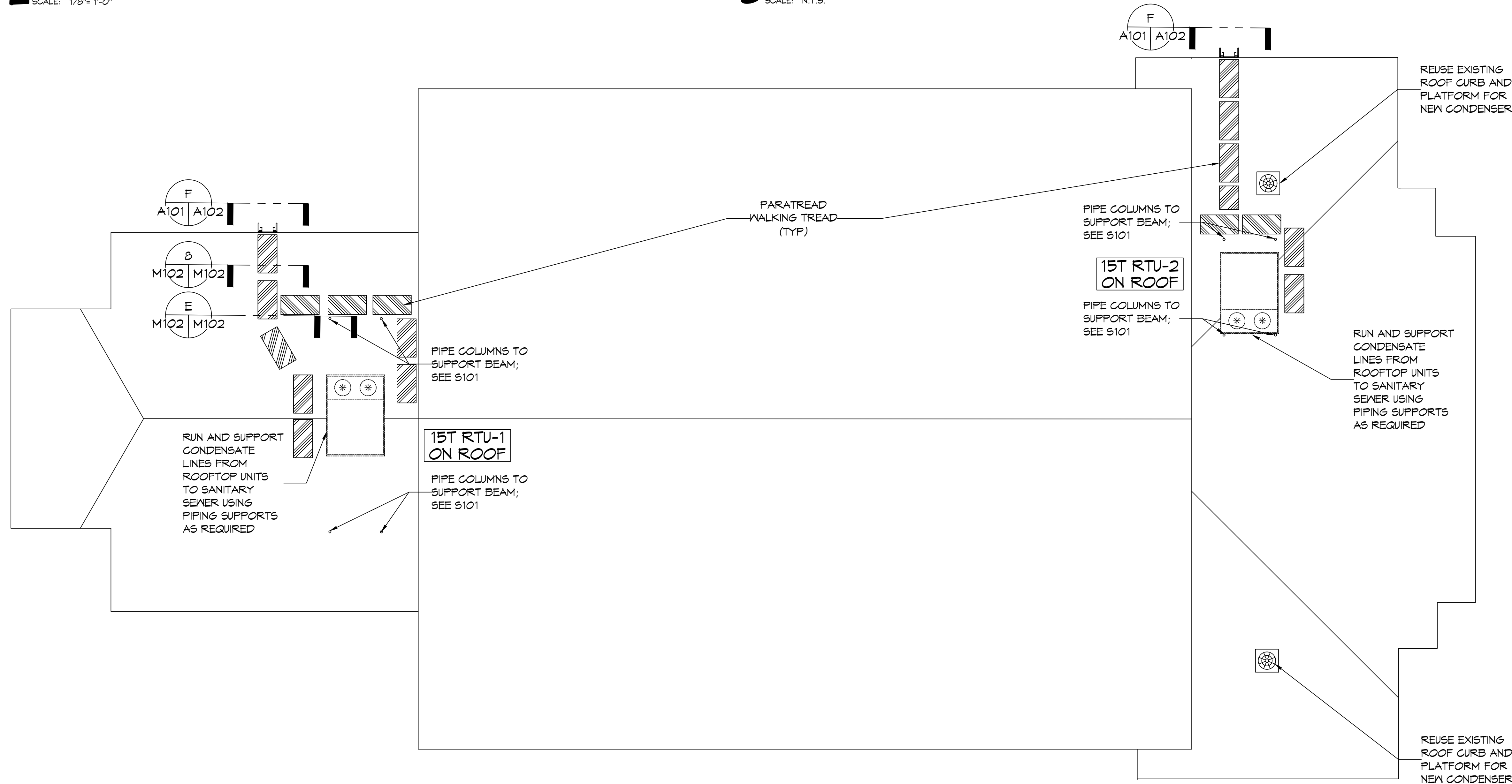

ROOF PLAN
SCALE: 1/8" = 1'-0"

DAMMON ENGINEERING, INC.
LOUISIANA & MISSISSIPPI
Chief Engineer: Brian Mistich, PE
554 Old Spanish Trail
Slidell, LA 70458
www.dammonengineering.com
info@dammonengineering.com
PH: 985.649.5832

#	DESCRIPTION	DATE

SEAL:

MECHANICAL RENOVATIONS
BOYETT JUNIOR HIGH SCHOOL
51295 Rebel Dr.
Slidell, LA 70461
JOB No: 2465
DATE: 3-1-2023
DRAWN BY: CKD
CHECKED BY: BAK

SHEET TITLE:
ROOF PLAN
DRAWING NUMBER:
M102
SHEET No: 6 of 9