

GENERAL HVAC NOTES

1. CONCEALED DUCTWORK TO BE GALVANIZED SHEET METAL LINED WITH FIBROX GLASS DUCT LINER, MIN R-6. INSTALLED PER SMACNA STANDARDS.
2. SPOURED DUCTWORK TO BE GALVANIZED SHEET METAL LINED WITH FIBROX GLASS DUCT LINER, MIN R-6. INSTALLED PER SMACNA STANDARDS.
3. ROUND FLEXIBLE DUCT TO BE UL-181 CLASS 1, AIR DUCT MATERIALS.
4. DUCT SIZES SHOWN ARE CLEAR INSIDE DIMENSIONS.
5. IN ALL SYSTEMS OVER 2000 CFM AND LESS THAN 15,000 CFM, SMOKE TESTING SHALL BE REQUIRED. SMOKE TESTING SHALL BE IN THE RETURN DUCT DOWNSTREAM OF THE AIR HANDLING UNIT AND ALL FILTERS TO AUTOMATICALLY STOP THE FAN.
6. PROVIDE UL LISTED 125' FRESH AIR IN RETURN AIR OF EACH SYSTEM UNDER 2000 CFM TO SHUT DOWN THE FAN IN THE EVENT OF FIRE.
7. PROVIDE UL RATED FIRE DAMPERS WHERE REQUIRED AT ALL DUCT PENETRATIONS OF FIRE-RATED ASSEMBLIES AND WHERE REQUIRED BY CODE, INCLUDING OUTSIDE AIR INTAKES AND EXHAUST FANS.
8. CONDENSATE DRAINS TO BE PVC PIPE RUN TO FLOWERS P-TRAP WITHIN FIVE FEET OF AIR HANDLING UNITS.
9. ALL AIR HANDLING SYSTEMS TO BE BALANCED TO ASSURE PROPER AIR FLOWS PER PLANS.
10. ALL THERMOSTATS TO BE AUTOMATIC CHANGED/OVER WITH HEAT SWITCH.
11. EXHAUST FAN SHALL BE CONTROLLED BY A SWITCH ON THE WALL IN THE SAME LOCATION AS LIGHT SWITCH(S). PROVIDE BACK DRAFT DAMPER.
12. PROVIDE AND INSTALL WATER PROOF GULLIE VENT IN PROPER ROOF LOCATION FOR PUMPING FIXTURE EXHAUST.
13. ALL SUPPLY AIR VENTS SHALL BE EQUIPPED WITH AIR CONTROL DAMPERS AT THE REGISTER.
14. LOCATE OUTDOOR UNITS AS SHOWN ON ARCHITECTURAL DRAWINGS.
15. REFRIGERANT LINES SHALL BE SIZED BY UNIT MANUFACTURER AND INSTALLED ACCORDING TO MANUFACTURER'S INSTRUCTIONS.
16. FRESH AIR SHALL BE SUPPLIED TO EACH AIR HANDLER THROUGH EXTERIOR WALL DUCT SUPPLIED WITH A CONTROL DAMPER.
17. ALL ELECTRICAL, MECHANICAL, AND PUMPING PENETRATING FIRE WALLS SHALL BE FIRE CALKED. (PENETRATIONS THROUGH RATED CONSTRUCTION SHALL BE SEALED WITH A MATERIAL CAPABLE OF PREVENTING THE PASSAGE OF FLAMES AND HOT GASES WHEN TESTED IN ACCORDANCE WITH ASTM E9-14).
18. ALL MECHANICAL SYMBOLS ARE DRAWN DISGRAMMATICALLY. CONTRACTOR TO VERIFY WITH OWNER LOCATIONS OF VENTS, DAMPERS, REGISTERS, ETC.
19. FLEXIBLE DUCTWORK LENGTH NOT TO EXCEED 12'-0".
20. REFER TO REFLECTED CEILING PLAN FOR FINAL GRILLE AND DIFFUSER LOCATION AND COORDINATE AS REQUIRED.
21. FINAL LOCATION OF TEMPERATURE CONTROLS TO BE COORDINATED WITH OWNER AT JOB SITE.
22. PROVIDE AND INSTALL SMOKE DETECTORS AS APPROVED BY LOCAL A.U.S. PLACE NEAR R/A AND S/A OPENINGS OF A/U AND PROVIDE WITH ACCESS PANEL, MARKING BY ELECTRICAL CONTRACTOR.
23. FRESH AIR INTAKES ARE REQUIRED TO HAVE WINDRIZOR OR GRAVITY DAMPERS TO SHUT OFF WHEN SYSTEM IS NOT RUNNING.
24. PROVIDE BRID SCREWS AT ALL EXTERIOR MECHANICAL PENETRATIONS.
25. COORDINATE WALL MOUNTED THERMOSTAT LOCATIONS WITH ALL OWNER FINISHED ITEMS EITHER WALL MOUNTED OR FLOOR MOUNTED AGAINST PARTITIONS. REFER TO ARCHITECTURAL DRAWINGS.
26. SEE ROOF PLAN FOR ALL ROOF PENETRATIONS.
27. PROVIDE MIN 18 GA GALVANIZED SHEET METAL TO BLANK-OFF GABLE VENTS WHERE IN TAKE EXHAUST DUCTS OCCUR.

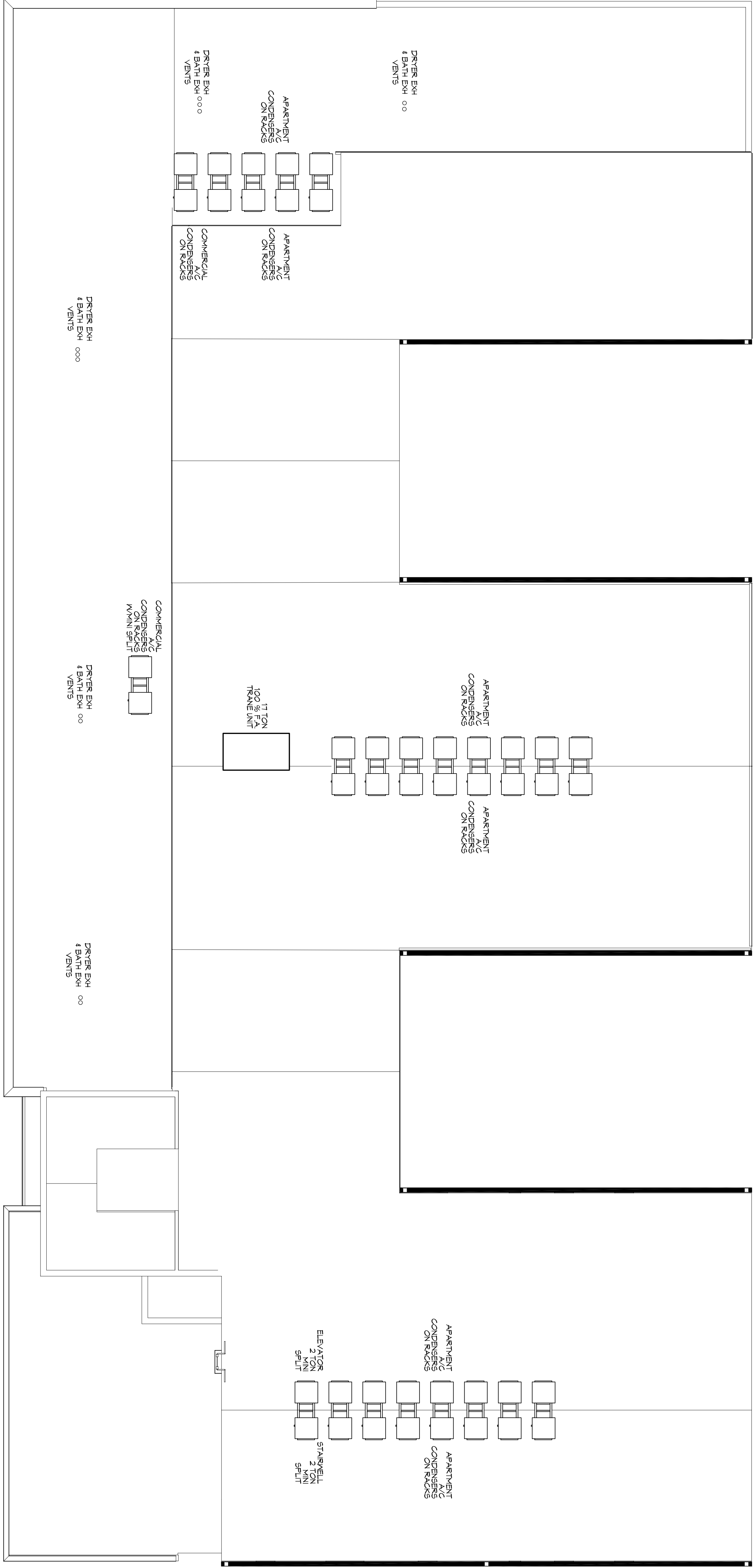

A/C UNIT SCHEDULE					
NO.	TOTAL CFM	COOLING CAPACITY	HEAT CAPACITY	ELECTRICAL	COMMENTS
1	1250	1.250 TON	1.250 TON	45 AMP	LENNOX
2	1250	1.250 TON	1.250 TON	45 AMP	LENNOX
3	1250	1.250 TON	1.250 TON	45 AMP	LENNOX
4	1250	1.250 TON	1.250 TON	45 AMP	LENNOX
5	1250	1.250 TON	1.250 TON	45 AMP	LENNOX
6	1250	1.250 TON	1.250 TON	45 AMP	LENNOX
7	1250	1.250 TON	1.250 TON	45 AMP	LENNOX
8	1250	1.250 TON	1.250 TON	45 AMP	LENNOX
9	1250	1.250 TON	1.250 TON	45 AMP	LENNOX
10	1250	1.250 TON	1.250 TON	45 AMP	LENNOX

- 25 TON CONDENSER MODEL # XPH4-090
 - 25 AIR HANDLER MODEL # CBX2BH-030
 - 20 TON CONDENSER MODEL # XPH4-024
 - 25 AIR HANDLER MODEL # CBX2BH-024
- MINI SPLIT UNITS**
- STARWELLS #15 AND ELEVATOR EQUIPMENT ROOM SHALL BE MITSUBISHI INDOOR UNITS MODEL #MSZ-SZANKA. OUTDOOR UNITS MODEL #MZ-SZANKA.
- TRANE 11 TON 100% FRESH AIR UNIT**
- HORIZON (B/G) PACKAGED CABE MOUNTED MULTI-FUNCTION HEATING, COOLING AND VENTILATION INT. MODEL #OAG5210AS-D10000-000B0000

In/John Venture

DAMMON ENGINEERING, INC.

Architects & Engineers

Chief Engineer: Brian Mistich, PE

534 Old Spanish Trail
Suite 1, LA 70098

www.dammonengineering.com
info@dammonengineering.com
PH: 985.649.5832
F: 985.641.5990