

PROJECT NAME: \_\_\_\_\_

FIXTURE TYPE: \_\_\_\_\_

## HADCO PROFILER PA3S AREA-LYTE SPECIFICATION SHEET



The Hadco Profiler PA3S Area-Lyte luminaire is a straight arm architectural area fixture. Designed for performance, form and function; the PA2 Profiler Area-Lyte is suitable for pole and/or wall mount applications where glare-free cut-off lighting is the requirement. Combined with the Profiler Wall-Lyte and Profiler Flood-Lyte, the low profile aesthetic pleasing family of fixtures meets the requirements of your discriminating customers.

model PA3S

### SPECIFICATIONS

**HOUSING:** Precision machined die-cast aluminum housing eliminates welded seams and water entry. The Profiler incorporates a blend of radial geometries with 45 degree sloping planes and ribbing that provides an aesthetic low profile detail.

**LENS FRAME:** The lens is 3/16" tempered glass. The frame is a one piece precision machined, die-cast part. Lens is recessed in the frame; a silicone gasket seal, (4) stainless steel clips and (4) stainless steel screws secure the lens to the frame. The lens frame assembly incorporates an integral stainless steel hinges and pins (no tools required for maintenance) to connect the assembly to the housing. A stainless steel compression latch locks the assembly.

**OPTICAL ASSEMBLY:** Type I, II, III, IV, V, and Forward Throw reflectors are of highly reflective anodized panels with multiple facets that are rigidly mounted on an aluminum frame. All are 90 degree rotatable and interchangeable.

**ELECTRICAL ASSEMBLY:** Electrical components are mounted on a removable hinged galvanized steel ballast tray, with quick disconnects for easy replacement (no tools required). Ballasts have at power factor greater than 90%. Metal halide ballasts are capable of starting a -20° F or -30° C and HPS at -40° F or -40° C. The mogul base porcelain socket is 4KV rated. All components shall be UL and CSA Listed or cUL recognized and 100% factory tested.

**MOUNTING ASSEMBLY:** Consists of a one-piece straight aluminum extruded arm, with bolt guides, backplate and mounting hardware. The assembly is adaptable to either square or round poles with diameters of 3", 4", 5" and 6". The pole, arm and fixture are connected by a mechanical draw system that incorporates (2) flange nuts and (2) 3/8-16 UNC Zinc Chromated threaded rods.

**FINISH:** Thermoset polyester powdercoat, laboratory tested for superior weatherability and fade resistance in accordance with ASTM B-117-64 and ANSI/ASTM G53-77 specifications.

**CERTIFICATIONS:** UL Listed for wet locations (120, 208, 240, 277, and 480v). cUL Listed for wet locations (120, 277, and 347v only).

**WARRANTY:** Three year limited warranty.

**EPA:** 1.36

**MAX WEIGHT:** 50 lbs.

### ACCESSORIES (Must Be Ordered Separately and Field Installed)

**PA3-PS:** UV stabilized polycarbonate convex shield (replaces tempered glass lens). NOTE: The PA3-PS has limited life due to UV discoloration caused from sunlight and/or metal halide lamps. (maximum wattage: 250 Watts)  
Depth of Shield: 3.177"

**PA3-HSS:** Internally mounted aluminum louvered light shield and black aluminum inserts eliminates house-side spill light. (Not available with optics (F) Forward Throw or (5) Type V.)

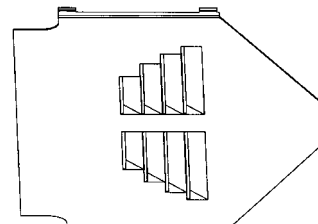
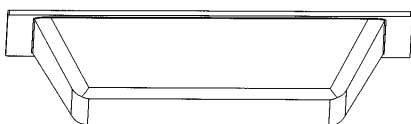

## DIMENSIONS & MOUNTING DETAILS

MAX WEIGHT: 50 lbs.

EPA: 1.36

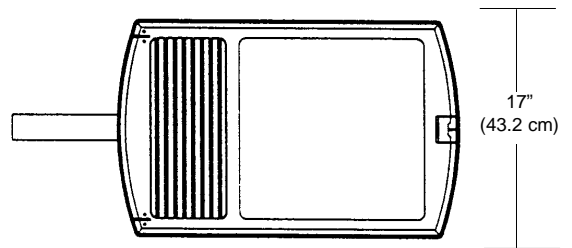
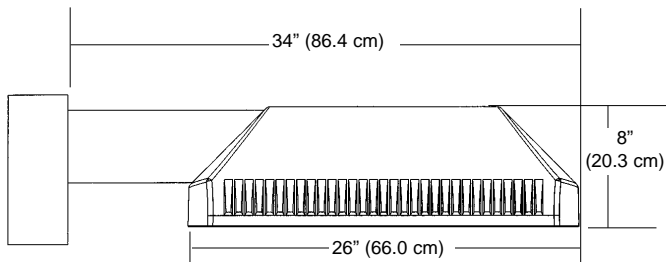

## ORDERING LOGIC

Housing	Arm	Mounting	Finish	Optics	Wattage	Voltage	Options
PA3	S	S	A	3	400H	E	N
<b>PA3</b> Large	<b>S</b> Straight	<b>3</b> 3"O.D. Round Pole <b>4</b> 4"O.D. Round Pole <b>5</b> 5"O.D. Round Pole <b>6</b> 6"O.D. Round Pole <b>S</b> Square Pole <b>W</b> Wall Mount	<b>A</b> Black <b>B</b> White <b>H</b> Bronze <b>X</b> Silver	<b>1</b> Type I <b>2</b> Type II <b>3</b> Type III <b>4</b> Type IV <b>5</b> Type V <b>F</b> Forward Throw	<b>150S</b> 150W HPS <b>250S</b> 250W HPS <b>400S</b> 400W HPS <b>175H</b> 175W MH <b>250H</b> 250W MH <b>400H</b> 400W MH	<b>E</b> 120V <b>F</b> 208V <b>G</b> 240V <b>H</b> 277V <b>K</b> 347V <b>J</b> 480V	<b>N</b> None <b>A</b> Air Filter <b>B</b> Button Eye <b>F</b> Fusing <b>Q</b> Quartz Restrike <b>R</b> PE Receptacle <b>V</b> Tamper-Resistant Latch

Housing	Arm	Mounting	Finish	Optics	Wattage	Voltage	Options

## PROJECT NOTES

---



---



---



---



---



---



---



---

## APPROVAL

