

ORIGINAL

GA FILE NO. WP 3370      GENERIC

ONE LAYER 5/8" TYPE X GYPSUM WALLBOARD OR GYPSUM VENEER BASE APPLIED PARALLEL OR AT RIGHT ANGLES TO EACH SIDE OF DOUBLE ROW OF 2x4 WOOD STUDS 16" O.C. ON SEPARATE PLATES 1" APART WITH 6D COATED NAILS, 1-7/8" LONG, 0.0915" SHANK, 1/4" HEADS, 7" O.C.

JOINTS STAGGERED 16" ON OPPOSITE SIDES. HORIZONTAL BRACING REQUIRED AT MID HEIGHT. (LOAD BEARING)

DETAIL



N.T.S.

1 HOUR FIRE      45 TO 49 STC SOUND

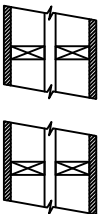

THICKNESS:  
APPROX. WEIGHT:  
FIRE TEST:

9-1/2"  
8 PSF  
SEE WP 3605  
(UL R1319-4, 6, 6-17-52;  
UL R2717-39, 1-20-66;  
UL R3501-52, 3-15-66;  
UL DESIGN U305;  
ULC DESIGN W301)  
ESTIMATED

SOUND TEST:

PROVIDE 3/4" PLYWOOD SMOKE BLOCKING IN FLAT TRUSS EVERY 1,000 S.F.

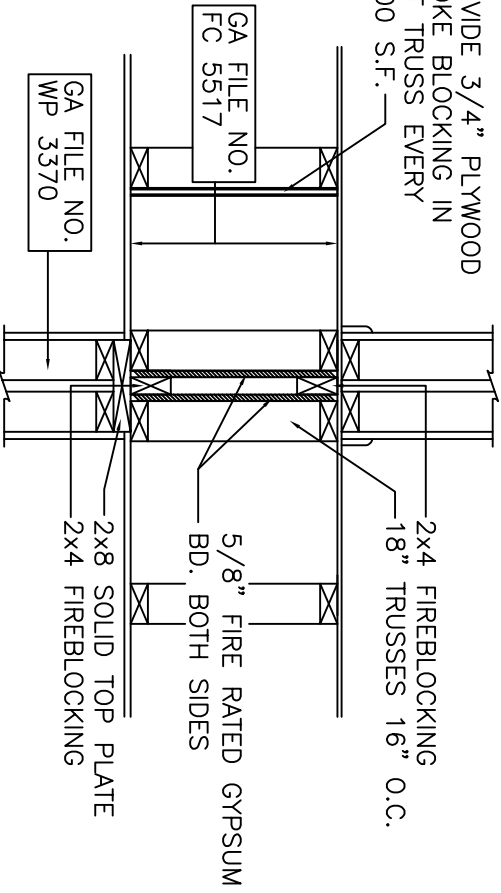

TRUSS SUPPORT AT DIVIDING WALLS

N.T.S.

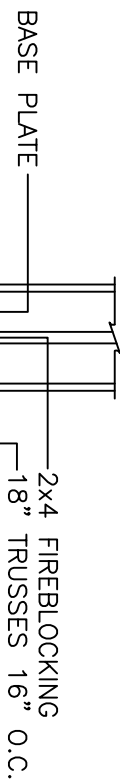

TRUSS SUPPORT AT PARTITION WALLS

N.T.S.