

THESE DRAWINGS ARE THE EXCLUSIVE PROPERTY OF CHERO-KEY PIPING CO., INC. THE IDEAS AND DESIGNS ON THIS SHEET ARE NOT TO BE REPRODUCED, CHANGED OR COPIED IN ANY FORM OR MANNER WHATSOEVER, NOR ARE THEY TO BE ASSIGNED TO ANY THIRD PARTY WITHOUT WRITTEN AUTHORIZATION FROM CHERO-KEY PIPING CO., INC.

**NOTES**

- ALL RISERS TO UNITS ABOVE AND BELOW SIZED AS INDICATED.
- ALL PIPING WITHIN UNITS 3/4" UNLESS NOTED OTHERWISE.

**LEGEND**

ROBERT H. LIGHTFOOT, SR. RME

*[Signature]*

SCR - 0074  
RME - 0079  
NICET - LEVEL IV

**SUN VALLEY 2  
APARTMENTS  
SITE PLAN**

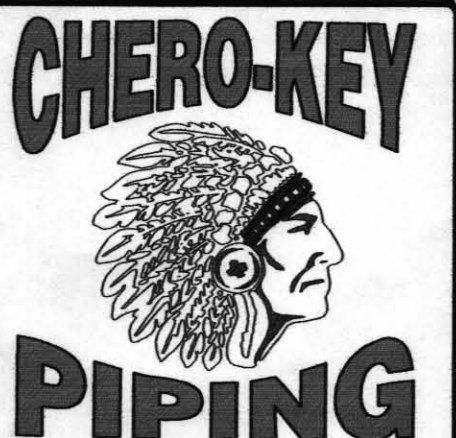

**CHERO-KEY  
PIPING**  
11936 BRITMOORE PARK DRIVE  
HOUSTON, TEXAS 77041  
(713) 856-5612  
(800) 713-2430  
FAX (713) 856-5466  
www.cherokey-piping.com

DESIGN BY: JJP  
DRAWN BY: JJP  
CHECKED BY: RHL  
SUBMITTED BY: 12/4/06  
DATE: 12/19/06  
SCALE: 1" = 30'-0"  
JOB NUMBER: 8429

**REVISIONS**

NO.	DESCRIPTION

**SUN VALLEY 2  
APARTMENTS**

800 JOSEPH STREET  
SLIDELL, LA. 70458

**REINE  
CONSTRUCTION**

PLAN No:  
**ASP02**

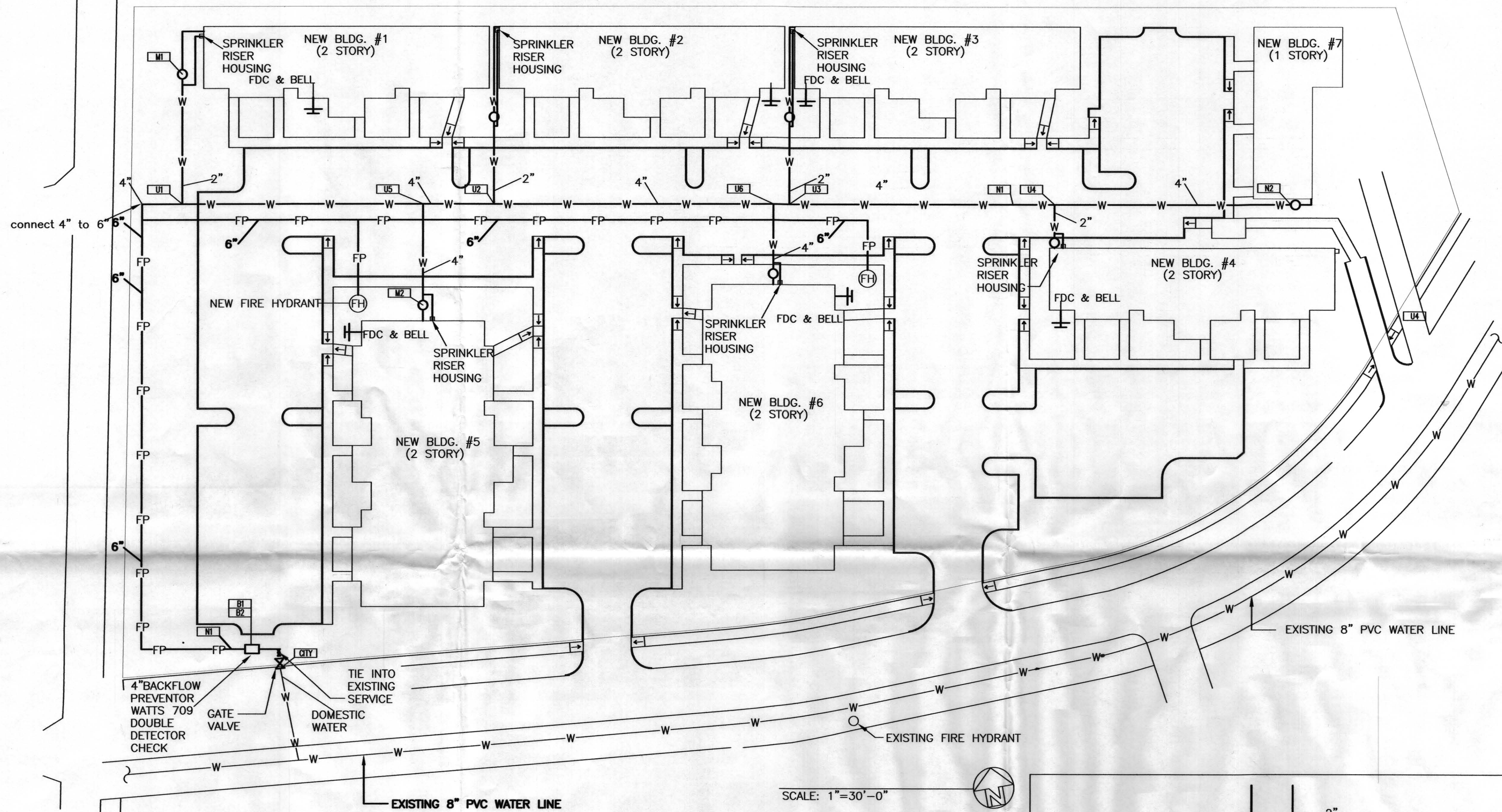

TOTAL BUILDINGS WATER DAMAND 220 GPM

THIS SHEET IS FOR HYDRAULIC PURPOSE ONLY. UNDERGROUND NOT PART OF CHERO-KEY PIPING SCOPE OF WORK.

**FLOW TEST**  
STATIC PRESSURE = 64 P.S.I.  
RESIDUAL PRESSURE = 42 P.S.I.  
FLOW = 978 G.P.M.  
DATE = 12/13/06

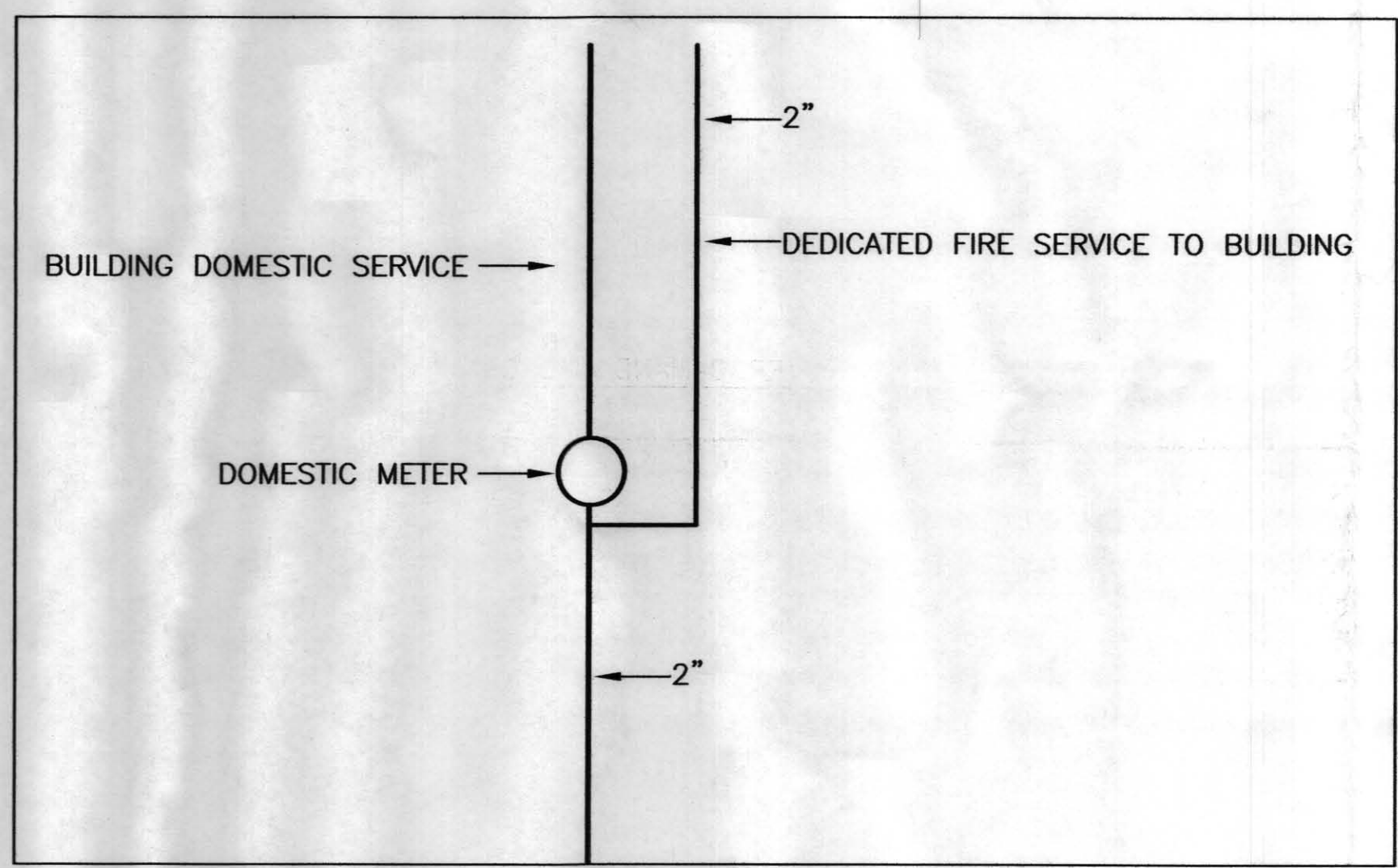

I have reviewed these plans and certify that they comply with the adopted NFPA standards.

Cherokey-Piping Co.  
11936 Britmoore Park Dr.  
Houston, Texas 77041  
713/856-5612  
SCR - 0074

RME Signature: *[Signature]*  
Printed RME Name: Robert H. Lightfoot Sr.  
Date: 24 Dec 2006

AS-BUILT  SUBMITTAL  OTHER