

DAMMON ENGINEERING, INC.
 CHIEF ENGINEER
 EMMETT DAMMON, P.E.
 CHIEF ARCHITECT
 ROBERT WILTSE

554 OLD SPANISH TRAIL
 SUITE LL, LA 70458
 OFFICE: 985-649-5832
 FAX: 985-641-5950

WWW.DAMMONENGINEERING.COM
 EMAIL: DAMMONENG@BELLFLOWTH.NET

ARCHITECTURE
 ENGINEERING
 PLANNING
 INVESTIGATION
 EXPERT WITNESSES

NEW APARTMENTS
 CASEY CIVIL, LLC
 LOT 2A
 TERRACE AVE
 SLIDELL, LA

LIGHTING PLAN

REV:
 SCALE: AS NOTED
 JOB#:
 DATE: 06-16-11
 SHEET 11

PANEL: LP-1
 LOCATION: KITCHEN WALL IN APARTMENT 1
 FEEDER SOURCE: NEAREST SERVICE ENTRANCE

VOLTAGE: 240/120V, 150A, 1Ø, 3W
 1 25A MAIN BREAKER, 1 25A MAIN BUS
 ENCLOSURE: FLUSH MOUNTED W/ EQUIPMENT GND BAR
 SQUARE D TYPE OO LOAD CENTER

OUT. NO.	TRAILER SIZE	LOAD DESCRIPTION	BREAKER AMP	FUSE	LOAD (VA)	LOAD (VA)	BREAKER AMP	FUSE	LOAD DESCRIPTION	TRAILER SIZE	OUT. NO.
1	#6	HEATER/COOLER UNIT (RH)	45	2	5000	5000	30	2	AIR COMPRESSOR UNIT	#10	2
3	#6	1Ø RV	5000		5000	5000			2 1/2 TON	#10	4
5	#6	RANGE	40	2	4800	2250	30	2	WATER HEATER (40 GAL)	#10	6
7	#6	WASHER/DRYER COILS	30	2	2930	920	20	1	LIVING + DINING RECEPTACLES	#12	10
9	#10	WASHER/DRYER COILS	30	2	2930	920	20	1	BEDROOM 1 RECEPTACLES + SMOKE DETECTOR, ALC, VENT	#12	12
11	#10	BEDROOM 1 GROUND 7W W/ LIGHT	20	1	1800	500	20	1	BEDROOM 2 RECEPTACLES + SMOKE DETECTOR, ALC, VENT	#12	14
13	#12	BEDROOM 1 GROUND 7W W/ LIGHT	20	1	1800	500	20	1	BEDROOM 2 RECEPTACLES + SMOKE DETECTOR, ALC, VENT	#12	16
15	#12	BEDROOM 2 GROUND 7W W/ LIGHT	20	1	300	200	20	1	KITCHEN AND HALLWAY LIGHTS	#12	22
17	#12	EXHAUST FAN	20	1	300	200	20	1	BATHROOM VENT AND LIGHTS	#12	24
19	#12	EXHAUST FAN	20	1	300	200	20	1	BATHROOM VENT AND LIGHTS	#12	26
21	#12	EXHAUST FAN	20	1	300	200	20	1	EXHAUST FAN	#12	28
23	#12	EXHAUST FAN	20	1	300	200	20	1	EXHAUST FAN	#12	30
25	#12	EXHAUST FAN	20	1	300	200	20	1	EXHAUST FAN	#12	30
27	#12	EXHAUST FAN	20	1	300	200	20	1	EXHAUST FAN	#12	30
29	#12	EXHAUST FAN	20	1	300	200	20	1	EXHAUST FAN	#12	30
					TOTAL CONNECTED LOAD (VA) = 46,330						
					482-23.91Ø						

PANEL: LP-2
 LOCATION: KITCHEN WALL IN APARTMENT 2
 FEEDER SOURCE: NEAREST SERVICE ENTRANCE

VOLTAGE: 240/120V, 150A, 1Ø, 3W
 1 25A MAIN BREAKER, 1 25A MAIN BUS
 ENCLOSURE: FLUSH MOUNTED W/ EQUIPMENT GND BAR
 SQUARE D TYPE OO LOAD CENTER

OUT. NO.	TRAILER SIZE	LOAD DESCRIPTION	BREAKER AMP	FUSE	LOAD (VA)	LOAD (VA)	BREAKER AMP	FUSE	LOAD DESCRIPTION	TRAILER SIZE	OUT. NO.
1	#6	HEATER/COOLER UNIT (RH)	45	2	5000	5000	30	2	AIR COMPRESSOR UNIT	#10	2
3	#6	1Ø RV	5000		5000	5000			2 1/2 TON	#10	4
5	#6	RANGE	40	2	4800	2250	30	2	WATER HEATER (40 GAL)	#10	6
7	#6	WASHER/DRYER COILS	30	2	2930	920	20	1	LIVING + DINING RECEPTACLES	#12	10
9	#10	WASHER/DRYER COILS	30	2	2930	920	20	1	BEDROOM 1 RECEPTACLES + SMOKE DETECTOR, ALC, VENT	#12	12
11	#10	BEDROOM 1 GROUND 7W W/ LIGHT	20	1	1800	500	20	1	BEDROOM 2 RECEPTACLES + SMOKE DETECTOR, ALC, VENT	#12	14
13	#12	BEDROOM 1 GROUND 7W W/ LIGHT	20	1	1800	500	20	1	BEDROOM 2 RECEPTACLES + SMOKE DETECTOR, ALC, VENT	#12	16
15	#12	BEDROOM 2 GROUND 7W W/ LIGHT	20	1	300	200	20	1	KITCHEN AND HALLWAY LIGHTS	#12	22
17	#12	EXHAUST FAN	20	1	300	200	20	1	BATHROOM VENT AND LIGHTS	#12	24
19	#12	EXHAUST FAN	20	1	300	200	20	1	BATHROOM VENT AND LIGHTS	#12	26
21	#12	EXHAUST FAN	20	1	300	200	20	1	EXHAUST FAN	#12	28
23	#12	EXHAUST FAN	20	1	300	200	20	1	EXHAUST FAN	#12	28
25	#12	EXHAUST FAN	20	1	300	200	20	1	EXHAUST FAN	#12	28
27	#12	EXHAUST FAN	20	1	300	200	20	1	EXHAUST FAN	#12	28
29	#12	EXHAUST FAN	20	1	300	200	20	1	EXHAUST FAN	#12	30
					TOTAL CONNECTED LOAD (VA) = 46,330						
					482-23.91Ø						

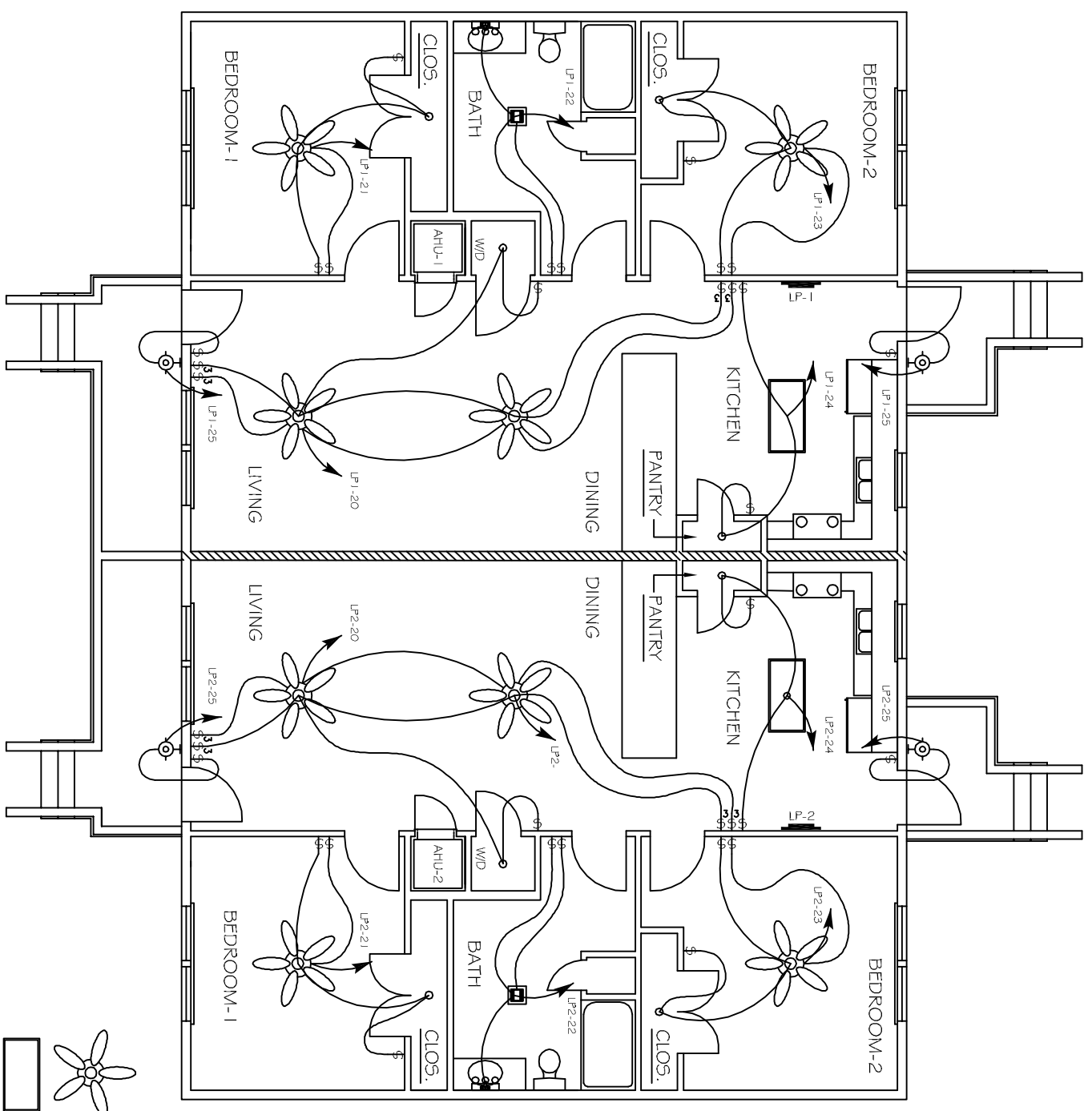

LIGHTING PLAN
 SCALE: 1/4" = 1'

- LEGEND**
- CEILING FAN WITH LIGHT FIXTURE
 - 2x4' CEILING MOUNTED FLUORESCENT LIGHT
 - 1x4' CEILING MOUNTED FLUORESCENT LIGHT
 - 3 BULB HOLLYWOOD LIGHT FIXTURE
 - VENT LIGHT WITH EXHAUST FAN
 - SINGLE BULB CEILING MOUNTED FIXTURE
 - SURFACE MOUNTED EXTERIOR LIGHT FIXTURE
 - SWITCH
 - 3-WAY SWITCH
 - POWER PANEL

