

REAR
SLIDING
DOOR

15'-4"

33'-5"

DEN

CLOSET

A/C

1/2 BATH

KITCHEN

FIRST FLOOR

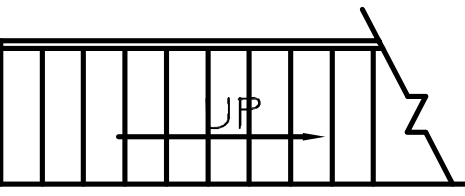

REAR
SLIDING
DOOR

15'-4"

33'-5"

MASTER
BEDROOM

W/D

FULL BATH

W/H

SPARE
BEDROOM

CLOSET

SECOND FLOOR

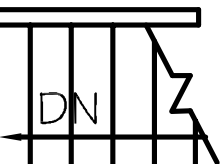

EXISTING PARTY WALL, 1/2" SHEET ROCK AND SOUND BOARD TO REMAIN.

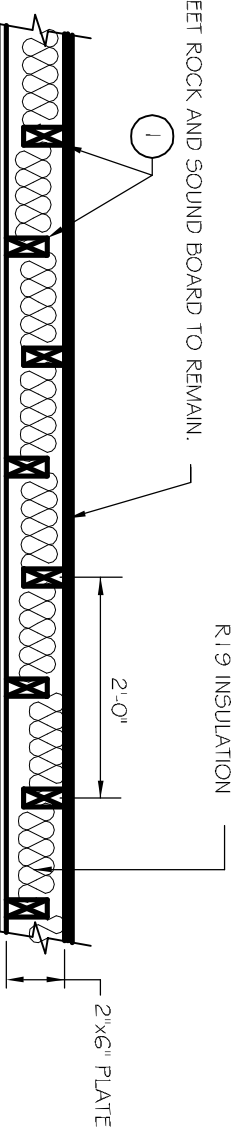

1. WOOD STUDS - NOM. 2x4 IN. ALTERNATING ON OPPOSITE SIDES OF NOM. 2x6" WOOD PLATES SPACED 24" O.C. MAX ON EACH SIDE OF PLATE
2. WALLBOARD GYPSUM 5/8" THICK WALLBOARD PAPER FACE. TAPERED EDGES. WALLBOARD NAILED TO EACH STUD 7" O.C. WITH 6d CEMENT COATED NAILS. 1 7/8" LONG. #6 BUGLE HEAD DRY WALL SCREWS MAY BE SUBSTITUTED FOR THE 6d CEMENT COATED NAILS, WHEN USED IN WIDTHS OTHER THAN 48", WALLBOARD TO BE INSTALLED HORIZONTALLY.
3. JOINTS AND NAIL HEADS - WALLBOARD JOINTS COVERED WITH TAPE AND JOINT COMPOUND. NAIL HEADS COVERED WITH JOINT COMPOUND.

THE PARTY WALL IS TO EXTEND VERTICALLY FROM FIRST FLOOR TO BOTTOM OF ROOF SHEATHING.
FIRE RESISTANCE RATINGS ANSUL263 (BXUV)
DESIGN *U340 BEARING WALL RATING 1 HR.

1 HR. PARTY WALLS
N.T.S.

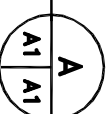

2009 INTERNATIONAL EXISTING BUILDING CODE
CHAPTER 5 REPAIRS
SECTION 502
BUILDING ELEMENTS AND MATERIALS

THIS IS A 3 STORY APARTMENT BLDG. WITH FOUR TWO STORY UNITS. THE THIRD FLOOR IS A PENTHOUSE WHICH IS THE WIDTH OF ALL THE FOUR UNITS BELOW.
THIS APARTMENT BLDG WAS BUILT IN THE LATE 70S UNDER THE SBC WITH 1/2" SHEETROCK. UNIT "A" CAUGHT FIRE (ARSON). THE OWNER HAS REMOVED ALL SHEETROCK WALLS AND CEILINGS. THE OWNER SHALL REPLACE ALL SHEET ROCK WITH NEW 5/8" TYPE "X" AND ALL ASSOCIATED FIXTURES.

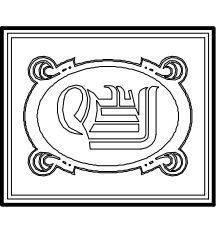

DAMMON ENGINEERING, INC.
CHIEF ENGINEER
EMMETT DAMMON, P.E.
CHIEF ARCHITECT
ROBERT WILTSE

554 OLD SPANISH TRAIL
SLIDELL, LA. 70458
OFFICE: 985-649-5632
FAX: 985-641-5950

WEBSITE:
WWW.DAMMONENGINEERING.COM
EMAIL:
DAMMONENG@BLSOUTH.NET

ARCHITECTURE
ENGINEERING
STUDIES
PLANNING
INVESTIGATION
EXPERT WITNESS

FRED FURLAN
P.O. BOX 2677
SLIDELL, LA
70458

COURER DE VILLE
2021 BAYOU LANE
UNIT A
SLIDELL, LA
70458

REV:	
SCALE:	AS NOTED
JOB#:	
DATE:	03-21-12
SHEET	A-1
OF	