

# ALGIERS PEDIATRIC

## FRAME SCHEDULE

OLDCASTLEFG-5100 : Storefront : StormMax : Center Set : 2-1/2 x 5 : 1-5/16 in. Impact Glass : Dry Glazed

## DOOR SCHEDULE

OLDCASTLE BRAND MSD-37D MEDIUM (IMPACT) W/ HARDWARE SHOWN ON SCHEDULE

## GLASS SCHEDULE

G1- 1/4" CLEAR TEMP - 1/2" MILL AIRSPACE - 1/4" CLEAR TEMP(.090 PVB) 1/4" CLEAR TEMP

G2- 1/4" CLEAR TEMP(.090 PVB) 1/4" CLEAR TEMP

G3- 1/4" (SPANDREL) TEMP- 1/2" MILL AIRSPACE - 1/4" CLEAR TEMP(.090 PVB) 1/4" CLEAR TEMP

## VINYL OR SEALANTS SCHEDULE

FG-5946 - INTERIOR WEDGE FG5948

FG-5947 - EXTERIOR GASKET

SIKAFLEX TEXTURED SEALANT ( BRONZE)

## FINISHES

BRONZE ANNOXIDIZED

## FLASHING

STANDARD FLASHING MANUFACTURED BY OLDCASTLE.

## HARDWARE SCHEDULE

MFG STD BUTT HINGES

MFG STD PUSH/PULLS

MFG STD SURFACE CLOSERS

MFG STD WEATHER SEALS

MFG STD THRESHOLD

## LEGENDS / ABBREVIATIONS

SHEET NO.1 COVER SHEET  
 SHEET NO.2 ELEVATION A  
 SHEET NO.3 ELEVATION B  
 SHEET NO.4 ELEVATION C  
 SHEET NO.5 ELEV DOOR 101  
 SHEET NO.6 ELEV DOOR 102  
 SHEET NO.7 WINDOW DETAILS  
 SHEET NO.8 DOOR DETAILS  
 SHEET NO.9 DOOR DETAILS  
 SHEET NO.10GLASS PERFORMANCE  
 SHEET NO.11 FRAMING SYSTEM  
 SHEET NO.12 FRAMING SYSTEM CONTINUED  
 SHEET NO.13 DOOR SYSTEM  
 SHEET NO. 14 DOOR SYSTEM CONTINUED

## ARCHITECT AND CONTRACTOR NOTE

THESE SHOP DRAWINGS SHOW OUR INTERPERATION OF THE PROJECT AND ARE SUBMITTED FOR APPROVAL. OUR RESPONSIBILITY SHALL BE LIMITED TO FURNISHING, FABRICATING AND INSTALLING THE MATERIALS IN ACCORDANCE WITH THESE APPROVED DETAILS.

ALL DIMENSIONS TO BE VERIFIED IN THE FIELD. UNLESS OTHERWISE SPECIFIED WE WILL FABRICATE AND INSTALL TO SHOWN DIMENSIONS.

MATERIALS WILL BE RELEASED ONLY UPON ACCEPTANCE OF SIGNED DRAWINGS BY THE ARCHITECT AND BY THE GENERAL CONTRACTOR OR WRITTEN REQUEST OF THE GENERAL CONTRACTOR.

IF HARDWARE IS TO BE FURNISHED BY OTHERS, TEMPLATES AND PHYSICAL HARDWARE MUST BE IN OUR POSSESSION OR IN THE POSSESSION OF OUR FABRICATOR PRIOR TO FABRICATION.

## EXCLUSIONS

ALL SUBSTRATE BUILDING MATERIALS SHOWN IN THE DETAILS PORTION OF THIS SHOP DRAWING ARE TO BE SUPPLIED, FABRICATED, AND INSTALLED "BY OTHERS" UNLESS SPECIFICALLY NOTED OTHERWISE. ( I.E BRICK, CMU, E.I.F.S., WOOD BLOCKING, STUCCO ON METAL LATHE, GYPSUM BORD, SHEATHIN, METAL OR WOOD STUDS, STRUCTURAL STEEL, STEEL ANGLES, STEEL LINTEL, POUR STOPS, INSULATION, METAL PANELS AND TRIM, SUSPENDE CEILING, METAL TRIM, THRU-WALL FLASHING, INTERIOR CAULING,

ARCHITECT	patrick schwall - 10
	REVISED 4/29/2016
CONTRACTOR	REVISED
	PROJECT NO.
PROJECT	VERGES ROME
	ALGIERS PEDIATRIC
GLAZING CONTRACTOR	STAR GLASS INC
	SHEET NO. 10 OF

DRAWINGS PREPARED BY STAR GLASS INC

48"

28 3/8"

12"

48"

20 1/4"

20 1/4"

G1

G1

G1

G1

1

2

0 1/8"

31"

# ALGIERS PEDIATRIC - 001 - MARK A.dwg (5 Thus)

GLAZING CONTRACTOR  
STAR GLASS INC

PROJECT  
ALGIERS  
PEDIATRIC

ARCHITECT  
VERGES ROME

CONTRACTOR  
DEW ENTERPRISES

SHEET  
NO.

OF

patrick schwall - 10  
REVISED - 4/29/2016  
REVISED  
REVISED  
PROJECT NO.

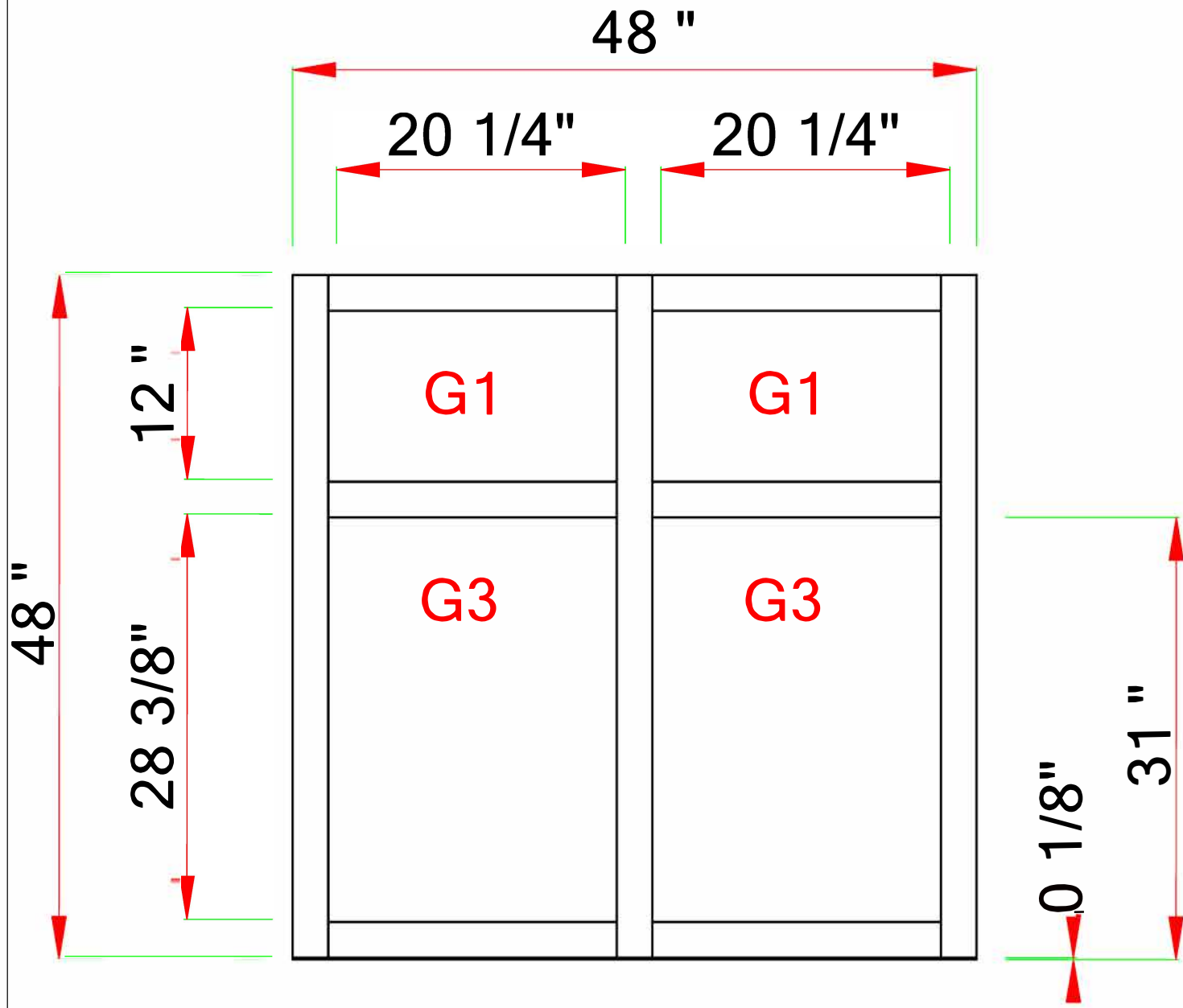

**1 2**  
**ALGIERS PEDIATRIC - 002 - MARK B.dwg (1 Thus)**

GLAZING CONTRACTOR STAR GLASS INC	PROJECT ALGIERS PEDIATRIC	ARCHITECT VERGES ROME CONTRACTOR DEW ENTERPRISES	patrick schwall - 10 REVISED 4/29/2016 REVISED REVISED PROJECT NO.
--------------------------------------	------------------------------	---	--

SHEET NO. OF

DRAWINGS PREPARED BY STAR GLASS INC

48"

28 3/8"

12"

36"

14 1/4"

14 1/4"

G1

G1

G1

G1

0 1/8"

31"

1

2

ALGIERS PEDIATRIC - 003 - MARK C.dwg (1 Thus)

GLAZING CONTRACTOR  
STAR GLASS INC

PROJECT  
ALGIERS PEDIATRIC

ARCHITECT  
VERGES ROME  
CONTRACTOR  
DEW ENTERPRISE

patrick schwall - 10  
REVISED 4/29/2016  
REVISED  
REVISED  
PROJECT NO.

SHEET NO.  
OF

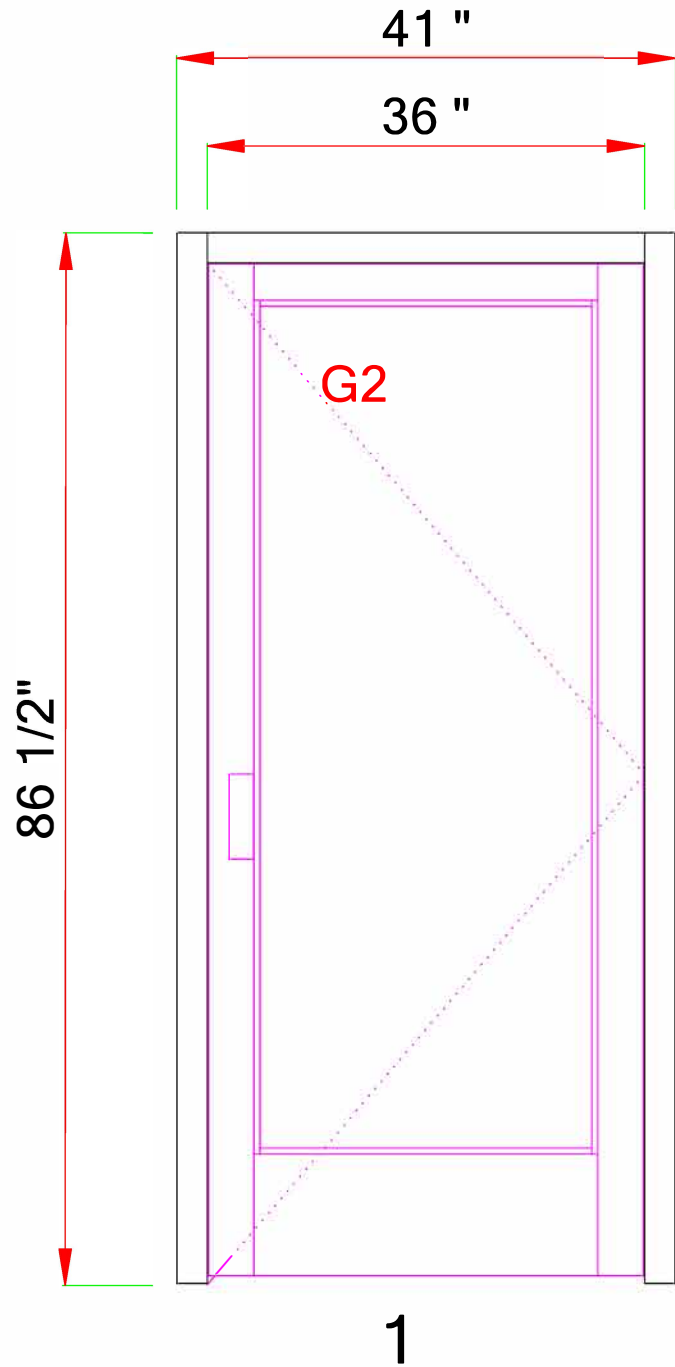

ALGIERS PEDIATRIC - 004 - ENTRANCE 101.dwg (1 Thus)

GLAZING CONTRACTOR STAR GLASS INC	PROJECT ALGIERS PEDIATRIC	ARCHITECT	patrick schwall - 10
		VERGES ROME	REVISED 4/29/2016
SHEET NO.	OF	CONTRACTOR	REVISED
		DEW ENTERPRISE	REVISED
			PROJECT NO.

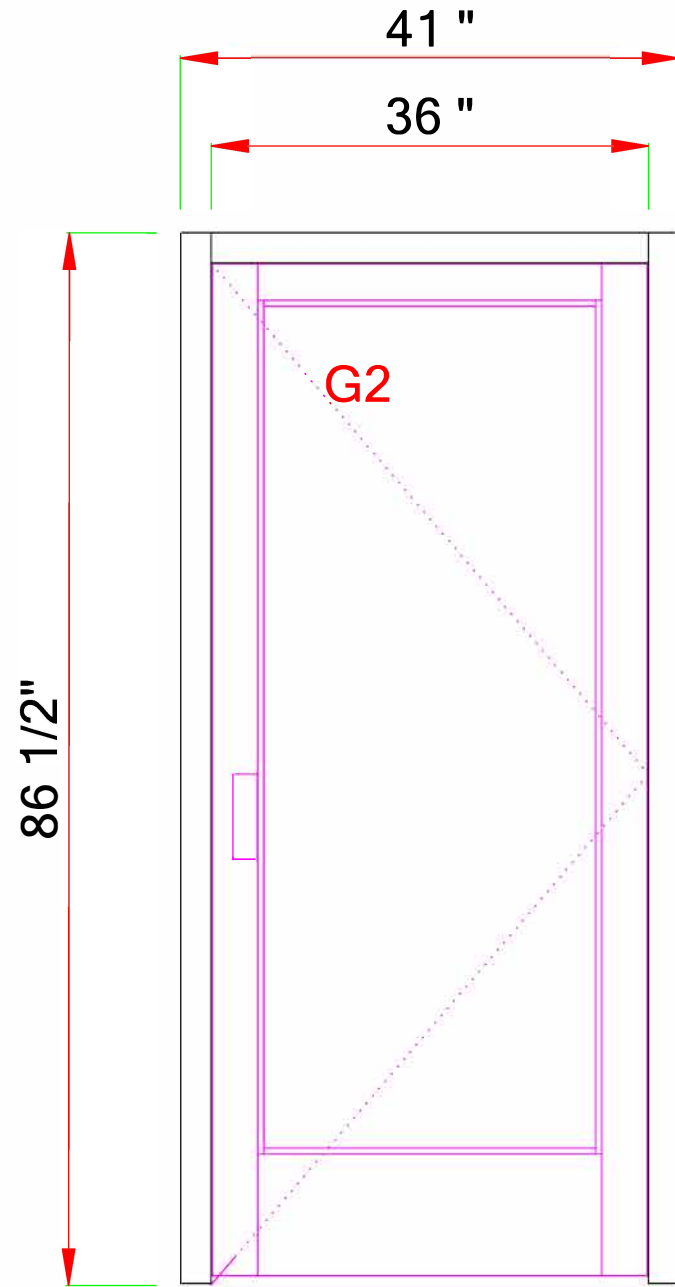

1

ALGIERS PEDIATRIC - 005 - ENTRANCE 102.dwg (1 Thus)

GLAZING CONTRACTOR STAR GLASS INC	PROJECT ALGIERS PEDIATRIC	ARCHITECT	patrick schwall - 10
		CONTRACTOR	REVISOR
		DEW ENTERPRISES	REVISION DATE
			PROJECT NO.

SHEET NO. OF

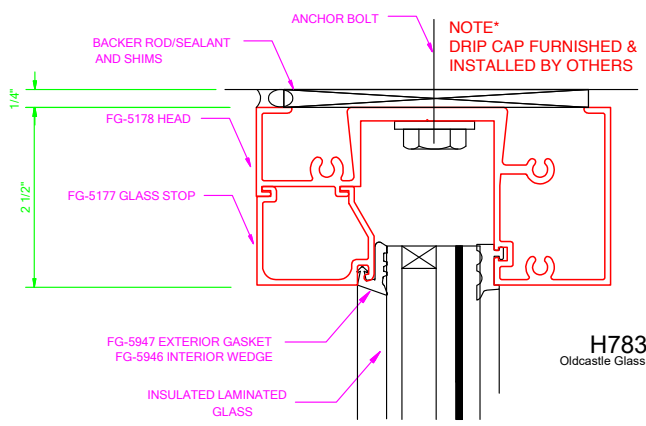

NOTE\* DRIP CAP FURNISHED & INSTALLED BY OTHERS

H7831  
Oldcastle Glass © Vistawall ©

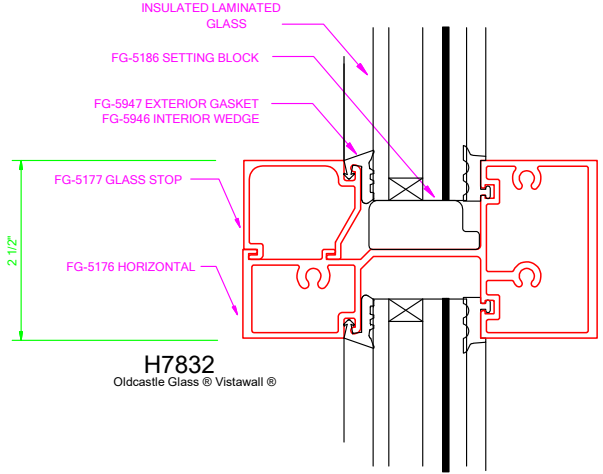

H7832  
Oldcastle Glass © Vistawall ©

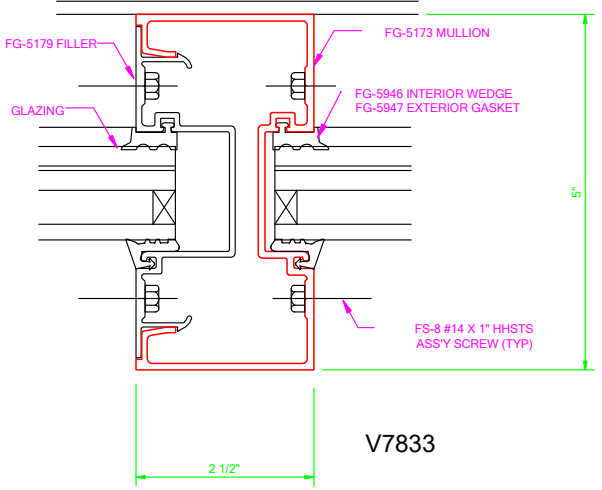

V7833

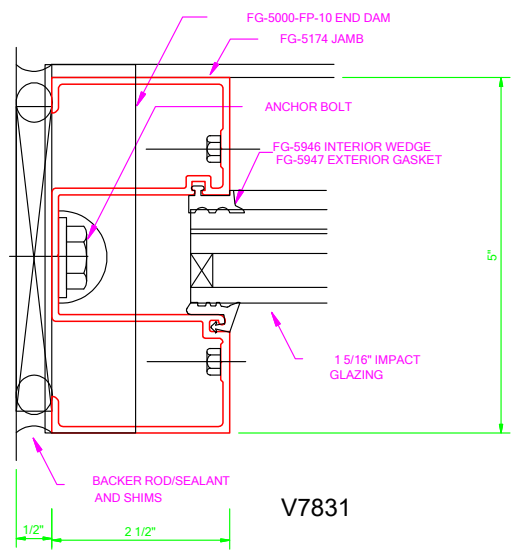

V7831

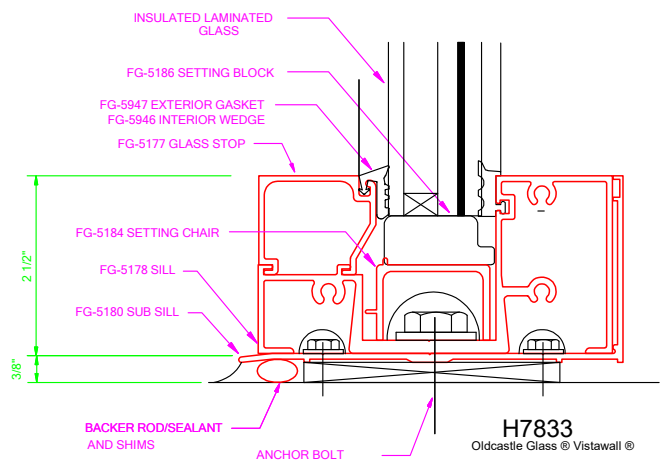

H7833  
Oldcastle Glass © Vistawall ©

NOTE\* DRIP CAP FURNISHED & INSTALLED BY OTHERS

PROJECT ALGIERS PEDIATRIC	ARCHITECT	patrick schwall - 10
	VERGES ROME	REVISED 4/29/2016
	CONTRACTOR	REVISED
GLAZING CONTRACTOR STAR GLASS INC	DEW ENTERPRISES	PROJECT NO.
SHEET NO.	OF	

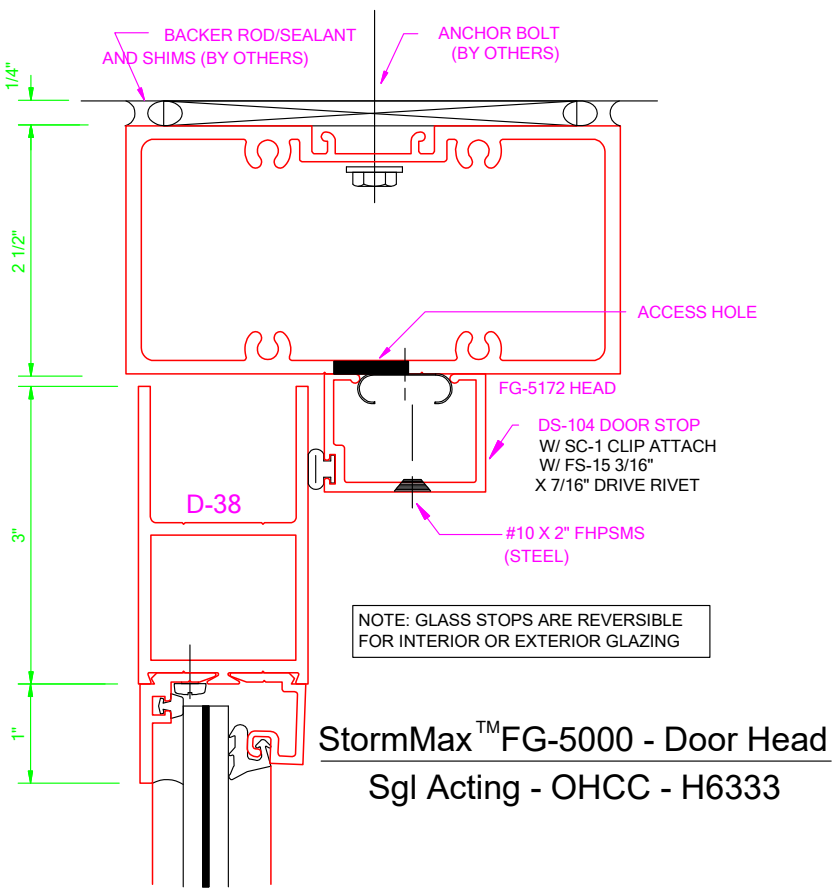

NOTE: GLASS STOPS ARE REVERSIBLE FOR INTERIOR OR EXTERIOR GLAZING

**StormMax™ FG-5000 - Door Head**  
**Sgl Acting - OHCC - H6333**

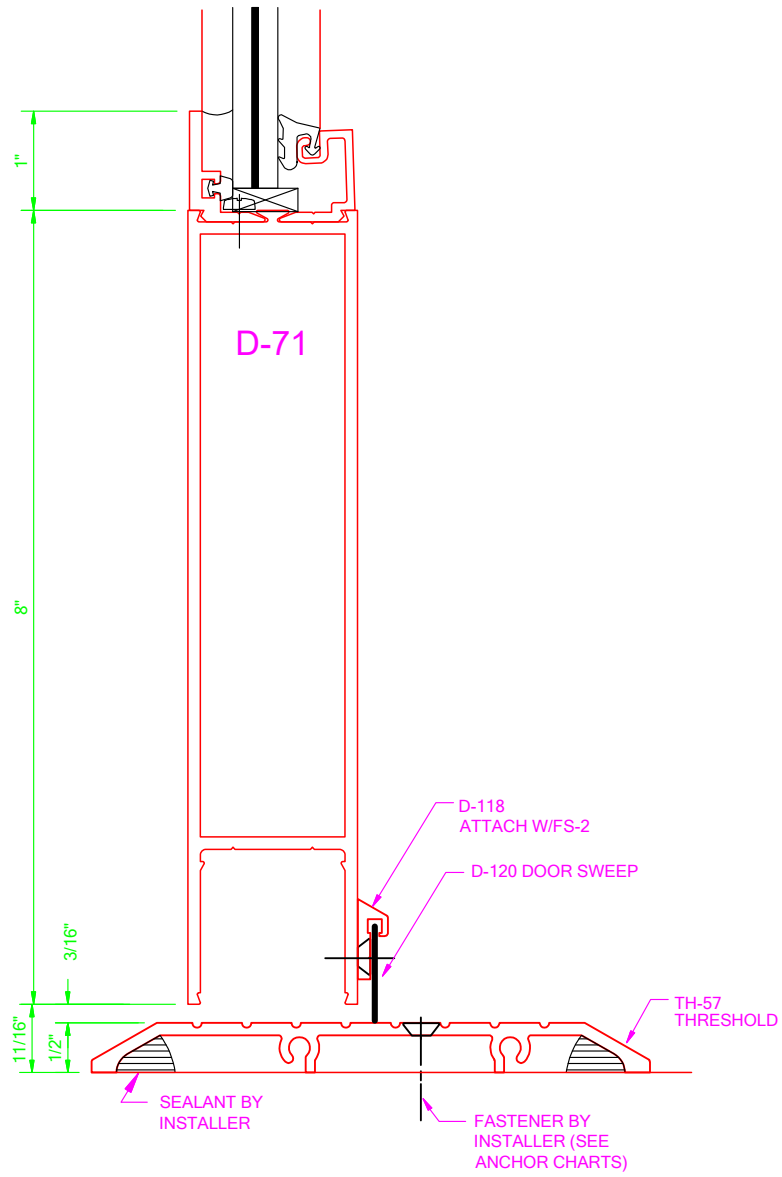

**StormMax™ Hurricane Resistant Entrances**  
**Bottom Rail w/Threshold - HD6157**

patrick schwall - 10	ARCHITECT	VERGES ROME	PROJECT	ALGIERS PEDIATRIC	GLAZING CONTRACTOR	STAR GLASS INC
REVISED 4/29/2016	CONTRACTOR	DEW ENTERPRISES				
REVISED						
REVISED						
PROJECT NO.						

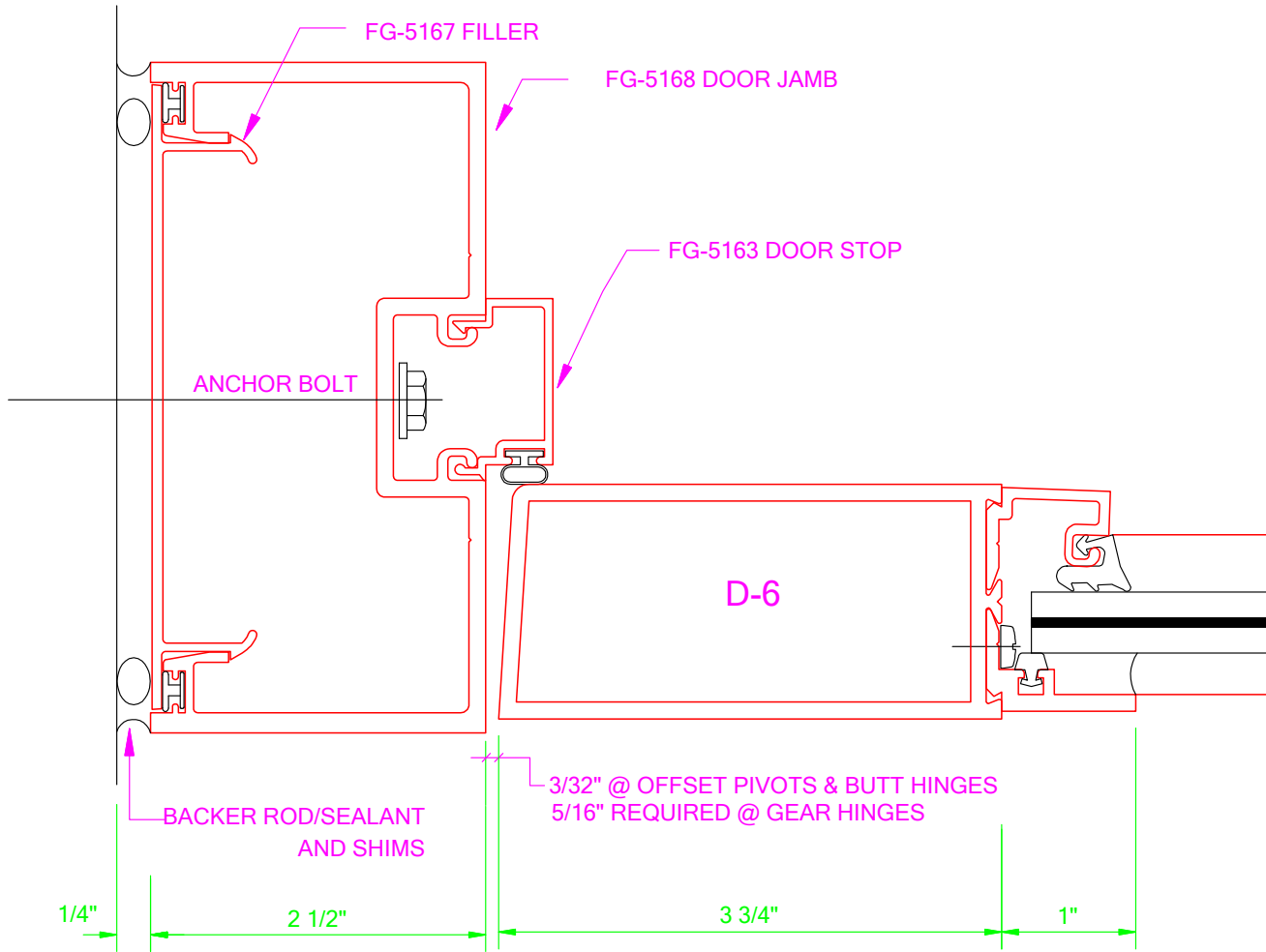

**StormMax™ FG-5000 - Door Jamb**  
**V6331**

GLAZING CONTRACTOR  
STAR GLASS INC

PROJECT  
ALGIERS PEDIATRIC

ARCHITECT  
VERGES ROME  
CONTRACTOR  
DEWENTEPRISES

patrick schwall - 10  
REVISED 4/29/2016  
REVISED  
REVISED  
PROJECT NO.

SHEET  
NO.  
OF



Product Comparison Chart

Color	Product Description - Performance Characteristics	Thickness (inches)	Visible Trans. (%)	Visible Refl. Out (%)	Visible Refl. In (%)	UV Trans. (%)	Solar Trans. (%)	Solar Refl. Out (%)	Winter U-factor	Summer U-factor	Shading Coeff.	Solar Heat Gain Coeff.	Relative Heat Gain	Light to Solar Gain
G1	OB: 1/4" Clear AS: 1/2 inch (Air Fill) IB: 19/32" Laminate - 1/4" Clear - 0.090" Clear PVB - 1/4" Clear	1.286	77	15	14	<1	51	11	0.45	0.47	0.77	0.67	160	1.15
G2	19/32" Laminate - 1/4" Clear - 0.090" Clear PVB - 1/4" Clear	0.563	86	8	8	<1	64	6	0.92	0.84	0.84	0.73	181	1.18

NOTES:

GlasSelect® calculates center of glass performance data using the Lawrence Berkeley National Laboratory (LBNL) Window 6.3 program (version 6.3.74.0) with Environmental Conditions set at NFRC 100-2010. Gas Library ID#1 (Air) is used for Insulating Glass units with air. Gas Library ID#9 (10% Air/90% Argon) is used for Insulating Glass units with argon. Monolithic glass data is from the following sources: 1. LBNL International Glazing Database (IGDB) version 44.0; 2. Vendor supplied spectral data files. Laminated glass data is from the following sources: 1. LBNL International Glazing Database (IGDB) version 44.0; 2. LBNL Optics 6 (version 6.0 Maintenance Pack 1); 3. Vendor supplied spectral data files; 4. Vendor supplied data. 5. Based on vendor testing, clear acid-etched glass performance data is estimated using regular clear glass of equivalent thickness.

Glass colors represented herein are included only for the general purpose of glass selection. Accurate representation of optical properties, including color and reflectivity, can only be achieved by viewing glass mock-ups in conditions that are similar to the actual job. User assumes all responsibility and liability for glass color selection. Thermal values are in Imperial units.

NOTE\*

THERE IS NO PERFORMANCE DATA ON SPANDREL GLASS.

ARCHITECT: VEREGES ROME  
 CONTRACTOR: DEW ENTERPRISES  
 PROJECT: ALGIERS PEDIATRIC  
 GLAZING CONTRACTOR: STAR GLASS INC  
 patrick schwall - 10  
 REVISED 4/29/2016  
 REVISED  
 REVISED  
 PROJECT NO.

SHEET NO. \_\_\_\_\_  
 OF \_\_\_\_\_

# Series FG-5100 StormMax™ — impact-resistant storefront system

The FG-5100 system is an **impact-resistant** storefront system for **1-5/16" insulating laminated glass**. This system meets the most demanding requirements of the Florida and International Building Codes.

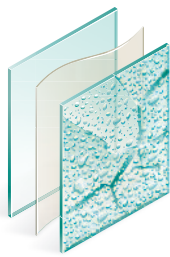

The system is unique in that it offers a dry-glaze option for large missile impact. StormMax™ products can also be glazed with our exclusive StormGlass™ hurricane-resistant glass for **maximum defense** against wind-borne debris.



Westlinks V Office Building, Ft. Myers, FL  
Architect: McGarvey Development Company

## Testing

- Miami/Dade County
- Florida Building Code TAS-201, TAS-202, TAS-203
- ASTM E 1886, E 1996

## Features

- Overall dimensions 2-1/2" x 5"
- Design Pressures up to +70 / -80 PSF
- Spans up to 10'-0" tall
- Vertical spacing up to 5'-0" C/L to C/L
- Screw spline assembly
- Dry-Glaze option (Large missile)
- Tested with the MSD-375 Impact-Resistant Entrance Door
- Corner Mullion option



**Details (Wet-Glaze Application Shown)**

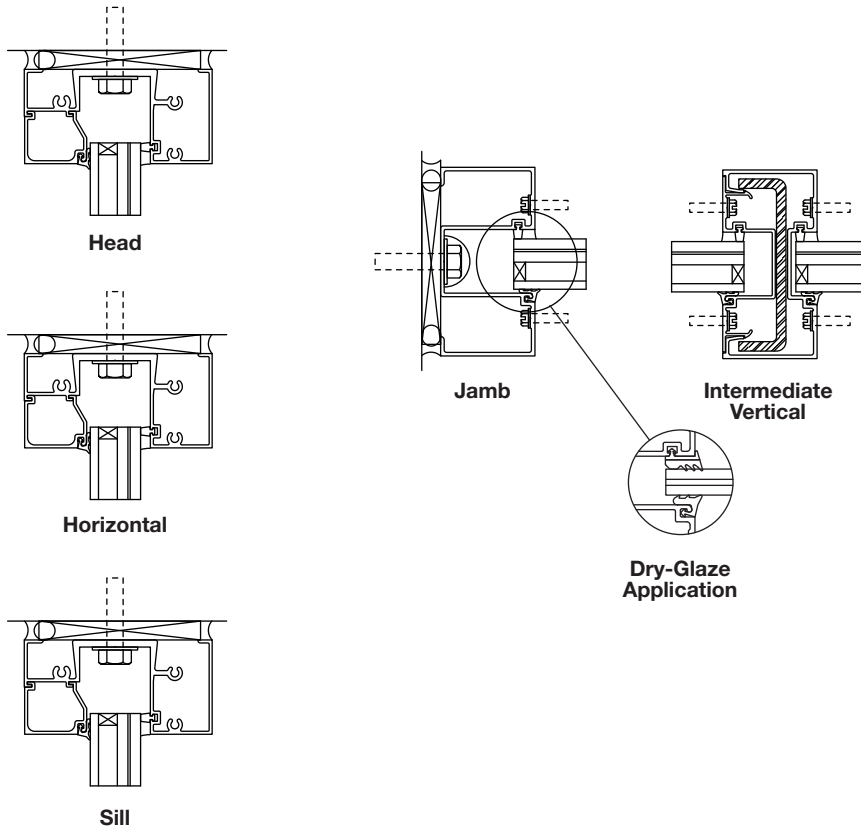

**Performance**

**Wet-Glaze Performance**

- Air Infiltration: Passed at 1.57 PSF and 6.24 PSF per TAS-202 and ASTM E 283
- Static Water: 15 PSF per TAS-202 and ASTM E 331
- Structural Load: +70 / -80 PSF per TAS-202 and ASTM E 330
- Large Missile and Cycling: +70 / -80 per TAS-201, TAS-203 and ASTM E 1886, E 1996

**Dry-Glaze Performance**

- Air Infiltration: Passed at 1.57 PSF and 6.24 PSF per TAS-202 and ASTM E 283
- Static Water: 10 PSF per TAS-202 and ASTM E 331
- Structural Load: +70 / -80 PSF per TAS-202 and ASTM E 330
- Large Missile and Cycling: +70 / -80 per TAS-201, TAS-203 and ASTM E 1886, E 1996

# Series MSD-375 StormMax™ — impact-resistant medium stile entrance doors by Oldcastle BuildingEnvelope™

The Series MSD-375 is an **impact-resistant medium stile entrance door**. This entrance system meets the most demanding requirements of both Florida and International building codes. The series MSD-375 offers the largest variety of hardware options in the industry. The most prominent names in retail and Corporate America rely on **Oldcastle BuildingEnvelope™** to make an unforgettable first impression from standard, custom and impact-resistant storefronts.

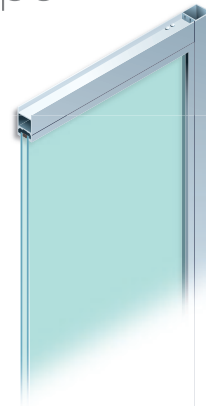

## Testing

- Miami/Dade County
- Florida Building Code TAS-201, TAS-202, TAS-203
- ASTM E 1886, E 1996



Myrtle Beach Convention Center, Myrtle Beach, SC  
Architect: Cannon Design

## Features

### Standard

- 3-point lock mechanism
- 1-1/2" pair of stainless steel butt hinges
- MIG welded corner construction
- 1-3/4" deep rail and stile
- 4-3/4" vertical stile, 4" top rail, 9" bottom rail
- Available for use with the FG-5000/FG-5100 storefront systems and the HR-250/HR-251 curtain wall systems

### Optional

- Panic Devices: A variety of options available
- Continuous gear hinge
- 7-1/2" top rail
- 8-1/2" or 10" mid rail
- Concealed overhead closer



**Details**

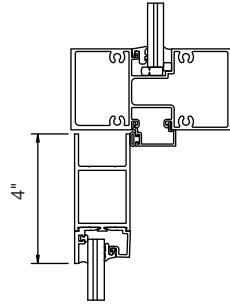

**Standard Top Rail**

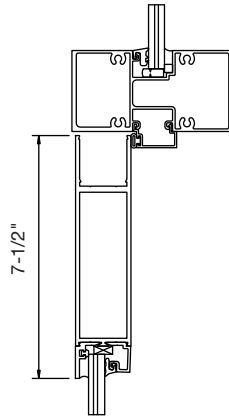

**Optional Top Rail**

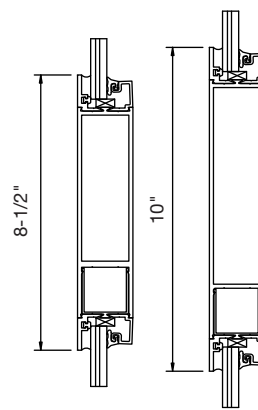

**Optional Mid Rail**

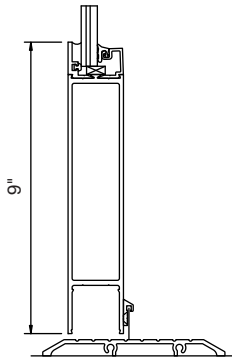

**Standard Threshold**

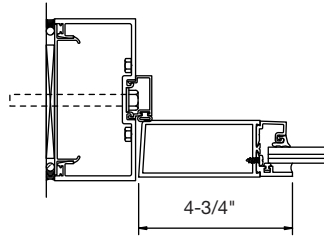

**Standard Stiles**

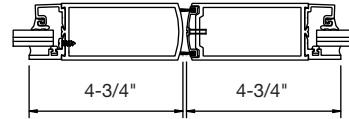

**Performance**

- Air Infiltration: Passed per TAS-202 and ASTM E 283

---

- Forced Entry Resistance Test: Passed at 300 lbs. Per SFBC 3603.2

---

- Structural Load: +70 / -80 PSF per TAS-202 and ASTM E 330

---

- Large Missile and Cycling: +70 / -80 per TAS-201, TAS-203 and ASTM E 1886, E 1996

