

REPLACE W.C. AND LABORATORY IN BOTH BATHROOMS. REPAIR PLUMBING LEAKS BELOW BUILDING

REMOVE & REINSTALL, OR OTHERWISE SUPPORT WALLS WHILE RENOVATING FLOOR. REPLACE ALL DOORS W/ SAME SIZE AS EXISTING

REMOVE TO LEVEL OF PIERS. EXTEND FLOOR BEAMS AND JOIST ACROSS. SPLICE ABOVE PIERS ONLY.

CLEAN TOP OF EXISTING BRICK PIERS AND SHIM TO ASSURE FLOOR LEVEL. INSTALL TERMITE PANS.

- NOTES
1. ALL NEW WOOD SHALL BE TREATED SOUTHERN YELLOW PINE.
 2. ALL MATERIALS SHALL BE NEW AND UNUSED.
 3. REMOVE ALL WOOD WANSCOT FROM WALLS. REPAIR ALL WALLS. REPLACE MISSING GYP BOARD, TEXTURE/FLOAT & PAINT
 4. INSTALL NEW CERAMIC TILE FLOOR & WANSCOT IN TOILETS.
 5. INSTALL NEW COMMERCIAL GRADE CARPET IN CHURCH TO MATCH THAT IN FELLOWSHIP BLDG.
 6. CLEAN INTERIOR OF BUILDING & DISPOSE OF CONSTRUCTION WASTE.

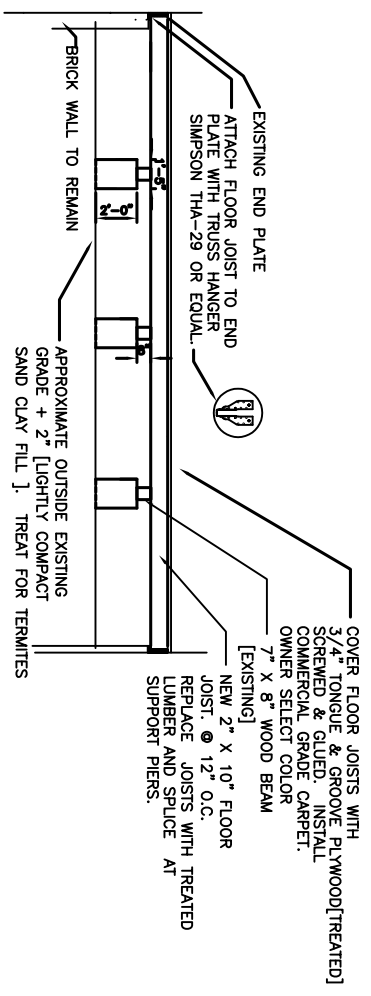

SECTION A-A
SCALE: 1/4" = 1'-0"

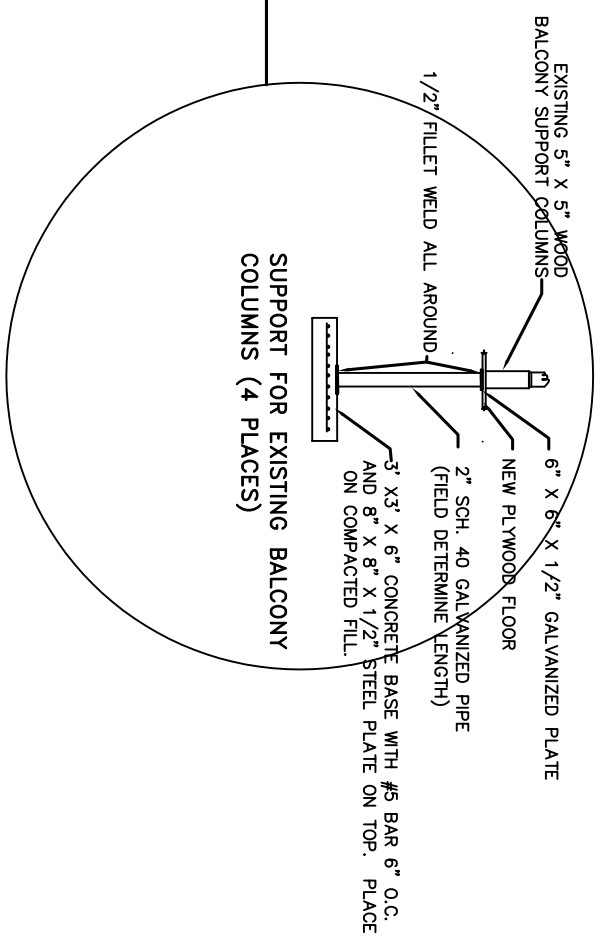

FIELD VERIFY ALL DIMENSIONS

EXISTING BUILDING RENOVATE FLOOR
SCALE: 1/4" = 1'-0"



HISTORIC SANCTUARY
STARLIGHT BAPTIST CHURCH
2100 2nd STREET
SLIDELL, LA.

REPLACE FLOOR IN HISTORICAL CHURCH
DAMMON ENGINEERING. INC.
1095 FLORIDA AVENUE 985-649-6882 SLIDELL, LA. 70456
DAMMONENGINEERING.COM

SCALE: AS NOTED
FILE:
JOB NO.
DATE: 11/02/06
SHEET 1
A-1
OF