

GENERAL NOTES

- INSULATION AND INSULATION ASSEMBLES SHALL MEET THE REQUIREMENTS OF SECTION 718 INTERNATIONAL BUILDING CODE, 2000.
 - CONCEALED INSULATION SHALL HAVE A FLAME SPREAD OF NOT MORE THAN 0-75 AND A SMOKE DEVELOPED INDEX OF NOT MORE THAN 0-450.
 - FACING SHALL COMPLY WITH IBC 718.2.1.
- PROVIDE 5'X5' LANDINGS OUTSIDE EXTERIOR DOOR LEVEL WITH THE FLOOR. THRESHOLDS SHALL BE NOT MORE THAN 1/2" IN HEIGHT AND SHALL BE BEVELED IF MORE THAN 1/4". ALL GROUND AND FLOOR SURFACES SHALL BE NON SLIP.
- DIMENSIONS ARE TO CENTER LINE OR FACE OF STUDS, CENTER LINES OF COLUMNS OR FACE OF VINYL.
- CONTRACTOR TO VERIFY ALL SITE CONDITIONS AND ALL DIMENSIONS PRIOR TO CONSTRUCTION.
- MATERIALS SHALL BE NEW AND U.L. LISTED.
- NO WORK SHALL BE CONCEALED UNTIL APPROVED BY LOCAL INSPECTORS.
- CONSTRUCTION SHALL COMPLY WITH ALL CITY, STATE AND LOCAL CODES.
- CONTRACTOR TO GUARANTEE WORK FOR ONE YEAR.
- CONTRACTOR SHALL FURNISH WATER AND POWER FROM EXISTING SOURCES.
- EXTERIOR CAULKING SHALL BE THOKAL CAULK.
- PAINT GRADE TO BE SHERWIN WILLIAMS OR EQUIVALENT. ALL WORK TO RECEIVE 3 COATS. COLOR SELECTION BY OWNER.
- PROVIDE CLEANUP ON A REGULAR BASIS. NO TRASH STORED IN BUILDING.
- ALL BATT INSULATION SHALL HAVE A CLASS "A" (0-25) FLAME SPREAD IN COMPLIANCE WITH APPLICABLE CODE.
- USE 6" STUDS AT ALL PLUMBING WALLS.
- PROVIDE GAL. METAL PAN WITH DRAIN AT WATER HEATER LOCATION.
- ALL CORNERS SHALL BE PROPERLY BRACED FOR WIND LOADS. A 48" SHEATHING SHALL BE PROVIDED EVERY 20 FEET OF WALL LENGTH.
- FLOORING SHALL BE NON-SLIP.
- LOCKS ON DOORS IN MEANS OF EGRESS SHALL NOT REQUIRE THE USE OF A KEY (INTERIOR SIDE). SPECIAL DEVICE OR SPECIAL KNOWLEDGE TO OPEN IN THE DIRECTION OF EGRESS. ALL DOORS SHALL HAVE LEVER TYPE HANDLES.
- INTERIOR WALLS AND CEILINGS SHALL HAVE A FLAME SPREAD OF 0-200 AND A SMOKE DEVELOPMENT RATING OF 0-450.
- ALL WORK SHALL COMPLY WITH THE LATEST EDITION OF ALL LOCAL STATE AND NATIONAL CODES THAT COVER THE SECTION OF WORK BEING PERFORMED.
- PROVIDE PORTABLE FIRE EXTINGUISHERS IN ACCORDANCE WITH NFPA 10. SEE APPENDIX "E" OF NFPA 10 FOR DISTRIBUTION OF EXTINGUISHERS.
- ALL FIRE WALLS SHALL EXTEND TIGHT TO ROOF SHEATHING & SEALED WITH APPROVED FIRE CAULK.
- ALL ELECTRICAL, MECHANICAL & PLUMBING PENETRATING FIRE PARTITIONS SHALL BE FIRE CAULKED. (PENETRATIONS THROUGH RATED CONSTRUCTION SHALL BE SEALED WITH A MATERIAL CAPABLE OF PREVENTING THE PASSAGE OF FLAMES AND HOT GASES WHEN TESTED IN ACCORDANCE WITH ASTM-E814.)

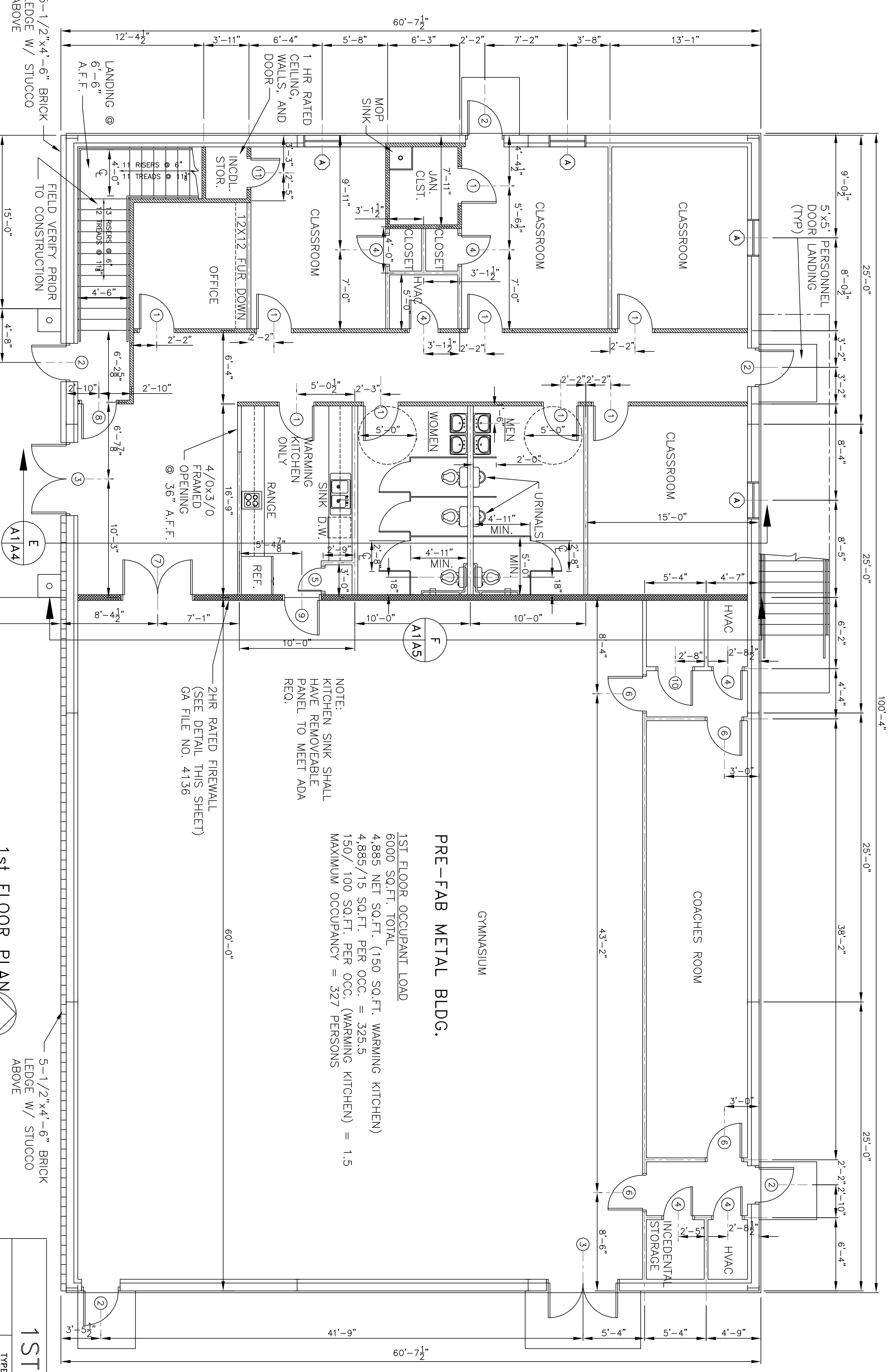

1st FLOOR PLAN
SCALE: 3/16"=1'-0"

1ST FLOOR WINDOW SCHEDULE

MARK	WINDOW	TYPE			FRAME			GLASS			LITES			ACCESSORIES			REMARKS				
		FIXED	VERTICAL SLIDE	HORIZ SLIDE	STEEL	ALUMINUM	WOOD	TINTED	PLAIN	TEMPERED	WIREGLASS	NONE	2/2	4/4	6/6	8/8		ALARM	SCREEN	SHUTTER	NONE
(A)	3/0x5/0																				GLAZED / 36" A.F.F.

1ST FLOOR DOOR & HARDWARE SCHEDULE

MARK	DOOR	TYPE			FRAME			HINGE			LOOK			ACCESSORIES			REMARKS					
		SOLID WOOD	HOLLOW METAL	ALUM/GLASS	ALUMINUM	WOOD	DBL SWING	BUTT	BURGLERPRF	PASSAGE	PRIVACY	DEADBOLT	KEYED HANDLE	PUSH PULL	PANIC	THRESHOLD		WEATHERSTRIP	DOOR STOP	ALARM	VIEW GLASS	CLOSER
(1)	3/0x6/8x1 3/4"																					CLSM. - OFFICE DOORS / 45 MIN FIRE RATED
(2)	3/0x6/8x1 3/4"																					SINGLE EXIT DOORS
(3)	(23/0x6/8x1 3/4"																					FRONT ENTRANCE DOOR
(4)	2/6x6/8x1 3/4"																					NON-RATED STORAGE ROOMS
(5)	2/0x6/8x1 3/4"																					PANTRY DOOR
(6)	3/0x6/8x1 3/4"																					NON-RATED STORAGE ROOMS
(7)	(23/0x6/8x1 3/4"																					SAFETY GLAZING / 90 MIN FIRE RATED
(8)	3/0x6/8x1 3/4"																					SAFETY GLAZING / 45 MIN FIRE RATED
(9)	3/0x6/8x1 3/4"																					90 MIN FIRE RATED
(10)	3/0x6/8x1 3/4"																					45 MIN FIRE RATED / JANITORS CLOSET
(11)	2/6x6/8x1 3/4"																					45 MIN. FIRE RATED / STORAGE UNDER STAIRS

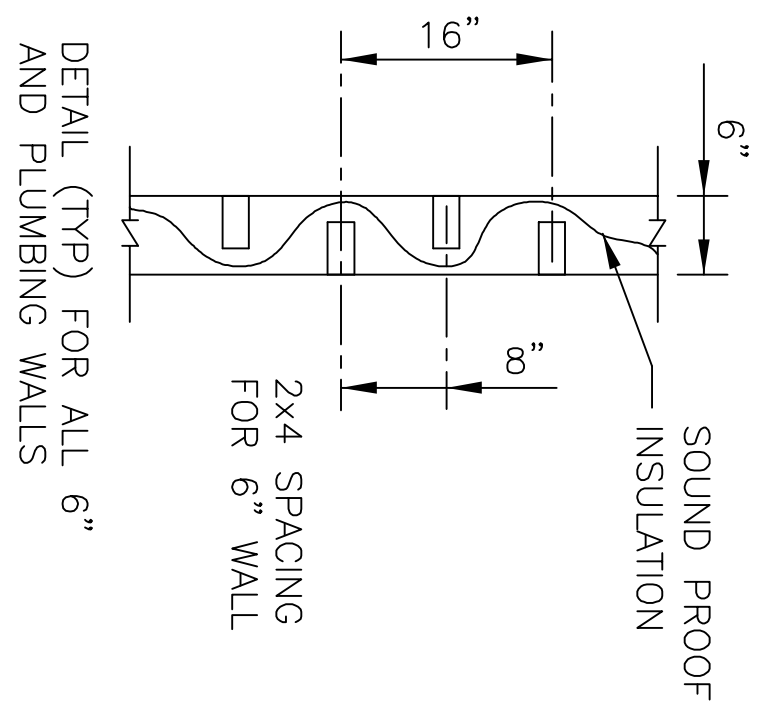

WALL DETAIL
SCALE: N.T.S.

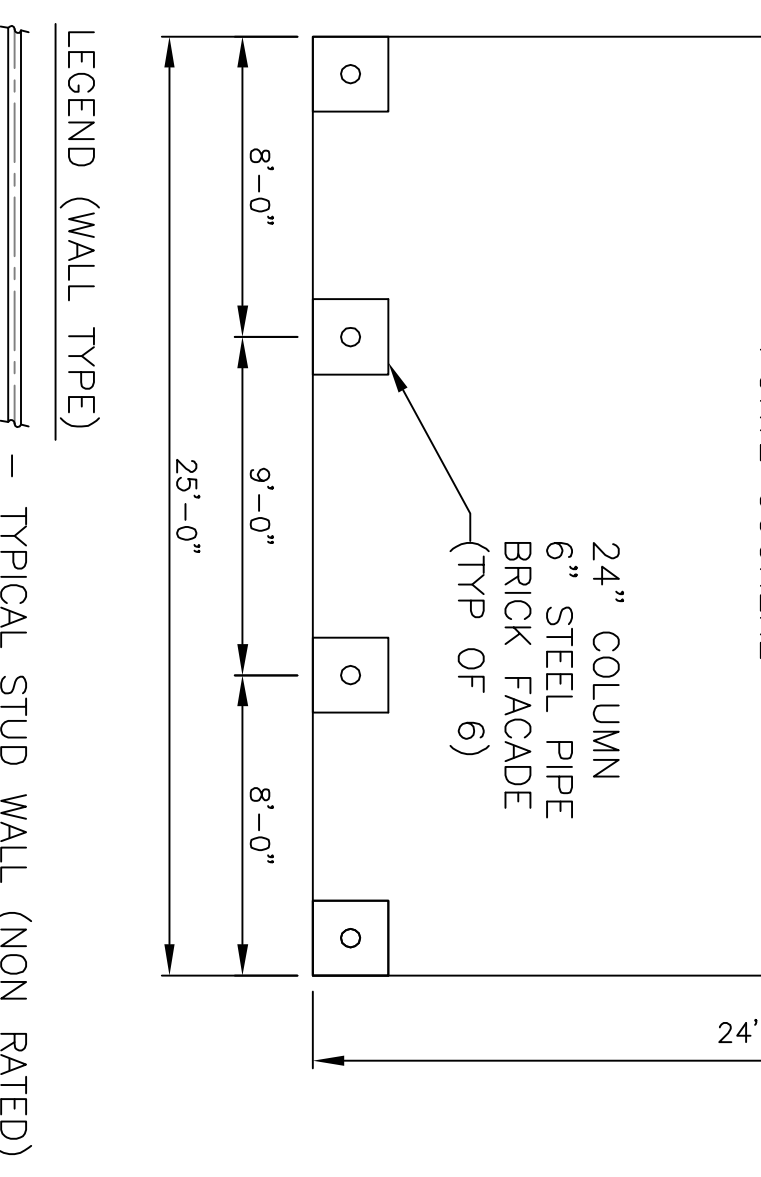

GRACE HARBOR FAMILY CHURCH

DAMMON ENGINEERING, INC.

1095 FLORIDA AVENUE 985-649-5832 SLIDELL, LA. 70458
DAMMONENGINEERING.COM

1ST FLOOR PLAN

MIKE PATTERSON
HWY 1077
GOODBEE, LOUISIANA

SCALE: AS NOTED

FILE: _____

JOB NO. 1704

DATE: 11-09-05

SHEET 6

A-1