

**DAMMON**  
ENGINEERING, INC.

CHIEF ENGINEER  
EMMETT  
DAMMON, P.E.

CHIEF ARCHITECT  
ROBERT  
WILTSE

1095 FLORIDA AVENUE  
SLIDELL, LA, 70458  
OFFICE: 985-649-5632  
FAX: 985-641-5950

WEBSITE:  
WWW.DAMMONENGINEERING.COM  
EMAIL:  
DAMMONENG@Bellsouth.net

ARCHITECTURE  
ENGINEERING  
STUDIES  
PLANNING  
INVESTIGATION  
EXPERT WITNESS

ALDERSGATE  
UNITED METHODIST  
ALTERATIONS  
AND RENOVATIONS

DALE KIMBALL  
2515 CAREY STREET  
SLIDELL, LA

CEILING AND  
LIGHTING PLAN

REV:

SCALE: AS NOTED

JOB#: 1795

DATE: 6-17-08

SHEET 5

A-3

OF 8

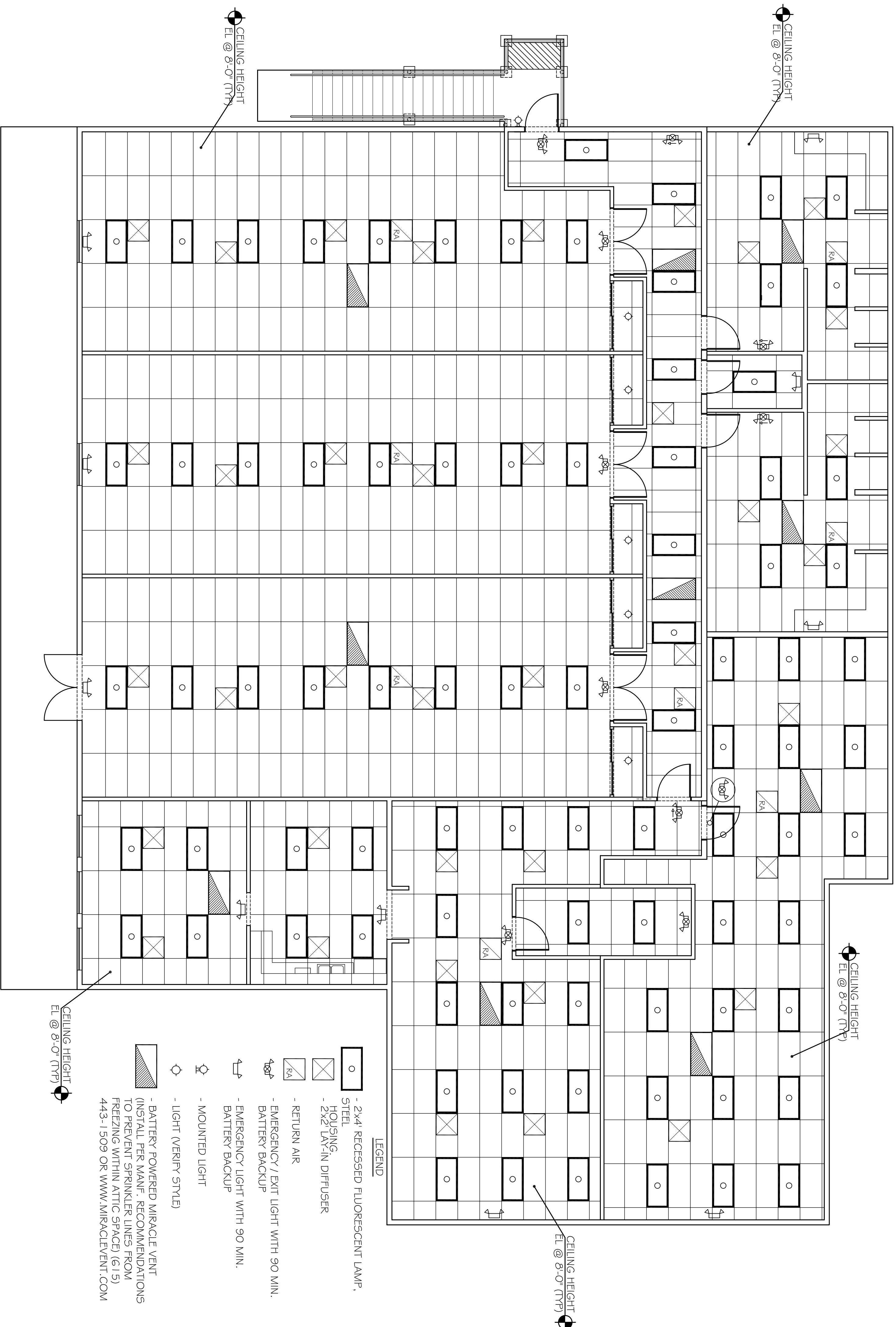

- LEGEND**
- 2"x4" RECESSED FLUORESCENT LAMP.
  - STEEL HOUSING.
  - 2"x2" LAN-IN DIFFUSER
  - RETURN AIR
  - EMERGENCY / EXIT LIGHT WITH 90 MIN. BATTERY BACKUP
  - EMERGENCY LIGHT WITH 90 MIN. BATTERY BACKUP
  - MOUNTED LIGHT
  - LIGHT (VERIFY STYLE)
  - BATTERY POWERED MIRACLE VENT (INSTALL PER MANF. RECOMMENDATIONS TO PREVENT SPRINKLER LINES FROM FREEZING WITHIN ATTIC SPACE) (6.15) 443-1509 OR WWW.MIRACLEVENT.COM

**2nd FLOOR REFLECTED CEILING AND LIGHTING PLAN**  
SCALE: 3/16" = 1'-0"

NOTE: THIS BUILDING SHALL BE FULLY SPRINKLED.