

SCALE 1/8"=1'-0"  
 FILE  
 JOB NO.  
 DATE 3/12/98  
 SHEET C-1

EDUCATIONAL BUILDING

BEN'S FORD BAPTIST CHURCH  
**D**AMMON ENGINEERING, INC.  
 ARCHITECTS - ENGINEERS  
 737 ROBERT ROAD, SUITE 1  
 SLIDELL, LA. 70458

BEN'S FORD BAPTIST CHURCH  
 BOGALUSA LOUISIANA

LAST EDIT: 3-24-98 7:56am GJD

SITE LAYOUT



- NOTES
1. Ground and floor surfaces shall be Non-slip.
  2. Handicap parking signage shall not be obscured by vehicles.
  3. Persons in wheelchairs shall not be required to pass behind parked vehicles.

EXISTING PARKING LOT

BENS FORD ROAD

EXISTING DRIVE

EXIST MAIN

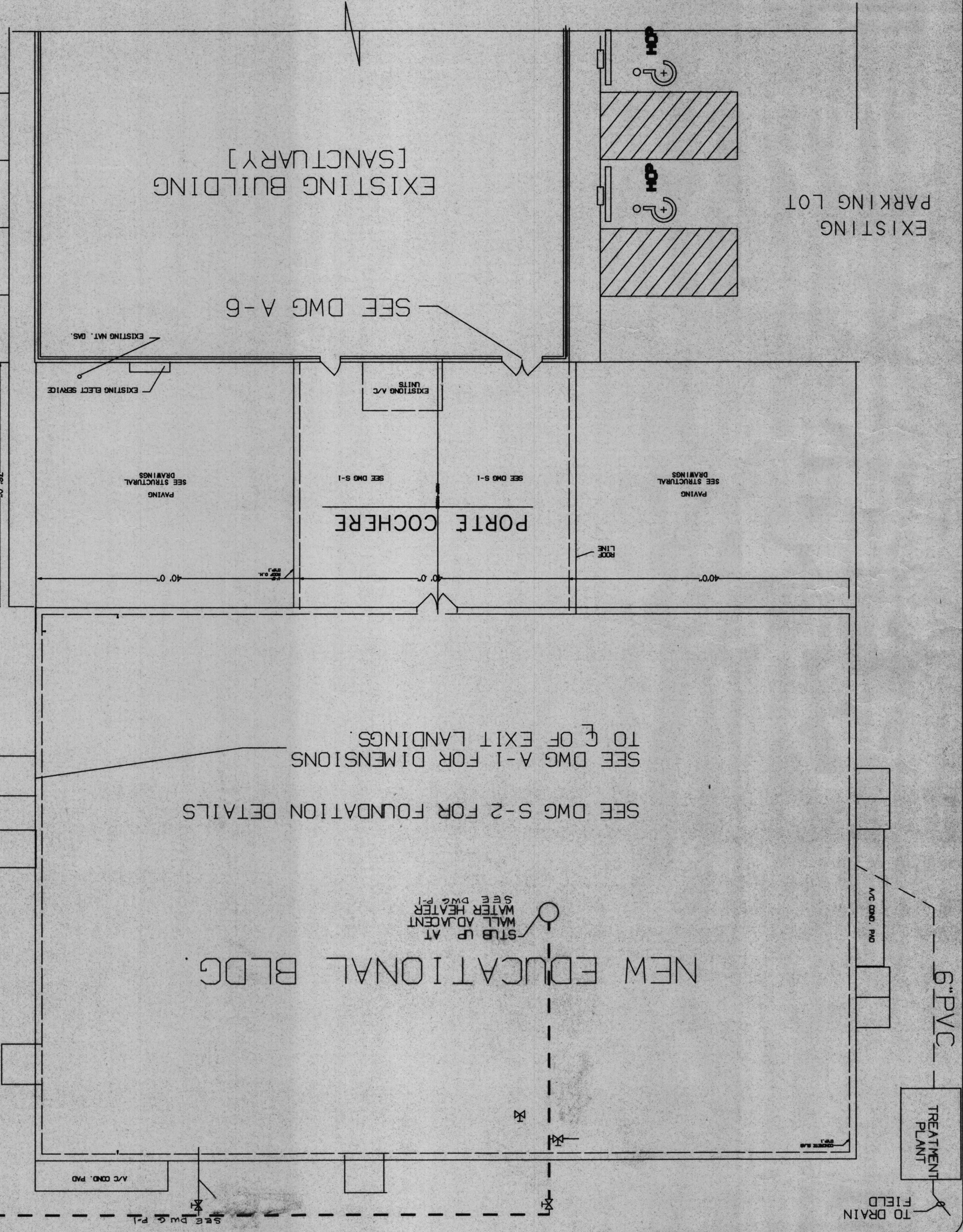

EXISTING PARKING LOT

EXISTING BUILDING [SANCTUARY]

SEE DWG A-6

PORTE COCHERE

SEE DWG S-2 FOR FOUNDATION DETAILS

SEE DWG A-1 FOR DIMENSIONS TO FACE OF EXIT LANDINGS

NEW EDUCATIONAL BLDG.

6" PVC

TREATMENT PLANT

TO DRAIN FIELD

2 1/2" WATER LINE SOED 40 PVC

EXIT PAD SEE STRUCT DRAWINGS

STUB UP AT WALL ADJACENT WATER HEATER SEE DWG P-1

SEE DWG P-1

A/C COND. PAD

A/C COND. PAD

SEE STRUCTURAL DRAWINGS

SEE DWG S-1

SEE DWG S-1

SEE STRUCTURAL DRAWINGS

EXISTING ELECT SERVICE

EXISTING MNT. GAS

