

# OM8200A23PC

## 8" Incandescent Cylinder

CAT NO:

TYPE:

PROJECT:

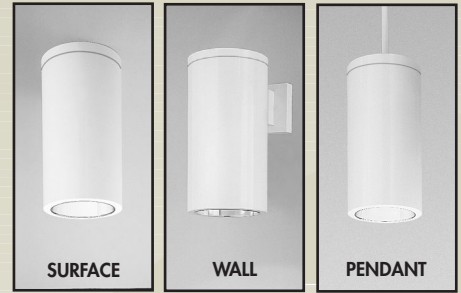

### PRODUCT INFORMATION

#### Applications

A low brightness small profile cylinder for use with PAR lamps. Provides broad uniform light distribution with high efficiency for general illumination of areas such as lobbies, reception areas, schools, restaurants, hotels and offices.

#### Specifications

- Housing** - Aluminum cylinder with cast aluminum top and bottom ring on pendant and wall units.
- Installation** - Top plate assembly mounts directly to outlet box (by others). Anchor holes are provided. Socket is mounted to top plate and is accessible for servicing by removal of screws secured to housing. Junction box with 3/8"IPS stud required.
- Reflectors** - Precision spun .050 aluminum one piece reflector, self flanged with clear specular low iridescent finish. The reflector is screw mounted for positive attachment to the socket assembly. Polished flange matches reflector finish.
- Baffle** - Precision machined .051 aluminum with deep grooves to eliminate aperture glare, anodized matte black or matte white finish. Standard flange is painted black.
- Aligning Canopy** - Die cast aluminum free moving and self aligning outlet box cover. Attaches to 3 1/4" or 4" octagon outlet box (by others). Allows for up to 45° adjustability for use with sloped ceilings or seismic requirements. Add AC2 for two aligning canopies - one mounted to outlet box, and one mounted to fixture.
- U.L. Listed** - For use in damp locations and approved for Through Branch Circuit Wiring. I.B.E.W. union made.

♣ Canadian Specifications may vary from these shown, consult Canadian Division.

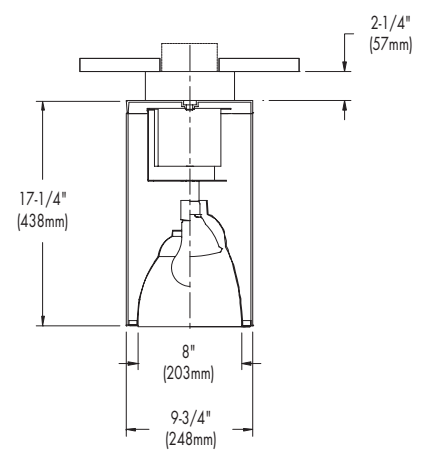
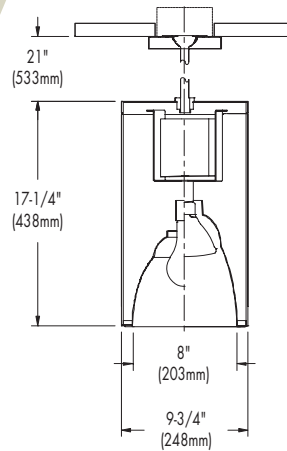
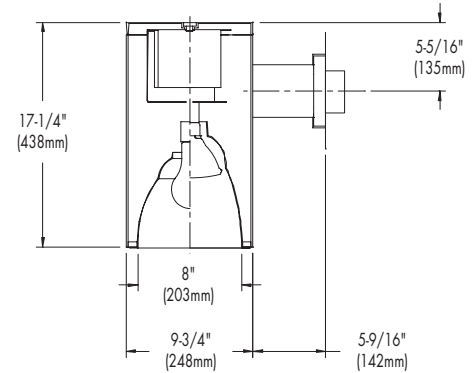

8

### CATALOG SYSTEM AND OPTIONS

EXAMPLE OF COMPLETE CATALOG NUMBER: **OM6200A23PC-CSFF**

OMEGA Lamp Aprt (by others)	Product Family	Reflector Option	Reflector Finish*	Frame Option
OM8				
200 A23	SC Surface Cylinder	BB Black Baffle	CSFF Clear Specular	AC2
150 A21	WC Wall Cylinder		CSSFF Clear Semi-Specular	2 Aligning Canopies
300 PS25	PC Pendant Cylinder**		HZFF Haze	
250 PAR38			GSFF Champagne Gold Specular	
			PWFF Pewter Finish	



FIVE YEAR  
Warranty

\*Consult factory for other finishes.

\*\*Stem length is 22". Consult factory for other lengths.

**OM8200A23-CS**

Photometric Data

**Clear Specular Reflector**

Report Number: 20837  
 Lamp: (1) 200W A23 Inside Frost  
 Total Lumens: 3800  
 Fixture Efficiency: = 73.3%  
 IES File: F20837.IES  
 S/MH Ratio = 1.1, 1.1  
 Beam Angle: 68.23

LIGHTING PERFORMANCE DATA		
CEILING HEIGHT* (FT.)	INITIAL FOOTCANDLES	BEAM DIAMETER (FT.-IN.)
8	78.0	7-5
10	41.9	10-2
12	26.1	12-10
14	17.8	15-7
16	12.9	18-4

DISTRIBUTION CURVE

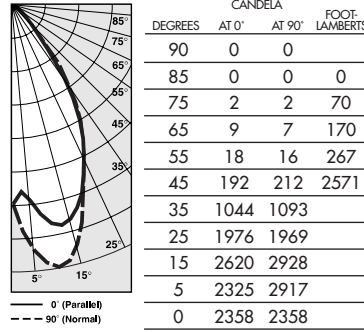

COEFFICIENTS OF UTILIZATION ZONAL CAVITY METHOD

Effective Floor Cavity Reflectance 0.20

RC RW	80		70		50	
	50	30	50	30	50	30
0	86	86	84	84	81	81
1	81	79	79	78	77	75
2	75	71	73	70	71	69
3	69	66	68	66	67	64
4	65	60	65	60	63	59
5	60	56	59	56	58	56
6	56	53	56	53	56	52
7	54	48	53	48	52	48
8	51	46	50	46	48	46
9	47	42	46	42	46	42
10	45	40	45	40	44	40

**OM8200A23BB-CS**

Photometric Data

**Clear Specular Reflector with Black Baffle**

Report Number: 20845  
 Lamp: (1) 200W A23 Inside Frost  
 Total Lumens: 3800  
 Fixture Efficiency: = 63.2%  
 IES File: F20845.IES  
 S/MH Ratio = 1.0, 1.0  
 Beam Angle: 62.71

LIGHTING PERFORMANCE DATA		
CEILING HEIGHT* (FT.)	INITIAL FOOTCANDLES	BEAM DIAMETER (FT.-IN.)
8	72.3	6-8
10	38.9	9-2
12	24.2	11-7
14	16.5	14-0
16	12.0	16-5

DISTRIBUTION CURVE

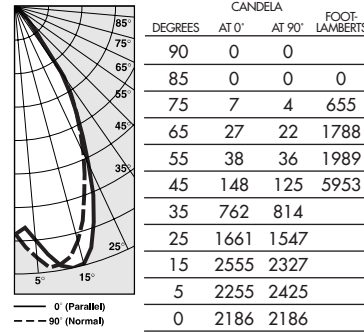

COEFFICIENTS OF UTILIZATION ZONAL CAVITY METHOD

Effective Floor Cavity Reflectance 0.20

RC RW	80		70		50	
	50	30	50	30	50	30
0	75	75	73	73	69	69
1	69	68	68	67	66	65
2	65	61	64	60	61	59
3	59	56	59	56	54	52
4	56	53	56	53	54	52
5	53	48	52	48	51	47
6	50	46	48	46	47	45
7	46	42	46	42	46	41
8	44	40	44	40	42	40
9	41	38	40	38	40	38
10	39	35	39	35	39	34

**OM8250PAR38-CS**

Photometric Data

**Clear Specular Reflector - Spot**

Report Number: 21655  
 Lamp: (1) 250W PAR38/SP  
 Total Lumens: 3370  
 Fixture Efficiency: = 88%  
 IES File: F21655.IES  
 S/MH Ratio = 0.3, 0.3  
 Beam Angle: 16.75

LIGHTING PERFORMANCE DATA		
CEILING HEIGHT* (FT.)	INITIAL FOOTCANDLES	BEAM DIAMETER (FT.-IN.)
8	609.1	1-7
10	327.6	2-2
12	204.2	2-10
14	139.3	3-5
16	101.1	3-12

DISTRIBUTION CURVE

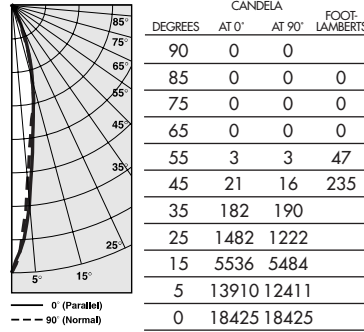

COEFFICIENTS OF UTILIZATION ZONAL CAVITY METHOD

Effective Floor Cavity Reflectance 0.20

RC RW	80		70		50	
	50	30	50	30	50	30
0	105	105	102	102	97	97
1	98	97	96	95	93	93
2	94	92	93	91	90	89
3	91	86	89	86	86	84
4	86	83	85	82	83	81
5	83	80	82	80	81	79
6	81	77	80	77	79	76
7	78	75	78	73	77	73
8	76	71	75	71	75	70
9	72	69	72	69	71	68
10	70	68	70	68	69	67

**OM8250PAR38-CS**

Photometric Data

**Clear Specular Reflector - Flood**

Report Number: 21654  
 Lamp: (1) 250W PAR38/FL  
 Total Lumens: 3370  
 Fixture Efficiency: = 95.3%  
 IES File: F21654.IES  
 S/MH Ratio = 0.8, 0.7  
 Beam Angle: 45.51

LIGHTING PERFORMANCE DATA		
CEILING HEIGHT* (FT.)	INITIAL FOOTCANDLES	BEAM DIAMETER (FT.-IN.)
8	222.6	4-7
10	119.7	6-3
12	74.6	7-12
14	50.9	9-8
16	36.9	11-4

DISTRIBUTION CURVE

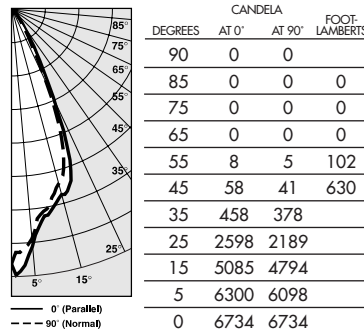

COEFFICIENTS OF UTILIZATION ZONAL CAVITY METHOD

Effective Floor Cavity Reflectance 0.20

RC RW	80		70		50	
	50	30	50	30	50	30
0	112	112	111	111	106	106
1	107	105	105	103	105	103
2	100	96	98	95	95	93
3	94	91	89	84	86	82
4	90	84	89	84	86	82
5	84	81	84	80	82	79
6	81	76	81	76	79	75
7	77	72	77	71	76	71
8	73	68	72	68	71	68
9	70	66	69	66	68	65
10	68	63	67	63	67	61

\*Readings at working plane, 2'6" above floor. Beam Angle and Diameter Cutoff at 50% of max. Candlpower Coefficients used at effective reflectances of: 70% Ceiling, 50% Walls, 20% Floor  
 Additional photometric test files are available @ [omegalighting.com](http://omegalighting.com)

To convert values for optional reflector colors, multiply by:  
 Gold .90      Bronze .82      Pewter .87