



"Dammon Engineering"
 <dammoneng@bellsouth.net
 >
 03/16/2010 03:25 PM

To <david.jones@dps.la.gov>
 cc <dammoneng@bellsouth.net>
 bcc
 Subject Tabernacle Baptist Church - PO376923

March 16, 2010

David,

Thanks for the heads up on this project. Attached, please find a revised layout of the baptismal with access from one side only, that frees up enough space to have proper landings at top and bottom of the stair leading to the baptismal. Let me know if any further adjustments are necessary.

Thanks,

Robert Wiltse
 Chief Architect

Dammon Engineering, Inc. A1-Floor Plan.pdf



LA. S.F.M. PLAN REVIEW
 PO# 376923 REVIEWER 459
 READING FILE DATE MO 03 YR 10
 ORIG TO: _____
 SENDER APPL. _____ OWNER _____
 CC'S _____
 COPY WHAT PGS. these pages to file
 B.R. _____ N.O. _____ ALEK _____ LAF. _____
 SHREVE _____ HO. FILE _____ HO DEPT. _____
 DET FILE _____ HR FILE _____ NON-REQ. SYST. _____
 OTHER _____

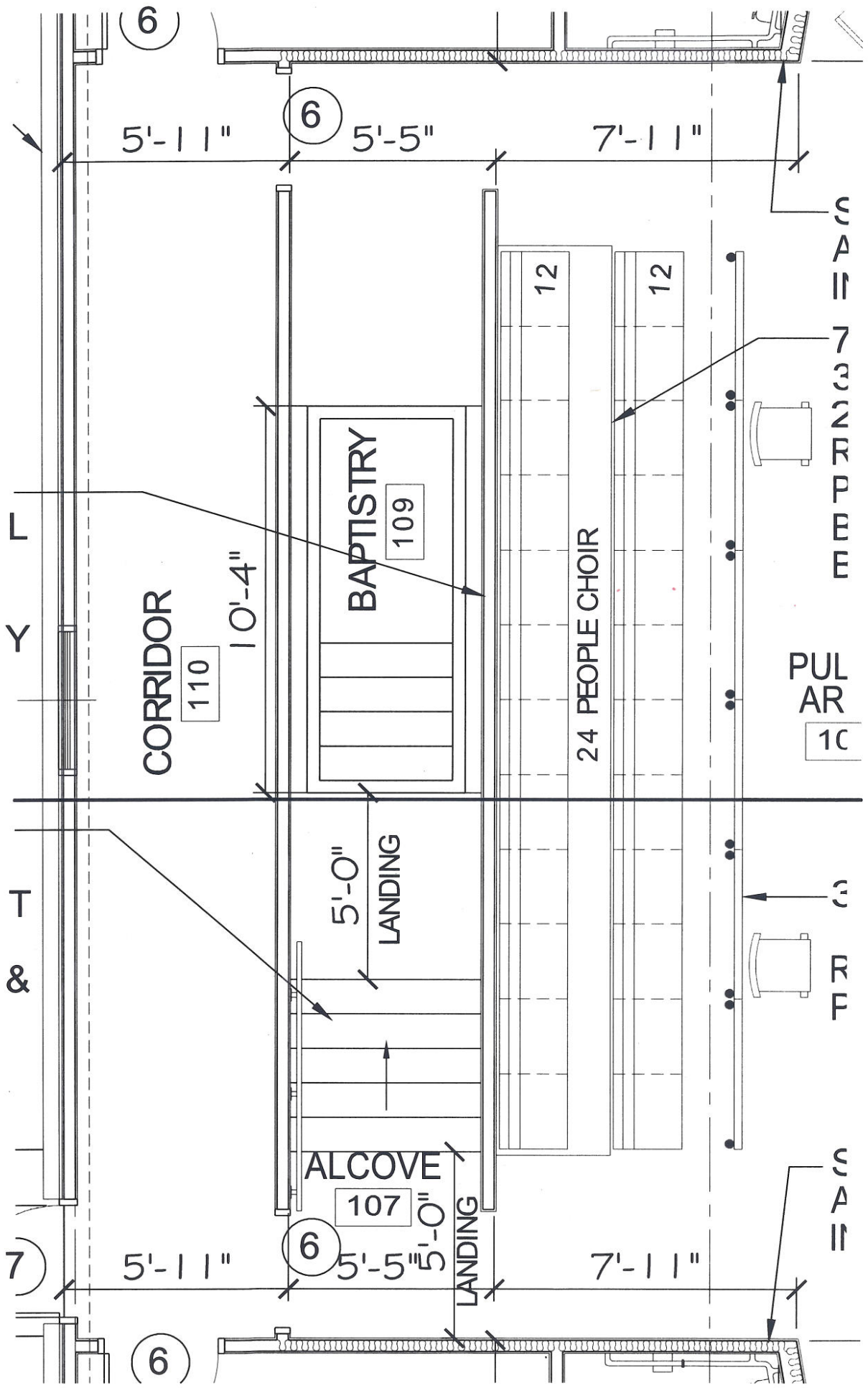

6

6

5'-11"

5'-5"

7'-11"

L
Y

CORRIDOR

110

10'-4"

BAPTISTRY

109

12

12

24 PEOPLE CHOIR

7'-3" DEPTH

PULPIT

1C

T
&

5'-0"
LANDING

ALCOVE

107

5'-0"
LANDING

7'-3" DEPTH

7

5'-11"

6

5'-5"

5'-0"

7'-11"

6