

1 POWER PLAN
SCALE: 3/16"=1'-0"

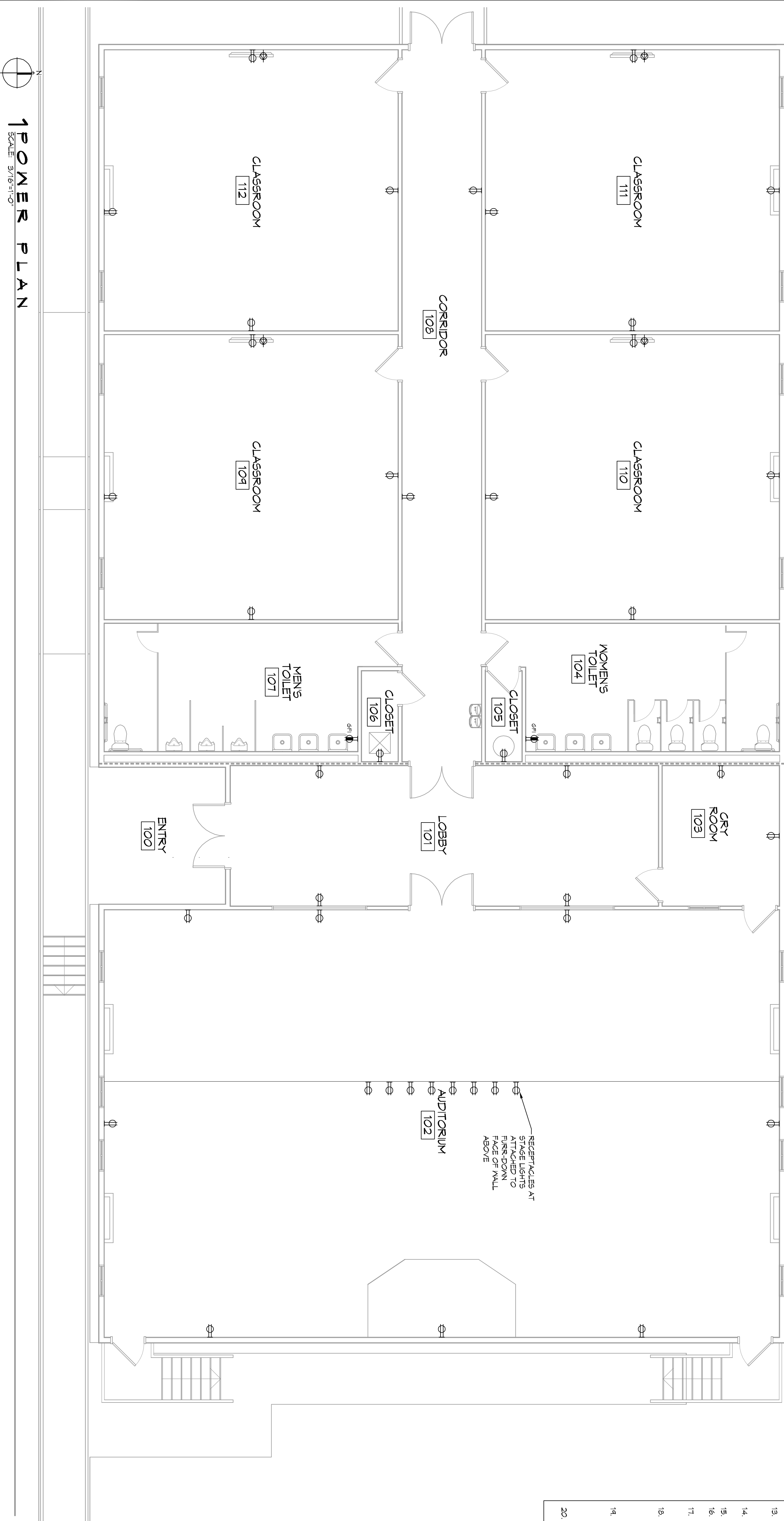

LEGEND

- SYMS DESCRIPTION
- ⊖ STANDARD 120V DUPLEX RECEPTACLE NEMA 5-2 OR 18' AFF (UNLESS OTHERWISE NOTED)
- ⊕ STANDARD 120V DUPLEX RECEPTACLE ABOVE COUNTER HT.
- ⊖ SINGLE-POLE DEDICATED RECEPTACLE - REFER TO PANEL SCHEDULE FOR CIRCUIT SIZE
- ⊖ 6FCI DUPLEX RECEPTACLE
- ⊖ 6FCI QUAD RECEPTACLE
- ⊖ 220V ELECTRIC DRYER RECEPTACLE - MOUNTED AT 30" AFF
- ⊖ 220V DEDICATED 6FCI RECEPTACLE
- ⊖ 220V ELECTRIC DRYER RECEPTACLE MOUNTED AT 30" AFF (UNLESS OTHERWISE NOTED)
- ⊖ STANDARD QUAD RECEPTACLE - WALL-MOUNTED
- ⊖ STANDARD QUAD RECEPTACLE - FLOOR MOUNTED
- ⊖ 125V 15 AMP DUPLEX 5/20 5 AMP
- ⊖ 125V 15 AMP QUADPLEX 5/20 3 AMP
- ⊖ 125V 15 AMP QUADPLEX RECEPTACLE
- ⊖ GENERATOR BATTERY CHARGER
- ⊖ JUNCTION BOX
- ⊖ 2-BUTTON PUSH BUTTON STATION
- ⊖ COAX-CABLE CONNECTION FOR TELEVISION
- ⊖ WALL MOUNTED DATA OUTLET
- ⊖ FLOOR DATA OUTLET
- ⊖ WATER HEATER ON DECK OR MEZZANINE ABOVE - SIZE AS NOTED ON PLAN
- ⊖ EXHAUST FAN - SEE MECH.

NOTES:
 1. CONNECT ALL EMERGENCY/EXIT LIGHT FIXTURES TO NEAREST CONSTANT POWER SOURCE

GENERAL ELEC POWER NOTES

1. ALL WORK SHALL CONFORM TO THE LATEST EDITION OF THE NATIONAL ELECTRICAL CODE, THE GOVERNING ELECTRICAL CODE AND ALL OTHER APPLICABLE CODES AND REGULATIONS. CERTAIN CERTIFICATES OR APPROVALS WHERE REQUIRED, ELECTRICAL CONTRACTOR SHALL VERIFY ALL WIRE AND CONDUIT SIZES FOR MECHANICAL EQUIPMENT TO BE INSTALLED.
2. ALL MATERIALS FINISHED SHALL BE NEW AND SHALL BE U.L. LISTED.
3. THE DRAWINGS INDICATE SIZE AND GENERAL LOCATION OF WORK. SCALE DIMENSIONS SHALL NOT BE USED. THE EXACT LOCATION OF ALL LIGHTING FIXTURES, RECEPTABLES AND TELEPHONE OUTLETS, ETC., SHALL BE DETERMINED BY ACTUAL CONDITIONS IN THE FIELD.
4. PRIOR TO BEGING WORK CONTRACTOR SHALL VISIT THE JOB SITE AND FAMILIARIZE THEMSELVES WITH THE EXISTING CONDITIONS.
5. ELECTRICAL CONTRACTOR SHALL COORDINATE HIS WORK WITH OTHER TRADES CONTRACTORS WHOSE WORK MAY AFFECT THIS INSTALLATION.
6. ELECTRICAL CONTRACTOR SHALL CORRECTLY RECORDING ELECTRICAL SERVICE WITH UTILITY COMPANY AND INCLUDE IN HIS BID ALL CHARGES AND FEES INCURRED IN MODIFICATIONS.
7. ELECTRICAL CONTRACTOR SHALL COORDINATE THE TELEPHONE INSTALLATION WITH THE TELEPHONE COMPANY AND THE GENERAL CONTRACTOR.
8. WHERE MORE THAN ONE SWITCH OCCURS IN THE SAME LOCATION, THEY SHALL BE INSTALLED IN A GANG TYPE BOX UNDER ONE COVER PLATE.
9. ELECTRICAL CONTRACTOR, BEFORE INSTALLING ANY OF THE WORK, SHALL SEE THAT IT DOES NOT INTERFERE WITH CLEARANCES REQUIRED FOR FINISHED CEILING, HUNG CEILING, PLASTER PARTITIONS, WALLS, ETC. AS SHOWN IN THE ARCHITECTURAL DRAWINGS AND DETAILS. IF ANY INTERFERENCE IS ENCOUNTERED, THE CONTRACTOR SHALL NOTIFY THE ARCHITECT AS WELL AS TO PERMIT THE INSTALLATION OF THE ARCHITECTURAL WORK AS SHOWN ON THE PLANS AND DETAILS.
10. PERSONNEL REQUIRED BY THE OWNER OR THE ENGINEER IN CONNECTION WITH THE OPERATION OF THE ELECTRICAL SYSTEM IN THE BUILDING, ALL TESTS SHALL BE MADE IN ACCORDANCE WITH THE LATEST STANDARD OF THE IEEE AND THE NATIONAL ELECTRICAL CODE.
11. MINIMUM CONDUCTOR SIZE SHALL BE #12, 600V INSULATION MINIMUM SIZE CONDUIT SHALL BE 3/4" ELECTRICAL METAL TUBING (EMT) FOR NON-METALLIC CABLE (NMC) AND 1" RIGID COPPER FOR LIGHTS AND RECEPTACLE CIRCUITS IN WOOD FRAME CONSTRUCTION AREAS ONLY. IN STEEL FRAMING AREAS THE USE OF EMT (MINIMUM) IS REQUIRED. EXTERIOR FITTINGS SHALL BE CAST BOXES AND COVERS. INTERIOR FITTINGS SHALL BE STAMPED BOXES.
12. CONTRACTOR SHALL INSTALL WIRING AND OTHER CIRCUIT COMPONENTS TO MATCH EQUIPMENT ACTUALLY INSTALLED.
13. INSTALL GROUND FAULT RECEPTABLES AT RECEPTACLE LOCATIONS WITHIN 5' OF SINKS OR LAVATORIES, AND AT EXTERIOR LOCATIONS. EXTERIOR RECEPTABLES SHALL ALSO BE WATERPROOF.
14. BONDING AND GROUNDING SHALL BE IN ACCORDANCE WITH NFPA 70:2020-65, NFPA 70:2020-25, 250-111 & 250-12.
15. GROUND NEUTRAL IN ACCORDANCE WITH NFPA 70:2020-230.
16. FIRES SHALL BE TIT CLASS 95, 250 VOLT, 200,000 AMP INTERRUPTING CAP.
17. PROVIDE SERVICES OF A FIRE/SMOKE DETECTION AND ALARM COMPANY TO DESIGN AND INSTALL ALARM SYSTEM TO MEET REQUIREMENTS OF THE STATE FIRE MARSHALL AND THE FIRE DISTRICT.
18. EXTERIOR LIGHTING SHALL BE SHAWD OR INWARDLY DIRECTED IN SUCH A MANNER AS TO NOT BE OBSTRUCTIVE TO TRAFFIC OR CAUSE GLARE. IN SUCH THE REVERSE SIDE OF THE FIXTURES SHALL BE GLASS OR CAST BROWN EXCEED ONE FOOT CANDLE AS MEASURED AT THE ADJACENT PROPERTY LINE.
19. ALL ELECTRICAL, MECHANICAL AND PLUMBING PENETRATIONS THROUGH PARTITIONS SHALL BE FIRE CALKED. PENETRATIONS THROUGH RATED CONSTRUCTION SHALL BE SEALED WITH A MATERIAL CAPABLE OF PREVENTING THE PASSAGE OF FLAMES AND HOT GASES WHEN TESTED IN ACCORDANCE WITH ASTM-E814.
20. VERIFY ELECTRICAL CONNECTIONS PER MANUFACTURERS RECOMMENDATIONS.

DAMMON ENGINEERING, INC.
 LOUISIANA & MISSISSIPPI

Chief Engineer: Brian Mistich, PE
 554 Old Spanish Trail
 Suidel, LA 70458

www.dammonengineering.com
 info@dammonengineering.com
 PH: 985.649.5832 F: 985.641.5950

REVISIONS		DATE
#	DESCRIPTION	

Missing or invalid
 File: p:\Stamps
 Sheet: 1

CONSOLE

64452 HWY 41,
 PEARL RIVER, LA 70492

JOB No: 2384 DATE: 9/15/2017
 DRAWN BY: CKD CHECKED BY: BAM

14. ALL ELECTRICAL, MECHANICAL AND PLUMBING PENETRATIONS THROUGH PARTITIONS SHALL BE FIRE CALKED. PENETRATIONS THROUGH RATED CONSTRUCTION SHALL BE SEALED WITH A MATERIAL CAPABLE OF PREVENTING THE PASSAGE OF FLAMES AND HOT GASES WHEN TESTED IN ACCORDANCE WITH ASTM-E814.
 20. VERIFY ELECTRICAL CONNECTIONS PER MANUFACTURERS RECOMMENDATIONS.

SHEET TITLE:
 POWER PLAN

DRAWING NUMBER:
E101

SHEET No. 9 of 15